

FOR KCC USE:

FORM C-1 7/91

EFFECTIVE DATE: 9-17-96
DISTRICT # 1
SSAT Yes No

State of Kansas
NOTICE OF INTENTION TO DRILL

FORM MUST BE TYPED
FORM MUST BE SIGNED
ALL BLANKS MUST BE FILLED

Must be approved by the K.C.C. five (5) days prior to commencing well

Expected Spud Date 10-15-96
month day year

Spot 75 S OF NW SW NW East
1725 FWH 330 FWH Sec 34. Twp 26 S. Rg 12. X West

OPERATOR: License # 5046
Name: Raymond Oil Co., Inc.
Address: P.O. Box 48788
City/State/Zip: Wichita, Ks. 67201
Contact Person: Pat Raymond
Phone: 316-2674214

1725 feet from South (North) line of Section
330 feet from East (West) line of Section
IS SECTION XX REGULAR IRREGULAR
(NOTE: Locate well on the Section Plat on Reverse Side)
County: Pratt
Lease Name: Mardis Well #: 1 'A'
Field Name: Wildcat

CONTRACTOR: License #: 5929
Name: Duke Drilg. Co.

Is this a Prorated/Spaced Field? yes XX no
Target Formation(s): LKC MISS. VIOLA. SIMP.
Nearest lease or unit boundary: 330
Ground Surface Elevation: 1897 est. feet MSL
Water well within one-quarter mile: yes XX no
Public water supply well within one mile: yes XX no
Depth to bottom of fresh water: 240
Depth to bottom of usable water: 240
Surface Pipe by Alternate: XX 1 2
Length of Surface Pipe Planned to be set: 280
Length of Conductor pipe required: N/A
Projected Total Depth: 4500
Formation at Total Depth: Arbuckle
Water Source for Drilling Operations:

Well Drilled For: Well Class: Type Equipment:
XX Oil ... Enh Rec ... Infield XXX Mud Rotary
XX Gas ... Storage ... Pool Ext. ... Air Rotary
... OWD ... Disposal XX Wildcat ... Cable
... Seismic: ... # of Holes ... Other
... Other
If OWD: old well information as follows:
Operator:
Well Name:
Comp. Date: Old Total Depth

well ... farm pond XX other
DWR Permit #: ...
Will Cores Be Taken?: ... yes XX no
If yes, proposed zone:

Directional, Deviated or Horizontal wellbore? ... yes XX no
If yes, true vertical depth:
Bottom Hole Location:

AFFIDAVIT

The undersigned hereby affirms that the drilling, completion and eventual plugging of this well will comply with K.S.A. 55-101, et. seq.
It is agreed that the following minimum requirements will be met:

- 1. Notify the appropriate district office prior to spudding of well;
- 2. A copy of the approved notice of intent to drill shall be posted on each drilling rig;
- 3. The minimum amount of surface pipe as specified below shall be set by circulating cement to the top; in all cases surface pipe shall be set through all unconsolidated materials plus a minimum of 20 feet into the underlying formation;
- 4. If the well is dry hole, an agreement between the operator and the district office on plug length and placement is necessary prior to plugging;
- 5. The appropriate district office will be notified before well is either plugged or production casing is cemented in;
- 6. IF AN ALTERNATE II COMPLETION, PRODUCTION PIPE SHALL BE CEMENTED FROM BELOW ANY USABLE WATER TO SURFACE WITHIN 120 DAYS OF SPUD DATE. IN ALL CASES, NOTIFY DISTRICT OFFICE PRIOR TO ANY CEMENTING.

I hereby certify that the statements made herein are true and to the best of my knowledge and belief.
9-6-96
Date: Signature of Operator or Agent: Title: Pres.

* LOST CIRCULATION
CAN OCCUR FROM
600 - 800' IN THIS
AREA.

FOR KCC USE:
API # 15- 151-221460000
Conductor pipe required NONE feet
Minimum surface pipe required 260 feet per Alt. 1 X
Approved by: JK 9-17-96
This authorization expires: 3-12-97
(This authorization void if drilling not started within 6 months of effective date.)
Spud date: Agent:

REMEMBER TO:

- File Drill Pit Application (form GDP-1) with Intent to Drill;
- File Completion Form ACD-1 within 120 days of spud date;
- File acreage attribution plat according to field prorations orders;
- Notify appropriate district office 48 hours prior to workover or re-entry;
- Submit plugging report (CP-4) after plugging is completed;
- Obtain written approval before disposing or injecting salt water.

Mail to: Conservation Division, 200 Colorado Derby Building, 202 W. First St., Wichita, Kansas 67202-1286.

RECEIVED
KANSAS CORP CO
SEP 11 A 11
1996
9-11-96

34
26
1242

IN ALL CASES PLOT THE INTENDED WELL ON THE PLAT BELOW

PLAT OF ACREAGE ATTRIBUTABLE TO A WELL IN A PRORATED OR SPACED FIELD

If the intended well is in a prorated or spaced field, please fully complete this side of the form. If the intended well is in a prorated or spaced field complete the plat below showing that the well will be properly located in relationship to other wells producing from the common source of supply. Please show all the wells within 1 mile of the boundaries of the proposed acreage attribution unit for gas wells and within 1/2 mile of the boundaries of the proposed acreage attribution unit for oil wells.

API NO. 15- _____
 OPERATOR Raymond Oil Co. Inc. LOCATION OF WELL: COUNTY Pratt
 LEASE Mardis 1725 feet from south/north line of section
 WELL NUMBER #1 'A' 330 feet from east/west line of section
 FIELD Wildcat SECTION 34 TWP 26s RG 12w

NUMBER OF ACRES ATTRIBUTABLE TO WELL 10 IS SECTION XX REGULAR or IRREGULAR
 QTR/QTR/QTR OF ACREAGE Appx NW SW NW IF SECTION IS IRREGULAR, LOCATE WELL FROM NEAREST
CORNER BOUNDARY.

Section corner used: NE NW SE SW

PLAT

(Show location of the well and shade attributable acreage for prorated or spaced wells.)
 (Show footage to the nearest lease or unit boundary line.)

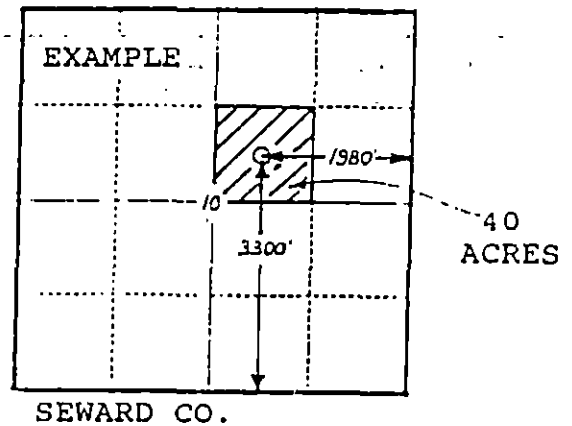
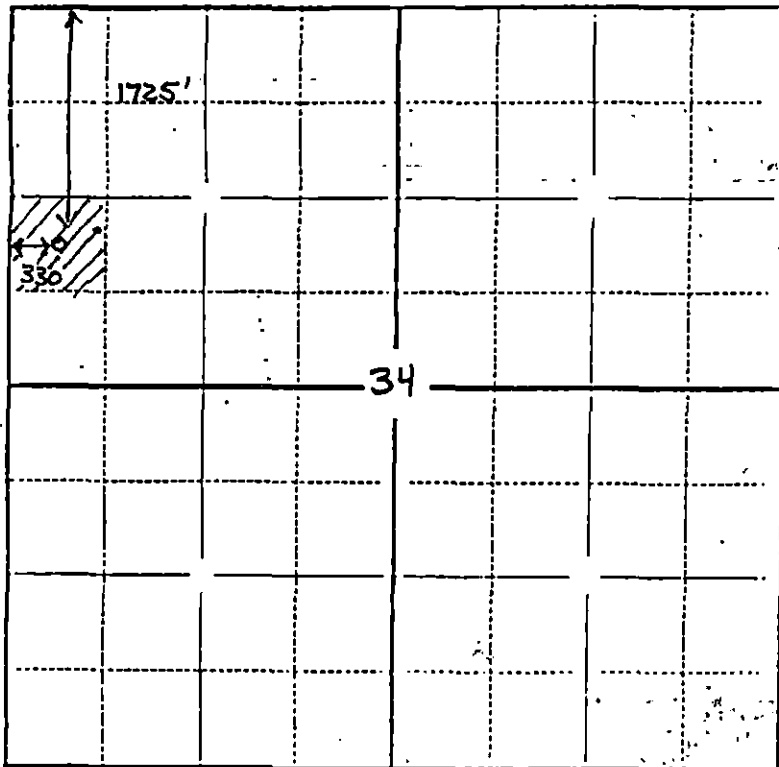

In plotting the proposed location of the well, you must show:

- 1) The manner in which you are using the depicted plat by identifying section lines, i.e. 1 section, 1 section with 8 surrounding sections, 4 sections, etc.;
- 2) the distance of the proposed drilling location from the section's south/north and east/west lines; and
- 3) the distance to the nearest lease or unit boundary line.