

EFFECTIVE DATE: 3-6-2000

State of Kansas

OWWO

FORM MUST BE TYPED

DISTRICT # 1

NOTICE OF INTENTION TO DRILL

FORM MUST BE SIGNED  
ALL BLANKS MUST BE FILLED

SGA?  Yes  No

Must be approved by the K.C.C. five (5) days prior to commencing well.

Expected Spud Date 03 04 2000  
month day year

Spot SW NE SW Sec 2 Twp 26 S, Rg 13 East West

OPERATOR: License # 32154  
Name: SAGEBRUSH OPERATING LLC  
Address: 1888 Sherman Street, Suite 500  
City/State/Zip: Denver, CO 80203  
Contact Person: Robert D. Johnson  
Phone: 303-866-0011

1650 feet from South ~~North~~ line of Section  
3630 feet from East ~~West~~ line of Section  
IS SECTION REGULAR  IRREGULAR?

CONTRACTOR: License # 5929  
Name: Duke Drilling

(NOTE: Locate well on the Section Plat on Reverse Side)  
County: Pratt  
Lease Name: Long Well #: A-1  
Field Name: Rose Valley South

Well Drilled For: Well Class: Type Equipment:  
 Oil ... Enh Rec ... Infield  Mud Rotary  
... Gas ... Storage  Pool Ext. ... Air Rotary  
 OWWO ... Disposal ... Wildcat ... Cable  
... Seismic; ... # of Holes ... Other

Is this a Prorated/Spaced Field? ... yes  no  
Target Formation(s): Lansing  
Nearest lease or unit boundary: 1650

If OWWO: old well information as follows:  
Operator: Vincent Oil Corporation  
Well Name: #1 Long 'A'  
Comp. Date: 12/01/86 Old Total Depth 4354'

Ground Surface Elevation: 1910 feet MSL  
Water well within one-quarter mile:  yes ... no  
Public water supply well within one mile:  yes ... no

Directional, Deviated or Horizontal wellbore? ... yes  no  
If yes, true vertical depth: \_\_\_\_\_  
Bottom Hole Location: \_\_\_\_\_

Depth to bottom of fresh water: 150'  
Depth to bottom of usable water: 180'  
Surface Pipe by Alternate:  1 438'  
Length of Surface Pipe ~~Planned to be set:~~ 438'

Length of Conductor pipe required: \_\_\_\_\_  
Projected Total Depth: 4354'  
Formation at Total Depth: Lansing  
Water Source for Drilling Operations:  
... well  farm pond ... other

Will Cores Be Taken? ... yes  no  
If yes, proposed zone: \_\_\_\_\_

AFFIDAVIT

The undersigned hereby affirms that the drilling, completion and eventual plugging of this well will comply with K.S.A. 55-101, et. seq.

It is agreed that the following minimum requirements will be met:

1. Notify the appropriate district office prior to spudding of well;
2. A copy of the approved notice of intent to drill shall be posted on each drilling rig;
3. The minimum amount of surface pipe as specified below shall be set by circulating cement to the top; in all cases surface pipe shall be set through all unconsolidated materials plus a minimum of 20 feet into the underlying formation;
4. If the well is dry hole, an agreement between the operator and the district office on plug length and placement is necessary prior to plugging;
5. The appropriate district office will be notified before well is either plugged or production casing is cemented in;
6. IF AN ALTERNATE II COMPLETION, PRODUCTION PIPE SHALL BE CEMENTED FROM BELOW ANY USABLE WATER TO SURFACE WITHIN 120 DAYS OF SPUD DATE. IN ALL CASES, NOTIFY DISTRICT OFFICE PRIOR TO ANY CEMENTING.

I hereby certify that the statements made herein are true and to the best of my knowledge and belief.

Date: 2/25/00 Signature of Operator or Agent: \_\_\_\_\_ Title: CEM

FOR KCC USE:  
 API # 15- 151-21508-0001  
 Conductor pipe required NONE feet  
 Minimum surface pipe required 438 feet per Alt. (1)   
 Approved by: JK 3-1-2000  
 This authorization expires: 9-1-2000  
 (This authorization void if drilling not started within 6 months of effective date.)  
 Spud date: \_\_\_\_\_ Agent: \_\_\_\_\_

RECEIVED  
STATE CORPORATION COMMISSION

REMEMBER TO:

- File Drill Pit Application (form CDP-1) with Intent to Drill;
- File Completion Form ACO-1 within 120 days of spud date;
- File acreage attribution plat according to field proration orders;
- Notify appropriate district office 48 hours prior to workover or re-entry;
- Submit plugging report (CP-4) after plugging is completed;
- Obtain written approval before disposing or injecting salt water.

FFB 29 2000

CONSERVATION DIVISION  
WICHITA, KANSAS

2  
26  
13W

IN ALL CASES PLOT THE INTENDED WELL ON THE PLAT BELOW

PLAT OF ACREAGE ATTRIBUTABLE TO A WELL IN A PRORATED OR SPACED FIELD

If the intended well is in a prorated or spaced field, please fully complete this side of the form. If the intended well is in a prorated or spaced field complete the plat below showing that the well will be properly located in relationship to other wells producing from the common source of supply. Please show all the wells within 1 mile of the boundaries of the proposed acreage attribution unit for gas wells and within 1/2 mile of the boundaries of the proposed acreage attribution unit for oil wells.

API NO. 15- \_\_\_\_\_  
 OPERATOR SAGEBRUSH OPERATING LLC  
 LEASE Long  
 WELL NUMBER A-1  
 FIELD Rose Valley South

LOCATION OF WELL: COUNTY Pratt  
1650 feet from south/~~north~~ line of section  
3630 feet from east/~~west~~ line of section  
 SECTION 2 TWP 26 S. RG 13 W.

NUMBER OF ACRES ATTRIBUTABLE TO WELL \_\_\_\_\_  
 QTR/QTR/QTR OF ACREAGE \_\_\_\_\_

IS SECTION \_\_\_\_\_ REGULAR or x IRREGULAR  
IF SECTION IS IRREGULAR, LOCATE WELL FROM NEAREST CORNER BOUNDARY.

Section corner used: \_\_\_\_\_ NE \_\_\_\_\_ NW \_\_\_\_\_ SE x SW

PLAT

(Show location of the well and shade attributable acreage for prorated or spaced wells.)  
 (Show footage to the nearest lease or unit boundary line.)

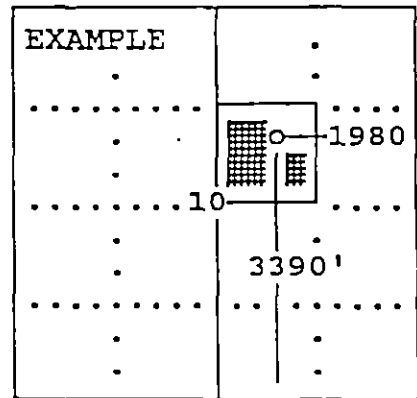
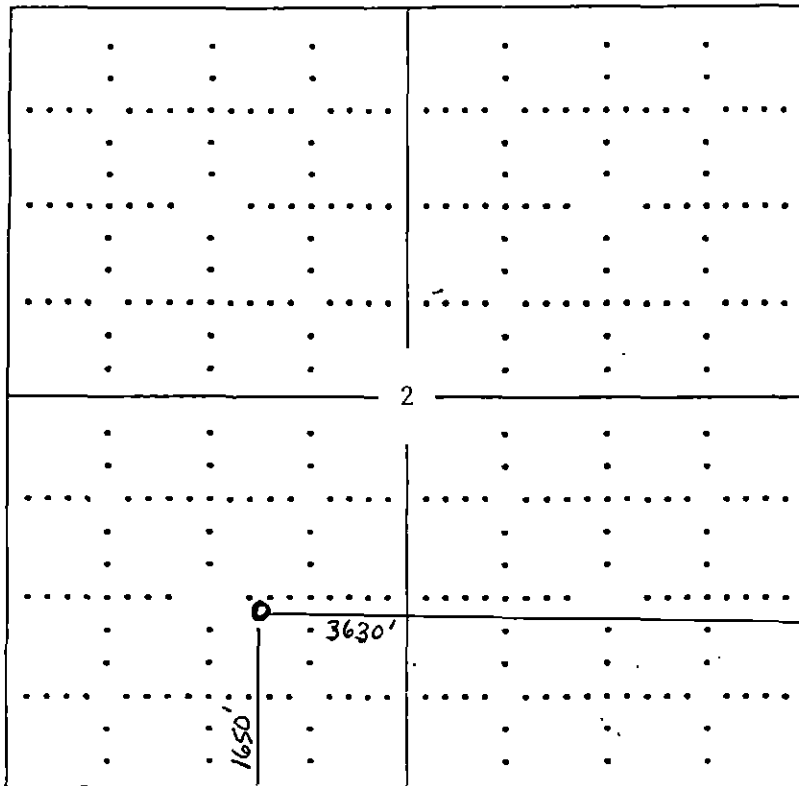

SEWARD CO.

In plotting the proposed location of the well, you must show:

- 1) The manner in which you are using the depicted plat by identifying section lines, i.e. 1 section, 1 section with 8 surrounding sections, 4 sections, etc.;
- 2) the distance of the proposed drilling location from the section's north/south and east/west; and
- 3) the distance to the nearest lease or unit boundary line.

RECEIVED  
 STATE CORPORATION COMMISSION

'FFB 29 2000