

RELEASED

NEW ACO-1 FORM
SIDE ONE

Date: MAR 1 1987

FROM CONFIDENTIAL
STATE CORPORATION COMMISSION OF KANSAS
OIL & GAS CONSERVATION DIVISION

WELL COMPLETION OR RECOMPLETION FORM
ACO-1 WELL HISTORY

DESCRIPTION OF WELL AND LEASE

Operator: license # 9232
name Timberline Oil & Gas Corporation
address 105 E. 8th Street
City: State Zip Pratt, Kansas 67124

Operator Contact Person Brant Grote or Roy Knappe, Jr
Phone (316) 672-9476

Contractor: license # 5138
name Cougar Drilling Co., Inc.

Wellsite Geologist
Phone

PURCHASER Permian

Designate Type of Completion
X New Well Re-Entry Workover

X Oil SWD Temp Abd
Gas Inj Delayed Comp.
Dry Other (Core, Water Supply etc.)

If OWWO: old well info as follows:
Operator
Well Name
Comp. Date Old Total Depth

WELL HISTORY

Drilling Method: Mud Rotary Air Rotary Cable
10-18-85 10-24-85 11-13-85
10-24-85
Spud Date Date Reached TD Completion Date

4400' KB
Total Depth PBDT

Amount of Surface Pipe Set and Cemented at 280.29 feet

Multiple Stage Cementing Collar Used? Yes No

If Yes, Show Depth Set feet

If alternate 2 completion, cement circulated
from feet depth to w/ SX cmt

API NO. 15-151-21,715-0000
County Pratt
NW SW SE Sec 28 Twp 26S Rge 12 West

990 Ft North from Southeast Corner of Section
2310 Ft West from Southeast Corner of Section
(Note: locate well in section plat below)

CONFIDENTIAL

Lease Name Reba Johnson Well# 8

Field Name Iuka Carmi

Producing Formation Viola

Elevation: Ground 1909 KB 1919

Section Plat

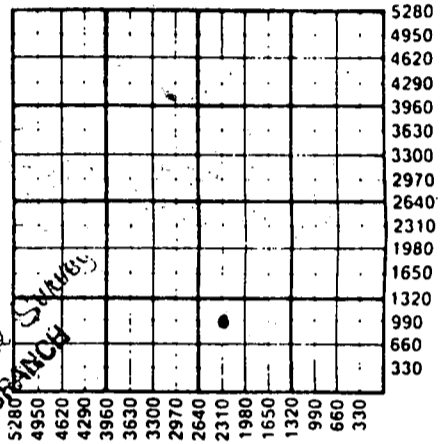

FEB 05 1986
State Geologist
WICHITA BRANCH

WATER SUPPLY INFORMATION

Source of Water:
Division of Water Resources Permit # T85-277

Groundwater 3660 Ft North From Southeast Corner and
(Well) 2380 Ft West From Southeast Corner of
NE/4 Sec 28 Twp 26S Rge 12 East West

Surface Water Ft North From Southeast Corner and
(Stream, Pond etc.) Ft West From Southeast Corner
Sec Twp Rge East West

Other (explain)
(purchased from city, R.W.D.#)

Disposition of Produced Water: Disposal Repressuring

Docket #

INSTRUCTIONS: This form shall be completed in duplicate and filed with the Kansas Corporation Commission, 200 Colorado Derby Building, Wichita, Kansas 67202, within 90 days after completion or recompletion of any well. Rules 82-3-130 and 82-3-107 apply.

Information on side two of this form will be held confidential for a period of 12 months if requested in writing and submitted with the form. See rule 82-3-107 for confidentiality in excess of 12 months.

One copy of all wireline logs and drillers time log shall be attached with this form. Submit CP-4 form with all plugged wells. Submit CP-111 form with all temporarily abandoned wells.

All requirements of the statutes, rules, and regulations promulgated to regulate the oil and gas industry have been fully complied with and the statements herein are complete and correct to the best of my knowledge.

Signature [Handwritten Signature]
Title President Date 1/30/86

Subscribed and sworn to before me this 30th day of January 1986

Notary Public Janice M. McCune
Date Commission Expires 10/18/89

JANICE M. McCUNE
NOTARY PUBLIC
STATE OF KANSAS
MY APPT. EXPIRES 10-18-89

K.C.C. OFFICE USE ONLY
 Letter of Confidentiality Attached
 Wireline Log Received
 Drillers Timelog Received
Distribution
 KCC SWD/Rep NGPA
 KGS Plug Other (Specify)

Form ACO-1 (7-84)
FEB 3 1986
2-3-86

Handwritten notes: 28110, 2148, 1221

15-151-21715-0000

SIDE TWO

Operator Name Timberline Oil & Gas Lease Name Reba Johnson Well# 8 SEC. 28 TWP. 26S RGE. 12 County Pratt

East
 West

WELL LOG

INSTRUCTIONS: Show important tops and base of formations penetrated. Detail all cores. Report all drill stem tests giving interval tested, time tool open and closed, flowing and shut-in pressures, whether shut-in pressure reached static level, hydrostatic pressures, bottom hole temperature, fluid recovery, and flow rates if gas to surface during test. Attach extra sheet if more space is needed. Attach copy of log.

Drill Stem Tests Taken Yes No
 Samples Sent to Geological Survey Yes No
 Cores Taken Yes No

Formation Description
 Log Sample

Clay & sand 0-220
 Red beds 220-737
 Anhydrite 737-750
 Red beds, shale, lime 750-2022
 Shale, lime, dolomite 2022-4389

Name	Top	Bottom
Viola	4108	
Arbuckle	4290	

RELEASED

MAR 17 1987

FROM CONFIDENTIAL

CASING RECORD <input checked="" type="checkbox"/> new <input type="checkbox"/> used							
Report all strings set - conductor, surface, intermediate, production, etc.							
Purpose of string	size hole drilled	size casing set (In O.D.)	weight lbs/ft.	setting depth	type of cement	# sacks used	type and percent additives
Surface	12 1/4"	8 5/8"	23#	292' KB	60/40 Poz	250 sx	2% Gel, 3% CC
Production	7 7/8"	5 1/2"	14#	4397' KB	60/40 Poz (followed w/50 sx ASC)	150 sx	
PERFORATION RECORD				Acid, Fracture, Shot, Cement Squeeze Record			
shots per foot	specify footage of each interval perforated			(amount and kind of material used)			Depth
2	4156-76			Acidize w/32 bbl. 15% HCL, frac. w/30,000# sand and 765 bbl. cross linked gelled KCL			4156-76
TUBING RECORD					Liner Run <input type="checkbox"/> Yes <input checked="" type="checkbox"/> No		
Date of First Production		Producing method					
11/13/85		<input type="checkbox"/> flowing <input checked="" type="checkbox"/> pumping <input type="checkbox"/> gas lift <input type="checkbox"/> Other (explain)					
Estimated Production Per 24 Hours	Oil	Gas	Water	Gas-Oil Ratio	Gravity		
	10	30		3000/1	40°		
	Bbls	MCF	Bbls	CFPB			

Disposition of gas: vented
 sold
 used on lease

METHOD OF COMPLETION

open hole perforation
 other (specify) _____

PRODUCTION INTERVAL

4156-76

Dually completed.
 Commingled