



KANSAS CORPORATION COMMISSION 1086600  
OIL & GAS CONSERVATION DIVISION

Form ACO-4  
Form must be typed  
March 2009

APPLICATION FOR COMMINGLING OF **Commingling ID # CO091211**  
PRODUCTION (K.A.R. 82-3-123) OR FLUIDS (K.A.R. 82-3-123a)

OPERATOR: License # 33343  
Name: PostRock Midcontinent Production LLC  
Address 1: Oklahoma Tower  
Address 2: 210 Park Ave, Ste 2750  
City: OKLAHOMA CITY State: OK Zip: 73102 +  
Contact Person: CLARK EDWARDS  
Phone: (620) 432-4200

API No. 15 - 15-133-27197-00-00  
Spot Description: \_\_\_\_\_  
N2 S2 SW NW Sec. 29 Twp. 27 S. R. 19  East  West  
2265 Feet from  North /  South Line of Section  
660 Feet from  East /  West Line of Section  
County: Neosho  
Lease Name: MIH, MARIAM L. Well #: 29-1

1. Name and upper and lower limit of each production interval to be commingled:  
Formation: RIVERTON (Perfs): 941-945  
Formation: WEIR (Perfs): 781-783  
Formation: WEIR (Perfs): 769-771  
Formation: FLEMING (Perfs): 678-680  
Formation: CROWEBURG (Perfs): 643-646

2. Estimated amount of fluid production to be commingled from each interval:  
Formation: RIVERTON BOPD: 0 MCFPD: 0 BWPD: 0  
Formation: WEIR BOPD: 0 MCFPD: 0 BWPD: 0  
Formation: WEIR BOPD: 0 MCFPD: 0 BWPD: 0  
Formation: FLEMING BOPD: 0 MCFPD: 0 BWPD: 0  
Formation: CROWEBURG BOPD: 0 MCFPD: 0 BWPD: 0

3. Plat map showing the location of the subject well, all other wells on the subject lease, and all wells on offsetting leases within a 1/2 mile radius of the subject well, and for each well the names and addresses of the lessee of record or operator.

4. Signed certificate showing service of the application and affidavit of publication as required in K.A.R. 82-3-135a.

**For Commingling of PRODUCTION ONLY, include the following:**

- 5. Wireline log of subject well. Previously Filed with ACO-1:  Yes  No
- 6. Complete Form ACO-1 (Well Completion form) for the subject well.

**For Commingling of FLUIDS ONLY, include the following:**

- 7. Well construction diagram of subject well.
- 8. Any available water chemistry data demonstrating the compatibility of the fluids to be commingled.

**AFFIDAVIT:** I am the affiant and hereby certify that to the best of my current information, knowledge and personal belief, this request for commingling is true and proper and I have no information or knowledge, which is inconsistent with the information supplied in this application.

Submitted Electronically

**KCC Office Use Only**  
 Denied  Approved  
15-Day Periods Ends: 10/5/2012  
Approved By: Rick Hestermann Date: 10/05/2012

Protests may be filed by any party having a valid interest in the application. Protests must be in writing and comply with K.A.R. 82-3-135b and must be filed within 15 days of publication of the notice of application.

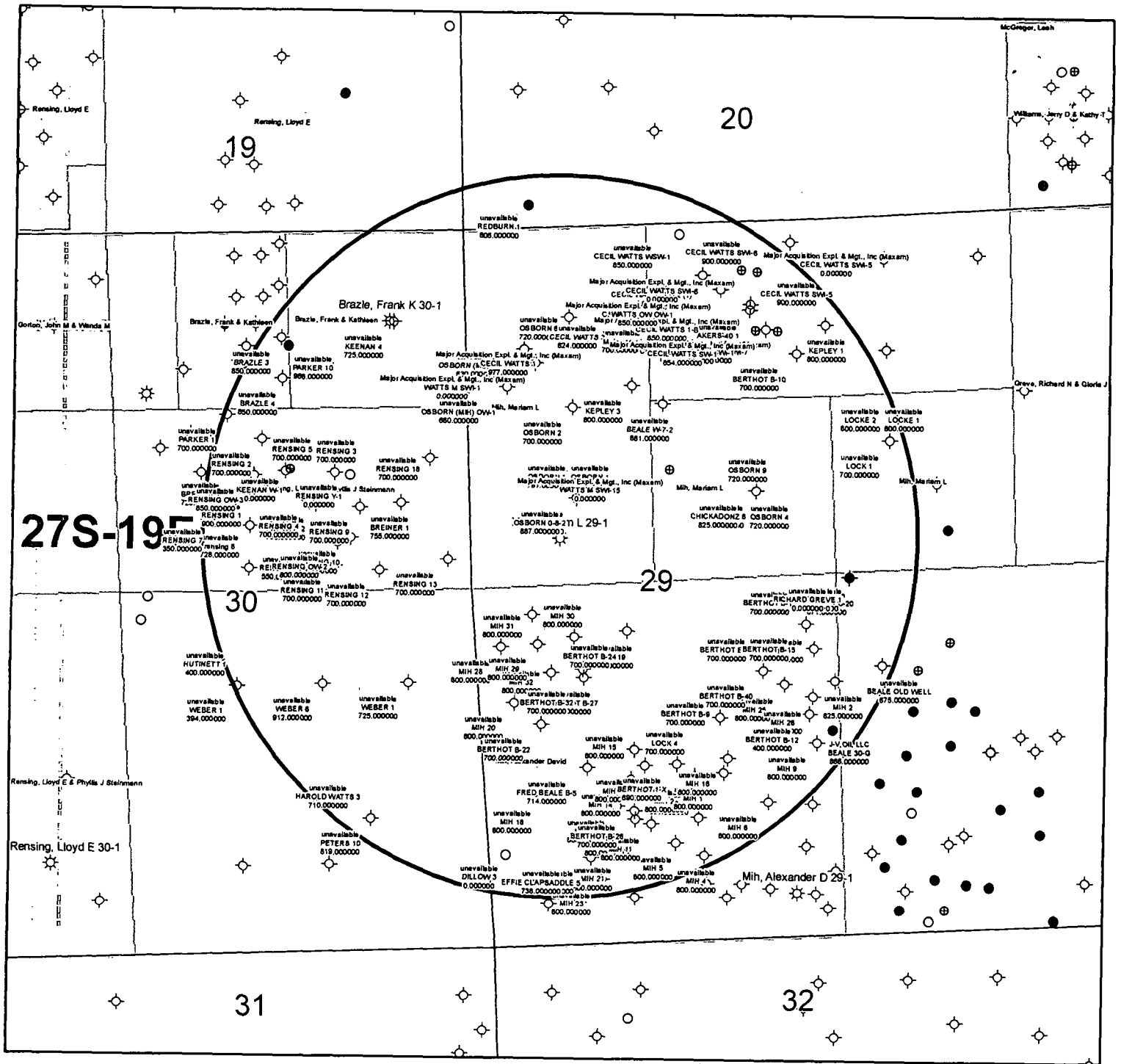

**KGS STATUS**

◇	DA/P A
⊕	EOR
⊛	GAS
△	INJ/SWD
●	OIL
⊛	OIL/GAS
○	OTHER

Mih, Mariam L 29-1  
 29-27S-19E  
 1" = 1,000'

**CONFIDENTIAL**

**KANSAS CORPORATION COMMISSION  
OIL & GAS CONSERVATION DIVISION  
WELL COMPLETION FORM**

**ORIGINAL**

*3/20/08*

Form ACO-1  
September 1999  
Form Must Be Typed

**WELL HISTORY - DESCRIPTION OF WELL & LEASE**

Operator: License # 33344  
Name: Quest Cherokee, LLC  
Address: 211 W. 14th Street  
City/State/Zip: Chanute, KS 66720  
Purchaser: Bluestem Pipeline, LLC  
Operator Contact Person: Jennifer R. Ammann  
Phone: (620) 431-9500  
Contractor: Name: TXD  
License: 33837

**CONFIDENTIAL**  
*JAN 20 2008*  
**KCC**

Wellsite Geologist: Ken Recco  
Designate Type of Completion:  
 New Well     Re-Entry     Workover  
 Oil     SWD     SIOW     Temp. Abd.  
 Gas     ENHR     SIGW  
 Dry     Other (Core, WSW, Expl., Cathodic, etc)

If Workover/Re-entry: Old Well Info as follows:  
Operator: \_\_\_\_\_  
Well Name: \_\_\_\_\_  
Original Comp. Date: \_\_\_\_\_ Original Total Depth: \_\_\_\_\_  
 Deepening     Re-perf.     Conv. to Enhr/SWD  
 Plug Back     Plug Back Total Depth  
 Commingled    Docket No. \_\_\_\_\_  
 Dual Completion    Docket No. \_\_\_\_\_  
 Other (SWD or Enhr.?)    Docket No. \_\_\_\_\_  

<u>11-27-07</u>	<u>12-01-07</u>	<u>12-03-07</u>
Spud Date or Recompletion Date	Date Reached TD	Completion Date or Recompletion Date

API No. 15-133-27197-0000  
County: Neosho  
SW NW Sec. 29 Twp. 27 S. R. 19  East  West  
2265 feet from S /  (circle one) Line of Section  
660 feet from E /  (circle one) Line of Section  
Footages Calculated from Nearest Outside Section Corner:  
(circle one) NE SE  NW SW  
Lease Name: Mih, Mariam L. Well #: 29-1  
Field Name: Cherokee Basin CBM  
Producing Formation: Multiple  
Elevation: Ground: 953 Kelly Bushing: n/a  
Total Depth: 1066 Plug Back Total Depth: 1055  
Amount of Surface Pipe Set and Cemented at 21 Feet  
Multiple Stage Cementing Collar Used?  Yes  No  
If yes, show depth set \_\_\_\_\_ Feet  
If Alternate II completion, cement circulated from 1055  
feet depth to surface w/ 165 sx cmf.

Drilling Fluid Management Plan ATTN: NJ 4-2809  
(Data must be collected from the Reserve Pit)  
Chloride content \_\_\_\_\_ ppm Fluid volume \_\_\_\_\_ bbls  
Dewatering method used \_\_\_\_\_  
Location of fluid disposal if hauled offsite: \_\_\_\_\_  
Operator Name: \_\_\_\_\_  
Lease Name: \_\_\_\_\_ License No.: \_\_\_\_\_  
Quarter \_\_\_\_\_ Sec. \_\_\_\_\_ Twp. \_\_\_\_\_ S. R. \_\_\_\_\_  East  West  
County: \_\_\_\_\_ Docket No.: \_\_\_\_\_

**INSTRUCTIONS:** An original and two copies of this form shall be filed with the Kansas Corporation Commission, 130 S. Market - Room 2078, Wichita, Kansas 67202, within 120 days of the spud date, recompletion, workover or conversion of a well. Rule 82-3-130, 82-3-106 and 82-3-107 apply. Information of side two of this form will be held confidential for a period of 12 months if requested in writing and submitted with the form (see rule 82-3-107 for confidentiality in excess of 12 months). One copy of all wireline logs and geologist well report shall be attached with this form. ALL CEMENTING TICKETS MUST BE ATTACHED. Submit CP-4 form with all plugged wells. Submit CP-111 form with all temporarily abandoned wells.

All requirements of the statutes, rules and regulations promulgated to regulate the oil and gas industry have been fully complied with and the statements herein are complete and correct to the best of my knowledge.

Signature: Jennifer R. Ammann  
Title: New Well Development Coordinator Date: 3/20/08  
Subscribed and sworn to before me this 20<sup>th</sup> day of March  
20 08  
Notary Public: Jerra Klauman  
Date Commission Expires: 8-4-2010

**TERRA KLAUMAN**  
Notary Public - State of Kansas  
My Appt. Expires 8-4-2010

**KCC Office Use ONLY**

Letter of Confidentiality Received  
 If Denied, Yes  Date: \_\_\_\_\_  
 Wireline Log Received  
 Geologist Report Received  
 UIC Distribution

**RECEIVED**  
KANSAS CORPORATION COMMISSION  
**MAR 24 2008**  
CONSERVATION DIVISION  
WICHITA, KS

ORIGINAL

Side Two

Operator Name: Quest Cherokee, LLC Lease Name: Mih, Mariam L. Well #: 29-1
Sec. 29 Twp. 27 S. R. 19 East West County: Neosho

INSTRUCTIONS: Show important tops and base of formations penetrated. Detail all cores. Report all final copies of drill stems tests giving interval tested, time tool open and closed, flowing and shut-in pressures, whether shut-in pressure reached static level, hydrostatic pressures, bottom hole temperature, fluid recovery, and flow rates if gas to surface test, along with final chart(s). Attach extra sheet if more space is needed. Attach copy of all Electric Wireline Logs surveyed. Attach final geological well site report.

Drill Stem Tests Taken Yes No
Samples Sent to Geological Survey Yes No
Cores Taken Yes No
Electric Log Run Yes No
List All E. Logs Run:

Log Formation (Top), Depth and Datum Sample
Name Top Datum
See attached

Compensated Density Neutron Log
Dual Induction Log

CASING RECORD table with columns: Purpose of String, Size Hole Drilled, Size Casing Set (In O.D.), Weight Lbs. / FL, Setting Depth, Type of Cement, # Sacks Used, Type and Percent Additives. Rows for Surface and Production.

ADDITIONAL CEMENTING / SQUEEZE RECORD table with columns: Purpose, Depth Top Bottom, Type of Cement, #Sacks Used, Type and Percent Additives.

PERFORATION RECORD - Bridge Plugs Set/Type table with columns: Shots Per Foot, Specify Footage of Each Interval Perforated, Acid, Fracture, Shot, Cement Squeeze Record (Amount and Kind of Material Used), Depth.

TUBING RECORD table with columns: Size, Set At, Packer At, Liner Run.

Date of First, Resumerd Production, SWD or Enhr. Producing Method table with columns: Date, Flowing, Pumping, Gas Lift, Other (Explain).

Estimated Production Per 24 Hours table with columns: Oil Bbls., Gas Mcf, Water Bbls., Gas-Oil Ratio, Gravity.

Disposition of Gas METHOD OF COMPLETION Production Interval
Vented Sold Used on Lease Open Hole Perf. Dually Comp. Commingled
Other (Specify)

A	B	C	D	E	F	G	H	I	J	K	
1 Produced Fluids #		1	2	3	4	5					
2 Parameters	Units	Input	Input	Input	Input	Input				Click	
3 Select the brines	Select fluid by checking the box(es),	<input type="checkbox"/>	<input type="checkbox"/>	<input type="checkbox"/>	<input type="checkbox"/>	<input type="checkbox"/>	Mixed brine:	Click here to run SSP  Goal Seek SSP		Click	
4 Sample ID							Cell H28 is			Click	
5 Date		3/19/2012	3/4/2012	3/14/2012	1/20/2012	1/20/2012	STP calc. pH.			Click	
6 Operator	Row 3	PostRock	PostRock	PostRock	PostRock	PostRock	Cells H35-38 are used in mixed brines calculations.			Click	
7 Well Name		Ward Feed	Ward Feed	Clinesmith	Clinesmith	Clinesmith				Click	
8 Location		#34-1	#4-1	#5-4	#1	#2			Click		
9 Field		CBM	CBM	Barlies	Barlies	Barlies					
10 Na <sup>+</sup>	(mg/l)*	19,433.00	27,381.00	26,534.00	25,689.00	24,220.00	24654.20	Initial(BH)	Final(WH)	S/SR (Final-Initial)	
11 K <sup>+</sup> (if not known =0)	(mg/l)						0.00	Saturation Index values			
12 Mg <sup>2+</sup>	(mg/l)	1,096.00	872.00	1,200.00	953.00	858.00	995.91	Calcite			
13 Ca <sup>2+</sup>	(mg/l)	1,836.00	2,452.00	2,044.00	1,920.00	1,948.00	2040.23	-0.73	-0.60	0.13	
14 Sr <sup>2+</sup>	(mg/l)						0.00	Barite			
15 Ba <sup>2+</sup>	(mg/l)						0.00				
16 Fe <sup>2+</sup>	(mg/l)	40.00	21.00	18.00	82.00	90.00	50.21	Halite			
17 Zn <sup>2+</sup>	(mg/l)						0.00	-1.77	-1.80	-0.03	
18 Pb <sup>2+</sup>	(mg/l)						0.00	Gypsum			
19 Cl <sup>-</sup>	(mg/l)	36,299.00	48,965.00	47,874.00	45,632.00	43,147.00	44,388.44	-3.19	-3.18	0.00	
20 SO <sub>4</sub> <sup>2-</sup>	(mg/l)	1.00	1.00	8.00	1.00	1.00	2.40	Hemihydrate			
21 F <sup>-</sup>	(mg/l)						0.00	-3.96	-3.90	0.06	
22 Br <sup>-</sup>	(mg/l)						0.00	Anhydrite			
23 SiO <sub>2</sub>	(mg/l) SiO <sub>2</sub>						0.00	-3.47	-3.36	0.12	
24 HCO <sub>3</sub> Alkalinity**	(mg/l as HCO <sub>3</sub> )	190.00	234.00	259.00	268.00	254.00	241.03	Celestite			
25 CO <sub>3</sub> Alkalinity	(mg/l as CO <sub>3</sub> )										
26 Carboxylic acids**	(mg/l)						0.00	Iron Sulfide			
27 Ammonia	(mg/L) NH <sub>3</sub>						0.00	-0.16	-0.22	-0.06	
28 Borate	(mg/L) H <sub>3</sub> BO <sub>3</sub>						0.00	Zinc Sulfide			
29 TDS (Measured)	(mg/l)						72781				
30 Calc. Density (STP)	(g/ml)	1.038	1.051	1.050	1.048	1.045	1.047	Calcium fluoride			
31 CO <sub>2</sub> Gas Analysis	(%)	19.97	18.76	22.41	35.53	33.79	26.16				
32 H <sub>2</sub> S Gas Analysis***	(%)	0.0289	0.0292	0.0296	0.0306	0.0151	0.0269	Iron Carbonate			
33 Total H <sub>2</sub> Saq	(mgH <sub>2</sub> S/l)	1.00	1.00	1.00	1.00	0.50	0.90	-0.74	-0.51	0.23	
34 pH, measured (STP)	pH	5.67	5.76	5.72	5.54	5.55	5.63	Inhibitor needed (mg/L)			
	Choose one option to calculate SI?	0-CO <sub>2</sub> %+Alk. 1-pH+Alk. 2-CO <sub>2</sub> %+pH						Calcite	NTMP		
35		0	0	0	0	0					
36 Gas/day(Thousand cf/day)	(Mc/D)						0	0.00	0.00		
37 Oil/Day	(B/D)	0	0	1	1	1	4	Barite	BHPMP		
38 Water/Day	(B/D)	100	100	100	100	100	500	0.00	0.00		
39	For mixed brines, enter values for temperatures and pressures in Cells (H40-H43)						(Enter H40-H43)		pH		
40 Initial T	(F)	66.0	71.0	70.0	41.0	49.0	60.0	5.69	5.60		
41 Final T	(F)	66.0	71.0	70.0	41.0	49.0	89.0	Viscosity (CentiPoise)			
42 Initial P	(psia)	25.0	25.0	25.0	25.0	25.0	25.0	1.196	0.826		
43 Final P	(psia)	25.0	25.0	25.0	25.0	25.0	120.0	Heat Capacity (cal/ml/C)			
44 Use TP on Calcite sheet?	1-Yes;0-No							0.955	0.959		
45 API Oil Grav.	API grav.						30.00	Inhibitor needed (mg/L)			
46 Gas Sp.Grav.	Sp.Grav.						0.60	Gypsum	HDTMP		
47 MeOH/Day	(B/D)	0					0	0.00	0.00		
48 MEG/Day	(B/D)	0					0	Anhydrite	HDTMP		
49 Conc. Multiplier								0.00	0.00		
50 H <sup>+</sup> (Strong acid) <sup>†</sup>	(N)										
51 OH <sup>-</sup> (Strong base) <sup>†</sup>	(N)										
52	Quality Control Checks at STP:										
53 H <sub>2</sub> S Gas	(%)										
54 Total H <sub>2</sub> Saq (STP)	(mgH <sub>2</sub> S/l)										
55 pH Calculated	(pH)										
56 PCO <sub>2</sub> Calculated	(%)										
57 Alkalinity Calculated	(mg/l) as HCO <sub>3</sub>										
58 ECations=	(equiv./l)										
59 EAnions=	(equiv./l)										
60 Calc TDS=	(mg/l)										
61 Inhibitor Selection	Input	Unit	#	Inhibitor	Unit Converter (From metric to English)			Value			
62 Protection Time	120	min	1	NTMP	From Unit	Value	To Unit	Value			
63 Have ScaleSoft/Pitzer			2	BHPMP	°C	80	°F	176			
64 pick inhibitor for you?	1	1-Yes;0-No	3	PAA	m <sup>3</sup>	100	ft <sup>3</sup>	3,531			
65 If No, inhibitor # is:	4	#	4	DTPMP	m <sup>3</sup>	100	bb(42 US gal)	629			
66 If you select Mixed,			5	PPCA	MPa	1,000	psia	145,074			
67 1 <sup>st</sup> inhibitor # is:	1	#	6	SPA	Bar	496	psia	7,194			
68 % of 1 <sup>st</sup> inhibitor is:	50	%	7	HEDP	Torr	10,000	psia	193			
69 2 <sup>nd</sup> inhibitor # is:	2	#	8	HDTMP	Gal	10,000	bb(42 US gal)	238			
70 Display act. coeffs?	0	1-Yes;0-No	9	Average	Liters	10,000	bb(42 US gal)	63			
71			10	Mixed							

## Saturation Index Calculations

*Champion Technologies, Inc.*

(Based on the Tomson-Oddo Model)

**Brine 1:** Ward Feed Yard 34-1

**Brine 2:** Ward Feed Yard 4-1

**Brine 3:** Clinesmith 5-4

**Brine 4:** Clinesmith 1

**Brine 5:** Clinesmith 2

Component (mg/L)	Ratio					
	20% Brine 1	20% Brine 2	20% Brine 3	20% Brine 4	20 Brine 5	Mixed Brine
Calcium	1836	2452	2044	1920	1948	1952
Magnesium	1096	872	1200	953	858	865
Barium	0	0	0	0	0	0
Strontium	0	0	0	0	0	0
Bicarbonate	190	234	259	268	254	253
Sulfate	1	1	8	1	1	1
Chloride	36299	48965	47874	45632	43147	43206
CO <sub>2</sub> in Brine	246	220	264	422	405	401
Ionic Strength	1.12	1.48	1.46	1.38	1.31	1.31
Temperature (°F)	89	89	89	89	89	89
Pressure (psia)	50	50	120	120	120	119

### Saturation Index

Calcite	-1.71	-1.41	-1.48	-1.68	-1.69	-1.69
Gypsum	-3.71	-3.64	-2.82	-3.73	-3.72	-3.69
Hemihydrate	-3.70	-3.65	-2.83	-3.74	-3.71	-3.69
Anhydrite	-3.89	-3.79	-2.97	-3.89	-3.88	-3.85
Barite	N/A	N/A	N/A	N/A	N/A	N/A
Celestite	N/A	N/A	N/A	N/A	N/A	N/A

### PTB

Calcite	N/A	N/A	N/A	N/A	N/A	N/A
Gypsum	N/A	N/A	N/A	N/A	N/A	N/A
Hemihydrate	N/A	N/A	N/A	N/A	N/A	N/A
Anhydrite	N/A	N/A	N/A	N/A	N/A	N/A
Barite	N/A	N/A	N/A	N/A	N/A	N/A
Celestite	N/A	N/A	N/A	N/A	N/A	N/A



## Wellbore Schematic

**WELL:** Mih, Miriam L 29-1  
**SSI:** 624240  
**API:** 15-133-27197-00-00  
**LOCATION:** SW NW Sec. 29-27S-19E  
**COUNTY:** Neosho  
**STATE:** Kansas

<b>Casing</b>	8.625" @ 21' 4.5" 10.5# J-55, 4.05" ID w/ 0.0159 bbl/ft capacity @ 1055'
<b>Perforations</b>	Original Perfs: 1/22/2008 - Riverton 941-945 (17) - Weir 781-783 (9) - Weir 769-771 (9) - Fleming 678-680 (9) - Croweburg 643-646 (13) - Bevier 621-623 (9) - Mulky 540-544 (17) - Summit 528-532 (17)
<b>Completions</b>	Spud Date: 11/28/2007 Completion date: 1/22/2008 <b>Riverton:</b> - 5700# 20/40 - 400 gal 15% - 546 bbls - 10 bpm <b>Weir/Flem/Crowe/Bevier:</b> - 2800# 20/40 - 400 gal 15% - 546 bbls - 14 bpm <b>Mulky/Summit:</b> - 5600# 20/40 - 300 gal 15% - 646 bbls - 14 bpm

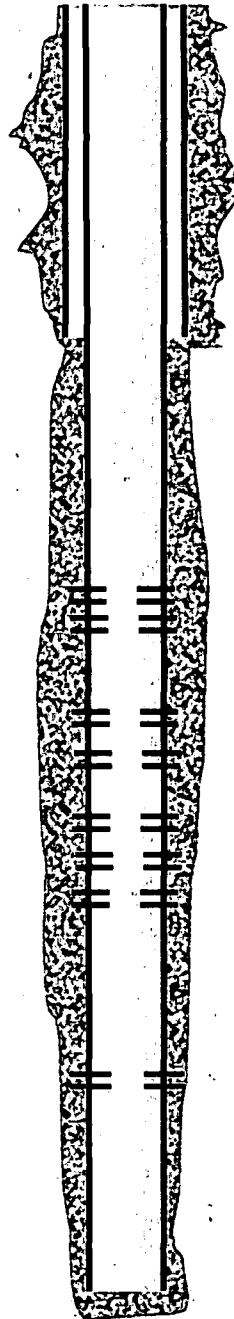

TOC - Surface

8.625" @ 21'

4.5" 10.5# @ 1055'  
165 sks cement

TD - 1066'





**Affidavit of Notice Served**

Re: Application for: APPLICATION FOR COMMINGLING OF PRODUCTION OR FLUIDS ACO-4

Well Name: MIH, MARIAM L 29-1 Legal Location: SWNW S29-T27S-R19E

The undersigned hereby certifies that he / she is a duly authorized agent for the applicant, and that on the day 18<sup>th</sup> of SEPTEMBER, 2012, a true and correct copy of the application referenced above was delivered or mailed to the following parties:

*Note: A copy of this affidavit must be served as a part of the application.*

Name	Address (Attach additional sheets if necessary)
J-V OIL, LLC	PO BOX 151, CHANUTE, KS 66720
MAJOR ACQUISITION EXPL. & MGT., INC (MAXAM)	908 BRIDGE STREET, HUMBOLDT, KS 66748
SEE ATTACHED	

I further attest that notice of the filing of this application was published in the THE CHANUTE TRIBUNE, the official county publication of NEOSHO county. A copy of the affidavit of this publication is attached.

Signed this 18<sup>th</sup> day of SEPTEMBER, 2012

[Signature]  
Applicant or Duly Authorized Agent

Subscribed and sworn to before me this 18<sup>th</sup> day of SEPTEMBER, 2012



[Signature]  
Notary Public

My Commission Expires: July 20, 2016

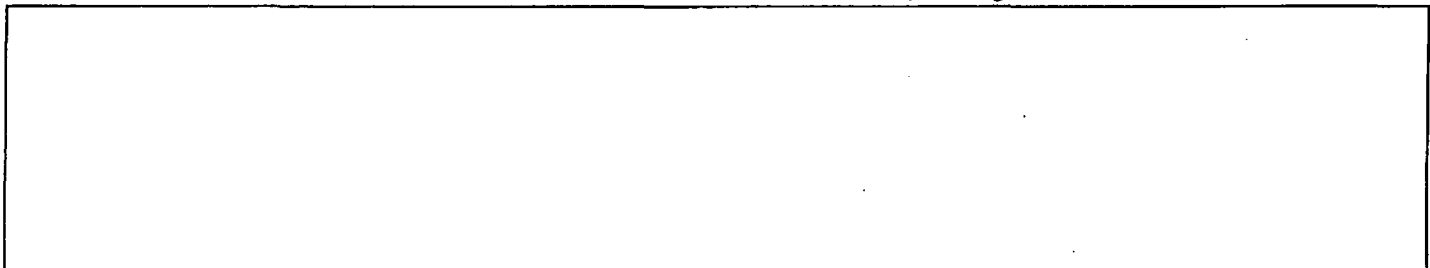

**MIH, MARIAM L 29-1**

**20-27S-19E**

**SW4** David Orr  
(portion) 10280 210th Rd  
Chanute, KS 66720

**29-27S-19E**

**SE4** Beale Family Living Trust  
(portion) 2301 Tipps Rd  
Crossroads, TX 76277

**NE4NW4** Cecil E. Watts and Kathleen A. Watts  
501 E 6th Street  
Chanute, KS 66720

**NW4NE4** Paul D. M. Cadwallader and Linda M, Cadwallader  
10625 210th Rd  
Chanute, KS 66720

**30-27S-19E**

**SE4 less** Cecil E. Watts and Kathleen A. Watts  
501 E 6th Street  
Chanute, KS 66720

**Tract in SE4** William Clyde Davis  
20235 Jackson Rd  
Chanute, KS 66720

MIH, MARIAM L 29-1-APPLICATION FOR COMMINGLING OF PRODUCTION OR FLUIDS

[ ]

[ ]

Offset Operators, Unleased Mineral Owners and Landowners acreage  
(Attach additional sheets if necessary)

Name:

Legal Description of Leasehold:

SEE ATTACHED

[Lined area for Name and Legal Description of Leasehold]

I hereby certify that the statements made herein are true and correct to the best of my knowledge and belief.

*Jess L. Martin*  
\_\_\_\_\_  
Applicant or Duty Authorized Agent

Subscribed and sworn before me this 18<sup>th</sup> day of SEPTEMBER, 2012



*Jennifer R. Beal*  
\_\_\_\_\_  
Notary Public

My Commission Expires: July 20, 2016

[Large empty rectangular box]

**MIH, MARIAM L 29-1**

<b>LEGAL LOCATION</b>	<b>SPOT</b>	<b>CURR_OPERA</b>
S29-T27S-R19E	SE NE SW	J-V Oil, LLC
S29-T27S-R19E		Major Acquisition Expl. & Mgt., Inc (Maxam)
S29-T27S-R19E	C NE NW	Major Acquisition Expl. & Mgt., Inc (Maxam)
S29-T27S-R19E		Major Acquisition Expl. & Mgt., Inc (Maxam)
S29-T27S-R19E	SE NE NW	Major Acquisition Expl. & Mgt., Inc (Maxam)
S29-T27S-R19E	SE NE NW	Major Acquisition Expl. & Mgt., Inc (Maxam)
S29-T27S-R19E	NE NE NW	Major Acquisition Expl. & Mgt., Inc (Maxam)
S29-T27S-R19E	N2 NE NW	Major Acquisition Expl. & Mgt., Inc (Maxam)
S29-T27S-R19E	N2 NE NW	Major Acquisition Expl. & Mgt., Inc (Maxam)
S29-T27S-R19E	SW NW NW	Major Acquisition Expl. & Mgt., Inc (Maxam)
S29-T27S-R19E	N2 S2 NW	Major Acquisition Expl. & Mgt., Inc (Maxam)

MIH, MARIAM L 29-1

**20-27S-19E**

SW4  
(portion)            David Orr  
                         10280 210th Rd  
                         Chanute, KS 66720

**29-27S-19E**

SE4  
(portion)            Beale Family Living Trust  
                         2301 Tipps Rd  
                         Crossroads, TX.76277

NE4NW4            Cecil E. Watts and Kathleen A. Watts  
                         501 E 6th Street  
                         Chanute, KS 66720

NW4NE4            Paul D. M. Cadwallader and Linda M, Cadwallader  
                         10625 210th Rd  
                         Chanute, KS 66720

**30-27S-19E**

SE4 less            Cecil E. Watts and Kathleen A. Watts  
                         501 E 6th Street  
                         Chanute, KS 66720

Tract in SE4        William Clyde Davis  
                         20235 Jackson Rd  
                         Chanute, KS 66720

BEFORE THE STATE CORPORATION COMMISSION  
OF THE STATE OF KANSAS  
**NOTICE OF FILING APPLICATION**

RE: In the Matter of **Postrock Midcontinent Production, LLC**  
Application for Commingling of Production in the Mlh, Marlam L 29-1 located in Neosho County, Kansas.

TO: All Oil & Gas Producers, Unleased Mineral Interest Owners, Landowners, and all persons whomsoever concerned.

You, and each of you, are hereby notified that **Postrock Midcontinent Production, LLC** has filed an application to commingle the **Riverton, Weir, Fleming, Croweburg, Bevier, Mulky, Summit and Bartlesville** producing formations at the Mlh, Marlam L 29-1, located in the SW NW, S29-T27S-R19E, Approximately 2265 FNL & 660 FWL, Neosho County, Kansas.

Any persons who object to or protest this application shall be required to file their objections or protest with the Conservation Division of the State Corporation Commission of the State of Kansas within fifteen (15) days from the date of this publication. These protests shall be filed pursuant to Commission regulations and must state specific reasons why granting the application may cause waste, violate correlative rights or pollute the natural resources of the State of Kansas.

All persons interested or concerned shall take notice of the foregoing and shall govern themselves accordingly. All person and/or companies wishing to protest this application are required to file a written protest with the Conservation Division of the Kansas Oil and Gas Commission.

Upon the receipt of any protest, the Commission will convene a hearing and protestants will be expected to enter an appearance either through proper legal counsel or as individuals, appearing on their own behalf.

**Postrock Midcontinent Production, LLC**  
210 Park Avenue, Suite 2750  
Oklahoma City, Oklahoma 73102  
(405) 680-7704

A COPY OF THE AFFIDAVIT OF PUBLICATION MUST ACCOMPANY ALL APPLICATIONS

# Affidavit of Publication

STATE OF KANSAS, NEOSHO COUNTY, ss:  
*Rhonda Howerter*, being first duly sworn, deposes and says: That *she* is *Classified Manager* of *THE CHANUTE TRIBUNE*, a daily newspaper printed in the State of Kansas, and published in and of general circulation in Neosho County, Kansas, with a general paid circulation on a daily basis in Neosho County, Kansas, and that said newspaper is not a trade, religious or fraternal publication.

Said newspaper is a daily published at least weekly 50 times a year: has been so published continuously and uninterruptedly in said county and state for a period of more than five years prior to the first publication of said notice; and has been admitted at the post office of Chanute, in said county as second class matter.

That the attached notice is a true copy thereof and was published in the regular and entire issue of said newspaper for 1 consecutive time, the first publication thereof being made as aforesaid on the 19 day of September 2012, with subsequent publications being made on the following dates:

\_\_\_\_\_, 2012 \_\_\_\_\_, 2012

\_\_\_\_\_, 2012 \_\_\_\_\_, 2012

*Rhonda Howerter*

Subscribed and sworn to and before me this 19 day of September, 2012

*[Signature]*  
Notary Public

My commission expires: January 9, 2015

Printer's Fee ..... \$ 69.18

Affidavit, Notary's Fee ..... \$ 3.00

Additional Copies ..... \$ \_\_\_\_\_

Total Publication Fees ..... \$ 72.18

**SHANNA L. GUIOT**  
Notary Public - State of Kansas  
My Appt. Expires 1-9-15

**AFFIDAVIT**

STATE OF KANSAS

\  
- SS.  
/

County of Sedgwick

Mark Fletchall, of lawful age, being first duly sworn, deposeth and saith: That he is Record Clerk of The Wichita Eagle, a daily newspaper published in the City of Wichita, County of Sedgwick, State of Kansas, and having a general paid circulation on a daily basis in said County, which said newspaper has been continuously and uninterruptedly published in said County for more than one year prior to the first publication of the notice hereinafter mentioned, and which said newspaper has been entered as second class mail matter at the United States Post Office in Wichita, Kansas, and which said newspaper is not a trade, religious or fraternal publication and that a notice of a true copy is hereto attached was published in the regular and entire Morning issue of said The Wichita Eagle for 1 issues, that the first publication of said notice was

made as aforesaid on the 20th of

September A.D. 2012, with

subsequent publications being made on the following dates:

And affiant further says that he has personal knowledge of the statements above set forth and that they are true.

*Mark Fletchall*

Subscribed and sworn to before me this

20th day of September, 2012

**PENNY L. CASE**  
Notary Public, State of Kansas  
My Appt. Expires 6/28/2017

*Penny L. Case*  
Notary Public Sedgwick County, Kansas

Printer's Fee : \$139.60

**LEGAL PUBLICATION**  
PUBLISHED IN THE WICHITA EAGLE  
SEPTEMBER 20, 2012 (3207643)  
BEFORE THE STATE CORPORATION COMMISSION  
OF THE STATE OF KANSAS  
**NOTICE OF FILING APPLICATION**  
RE: The Matter of Postrock  
Midcontinent Production, LLC  
Application for Commencing of  
Production in the Mth. Marlam  
L291 located in Neosho County,  
Kansas.  
TO: All Oil & Gas Producers, Unleased  
Mineral Interest Owners,  
Landowners, and all persons  
whomsoever concerned.  
You and each of you, are hereby  
notified that Postrock Midcontinent  
Production, LLC has filed an application  
to commence the R. Wagon, West, Fleming,  
Crowburg, Beaver, Milky, Summit and  
Barnesville producing formations at the  
Mth. Marlam L291 located in the SW  
NW, S29-T22-R19E, approximately 2245  
FMI & 460 FWL, Neosho County, Kansas.  
Any persons who object to or protest  
this application shall be required to file their  
objections or protest with the Conservation  
Division of the State Corporation  
Commission of the State of Kansas within  
fifteen (15) days from the date of this  
publication. These protests shall be filed  
pursuant to Commission regulations and  
must state specific reasons why granting  
the application may cause waste, violate  
correlative rights or pollute the natural  
resources of the State of Kansas.  
All persons interested or concerned  
shall take notice of the foregoing and shall  
govern themselves accordingly. All person  
and/or companies wishing to protest this  
application are required to file a written  
protest with the Conservation Division of  
the Kansas Oil and Gas Commission.  
Upon the receipt of any protest, the  
Commission will convene a hearing and  
protestants will be expected to enter an  
appearance either through proper legal  
counsel or as individuals appearing on  
their own behalf.  
Postrock Midcontinent Production, LLC  
210 Park Avenue, Suite 2750  
Oklahoma City, Oklahoma 73102  
(405) 640-7704  
**A COPY OF THE AFFIDAVIT OF PUBLICATION  
MUST ACCOMPANY ALL APPLICATIONS**

Conservation Division  
Finney State Office Building  
130 S. Market, Rm. 2078  
Wichita, KS 67202-3802



Phone: 316-337-6200  
Fax: 316-337-6211  
<http://kcc.ks.gov/>

Mark Sievers, Chairman  
Thomas E. Wright, Commissioner  
Shari Feist Albrecht, Commissioner

Sam Brownback, Governor

October 5, 2012

Clark Edwards  
PostRock Midcontinent Production LLC  
Oklahoma Tower  
210 Park Ave, Ste 2750  
Oklahoma City, OK 73102

RE: Approved Commingling CO091211  
Mih, Mariam L. 29-1, Sec. 29-T27S-R19E, Neosho County  
API No. 15-133-27197-00-00

Dear Mr. Edwards:

Your Application for Commingling (ACO-4) for the above described well, received by the KCC on September 26, 2012, has been reviewed and approved by the Kansas Corporation Commission (KCC) per K.A.R. 82-3-123. Notice was examined and found to be proper per K.A.R. 82-3-135a. No protest had been filed within the 15-day protest period.

Based upon the depth of the Riverton formation perforations, total oil production shall not exceed 100 BOPD and total gas production shall not exceed 50% of the absolute open flow (AOF).

**File form ACO-1 upon re-completion of the well to commingle.**

Commingling ID number CO091211 has been assigned to this approved application. Use this number for well completion reports (ACO-1) and other correspondence that may concern this approved commingling.

Sincerely,

Rick Hestermann  
Production Department