

EFFECTIVE DATE: 7-28-91

FORM MUST BE TYPED
FORM C-1 4/90

State of Kansas
NOTICE OF INTENTION TO DRILL

FORM MUST BE SIGNED
ALL BLANKS MUST BE FILLED

Must be approved by the K.C.C. five (5) days prior to commencing well

Expected Spud Date: August 9 1991 110' W of N/2 N/2 SE/4 Sec 3 Twp 27 S, Rg 12 E East ☒ West ☒

OPERATOR: License # 5030
Name: Vess Oil Corporation
Address: 8100 E. 22nd St. N. Bldg. 300
City/State/Zip: Wichita, KS 67226
Contact Person: W.R. Horgan
Phone: 682-1537

CONTRACTOR: License # 6039
Name: L.D. Drilling, Inc.

Well Drilled For: Well Class: Type Equipment:
☒ Oil ☐ Inj ☒ Infield ☒ Mud Rotary
☐ Gas ☐ Storage ☐ Pool Ext. ☐ Air Rotary
☐ OWWO ☐ Disposal ☐ Wildcat ☐ Cable
☐ Seismic; ☐ # of Holes

If OWWO: old well information as follows:

Operator: _____
Well Name: _____
Comp. Date: _____ Old Total Depth _____

Directional, Deviated or Horizontal wellbore? ☒ yes ☐ no
If yes, total depth location: _____

2310 feet from South line of Section
1430 feet from East line of Section
(Note: Locate well on Section Plat on Reverse Side)

County: Pratt
Lease Name: Studer Well #: 3-3
Field Name: Stead South
Is this a Prorated field? ☐ yes ☒ no
Target Formation(s): Mississippi
Nearest lease or unit boundary: 330'
Ground Surface Elevation: 1880 feet MSL
Domestic well within 330 feet: ☐ yes ☒ no
Municipal well within one mile: ☐ yes ☒ no
Depth to bottom of fresh water: 200-210
Depth to bottom of usable water: 210-240
Surface Pipe by Alternate: ☒ 1 ☐ 2
Length of Surface Pipe Planned to be set: 280'
Length of Conductor pipe required: N/A
Projected Total Depth: 4300'
Formation at Total Depth: Miss
Water Source for Drilling Operations:
☒ well ☐ farm pond ☐ other
DWR Permit #: N/A
Will Cores Be Taken?: ☐ yes ☒ no
If yes, proposed zone: _____

AFFIDAVIT

The undersigned hereby affirms that the drilling, completion and eventual plugging of this well will comply with K.S.A. 55-101, et. seq.

It is agreed that the following minimum requirements will be met:

1. The appropriate district office shall be notified before setting surface pipe;
2. The minimum amount of surface pipe as specified above shall be set by circulating cement to the top; in all cases surface pipe shall be set through all unconsolidated materials plus a minimum of 20 feet into the underlying formation;
3. If the well is dry, a plugging proposal shall be submitted to the district office. An agreement between the operator and the district office on plug length and placement is necessary prior to plugging;
4. The appropriate district office will be notified before well is either plugged or production casing is cemented in;
5. If an Alternate II completion, production pipe shall be cemented from below any usable water to surface within 120 days of spud date. In all cases, notify district office prior to any cementing.

I hereby certify that the statements made herein are true and to the best of my knowledge and belief.

Date: 7/22/91 Signature of Operator or Agent: W.R. Horgan Title: Operations Manager

RECEIVED
STATE CORPORATION COMMISSION

JUL 23 1991

CONSERVATION DIVISION
Wichita, Kansas

FOR KCC USE:

API # 15- 151-22054-00-00
Conductor pipe required None feet
Minimum surface pipe required 260 feet per Alt (1)
Approved by: MAW 7-23-91
EFFECTIVE DATE: 7-28-91
This authorization expires: 7-23-92
(This authorization void if drilling not started within 6 months of effective date.)
Spud date: _____ Agent: _____

REMEMBER TO:

- File Drill Pit Application (form CDP-1) with Intent to Drill;
- File Completion Form ACO-1 within 120 days of spud date;
- File acreage attribution plat according to field proration orders;
- Notify appropriate district office 48 hours prior to workover or re-entry;
- Submit plugging report (CP-4) after plugging is completed;
- Obtain written approval before disposing or injecting salt water.

PLAT OF ACREAGE ATTRIBUTABLE TO A WELL

State Corporation Commission, Conservation Division
200 Colorado Derby Bldg. Wichita, Kansas 67202

OPERATOR Vess Oil Corporation LOCATION OF WELL:
LEASE Studer 2310' feet north of SE corner
WELL NUMBER 3-3 1430' feet west of SE corner
FIELD Stead South Sec. 3 T 27 R 12 XE/W
COUNTY Pratt
NO. OF ACRES ATTRIBUTABLE TO WELL 10 IS SECTION X REGULAR IRREGULAR?
DESCRIPTION OF ACREAGE 10 acres IF IRREGULAR, LOCATE WELL FROM NEAREST
surrounding well CORNER BOUNDARY.

NOTE: If plat depicted is insufficient for your circumstances, you may attach your own scaled or surveyed plat.

PLAT

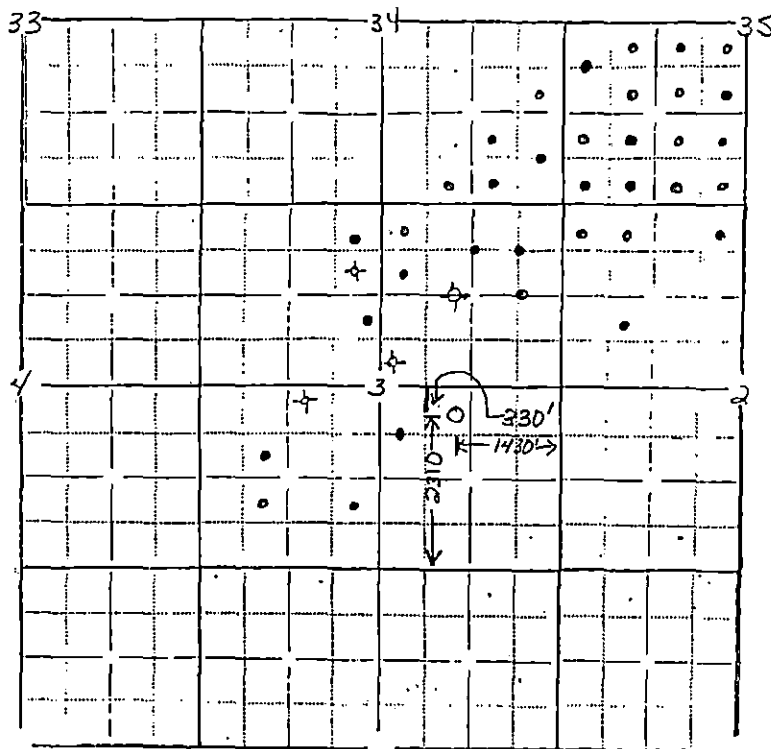

In plotting the proposed location of the well, you must show:

- 1) The manner in which you are using the depicted plat by identifying section lines, i.e. 1 section, 1 section with 8 surrounding partial sections, 4 sections, 16 sections, etc.;
- 2) the well's location relative to the location of other wells producing from the same common source of supply in adjoining drilling units, pursuant to K.A.R. 82-3-108, 82-3-207, 82-3-312, or special orders of the Commission;
- 3) the distance of the proposed drilling location from the section's east and south lines; and
- 4) the distance to the nearest lease or unit boundary line.

I hereby certify that the statements made herein are true and to the best of my knowledge and belief.

Signature of Operator or Agent W R Hodge

Date 7/22/91 Title Operations Manager