

FOR KCC USE:

FORM C-1 7/91

FORM MUST BE TYPED

FORM MUST BE SIGNED

ALL BLANKS MUST BE FILLED

EFFECTIVE DATE: 6-17-97

State of Kansas

NOTICE OF INTENTION TO DRILL

Must be approved by the K.C.C. five (5) days prior to commencing well.

DISTRICT # 1  
SGA? Yes...NoExpected Spud Date June 30 1997  
month day yearSpot  
APP. C SE Sec 24 Twp 27 S, Rg 11 East  
WestOPERATOR: License # 5278  
Name: Northern Natural Gas  
Address: PO Box 178  
City/State/Zip: Cunningham, KS 67035  
Contact Person: Dan Dobbins  
Phone: 316-257-5146CONTRACTOR: License # 5893  
Name: Pratt Well Service..... 1430 feet from South / North line of Section  
..... 1290 feet from East / West line of Section  
IS SECTION X REGULAR IRREGULAR(NOTE: Locate well on the Section Plat on Reverse Side)  
County: Pratt  
Lease Name: Steffen Well #: 24-32  
Field Name: Cunningham  
Is this a Prorated/Spaced Field? .... yes X no  
Target Formation(s): Simpson  
Nearest lease or unit boundary: 1200 ft  
Ground Surface Elevation: 1721 feet MSL  
Water well within one-quarter mile: ... X yes .... no  
Public water supply well within one mile: .... yes X .. no  
Depth to bottom of fresh water: ... 120 ft  
Depth to bottom of usable water: ... 300 ft 200  
Surface Pipe by Alternate: ... X 1 ... 2  
Length of Surface Pipe Planned to be set: ... 1516  
Length of Conductor pipe required: ... 132  
Projected Total Depth: ... 4315  
Formation at Total Depth: Simpson  
Water Source for Drilling Operations:  
X well .... farm pond .... other

Well Drilled For: Well Class: Type Equipment:

... Oil ... Enh Rec X Infield ... Mud Rotary  
X Gas X Storage ... Pool Ext. ... Air Rotary  
X OWMO ... Disposal ... Wildcat ... CableX Seismic; ... # of Holes ... Other  
X Other Deepen well to Simpson

If OWMO: old well information as follows:

Operator: Northern Natural Gas  
Well Name: 24-32 API 15-151-20501  
Comp. Date: 7-18-78 Old Total Depth 4220Directional, Deviated or Horizontal wellbore? .... yes X no

If yes, true vertical depth: .....

Bottom Hole Location: .....

Will Cores Be Taken?: .... yes X .. no

If yes, proposed zone: .....

## AFFIDAVIT

The undersigned hereby affirms that the drilling, completion and eventual plugging of this well will comply with K.S.A. 55-101, et. seq.

It is agreed that the following minimum requirements will be met:

1. Notify the appropriate district office prior to spudding of well;
2. A copy of the approved notice of intent to drill shall be posted on each drilling rig;
3. The minimum amount of surface pipe as specified below shall be set by circulating cement to the top; in all cases surface pipe shall be set through all unconsolidated materials plus a minimum of 20 feet into the underlying formation;
4. If the well is dry hole, an agreement between the operator and the district office on plug length and placement is necessary prior to plugging;
5. The appropriate district office will be notified before well is either plugged or production casing is cemented in;
6. IF AN ALTERNATE II COMPLETION, PRODUCTION PIPE SHALL BE CEMENTED FROM BELOW ANY USABLE WATER TO SURFACE WITHIN 120 DAYS OF SPUD DATE. IN ALL CASES, NOTIFY DISTRICT OFFICE PRIOR TO ANY CEMENTING.

I hereby certify that the statements made herein are true and to the best of my knowledge and belief.

Date: 5/2/97 Signature of Operator or Agent: Dan Dobbins Title Sr. Reservoir Analyst.

FOR KCC USE:	
API # 15-	<u>151-20501 0001</u>
Conductor pipe required	<u>NONE</u> feet
Minimum surface pipe required	<u>1516</u> feet per Alt. <u>(1) X</u>
Approved by:	<u>JK 6-12-97</u>
This authorization expires: <u>12-12-97</u>	
(This authorization void if drilling not started within 6 months of effective date.)	
Spud date:	Agent: _____

RECEIVED  
KANSAS CORPORATION COMMISSION

MAY 05 1997

CONSERVATION DIVISION  
WICHITA, KS

## REMEMBER TO:

- File Drill Pit Application (form CDP-1) with Intent to Drill;
- File Completion Form ACO-1 within 120 days of spud date;
- File acreage attribution plat according to field proration orders;
- Notify appropriate district office 48 hours prior to workover or re-entry;
- Submit plugging report (CP-4) after plugging is completed;
- Obtain written approval before disposing or injecting salt water.

Mail to: KCC - Conservation Division, 130 S. Market - Room 207B, Wichita, Kansas 67202.

**IN ALL CASES PLOT THE INTENDED WELL ON THE PLAT BELOW**

**PLAT OF ACREAGE ATTRIBUTABLE TO A WELL IN A PRORATED OR SPACED FIELD**

If the intended well is in a prorated or spaced field, please fully complete this side of the form. If the intended well is in a prorated or spaced field complete the plat below showing that the well will be properly located in relationship to other wells producing from the common source of supply. Please show all the wells within 1 mile of the boundaries of the proposed acreage attribution unit for gas wells and within 1/2 mile of the boundaries of the proposed acreage attribution unit for oil wells.

API NO. 15- \_\_\_\_\_  
OPERATOR \_\_\_\_\_ LOCATION OF WELL: COUNTY \_\_\_\_\_  
LEASE \_\_\_\_\_ feet from south/north line of section  
WELL NUMBER \_\_\_\_\_ feet from east/west line of section  
FIELD \_\_\_\_\_ SECTION \_\_\_\_\_ TWP \_\_\_\_\_ RG \_\_\_\_\_

NUMBER OF ACRES ATTRIBUTABLE TO WELL \_\_\_\_\_ IS SECTION \_\_\_\_\_ REGULAR or \_\_\_\_\_ IRREGULAR  
QTR/QTR/QTR OF ACREAGE \_\_\_\_\_ IF SECTION IS IRREGULAR, LOCATE WELL FROM NEAREST  
CORNER BOUNDARY.

Section corner used: \_\_\_\_\_ NE \_\_\_\_\_ NW \_\_\_\_\_ SE \_\_\_\_\_ SW

**PLAT**

(Show location of the well and shade attributable acreage for prorated or spaced wells.)  
(Show footage to the nearest lease or unit boundary line.)

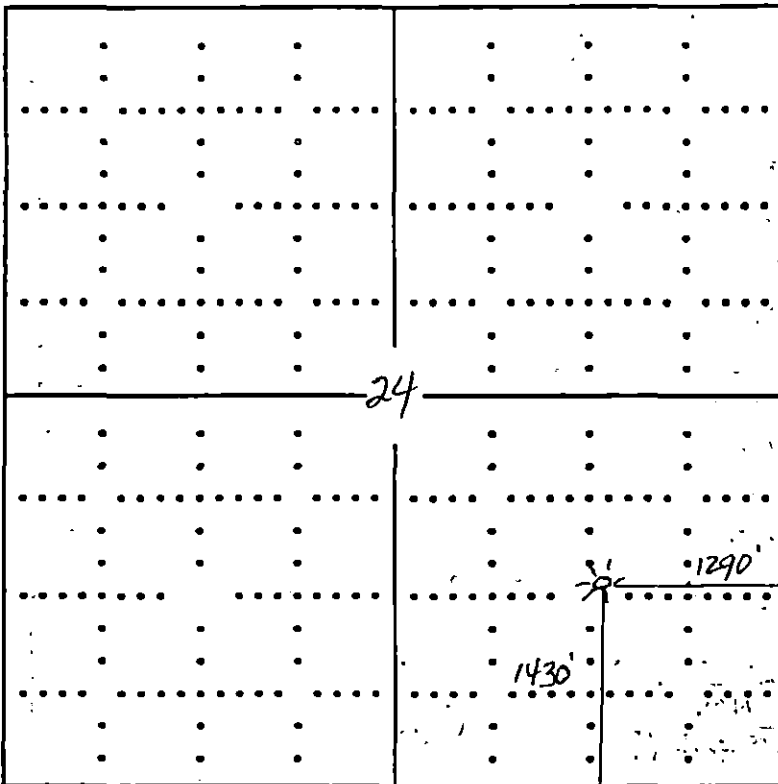

PRATT CO.

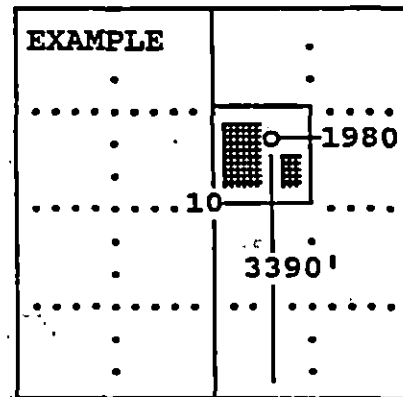

SEWARD CO.

In plotting the proposed location of the well, you must show:

- 1) The manner in which you are using the depicted plat by identifying section lines, i.e. 1 section, 1 section with 8 surrounding sections, 4 sections, etc.;
- 2) the distance of the proposed drilling location from the section's south/north and east/west; and
- 3) the distance to the nearest lease or unit boundary line.