

SRM

FOR KCC USE:

EFFECTIVE DATE: 11-6-91
DISTRICT # 1
SEAT Yes No

State of Kansas
NOTICE OF INTENTION TO DRILL

FORM C-1 7/91
FORM MUST BE TYPED
FORM MUST BE SIGNED
ALL BLANKS MUST BE FILLED

"OWWO" ✓

Must be approved by the K.C.C. five (5) days prior to commencing well

Expected Spud Date: November 1, 1991
month day year

Spot
C-N/2- NE- SW- Sec 26 Twp 27 S, Rg 11 - East West ✓

OPERATOR: License # 3180
Name: DEUTSCH OIL COMPANY
Address: 107 North Market - Suite 1115
City/State/Zip: Wichita, Kansas 67202
Contact Person: Kent Deutsch
Phone: 316/267-7551

2310 feet from South / North line of Section
3300 feet from East / West line of Section
IS SECTION REGULAR IRREGULAR

(NOTE: Locate well on the Section Plat on Reverse Side)
County: Pratt
Lease Name: SITTON Well #: 1-26
Field Name: Cunningham
Is this a Prorated/Spaced Field? yes no

CONTRACTOR: License #: 5929
Name: DUKE DRILLING CO., INC.

Target Formation(s): Viola 1980'
Nearest lease or unit boundary:
Ground Surface Elevation: Unknown feet MSL

Well Drilled For: Well Class: Type Equipment:
X. Oil ... Enh Rec .X Infield .X Mud Rotary
... Gas ... Storage ... Pool Ext. ... Air Rotary
X. OWWO ... Disposal ... Wildcat ... Cable
... Seismic; ... # of Holes ... Other

Water well within one-quarter mile: yes no
Public water supply well within one mile: yes no
Depth to bottom of fresh water: 180'
Depth to bottom of usable water: 200'
Surface Pipe by Alternate: 1 2
Length of Surface Pipe ~~Required~~ set: 300'

If OWWO: old well information as follows:
Operator: DEUTSCH OIL COMPANY
Well Name: Sitton #1
Comp. Date: 6/23/87 Old Total Depth 4400'

Length of Conductor pipe required: N/A
Projected Total Depth: 4300'
Formation at Total Depth: Viola
Water Source for Drilling Operations:
... well ... farm pond other

Directional, Deviated or Horizontal wellbore? yes no
If yes, true vertical depth:
Bottom Hole Location:

DWR Permit #:
Will Cores Be Taken?: yes no
If yes, proposed zone:

AFFIDAVIT

The undersigned hereby affirms that the drilling, completion and eventual plugging of this well will comply with K.S.A. 55-101, et. seq.
It is agreed that the following minimum requirements will be met:

1. Notify the appropriate district office prior to spudding of well;
2. A copy of the approved notice of intent to drill shall be posted on each drilling rig;
3. The minimum amount of surface pipe as specified below shall be set by circulating cement to the top; in all cases surface pipe shall be set through all unconsolidated materials plus a minimum of 20 feet into the underlying formation;
4. If the well is dry hole, an agreement between the operator and the district office on plug length and placement is necessary prior to plugging;
5. The appropriate district office will be notified before well is either plugged or production casing is cemented in;
6. IF AN ALTERNATE IS COMPLETION, PRODUCTION PIPE SHALL BE CEMENTED FROM BELOW ANY USABLE WATER TO SURFACE WITHIN 120 DAYS OF SPUD DATE. IN ALL CASES, NOTIFY DISTRICT OFFICE PRIOR TO ANY CEMENTING.

I hereby certify that the statements made herein are true and to the best of my knowledge and belief.
Date: 10/23/91 Signature of Operator or Agent: James J. Steffen Title: Agent

FOR KCC USE:
API # 15- 151-21,841-A
Conductor pipe required None feet
Minimum surface pipe required 300 feet per Alt. (1) @
Approved by: *[Signature]* 11-1-91
This authorization expires: 5-1-92
(This authorization void if drilling not started within 6 months of effective date.)
Spud date: Agent:

RECEIVED
STATE CORPORATION COMMISSION

OCT 24 1991

- REMEMBER TO:
- File Drill Pit Application (form CDP-1) with Intent to Drill;
 - File Completion Form ACO-1 within 120 days of spud date;
 - File acreage attribution plat according to field prorated orders;
 - Notify appropriate district office 48 hours prior to workover or re-entry;
 - Submit plugging report (CP-4) after plugging is completed;
 - Obtain written approval before disposing or injecting salt water.

Mail to: Conservation Division, 208 Colorado Derby Building, 202 W. First St., Wichita, Kansas 67202-1286.

26
27
1103

IN ALL CASES PLOT THE INTENDED WELL ON THE PLAT BELOW

PLAT OF ACREAGE ATTRIBUTABLE TO A WELL IN A PRORATED OR SPACED FIELD

If the intended well is in a prorated or spaced field, please fully complete this side of the form. If the intended well is in a prorated or spaced field complete the plat below showing that the well will be properly located in relationship to other wells producing from the common source of supply. Please show all the wells within 1 mile of the boundaries of the proposed acreage attribution unit for gas wells and within 1/2 mile of the boundaries of the proposed acreage attribution unit for oil wells.

API NO. 15- _____
 OPERATOR _____ LOCATION OF WELL: COUNTY _____
 LEASE _____ feet from south/north line of section _____
 WELL NUMBER _____ feet from east/west line of section _____
 FIELD _____ SECTION _____ TWP _____ RG _____

NUMBER OF ACRES ATTRIBUTABLE TO WELL _____ IS SECTION _____ REGULAR or _____ IRREGULAR
 QTR/QTR/QTR OF ACREAGE _____ IF SECTION IS IRREGULAR, LOCATE WELL FROM NEAREST CORNER BOUNDARY.

Section corner used: _____ NE _____ NW _____ SE _____ SW
 PLAT

(Show location of the well and shade attributable acreage for prorated or spaced wells.)
 (Show footage to the nearest lease or unit boundary line.)

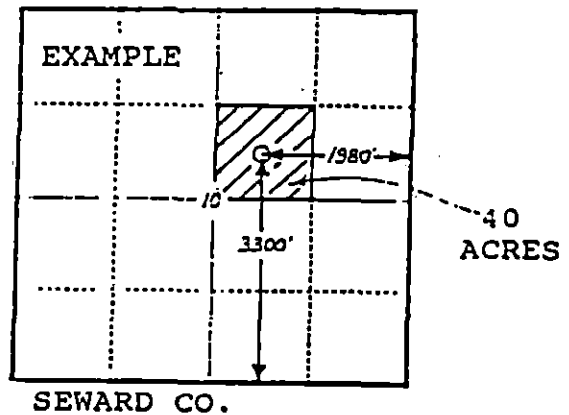
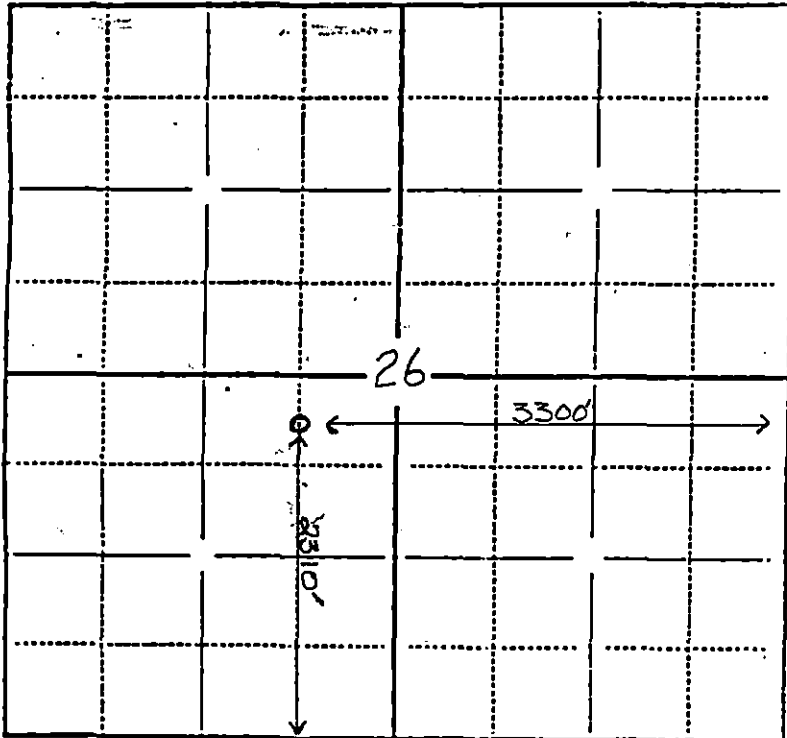

In plotting the proposed location of the well, you must show:

- 1) The manner in which you are using the depicted plat by identifying section lines, i.e. 1 section, 1 section with 8 surrounding sections, 4 sections, etc.;
- 2) the distance of the proposed drilling location from the section's south/north and east/west lines; and
- 3) the distance to the nearest lease or unit boundary line.