

CORRECTIONS

FOR ECC USE:

EFFECTIVE DATE: 11-6-91

DISTRICT #

SEAL Yes No

State of Kansas
NOTICE OF INTENTION TO DRILL

FORM C-1 7/91
FORM MUST BE TYPED
FORM MUST BE SIGNED
ALL BLANKS MUST BE FILLED

Must be approved by the K.C.C. five (5) days prior to commencing well

Expected Spud Date November 1, 1991
month day year

Spot C-N/2- NE- SW- Sec 26 Twp 27 S, Rg 11 East West

OPERATOR: License # 3180
Name: DEUTSCH OIL COMPANY
Address: 107 North Market - Suite 1115
City/State/Zip: Wichita, Kansas 67202
Contact Person: Kent Deutsch
Phone: 316/267-7551

2310 feet from South / North line of Section
3300 feet from East / West line of Section
IS SECTION X REGULAR IRREGULAR

(NOTE: Locate well on the Section Plat on Reverse Side)
County: Pratt
Lease Name: SITTON Well #: 1-26
Field Name: Cunningham

CONTRACTOR: License #: 5929
Name: DUKE DRILLING CO., INC

Is this a Prorated/Spaced Field? yes X no
Target Formation(s): Viola
Nearest lease or unit boundary: 1980'
Ground Surface Elevation: Unknown feet MSL

Well Drilled For: Well Class: Type Equipment:
X Oil ... Enh Rec X Infield X Mud Rotary
... Gas ... Storage ... Pool Ext. ... Air Rotary
X CWVO ... Disposal ... Wildcat ... Cable
... Seismic; ... # of Holes ... Other

Water well within one-quarter mile: yes X no
Public water supply well within one mile: yes X no
Depth to bottom of fresh water: 180'
Depth to bottom of usable water: 200'
Surface Pipe by Alternate: X 1 2
Length of Surface Pipe to be set: 300'
Length of Conductor pipe required: N/A
Projected Total Depth: 4300'
Formation at Total Depth: Viola

If CWVO: old well information as follows:
Operator: DEUTSCH OIL COMPANY
Well Name: Sitton #1
Comp. Date: 6/23/87 Old Total Depth 4400'

Water Source for Drilling Operations:
... well ... farm pond X other
DVR Permit #:
Will Cores Be Taken?: yes X no
If yes, proposed zone:

Directional, Deviated or Horizontal wellbore? yes X no
If yes, true vertical depth:
Bottom Hole Location:

WAS: API # 15-151-21,841-A AFFIDAVIT 15: API # 15-151-21,841-00-01

The undersigned hereby affirms that the drilling, completion and eventual plugging of this well will comply with K.S.A. 55-101, et. seq.
It is agreed that the following minimum requirements will be met:

- 1. Notify the appropriate district office prior to spudding of well;
- 2. A copy of the approved notice of intent to drill shall be posted on each drilling rig;
- 3. The minimum amount of surface pipe as specified below shall be set by circulating cement to the top; in all cases surface pipe shall be set through all unconsolidated materials plus a minimum of 20 feet into the underlying formation;
- 4. If the well is dry hole, an agreement between the operator and the district office on plug length and placement is necessary prior to plugging;
- 5. The appropriate district office will be notified before well is either plugged or production casing is cemented in;
- 6. IF AN ALTERNATE IS COMPLETION, PRODUCTION PIPE SHALL BE CEMENTED FROM BELOW ANY USABLE WATER TO SURFACE WITHIN 120 DAYS OF SPUD DATE. IN ALL CASES, NOTIFY DISTRICT OFFICE PRIOR TO ANY CEMENTING.

I hereby certify that the statements made herein are true and to the best of my knowledge and belief.
Date: 10/23/91 Signature of Operator or Agent: James J. Stehler Title: Agent

RECEIVED
STATE CORPORATION COMMISSION

FOR ECC USE:
API # 15- 151-21,841-00-01
Conductor pipe required None feet
Minimum surface pipe required 220 feet per Alt. (P) @
Approved by: MDeW 11-1-91 can 11-4-91
This authorization expires: 5-1-92
(This authorization void if drilling not started within 6 months of effective date.)
Spud date: Agent:

OCT 24 1991

REMEMBER TO:

- File Drill Pit Application (form CDP-1) with intent to drill;
- File Completion Form ACO-1 within 120 days of spud date;
- File acreage attribution plat according to field proration orders;
- Notify appropriate district office 48 hours prior to workover or re-entry;
- Submit plugging report (CP-4) after plugging is completed;
- Obtain written approval before disposing or injecting salt water.

CONSERVATION DIVISION
Wichita, Kansas

Mail to: Conservation Division, 200 Colorado Derby Building, 202 W. First St., Wichita, Kansas 67202-1286.

26
29
1100

IN ALL CASES PLOT THE INTENDED WELL ON THE PLAT BELOW

PLAT OF ACREAGE ATTRIBUTABLE TO A WELL IN A PRORATED OR SPACED FIELD

If the intended well is in a prorated or spaced field, please fully complete this side of the form. If the intended well is in a prorated or spaced field complete the plat below showing that the well will be properly located in relationship to other wells producing from the common source of supply. Please show all the wells within 1 mile of the boundaries of the proposed acreage attribution unit for gas wells and within 1/2 mile of the boundaries of the proposed acreage attribution unit for oil wells.

API NO. 15- _____
 OPERATOR _____
 LEASE _____
 WELL NUMBER _____
 FIELD _____

LOCATION OF WELL: COUNTY _____
 _____ feet from south/north line of section
 _____ feet from east/west line of section
 SECTION _____ TWP _____ RG _____

NUMBER OF ACRES ATTRIBUTABLE TO WELL _____
 QTR/QTR/QTR OF ACREAGE _____ - _____ - _____

IS SECTION _____ REGULAR or _____ IRREGULAR
IF SECTION IS IRREGULAR, LOCATE WELL FROM NEAREST CORNER BOUNDARY.

Section corner used: _____ NE _____ NW _____ SE _____ SW
 PLAT

(Show location of the well and shade attributable acreage for prorated or spaced wells.)
 (Show footage to the nearest lease or unit boundary line.)

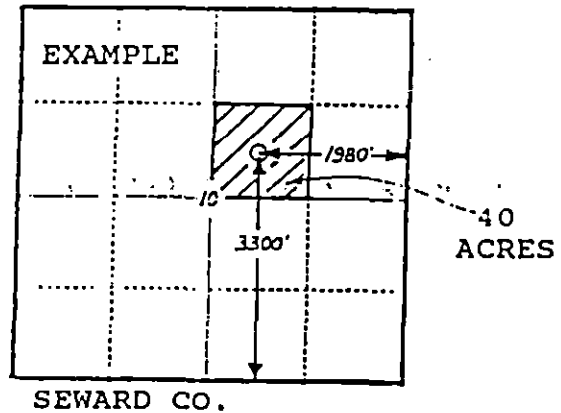
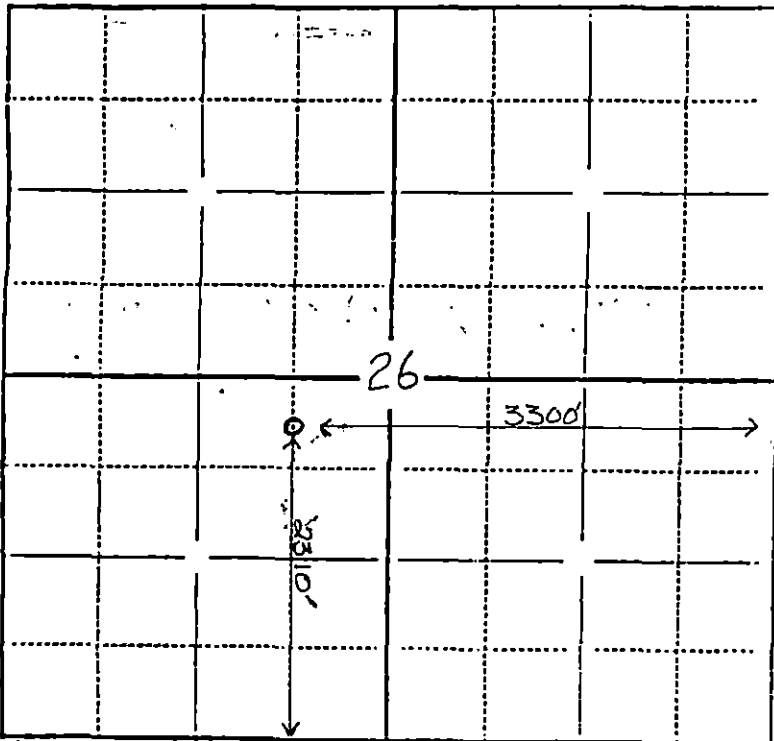

In plotting the proposed location of the well, you must show:

- 1) The manner in which you are using the depicted plat by identifying section lines, i.e. 1 section, 1 section with 8 surrounding sections, 4 sections, etc.;
- 2) the distance of the proposed drilling location from the section's south/north and east/west lines; and
- 3) the distance to the nearest lease or unit boundary line.