

SIDE ONE

Compt. \_\_\_\_\_

Two (2) copies of this form shall be filed with the Kansas Corporation Commission, 200 Colorado Derby Building, Wichita, Kansas 67202, within thirty (30) days after the completion of a well, regardless of how the well was completed.

F Attach separate letter of request if the information is to be held confidential. If confidential, only file one copy. Information on Side One will be of public record and Side Two will then be held confidential.

Applications must be made on dual completion, commingling, salt water disposal, injection and temporarily abandoned wells.

C Attach one copy only wireline logs (i.e. electrical log, sonic log, gamma ray neutron log, etc.). (Rules 82-2-105 & 82-2-125) KCC# (316) 263-3238.

LICENSE # 6045 EXPIRATION DATE 6/30/83 21133 00 00

OPERATOR KIRKLUND RESOURCES, INC. API NO. 15-151-21135

ADDRESS 1675 Broadway, Suite 2500 COUNTY Pratt

Denver, Colorado 80202 FIELD Wildcat

\*\* CONTACT PERSON Mr. J. Tom Kirk PROD. FORMATION Lansing - Kansas City  
PHONE (303) 595-9437

PURCHASER KOCH OIL COMPANY LEASE Leroy P. Hammeke

ADDRESS P.O. Box 2258 WELL NO. 1

Wichita, Kansas 67201 WELL LOCATION C NENE

DRILLING LEBEN DRILLING CO. 660 Ft. from North Line and

CONTRACTOR CONTRACTOR ADDRESS 105 South Broadway, Suite 640 660 Ft. from East Line of (E)  
Wichita, Kansas 67202 the NE (Qtr.) SEC28 TWP 27 RGE 11 (W).

PLUGGING N/A WELL PLAT (Office Use Only)  
CONTRACTOR CONTRACTOR ADDRESS

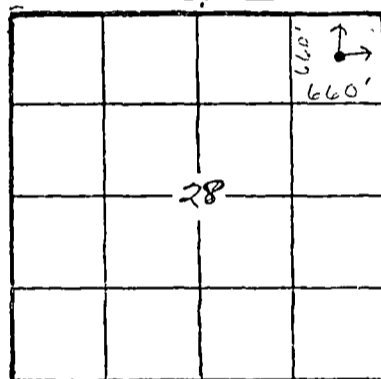

TOTAL DEPTH 4440' PBDT 4328

SPUD DATE 5/17/82 DATE COMPLETED 7/30/82

ELEV: GR 1738 DF 1746 KB 1748

DRILLED WITH (CABLE) (ROTARY) (AIR) TOOLS.

DOCKET NO. OF DISPOSAL OR REPRESSURING WELL BEING USED TO DISPOSE OF WATER FROM THIS LEASE

Amount of surface pipe set and cemented 409' DV Tool Used? No

THIS AFFIDAVIT APPLIES TO: (Circle ONE) - (Oil) Gas, Shut-in Gas, Dry, Disposal, Injection, Temporarily Abandoned, OWWO. Other

ALL REQUIREMENTS OF THE STATUTES, RULES AND REGULATIONS PROMULGATED TO REGULATE THE OIL AND GAS INDUSTRY HAVE BEEN FULLY COMPLIED WITH.

A F F I D A V I T

J. Tom Kirk, being of lawful age, hereby certifies that:

I am the Affiant, and I am familiar with the contents of the foregoing Affidavit. The statements and allegations contained therein are true and correct.

(Handwritten signature)

(Name)

SUBSCRIBED AND SWORN TO BEFORE ME this 6th day of December, 1982.

My commission expires Sept. 12, 1984

MY COMMISSION EXPIRES:

(Handwritten signature) Vicki (NOTARY PUBLIC) Brashear

\*\* The person who can be reached by phone regarding any questions concerning this information.

OPERATOR J. Tom Kirk LEASE Leroy P. Hammeke SEC. 28 TWP 27S RGE. 11W

FILL IN WELL INFORMATION AS REQUIRED:

WELL NO.

Show all important zones of porosity and contents thereof; cored intervals, and all drill-stem tests, including depth interval tested, cushion used, time tool open, flowing and shut-in pressures, and recoveries.

SHOW GEOLOGICAL MARKERS, LOGS RUN, OR OTHER DESCRIPTIVE INFORMATION.

FORMATION DESCRIPTION, CONTENTS, ETC.	TOP	BOTTOM	NAME	DEPTH
Check if no Drill Stem Tests Run.				
Limestone	1749	1811		
Limestone	1811	1880		
Limestone	1880	2359		
Limestone & Shale	2359	2491		
Shale	2491	2536		
Limestone	2536	2898		
Limestone	2898	3008		
Limestone	3008	3386		
Limestone	3386	3402		
Limestone	3402	3414		
Sandstone	3414	3560		
Sandstone	3560	3577		
Sandstone & Limestone	3577	3954		
Limestone	3954	4036		
Limestone	4036	4164		
Limestone	4164	4259		
Limestone & Dolomite	4259	4334		
Sandstone	4334	4421		
Dolomite	4421	4440		
R.T.D.	4440			
DST #1 - 2948-2990', 30-60-30-60 weak to very weak blow, recovery - 375' muddy water, 3% gas, 8% mud, 89% water, 92,000 ppm chlorides, IFP: 54-91#, FFP: 122-150#, ISIP: 1105#; FSIP: 1078# Temp - 115°F.				
DST #2 - 3019-3057', 30-60-30-60, weak increasing to fair, recovery - 975' salt water, 152,000 ppm chlorides; IFP: 150-259#, FFP - 300-368#, ISIP 1145#, FSIP: 1145#.				
DST #3 - 3619-3635' 30-60-30-60 weak blow, recovery 120' slight oil & gas cut mud, 18% oil, 9% gas, 73% mud, IFP - 54-54#, FFP - 91-91#, ISIP - 286#, FSIP - 327#.				
If additional space is needed use Page 2, Side 2				

RECEIVED  
STATE CORPORATION COMMISSION  
SEP 14 1983  
CONSERVATION DIVISION  
Wichita, Kansas

Report of all strings set — surface, intermediate, production, etc. CASING RECORD (New) or (Used)

Purpose of string	Size hole drilled	Size casing set (in O.D.)	Weight lbs/ft.	Setting depth	Type cement	Sacks	Type and percent additives
Surface	13 3/8"	9 5/8"	36#	409'	Quick set	500	
Production	7 7/8"	4 1/2"	10.5#	4415'	50-50 POZMIX	300	50 bbls SE flush 10% salt 3/4% cfr-2 10 bbls gilsonite

LINER RECORD

PERFORATION RECORD

Top, ft.	Bottom, ft.	Sacks cement	Shots per ft.	Size & type	Depth interval
			4		3850-56'
TUBING RECORD			4		3754-60'
Size	Setting depth	Packer set at			
2 3/8"	3840	3842			

ACID, FRACTURE, SHOT, CEMENT SQUEEZE RECORD

Amount and kind of material used	Depth interval treated
500 gal, 15% MCA max press. 950#	3754-60'

Date of first production 7/30/82	Producing method (flowing, pumping, gas lift, etc.) pumping	Gravity 31.3
Estimated Production -I.P. Oil 1 ph bbls. Gas No MCF Water % Sph bbls. Gas-oil ratio CFPB	Perforations 3850-56' 3754-60'	

Disposition of gas (vented, used on lease or sold)