



KANSAS CORPORATION COMMISSION 1093831  
OIL & GAS CONSERVATION DIVISION

Form ACO-4  
Form must be typed  
March 2009

APPLICATION FOR COMMINGLING OF **Commingling ID # CO101205**  
PRODUCTION (K.A.R. 82-3-123) OR FLUIDS (K.A.R. 82-3-123a)

OPERATOR: License # 33343  
Name: PostRock Midcontinent Production LLC  
Address 1: Oklahoma Tower  
Address 2: 210 Park Ave, Ste 2750  
City: OKLAHOMA CITY State: OK Zip: 73102 +  
Contact Person: CLARK EDWARDS  
Phone: (620) 432-4200

API No. 15 - 15-133-27093-00-00  
Spot Description: \_\_\_\_\_  
NE SW SW NW Sec. 23 Twp. 28 S. R. 19  East  West  
1983 Feet from  North /  South Line of Section  
659 Feet from  East /  West Line of Section  
County: Neosho  
Lease Name: HINES FARMS Well #: 23-1

1. Name and upper and lower limit of each production interval to be commingled:
- |                             |                         |
|-----------------------------|-------------------------|
| Formation: <u>SUMMIT</u>    | (Perfs): <u>379-383</u> |
| Formation: <u>MULKY</u>     | (Perfs): <u>392-396</u> |
| Formation: <u>BEVIER</u>    | (Perfs): <u>474-478</u> |
| Formation: <u>CROWEBURG</u> | (Perfs): <u>498-501</u> |
| Formation: <u>FLEMING</u>   | (Perfs): <u>532-534</u> |

2. Estimated amount of fluid production to be commingled from each interval:
- |                             |                |                   |                    |
|-----------------------------|----------------|-------------------|--------------------|
| Formation: <u>SUMMIT</u>    | BOPD: <u>0</u> | MCFPD: <u>2.5</u> | BWPD: <u>19.78</u> |
| Formation: <u>MULKY</u>     | BOPD: <u>0</u> | MCFPD: <u>2.5</u> | BWPD: <u>19.78</u> |
| Formation: <u>BEVIER</u>    | BOPD: <u>0</u> | MCFPD: <u>2.5</u> | BWPD: <u>19.78</u> |
| Formation: <u>CROWEBURG</u> | BOPD: <u>0</u> | MCFPD: <u>2.5</u> | BWPD: <u>19.78</u> |
| Formation: <u>FLEMING</u>   | BOPD: <u>0</u> | MCFPD: <u>2.5</u> | BWPD: <u>19.78</u> |

3. Plat map showing the location of the subject well, all other wells on the subject lease, and all wells on offsetting leases within a 1/2 mile radius of the subject well, and for each well the names and addresses of the lessee of record or operator.
4. Signed certificate showing service of the application and affidavit of publication as required in K.A.R. 82-3-135a.

**For Commingling of PRODUCTION ONLY, include the following:**

5. Wireline log of subject well. Previously Filed with ACO-1:  Yes  No
6. Complete Form ACO-1 (*Well Completion form*) for the subject well.

**For Commingling of FLUIDS ONLY, include the following:**

7. Well construction diagram of subject well.
8. Any available water chemistry data demonstrating the compatibility of the fluids to be commingled.

**AFFIDAVIT:** I am the affiant and hereby certify that to the best of my current information, knowledge and personal belief, this request for commingling is true and proper and I have no information or knowledge, which is inconsistent with the information supplied in this application.

Submitted Electronically

**KCC Office Use Only**

Denied  Approved

15-Day Periods Ends: 10/30/2012

Approved By: Rick Hestermann Date: 10/30/2012

*Protests may be filed by any party having a valid interest in the application. Protests must be in writing and comply with K.A.R. 82-3-135b and must be filed within 15 days of publication of the notice of application.*

	A	B	C	D	E	F	G	H	I	J	K
1	Produced Fluids #		1	2	3	4	5		Click here to run SSP  Goal Seek SSP  Click Click Click Click		
2	Parameters	Units	Input	Input	Input	Input	Input				
3	Select the brines	Select fluid by checking the box(es),	<input type="checkbox"/>	<input type="checkbox"/>	<input type="checkbox"/>	<input type="checkbox"/>	<input type="checkbox"/>	Mixed brine:			
4	Sample ID	Row 3	PostRock	PostRock	PostRock	PostRock	PostRock	Cell H28 is			
5	Date	3/19/2012	3/4/2012	3/14/2012	1/20/2012	1/20/2012		STP calc. pH.			
6	Operator	Ward Feed	Ward Feed	Clinesmith	Clinesmith	Clinesmith		Cells H35-38			
7	Well Name	#34-1	#4-1	#5-4	#1	#2		are used in			
8	Location	CBM	CBM	Bartles	Bartles	Bartles		mixed brines			
9	Field							calculations.			
10	Na <sup>+</sup>	(mg/l)*	19,433.00	27,381.00	26,534.00	25689.00	24220.00	24654.20	Initial(BH)	Final(WH)	SISR (Final-Initial)
11	K <sup>+</sup> (if not known =0)	(mg/l)						0.00	Saturation Index values		
12	Mg <sup>2+</sup>	(mg/l)	1,096.00	872.00	1,200.00	953.00	858.00	995.91	Calcite		
13	Ca <sup>2+</sup>	(mg/l)	1,836.00	2,452.00	2,044.00	1920.00	1948.00	2040.23	-0.73	-0.60	0.13
14	Sr <sup>2+</sup>	(mg/l)						0.00	Barite		
15	Ba <sup>2+</sup>	(mg/l)						0.00			
16	Fe <sup>2+</sup>	(mg/l)	40.00	21.00	18.00	82.00	90.00	50.21	Halite		
17	Zn <sup>2+</sup>	(mg/l)						0.00	-1.77	-1.80	-0.03
18	Pb <sup>2+</sup>	(mg/l)						0.00	Gypsum		
19	Cl <sup>-</sup>	(mg/l)	36,299.00	48,965.00	47,874.00	45632.00	43147.00	44388.44	-3.19	-3.18	0.00
20	SO <sub>4</sub> <sup>2-</sup>	(mg/l)	1.00	1.00	8.00	1.00	1.00	2.40	Hemihydrate		
21	F <sup>-</sup>	(mg/l)						0.00	-3.96	-3.90	0.06
22	Br <sup>-</sup>	(mg/l)						0.00	Anhydrite		
23	SiO <sub>2</sub>	(mg/l) SiO <sub>2</sub>						0.00	-3.47	-3.36	0.12
24	HCO <sub>3</sub> Alkalinity**	(mg/l as HCO <sub>3</sub> )	190.00	234.00	259.00	268.00	254.00	241.03	Celestite		
25	CO <sub>3</sub> Alkalinity	(mg/l as CO <sub>3</sub> )									
26	Carboxylic acids**	(mg/l)						0.00	Iron Sulfide		
27	Ammonia	(mg/L) NH <sub>3</sub>						0.00	-0.16	-0.22	-0.06
28	Borate	(mg/L) H <sub>3</sub> BO <sub>3</sub>						0.00	Zinc Sulfide		
29	TDS (Measured)	(mg/l)						72781			
30	Calc. Density (STP)	(g/ml)	1.038	1.051	1.050	1.048	1.045	1.047	Calcium fluoride		
31	CO <sub>2</sub> Gas Analysis	(%)	19.97	18.76	22.41	35.53	33.79	26.16			
32	H <sub>2</sub> S Gas Analysis***	(%)	0.0289	0.0292	0.0296	0.0306	0.0151	0.0269	Iron Carbonate		
33	Total H <sub>2</sub> Saq	(mgH <sub>2</sub> S/l)	1.00	1.00	1.00	1.00	0.50	0.90	-0.74	-0.51	0.23
34	pH, measured (STP)	pH	5.67	5.76	5.72	5.54	5.55	5.63	Inhibitor needed (mg/l)		
35	Choose one option to calculate SI?	0-CO <sub>2</sub> %+Alk, 1-pH+Alk, 2-CO <sub>2</sub> %+pH	0	0	0	0	0		Calcite	NTMP	
36	Gas/day(thousand cf/day)	(Mcf/D)						0	0.00	0.00	
37	Oil/Day	(B/D)	0	0	1	1	1	4	Barite	BHPMP	
38	Water/Day	(B/D)	100	100	100	100	100	500	0.00	0.00	
39	For mixed brines, enter values for temperatures and pressures in Cells (H40-H43)							(Enter H40-H43)	pH		
40	Initial T	(F)	66.0	71.0	70.0	41.0	49.0	60.0	5.69	5.60	
41	Final T	(F)	66.0	71.0	70.0	41.0	49.0	89.0	Viscosity (CentiPoise)		
42	Initial P	(psia)	25.0	25.0	25.0	25.0	25.0	25.0	1.196	0.826	
43	Final P	(psia)	25.0	25.0	25.0	25.0	25.0	120.0	Heat Capacity (cal/ml <sup>2</sup> C)		
44	Use TP on Calcite sheet?	1-Yes;0-No							0.955	0.959	
45	API Oil Grav.	API grav.						30.00	Inhibitor needed (mg/L)		
46	Gas Sp.Grav.	Sp.Grav.						0.60	Gypsum	HDTMP	
47	MeOH/Day	(B/D)	0					0	0.00	0.00	
48	MEG/Day	(B/D)	0					0	Anhydrite	HDTMP	
49	Conc. Multiplier								0.00	0.00	
50	H <sup>+</sup> (Strong acid) †	(N)									
51	OH <sup>-</sup> (Strong base) †	(N)									
52	Quality Control Checks at STP:										
53	H <sub>2</sub> S Gas	(%)									
54	Total H <sub>2</sub> Saq (STP)	(mgH <sub>2</sub> S/l)									
55	pH Calculated	(pH)									
56	PCO <sub>2</sub> Calculated	(%)									
57	Alkalinity Calculated	(mg/l) as HCO <sub>3</sub>									
58	ECations=	(equiv./l)									
59	EAnions=	(equiv./l)									
60	Calc TDS=	(mg/l)									
61	Inhibitor Selection	Input	Unit	#	Inhibitor	Unit Converter (From metric to English)					
62	Protection Time	120	min	1	NTMP	From Unit	Value	To Unit	Value		
63	Have ScaleSoftPitzer			2	BHPMP	°C	80	°F	176		
64	pick inhibitor for you?	1	1-Yes;0-No	3	PAA	m <sup>3</sup>	100	ft <sup>3</sup>	3,531		
65	If No, inhibitor # is:	4	#	4	DTPMP	m <sup>3</sup>	100	bbl(42 US gal)	629		
66	If you select Mixed,			5	PPCA	MPa	1,000	psia	145,074		
67	1 <sup>st</sup> inhibitor # is:	1	#	6	SPA	Bar	496	psia	7,194		
68	% of 1 <sup>st</sup> inhibitor is:	50	%	7	HEDP	Torr	10,000	psia	193		
69	2 <sup>nd</sup> inhibitor # is:	2	#	8	HDTMP	Gal	10,000	bbl(42 US gal)	238		
70	Display act. coeffs?	0	1-Yes;0-No	9	Average	Liters	10,000	bbl(42 US gal)	63		
71				10	Mixed						

## Saturation Index Calculations

*Champion Technologies, Inc.*

(Based on the Tomson-Oddo Model)

**Brine 1:** Ward Feed Yard 34-1

**Brine 2:** Ward Feed Yard 4-1

**Brine 3:** Clinesmith 5-4

**Brine 4:** Clinesmith 1

**Brine 5:** Clinesmith 2

Component (mg/L)	Ratio					Mixed Brine
	20% Brine 1	20% Brine 2	20% Brine 3	20% Brine 4	20 Brine 5	
Calcium	1836	2452	2044	1920	1948	1952
Magnesium	1096	872	1200	953	858	865
Barium	0	0	0	0	0	0
Strontium	0	0	0	0	0	0
Bicarbonate	190	234	259	268	254	253
Sulfate	1	1	8	1	1	1
Chloride	36299	48965	47874	45632	43147	43206
CO <sub>2</sub> in Brine	246	220	264	422	405	401
Ionic Strength	1.12	1.48	1.46	1.38	1.31	1.31
Temperature (°F)	89	89	89	89	89	89
Pressure (psia)	50	50	120	120	120	119

### Saturation Index

Calcite	-1.71	-1.41	-1.48	-1.68	-1.69	-1.69
Gypsum	-3.71	-3.64	-2.82	-3.73	-3.72	-3.69
Hemihydrate	-3.70	-3.65	-2.83	-3.74	-3.71	-3.69
Anhydrite	-3.89	-3.79	-2.97	-3.89	-3.88	-3.85
Barite	N/A	N/A	N/A	N/A	N/A	N/A
Celestite	N/A	N/A	N/A	N/A	N/A	N/A

### PTB

Calcite	N/A	N/A	N/A	N/A	N/A	N/A
Gypsum	N/A	N/A	N/A	N/A	N/A	N/A
Hemihydrate	N/A	N/A	N/A	N/A	N/A	N/A
Anhydrite	N/A	N/A	N/A	N/A	N/A	N/A
Barite	N/A	N/A	N/A	N/A	N/A	N/A
Celestite	N/A	N/A	N/A	N/A	N/A	N/A

**CONFIDENTIAL**

KANSAS CORPORATION COMMISSION  
OIL & GAS CONSERVATION DIVISION  
**WELL COMPLETION FORM**  
WELL HISTORY - DESCRIPTION OF WELL & LEASE

12/2009  
**ORIGINAL**  
Form ACO-1  
September 1999  
Form Must Be Typed

Operator: License # 33344  
 Name: Quest Cherokee, LLC  
 Address: 211 W. 14th Street  
 City/State/Zip: Chanute, KS 66720  
 Purchaser: Bluestem Pipeline, LLC  
 Operator Contact Person: Jennifer R. Ammann  
 Phone: (620) 431-9500  
 Contractor: Name: TXD Drilling  
 License: 33837  
 Wellsite Geologist: Ken Recoy  
 Designate Type of Completion:  
 New Well     Re-Entry     Workover  
 Oil     SWD     SLOW     Temp. Abd.  
 Gas     ENHR     SIGW  
 Dry     Other (Core, WSW, Expl., Cathodic, etc)  
 If Workover/Re-entry: Old Well Info as follows:  
 Operator: \_\_\_\_\_  
 Well Name: \_\_\_\_\_  
 Original Comp. Date: \_\_\_\_\_ Original Total Depth: \_\_\_\_\_  
 Deepening     Re-perf.     Conv. to Enhr./SWD  
 Plug Back    \_\_\_\_\_ Plug Back Total Depth  
 Commingled    Docket No. \_\_\_\_\_  
 Dual Completion    Docket No. \_\_\_\_\_  
 Other (SWD or Enhr.?)    Docket No. \_\_\_\_\_  

<u>8/28/07</u>	<u>8/29/07</u>	<u>8/30/07</u>
Spud Date or Recompletion Date	Date Reached TD	Completion Date or Recompletion Date

**CONFIDENTIAL**  
DEC 20 2007  
KCC

API No. 15 - 133-27093-0000  
 County: Neosho  
 \_\_\_\_\_ SW \_\_\_\_\_ NW Sec. 23 Twp. 28 S. R. 19  East  West  
1980 feet from S / N (circle one) Line of Section  
660 feet from E / W (circle one) Line of Section  
 Footages Calculated from Nearest Outside Section Corner:  
 (circle one) NE SE NW SW  
 Lease Name: Hines Farms Well #: 23-1  
 Field Name: Cherokee Basin CBM  
 Producing Formation: multiple  
 Elevation: Ground: 890 Kelly Bushing: n/a  
 Total Depth: 917 Plug Back Total Depth: 906.57  
 Amount of Surface Pipe Set and Cemented at 22 Feet  
 Multiple Stage Cementing Collar Used?  Yes  No  
 If yes, show depth set \_\_\_\_\_ Feet  
 If Alternate II completion, cement circulated from 906.57  
 feet depth to Surface \_\_\_\_\_ w/ 125 \_\_\_\_\_ sx cmt.

**Drilling Fluid Management Plan** AK 110 5509  
 (Data must be collected from the Reserve Pit)  
 Chloride content \_\_\_\_\_ ppm Fluid volume \_\_\_\_\_ bbls  
 Dewatering method used \_\_\_\_\_  
 Location of fluid disposal if hauled offsite: \_\_\_\_\_  
 Operator Name: \_\_\_\_\_  
 Lease Name: \_\_\_\_\_ License No.: \_\_\_\_\_  
 Quarter \_\_\_\_\_ Sec. \_\_\_\_\_ Twp. \_\_\_\_\_ S. R. \_\_\_\_\_  East  West  
 County: \_\_\_\_\_ Docket No.: \_\_\_\_\_

**INSTRUCTIONS:** An original and two copies of this form shall be filed with the Kansas Corporation Commission, 130 S. Market - Room 2078, Wichita, Kansas 67202, within 120 days of the spud date, recompletion, workover or conversion of a well. Rule 82-3-130, 82-3-106 and 82-3-107 apply. Information of side two of this form will be held confidential for a period of 12 months if requested in writing and submitted with the form (see rule 82-3-107 for confidentiality in excess of 12 months). One copy of all wireline logs and geologist well report shall be attached with this form. ALL CEMENTING TICKETS MUST BE ATTACHED. Submit CP-4 form with all plugged wells. Submit CP-111 form with all temporarily abandoned wells.

All requirements of the statutes, rules and regulations promulgated to regulate the oil and gas industry have been fully complied with and the statements herein are complete and correct to the best of my knowledge.

Signature: Jennifer R. Ammann  
 Title: New Well Development Coordinator Date: 12/19/07  
 Subscribed and sworn to before me this 19<sup>th</sup> day of December  
 2007.  
 Notary Public: Debra Klauman  
 Date Commission Expires: 8-4-2010

**TERRA KLAUMAN**  
Notary  
My Appt. Expires 8-4-2010

**KCC Office Use ONLY**

Letter of Confidentiality Received  
 Wireline Log Received  
 Geologist Report Received  
 UIC Distribution

RECEIVED  
KANSAS CORPORATION COMMISSION  
DEC 26 2007  
CONSERVATION DIVISION  
WICHITA, KS

Operator Name: Quest Cherokee, LLC Lease Name: Hines Farms Well #: 23-1  
 Sec. 23 Twp. 28 S. R. 19  East  West County: Neosho

**INSTRUCTIONS:** Show important tops and base of formations penetrated. Detail all cores. Report all final copies of drill stems tests giving interval tested, time tool open and closed, flowing and shut-in pressures, whether shut-in pressure reached static level, hydrostatic pressures, bottom hole temperature, fluid recovery, and flow rates if gas to surface test, along with final chart(s). Attach extra sheet if more space is needed. Attach copy of all Electric Wireline Logs surveyed. Attach final geological well site report.

Drill Stem Tests Taken  Yes  No  
 (Attach Additional Sheets)  
 Samples Sent to Geological Survey  Yes  No  
 Cores Taken  Yes  No  
 Electric Log Run  Yes  No  
 (Submit Copy)

Log Formation (Top), Depth and Datum  Sample  
 Name Top Datum  
 See attached

List All E. Logs Run:

Compensated Density Neutron Log  
 Dual Induction Log  
 Gamma Ray Neutron Log

CASING RECORD <input type="checkbox"/> New <input type="checkbox"/> Used							
Report all strings set-conductor, surface, intermediate, production, etc.							
Purpose of String	Size Hole Drilled	Size Casing Set (In O.D.)	Weight Lbs. / Ft.	Setting Depth	Type of Cement	# Sacks Used	Type and Percent Additives
Surface	12-1/4	8-5/8"	22	22	"A"	5	
Production	6-3/4	4-1/2	10.5	906.57	"A"	125	

ADDITIONAL CEMENTING / SQUEEZE RECORD				
Purpose:	Depth Top Bottom	Type of Cement	#Sacks Used	Type and Percent Additives
<input type="checkbox"/> Perforate				
<input type="checkbox"/> Protect Casing				
<input type="checkbox"/> Plug Back TD				
<input type="checkbox"/> Plug Off Zone				

Shots Per Foot	PERFORATION RECORD - Bridge Plugs Set/Type Specify Footage of Each Interval Perforated	Acid, Fracture, Shot, Cement Squeeze Record (Amount and Kind of Material Used)	Depth
4	796-799/745-747/739-741	500gal 15% HCL w/ 48 lbs 2% acid water, 64 lbs water w/ 2% KCL, Biocide, 5900# 20#40 sand	796-799/745-747 739-741
4	589-591/532-534/498-501/474-478	400gal 15% HCL w/ 41 lbs 2% acid water, 64 lbs water w/ 2% KCL, Biocide, 4500# 20#40 sand	589-591/532-534 498-501/474-478
4	392-396/379-383	300gal 15% HCL w/ 48 lbs 2% acid water, 64 lbs water w/ 2% KCL, Biocide, 6700# 20#40 sand	392-396/379-383

TUBING RECORD	Size	Set At	Packer At	Liner Run <input type="checkbox"/> Yes <input type="checkbox"/> No

Date of First, Resumed Production, SWD or Enhr. waiting on pipeline \_\_\_\_\_ Producing Method  Flowing  Pumping  Gas Lift  Other (Explain) \_\_\_\_\_

Estimated Production Per 24 Hours	Oil Bbls.	Gas Mcf	Water Bbls.	Gas-Oil Ratio	Gravity

Disposition of Gas:  Vented  Sold  Used on Lease (If vented, Submit ACO-18.)  
 METHOD OF COMPLETION:  Open Hole  Perf.  Dually Comp.  Commingled  Other (Specify) \_\_\_\_\_  
 Production Interval \_\_\_\_\_

# QUEST

Resource Corporation



211 W. 14TH STREET,  
CHANUTE, KS 66720  
620-431-9500

TICKET NUMBER **2383**

FIELD TICKET REF # \_\_\_\_\_

FOREMAN Joe

623020

### TREATMENT REPORT & FIELD TICKET CEMENT

DATE	WELL NAME & NUMBER	SECTION	TOWNSHIP	RANGE	COUNTY
8-30-07	Hines Farms 23-1	23	28	19	NO

FOREMAN / OPERATOR	TIME IN	TIME OUT	LESS LUNCH	TRUCK #	TRAILER #	TRUCK HOURS	EMPLOYEE SIGNATURE
Joe	10:00	1:00		903427		3	Joe Blomquist
Tim				903255			L. Ayer
Tyler				903600			
Maverick				931585	931590		
Daniel				931420			Daniel

JOB TYPE Long String HOLE SIZE 6 3/4 HOLE DEPTH 917 CASING SIZE & WEIGHT 4 1/2 10.5  
 CASING DEPTH 906.57 DRILL PIPE \_\_\_\_\_ TUBING \_\_\_\_\_ OTHER \_\_\_\_\_  
 SLURRY WEIGHT 14.5 SLURRY VOL \_\_\_\_\_ WATER gal/sk \_\_\_\_\_ CEMENT LEFT in CASING 0  
 DISPLACEMENT 14.45 DISPLACEMENT PSI \_\_\_\_\_ MIX PSI \_\_\_\_\_ RATE 4bpm

REMARKS:

Installed Cement head Ran 15K gal of 8 hbl dye & 125 SKS of cement To get dye to surface. flush pump. Pump wiper plug to bottom of set float shoe.

**CONFIDENTIAL**

DEC 20 2007

KCC

906.57	ft 4 1/2 Casing	
5	Centralizers	
1	4 1/2 float shoe	

ACCOUNT CODE	QUANTITY or UNITS	DESCRIPTION OF SERVICES OR PRODUCT	TOTAL AMOUNT
903427	3 hr	Foreman Pickup	
903255	3 hr	Cement Pump Truck	
903600	3 hr	Bulk Truck	
1104	115 SK	Portland Cement	
1124	2	50/50 POZ Blend Cement Baffles 3 1/2 #3	
1126	1	GWC Blend Cement 4 1/2 wiper plug	
1110	12 SK	Gilsonite	
1107	1 SK	Flo-Seal	
1118	1 SK	Premium Gel	
1215A	load	KCL	
1111B	2 SK	Sodium Silicate Calchloride	
1123	7000 gal	City Water	
	3 hr	Transport Truck	
	3 hr	Transport Trailer	
931520	3 hr	80 Vac	

RECEIVED  
KANSAS CORPORATION COMMISSION

DEC 26 2007

CONSERVATION DIVISION  
1515 E. 17th, KS

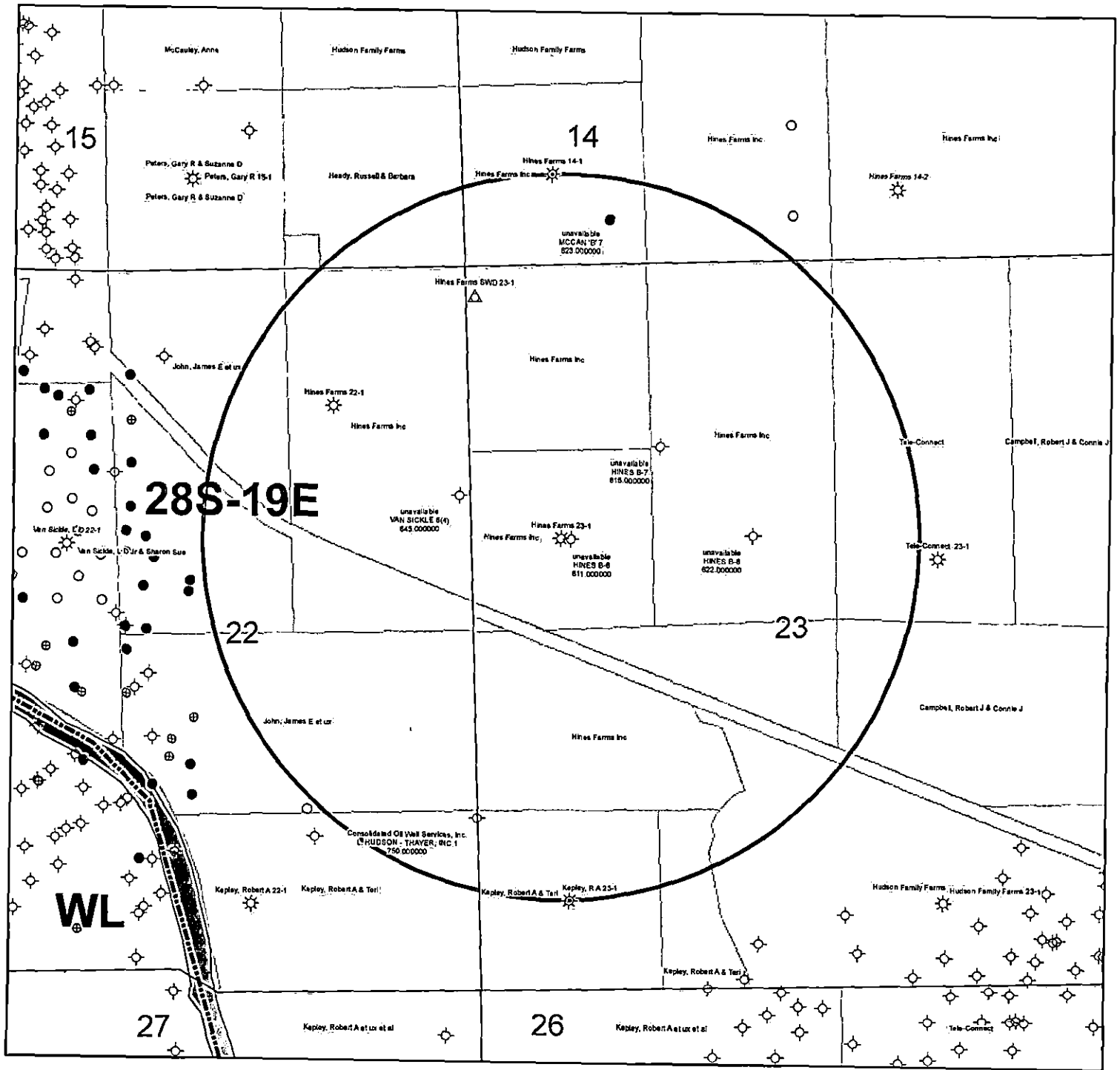

KGS STATUS	
◇	DA/PA
⊙	EOR
☆	GAS
△	INJ/SWD
●	OIL
☆	OIL/GAS
○	OTHER

Hines Farms 23-1  
 23-28S-19E  
 1" = 1,000'





# POSTROCK



## LEGEND

PostRock®

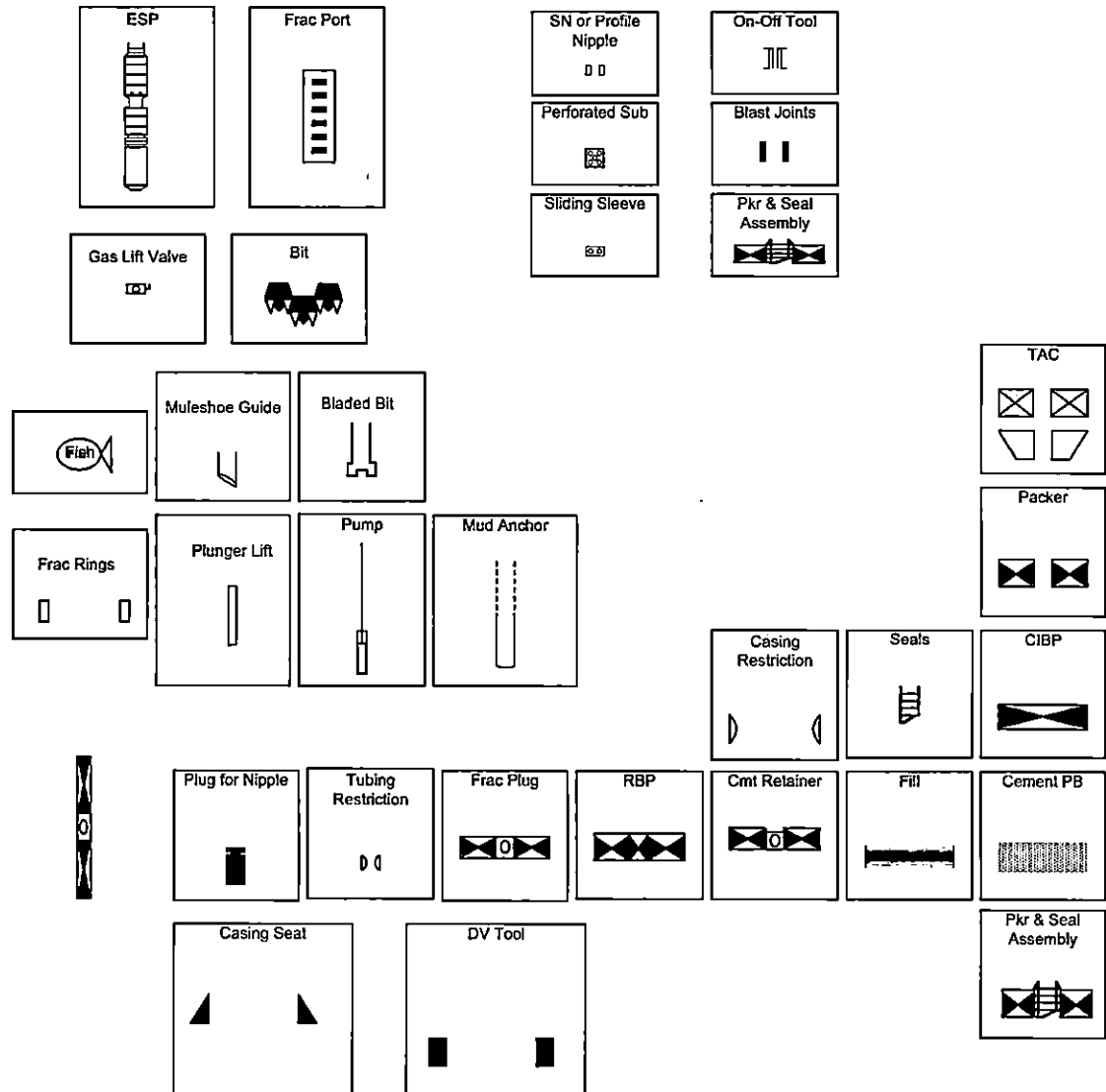



**Affidavit of Notice Served**

Re: Application for: APPLICATION FOR COMMINGLING OF PRODUCTION OR FLUIDS ACO-4

Well Name: HINES FARMS 23-1 Legal Location: NESWSWNW S23-T28S-R19E

The undersigned hereby certifies that he / she is a duly authorized agent for the applicant, and that on the day 15TH of OCTOBER, 2012, a true and correct copy of the application referenced above was delivered or mailed to the following parties:

*Note: A copy of this affidavit must be served as a part of the application.*

Name

Address (Attach additional sheets if necessary)

CONSOLIDATED OIL WELL SERVICE, INC

PO BOX 884, CHANUTE, KS 66720

SEE ATTACHED

I further attest that notice of the filing of this application was published in the THE CHANUTE TRIBUNE, the official county publication of NEOSHO county. A copy of the affidavit of this publication is attached.

Signed this 15TH day of OCTOBER, 2012

Jess Mann  
Applicant or Duly Authorized Agent

Subscribed and sworn to before me this 15TH day of OCTOBER, 2012



Jennifer R. Beal  
Notary Public  
My Commission Expires: July 20, 2016

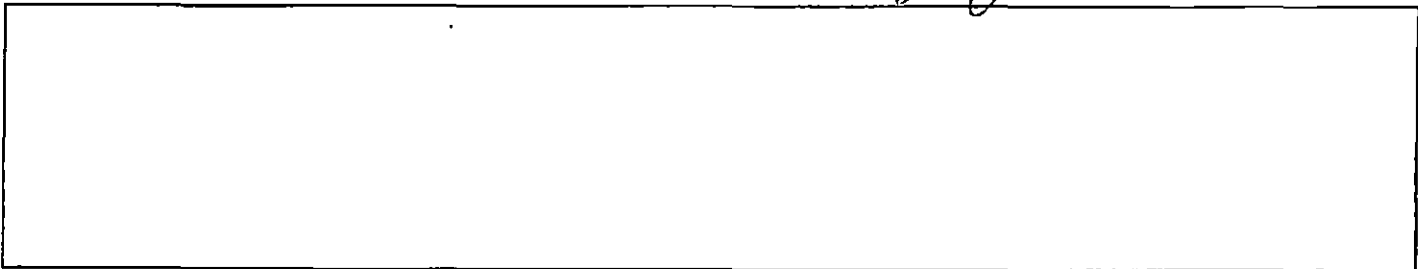

**HINES FARMS 23-1**

**22-28S-19E**

tract S of RR in E/2 NE/4

Judith L Moyer  
17175 Irving Rd  
Chanute, KS 66720

**NOTES**

our lessor in another tract

**22, 23-28S-19E**  
Railroad ROW

AT&SF & BN&SF Railway Co.  
PO Box 961089  
Fort Worth, TX 76161



**HINES FARMS 23-1**

<b>LEGAL LOCATION</b>	<b>SPOT</b>	<b>CURR_OPERA</b>
S22-T28S-R19E	NE NE SE SE	Consolidated Oil Well Services, Inc.

**HINES FARMS 23-1**

**22-28S-19E**

tract S of RR in E/2 NE/4

Judith L Moyer  
17175 Irving Rd  
Chanute, KS 66720

**NOTES**

our lessor in another tract

**22, 23-28S-19E**

Railroad ROW

AT&SF & BN&SF Railway Co.  
PO Box 961089  
Fort Worth, TX 76161

BEFORE THE STATE  
CORPORATION COMMISSION  
OF THE STATE OF KANSAS  
**NOTICE OF FILING  
APPLICATION**

RE: In the Matter of **Postrock  
Midcontinent Production, LLC**  
Application for Commingling of  
Production in the **Hines Farms  
23-1** located in **Neosho County,  
Kansas.**

TO: All Oil & Gas Producers, Un-  
leased Mineral Interest Owners,  
Landowners, and all persons  
whomever concerned.

You, and each of you, are hereby  
notified that **Postrock Midcont-  
inent Production, LLC** has filed  
an application to commingle the  
**Summit, Mulky, Bevier, Crowe-  
burg, Fleming, Tebo, Rowe,  
Neutral, Riverton and Cattleman**  
producing formations at the **Hines  
Farms 23-1**, located in the **NE SW  
SW NW, S23-T28S-R19E, Ap-  
proximately 1983 FNL & 659  
FWL, Neosho County, Kansas.**

Any persons who object to or pro-  
test this application shall be re-  
quired to file their objections or  
protest with the Conservation Divi-  
sion of the State Corporation  
Commission of the State of Kan-  
sas within fifteen (15) days from  
the date of this publication. These  
protests shall be filed pursuant to  
Commission regulations and must  
state specific reasons why grant-  
ing the application may cause  
waste, violate correlative rights or  
pollute the natural resources of  
the State of Kansas.

All persons interested or con-  
cerned shall take notice of the  
foregoing and shall govern them-  
selves accordingly. All person  
and/or companies wishing to pro-  
test this application are required to  
file a written protest with the Con-  
servation Division of the Kansas  
Oil and Gas Commission.

Upon the receipt of any protest,  
the Commission will convene a  
hearing and protestants will be ex-  
pected to enter an appearance ei-  
ther through proper legal counsel  
or as individuals, appearing on  
their own behalf.

**Postrock Midcontinent  
Production, LLC**  
210 Park Avenue, Suite 2750  
Oklahoma City, Oklahoma  
73102  
(405) 660-7704

A COPY OF THE AFFIDAVIT OF  
PUBLICATION MUST ACCOM-  
PANY ALL APPLICATIONS

## **Affidavit of Publication**

STATE OF KANSAS, NEOSHO COUNTY, ss:

*Rhonda Howerter*, being first duly sworn,  
deposes and says: That *she* is *Classified Manager*  
of **THE CHANUTE TRIBUNE**, a daily newspaper printed  
in the State of Kansas, and published in and of general  
circulation in Neosho County, Kansas, with a general paid  
circulation on a daily basis in Neosho County, Kansas, and  
that said newspaper is not a trade, religious or fraternal  
publication.

Said newspaper is a daily published at least weekly 50  
times a year: has been so published continuously and unin-  
terruptedly in said county and state for a period of more  
than five years prior to the first publication of said notice;  
and has been admitted at the post office of Chanute, in said  
county as second class matter.

That the attached notice is a true copy thereof and was  
published in the regular and entire issue of said newspa-  
per for 1 consecutive time, the first publication  
thereof being made as aforesaid on the 10 day of  
October  
2012, with subsequent publications being made on the fol-  
lowing dates:

\_\_\_\_\_, 2012 \_\_\_\_\_, 2012

\_\_\_\_\_, 2012 \_\_\_\_\_, 2012

*Rhonda Howerter*

Subscribed and sworn to and before me this  
10 day of October, 2012

*[Signature]*  
\_\_\_\_\_  
Notary Public

My commission expires: January 9, 2015

Printer's Fee ..... \$ 70.14

Affidavit, Notary's Fee ..... \$ 3.00

Additional Copies ..... \$ \_\_\_\_\_

Total Publication Fees ..... \$ 73.14

 **SHANNA L. GUIOT**  
Notary Public - State of Kansas  
My Appl. Expires



**AFFIDAVIT**

STATE OF KANSAS \  
- SS.  
County of Sedgwick /

Mark Fletchall, of lawful age, being first duly sworn, deposeth and saith: That he is Record Clerk of The Wichita Eagle, a daily newspaper published in the City of Wichita, County of Sedgwick, State of Kansas, and having a general paid circulation on a daily basis in said County, which said newspaper has been continuously and uninterruptedly published in said County for more than one year prior to the first publication of the notice hereinafter mentioned, and which said newspaper has been entered as second class mail matter at the United States Post Office in Wichita, Kansas, and which said newspaper is not a trade, religious or fraternal publication and that a notice of a true copy is hereto attached was published in the regular and entire Morning issue of said The Wichita Eagle for 1 issues, that the first publication of said notice was

made as aforesaid on the 11th of

October A.D. 2012, with

subsequent publications being made on the following dates:

And affiant further says that he has personal knowledge of the statements above set forth and that they are true.

*Mark Fletchall*

Subscribed and sworn to before me this

11th day of October, 2012



*Penny L. Case*  
Notary Public Sedgwick County, Kansas

Printer's Fee : \$132.40

**LEGAL PUBLICATION**

PUBLISHED IN THE WICHITA EAGLE  
OCTOBER 11, 2012 (3211703)  
BEFORE THE STATE CORPORATION  
COMMISSION  
OF THE STATE OF KANSAS

**NOTICE OF FILING APPLICATION**  
RE: In the Matter of Postrock Midcontinent  
Production, LLC Application for  
Commencing of Production in the Hines  
Farms 23-1 located in Neosho County,  
Kansas.

TO: All Oil & Gas Producers, Unleased Mineral  
Interest Owners, Landowners, and all  
persons whomsoever concerned.

You, and each of you, are hereby notified  
that Postrock Midcontinent Production, LLC  
has filed an application to commence the  
Summit, Mucky, Beaver, Crowburg, Fleming,  
Tobo, Rowe, Neutral, Riverton and Cattleman  
producing formations of the Hines Farms 23-1,  
located in the NE SW SW NW, S23-T125-R17E,  
Approximately 1983 FNL & 659 FWL, Neosho  
County, Kansas.

Any persons who object to or protest  
this application shall be required to file their  
objections or protest with the Conservation  
Division of the State Corporation Commission  
of the State of Kansas, within fifteen (15)  
days from the date of this publication. These  
protests shall be filed pursuant to Commission  
regulations and must state specific reasons  
why granting the application may cause waste,  
violate correlative rights or pollute the natural  
resources of the State of Kansas.

All persons interested or concerned shall  
take notice of the foregoing and shall govern  
themselves accordingly. All persons and/or  
companies wishing to protest this application  
are required to file a written protest with the  
Conservation Division of the Kansas Oil and  
Gas Commission.

Upon the receipt of any protest, the  
Commission will convene a hearing and  
protestants will be expected to attend in  
appearance either through proper legal counsel  
or as individuals, appearing on their own behalf.  
Postrock Midcontinent Production, LLC  
210 Park Avenue, Suite 2150  
Oklahoma City, Oklahoma 73102  
(405) 660-7704

Conservation Division  
Finney State Office Building  
130 S. Market, Rm. 2078  
Wichita, KS 67202-3802



Phone: 316-337-6200  
Fax: 316-337-6211  
<http://kcc.ks.gov/>

Mark Sievers, Chairman  
Thomas E. Wright, Commissioner  
Shari Feist Albrecht, Commissioner

Sam Brownback, Governor

October 30, 2012

Clark Edwards  
PostRock Midcontinent Production LLC  
Oklahoma Tower  
210 Park Ave, Ste 2750  
Oklahoma City, OK 73102

RE: Approved Commingling CO101205  
Hines Farms 23-1 Sec. 23-T28S-R19E, Neosho County  
API No. 15-133-27093-00-00

Dear Mr. Edwards:

Your Application for Commingling (ACO-4) for the above described well, received by the KCC on October 16, 2012, has been reviewed and approved by the Kansas Corporation Commission (KCC) per K.A.R. 82-3-123. Notice was examined and found to be proper per K.A.R. 82-3-135a. No protest had been filed within the 15-day protest period.

Based upon the depth of the Riverton formation perforations, total oil production shall not exceed 100 BOPD and total gas production shall not exceed 50% of the absolute open flow (AOF).

**File form ACO-1 upon re-completion of the well to commingle.**

Commingling ID number CO101205 has been assigned to this approved application. Use this number for well completion reports (ACO-1) and other correspondence that may concern this approved commingling.

Sincerely,

Rick Hestermann  
Production Department