

STATE OF KANSAS  
STATE CORPORATION COMMISSION

WELL PLUGGING RECORD

Give All Information Completely  
Make Required Affidavit  
Mail or Deliver Report to  
Conservation Division  
State Corporation Comm.  
245 North Water  
Wichita, KS 67202

Pratt County. Sec. 4 Twp. 27S Rge. 13 E/W  
Location as "NE/CNW $\frac{1}{4}$ SW $\frac{1}{4}$ " or footage from lines  
C NE NE

Lease Owner Hoppe Oil & Gas Co.  
Lease Name Briggeman Well No. 1  
Office Address 2400 N. Woodlawn, Suite #211  
Character of Well (Completed as Oil, Gas or Dry Hole)  
Dry Hole

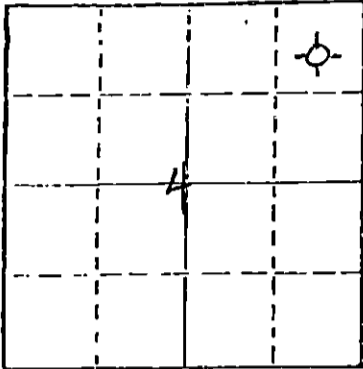

Locate well correctly on above  
Section Plat

Date Well completed April 5 1980  
Application for plugging filed August 18 1980  
Application for plugging approved 19  
Plugging commenced April 5 1980  
Plugging completed April 5 1980  
Reason for abandonment of well or producing formation  
Dry Hole

If a producing well is abandoned, date of last production 19

Was permission obtained from the Conservation Division or  
its agents before plugging was commenced? Yes

Name of Conservation Agent who supervised plugging of this well Mr. William T. Owens  
Producing formation Depth to top Bottom Total Depth of Well 4484  
Show depth and thickness of all water, oil and gas formations.

OIL, GAS OR WATER RECORDS

CASING RECORD

FORMATION	CONTENT	FROM	TO	SIZE	PUT IN	PULLED OUT

Describe in detail the manner in which the well was plugged, indicating where the mud fluid  
was placed and the method or methods used in introducing it into the hold. If cement or other  
plugs were used, state the character of same and depth placed, from feet to  
feet for each plug set.

Rotary Mud to 700 Feet; Bridge plug at 700 Feet with 50 sacks cement;

Mud to 390 feet with 40 sacks cement with bridge and plug; Mud to

40 feet plug with 10 sacks cement; 5 sacks cement in rat hole; plug down

at 10:30 A.M. 4/5/80

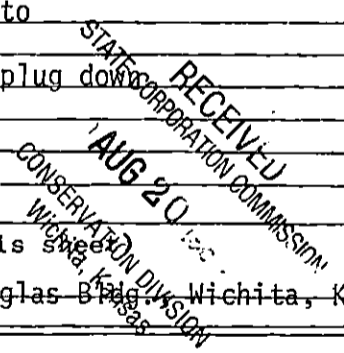

(If additional description is necessary, use BACK of this sheet)

Name of Plugging Contractor Brandt Drilling Co., Inc. Suite 1104 Douglas Bldg. Wichita, Ks.

STATE OF Kansas COUNTY OF Sedgwick, ss.  
Rick B. Hoppe (operator)

of the above-described well, being first duly sworn on oath, says: That I have knowledge of  
the facts, statements, and matters herein contained and the log of the above-described well  
as filed and that the same are true and correct. So help me God.

(Signature) *Rick B. Hoppe*  
2400 N. Woodlawn Suite 211 Wichita  
67220  
(Address)

SUBSCRIBED AND SWORN TO before me this 19th day of August, 1980

FAYE L. BRALEY  
NOTARY PUBLIC  
Sedgwick County, Kansas  
My Appt. Exp. March 22, 1983

*Faye L. Braley*  
Notary Public.

My commission expires

KANSAS

WELL COMPLETION REPORT AND DRILLER'S LOG

API No. 15 \_\_\_\_\_ County \_\_\_\_\_ Number \_\_\_\_\_

Operator  
HOPPE OIL & GAS COMPANY

Address  
2400 N. Woodlawn, Wichita, Kansas 67220

Well No. 1 Lease Name  
Bridgeman

Footage Location  
feet from (N) (S) line \_\_\_\_\_ feet from (E) (W) line \_\_\_\_\_

Principal Contractor  
Brandt Drilling Co., Inc. Geologist  
Don F. Moore

Spud Date 3-21-80 Date Completed 4-5-80 Total Depth 4484 P.B.T.D.

Directional Deviation \_\_\_\_\_ Oil and/or Gas Purchaser \_\_\_\_\_

S. 4 T27S R. 13 XW  
Loc. C NE NE  
County Pratt

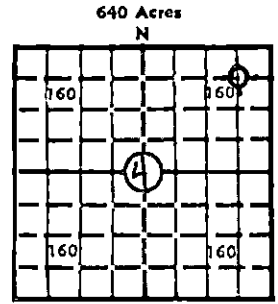

Elev.: Gr. 1960  
DF 1963 KB 1965

CASING RECORD

Report of all strings set— surface, intermediate, production, etc.

Purpose of string	Size hole drilled	Size casing set (in O.D.)	Weight lbs/ft.	Setting depth	Type cement	Sacks	Type and percent additives
Surface		8 5/8"		413'			

LINER RECORD

PERFORATION RECORD

Top, ft.	Bottom, ft.	Sacks cement	Shots per ft.	Size & type	Depth interval

TUBING RECORD

Size	Setting depth	Packer set at

ACID, FRACTURE, SHOT, CEMENT SQUEEZE RECORD

Amount and kind of material used	Depth interval treated

INITIAL PRODUCTION

Date of first production		Producing method (flowing, pumping, gas lift, etc.)			
RATE OF PRODUCTION PER 24 HOURS	Oil	Gas	Water	Gas-oil ratio	CFPB
	bbls.	MCF	bbls.		
Disposition of gas (vented, used on lease or sold)			Producing interval(s)		

RECEIVED  
STATE CORPORATION COMMISSION  
AUG 20 1981  
CONSERVATION DIVISION  
Wichita, Kansas

INSTRUCTIONS: As provided in KCC Rule 82-2-125, within 90 days after completion of a well, one completed copy of this Drillers Log shall be transmitted to the State Geological Survey of Kansas, 4150 Monroe Street, Wichita, Kansas 67209. Copies of this form are available from the Conservation Division, State Corporation Commission, 245 No. Water, Wichita, Kansas 67202. Phone AC 316-522-2206. If confidential custody is desired, please note Rule 82-2-125. Drillers Logs will be on an open file in the Oil and Gas Division, State Geological Survey of Kansas, Lawrence, Kansas 66044.

DESIGNATE TYPE OF COMP.: OIL, GAS,  
DRY HOLE, SWDW, ETC.:

HOPPE OIL & GAS COMPANY

Well No. 1	Lease Name Briggeman	Dry Hole
S 4 T 27S R 13 <sup>XXX</sup> W		

**WELL LOG**

Show all important zones of porosity and contents thereof; cored intervals, and all drill-stem tests, including depth interval tested, cushion used, time tool open, flowing and shut-in pressures, and recoveries.

SHOW GEOLOGICAL MARKERS, LOGS RUN,  
OR OTHER DESCRIPTIVE INFORMATION.

FORMATION DESCRIPTION, CONTENTS, ETC.	TOP	BOTTOM	NAME	DEPTH
			Herrington	2044 (-79)
DST. #4 3171 - 3261 Op. 30-30-30-30, Wk. blow 33", Rec. 26' Mud; IFP 75-86; ISIP 1006'; FFP 86-118; FSIP 1006; T-118 <sup>o</sup>			Howard	3208 (-1243)
DST #1 4235 - 68 Op. 45-45-30-45, Wk. blow 42", Rec. 60' Mud w/oil specks on top, IFP 84-84; ISIP 220-222; FFP 95-81; FSIP 127; T-126 <sup>o</sup>			Heebner	3678 (-1713)
			Bn. Lm.	3838 (-1873)
DST #3 4316 - 56 (Straddle) Op. 45-45-30-45 Wk. Blow 45"; Rec. 20' Mud; IFP 53-53; ISIP - 53; FFP 53 - 53; FSIP 53; T -131 <sup>o</sup>			Lansing	3850 (-1889)
DST #2 4410 - 38 Op. 30-45-30-45; Wk. blow 27", Rec. 15' Mud w/oil specks on top; IFP 52-52; ISIP 52; FFP 63-63; FSIP 63, T. 128 <sup>o</sup> .			Miss.	4332 (-2367)
			Viola	4388 (-2423)
			Simpson	4420 (-2455)
			T. D.	4484 (-2519)

USE ADDITIONAL SHEETS, IF NECESSARY, TO COMPLETE WELL RECORD.

Date Received	<p><i>John A. Hoppe</i> Signature</p> <p>Operator (co-owner) Title</p> <p>Aug 19, 1980 Date</p>
---------------	---