

EFFECTIVE DATE: 6-11-91

P. 4

FORM MUST BE TYPED
FORM C-1 4/90

State of Kansas
NOTICE OF INTENTION TO DRILL

FORM MUST BE SIGNED
ALL BLANKS MUST BE FILLED

Must be approved by the K.C.C. five (5) days prior to commencing well

Expected Spud Date June 7 1991
month day year

E/2 NW SE Sec 8 Twp 27 S, Rg 12 X East West

OPERATOR: License # 05050
Name: HUMMON CORPORATION
Address: 400 One Main Place
City/State/Zip: Wichita, KS 67202
Contact Person: Byron E. Hummon, Jr.
Phone: (316) 263-8521

1980 feet from South line of Section
1650 feet from East line of Section
(Note: Locate well on Section Plat on Reverse Side)

CONTRACTOR: License #: 5822
Name: Val Energy, Inc.

County: Pratt County, KS
Lease Name: Studer Well #: 1
Field Name: GRIMES

Well Drilled For: Well Class: Type Equipment:
X Oil ... Inj X Infield X Mud Rotary
... Gas ... Storage ... Pool Ext. ... Air Rotary
... OWWO ... Disposal ... Wildcat ... Cable
... Seismic; ... # of Holes

Is this a Prorated Field? ... yes X no
Target Formation(s): Mississippian
Nearest lease or unit boundary: 330'
Ground Surface Elevation: 1874 ground feet MSL
Domestic well within 330 feet: ... yes X no
Municipal well within one mile: ... yes X no
Depth to bottom of fresh water: 100'
Depth to bottom of usable water: 220
Surface Pipe by Alternate: X 1 ... 2
Length of Surface Pipe Planned to be set: 385
Length of Conductor pipe required: -0-
Projected Total Depth: 4250
Formation at Total Depth: Mississippian
Water Source for Drilling Operations:
X well ... farm pond ... other

If OWWO: old well information as follows:
Operator: _____
Well Name: _____
Comp. Date: _____ Old Total Depth _____

DWR Permit #: _____
Will Cores Be Taken?: ... yes X no
If yes, proposed zone: _____

Directional, Deviated or Horizontal wellbore? ... yes X no
If yes, total depth location: _____

AFFIDAVIT

The undersigned hereby affirms that the drilling, completion and eventual plugging of this well will comply with K.S.A. 55-101, et. seq.

- It is agreed that the following minimum requirements will be met:
1. The appropriate district office shall be notified before setting surface pipe;
 2. The minimum amount of surface pipe as specified above shall be set by circulating cement to the top; in all cases surface pipe shall be set through all unconsolidated materials plus a minimum of 20 feet into the underlying formation;
 3. If the well is dry, a plugging proposal shall be submitted to the district office. An agreement between the operator and the district office on plug length and placement is necessary prior to plugging;
 4. The appropriate district office will be notified before well is either plugged or production casing is cemented in;
 5. If an Alternate II completion, production pipe shall be cemented from below any usable water to surface within 120 days of spud date. In all cases, notify district office prior to any cementing.

I hereby certify that the statements made herein are true and to the best of my knowledge and belief.

Date: 6-3-91 Signature of Operator or Agent: Byron E. Hummon, Jr. Title: President

FOR KCC USE:
API # 15- 151-22,051-00-00
Conductor pipe required None feet
Minimum surface pipe required 240 feet per Alt. (1)
Approved by: mw 6-6-91
EFFECTIVE DATE: 6-11-91
This authorization expires: 12-6-91
(This authorization void if drilling not started within 6 months of effective date.)
Spud date: _____ Agent: _____

REMEMBER TO:

- File Drill Pit Application (form CDP-1) with Intent to Drill;
- File Completion Form ACO-1 within 120 days of spud date;
- File acreage attribution plat according to field proration orders;
- Notify appropriate district office 48 hours prior to workover or re-entry;
- Submit plugging report (CP-4) after plugging is completed;
- Obtain written approval before disposing or injecting salt water.

8
27
1263

PLAT OF ACREAGE ATTRIBUTABLE TO A WELL

State Corporation Commission, Conservation Division
200 Colorado Derby Bldg. Wichita, Kansas 67202

OPERATOR HUMMON CORPORATION LOCATION OF WELL:
 LEASE Studer 1980 feet north of SE corner
 WELL NUMBER #1 1650 feet west of SE corner
 FIELD Grimes E/2/NW SE Sec. 8 T 27S R 12 E/W
 COUNTY Pratt Co., KS
 NO. OF ACRES ATTRIBUTABLE TO WELL 80 IS SECTION X REGULAR IRREGULAR?
 DESCRIPTION OF ACREAGE W/2 SE IF IRREGULAR, LOCATE WELL FROM NEAREST
 CORNER BOUNDARY.

NOTE: If plat depicted is insufficient for your circumstances, you may attach your own scaled or surveyed plat.

PLAT

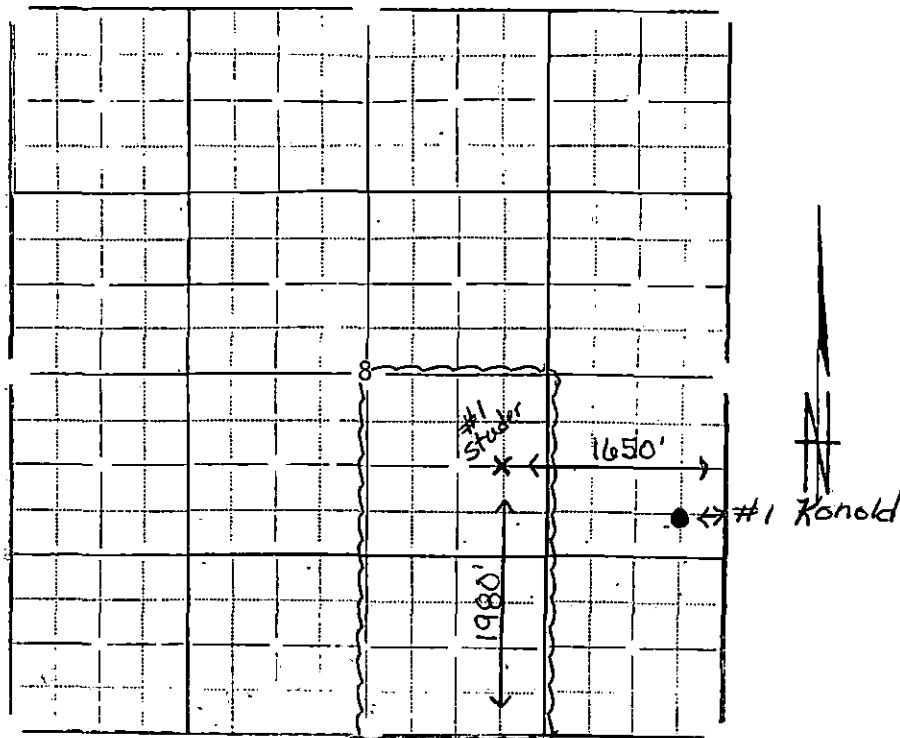

In plotting the proposed location of the well, you must show:

- 1) The manner in which you are using the depicted plat by identifying section lines, i.e. 1 section, 1 section with 8 surrounding partial sections, 4 sections, 16 sections, etc.;
- 2) the well's location relative to the location of other wells producing from the same common source of supply in adjoining drilling units, pursuant to K.A.R. 82-3-108, 82-3-207, 82-3-312, or special orders of the Commission;
- 3) the distance of the proposed drilling location from the section's east and south lines; and
- 4) the distance to the nearest lease or unit boundary line.

I hereby certify that the statements made herein are true and to the best of my knowledge and belief.

Signature of Operator or Agent *Byron E. Hummon, Jr.*
 Date 6-3-91 Title President