

EFFECTIVE DATE: 12-23-91

State of Kansas

FAX

FORM MUST BE TYPED

FORM MUST BE SIGNED

ALL BLANKS MUST BE FILLED

DISTRICT # 1

NOTICE OF INTENTION TO DRILL

SGA7. Yes. No

Must be approved by the K.C.C. five (5) days prior to commencing well

Expected Spud Date 12 20 91
month day year

2640 2510 C Sec 26 Twp 27 S, Rg 12W X East West

OPERATOR: License # 30660
Name: Crystal Oil Company
Address: Box 70
City/State/Zip: Isabel, KS 67065
Contact Person: Mrs. Bessie Kruckanberg
Phone: 316-739-4571

2640 2510 feet from South / North line of Section
feet from East / West line of Section
IS SECTION X REGULAR IRREGULAR?

(NOTE: Locate well on the Section Plat on Reverse Side)

CONTRACTOR: License #: 5302
Name: Red Tiger Drilling Co.

County: Pratt
Lease Name: Hirt Farms Well #: 1
Field Name: UNNAMED

Is this a Prorated/Spaced Field? yes X no

Target Formation(s): ARB
Nearest lease or unit boundary: 2510
Ground Surface Elevation: 1700 N/A feet MSL

Well Drilled For: Well Class: Type Equipment:
 Oil Enh Rec Infield Mud Rotary
 Gas Storage Pool Ext. Air Rotary
 OWD Disposal Wildcat Cable
 Seismic; # of Holes Other

Water well within one-quarter mile: yes X no
Public water supply well within one mile: yes X no

Depth to bottom of fresh water: 100
Depth to bottom of usable water: 200

Surface Pipe by Alternate: X 1 2
Length of Surface Pipe Planned to be set: 240
Length of Conductor pipe required: N/A

Projected Total Depth: 4500
Formation at Total Depth: ARB

Water Source for Drilling Operations:
 well farm pond other

DWR Permit #: Presently being filed
Will Cores Be Taken?: yes X no

If OWD: old well information as follows:
Operator: _____
Well Name: _____
Comp. Date: _____ Old Total Depth _____

Directional, Deviated or Horizontal wellbore? yes X no
If yes, true vertical depth: _____
Bottom Hole Location: _____

AFFIDAVIT

The undersigned hereby affirms that the drilling, completion and eventual plugging of this well will comply with K.S.A. 55-101, et. seq.
It is agreed that the following minimum requirements will be met:

1. Notify the appropriate district office prior to spudding of well;
2. A copy of the approved notice of intent to drill shall be posted on each drilling rig;
3. The minimum amount of surface pipe as specified below shall be set by circulating cement to the top; in all cases surface pipe shall be set through all unconsolidated materials plus a minimum of 20 feet into the underlying formation;
4. If the well is dry hole, an agreement between the operator and the district office on plug length and placement is necessary prior to plugging;
5. The appropriate district office will be notified before well is either plugged or production casing is cemented in;
6. IF AN ALTERNATE II COMPLETION, PRODUCTION PIPE SHALL BE CEMENTED FROM BELOW ANY USABLE WATER TO SURFACE WITHIN 120 DAYS OF SPUD DATE. IN ALL CASES, NOTIFY DISTRICT OFFICE PRIOR TO ANY CEMENTING.

I hereby certify that the statements made herein are true and to the best of my knowledge and belief.
Date: 12-12-91 Signature of Operator or Red Tiger Drilling Co. Title: Rig Coordinator

RECEIVED
STATE CORPORATION COMMISSION
DEC 18 1991
CONSERVATION DIVISION
WICHITA, KANSAS

FOR KCC USE:
API # 15- 151-22,074-00-00
Conductor pipe required N/A feet
Minimum surface pipe required 220 feet per Alt. 1
Approved by: MW 12-18-91
This authorization expires: 6-18-92
(This authorization void if drilling not started within 6 months of effective date.)
Spud date: _____ Agent: _____

REMEMBER TO:

- File Drill Pit Application (form GDP-1) with Intent to Drill;
- File Completion Form ACO-1 within 120 days of spud date;
- File acreage attribution plat according to field proration orders;
- Notify appropriate district office 48 hours prior to workover or re-entry;
- Submit plugging report (CP-4) after plugging is completed;
- Obtain written approval before disposing or injecting salt water.

Mail to: Conservation Division, 200 Colorado Derby Building, 202 W. First St., Wichita, Kansas 67202-1286.

26
27
28

IN ALL CASES PLOT THE INTENDED WELL ON THE PLAT BELOW

PLAT OF ACREAGE ATTRIBUTABLE TO A WELL IN A PRORATED OR SPACED FIELD

If the intended well is in a prorated or spaced field, please fully complete this side of the form. If the intended well is in a prorated or spaced field complete the plat below showing that the well will be properly located in relationship to other wells producing from the common source of supply. Please show all the wells within 1 mile of the boundaries of the proposed acreage attribution unit for gas wells and within 1/2 mile of the boundaries of the proposed acreage attribution unit for oil wells.

API NO. 15- _____
OPERATOR _____
LEASE _____
WELL NUMBER _____
FIELD _____

LOCATION OF WELL: COUNTY _____
_____ feet from south/north line of section
_____ feet from east/west line of section
SECTION _____ TWP _____ RG _____

NUMBER OF ACRES ATTRIBUTABLE TO WELL _____
QTR/QTR/QTR OF ACREAGE _____

IS SECTION _____ REGULAR or _____ IRREGULAR
IF SECTION IS IRREGULAR, LOCATE WELL FROM NEAREST CORNER BOUNDARY.

Section corner used: _____ NE _____ NW _____ SE _____ SW

PLAT

(Show location of the well and shade attributable acreage for prorated or spaced wells.)
(Show footage to the nearest lease or unit boundary line.)

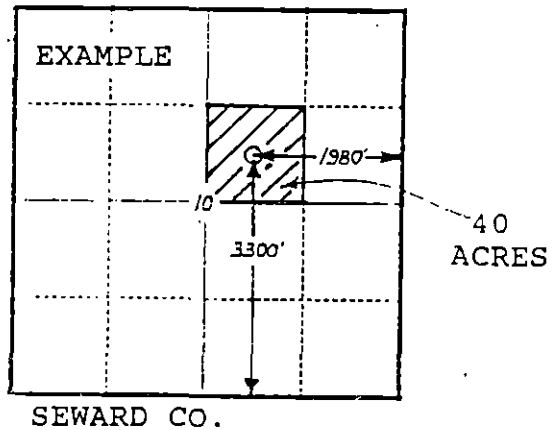
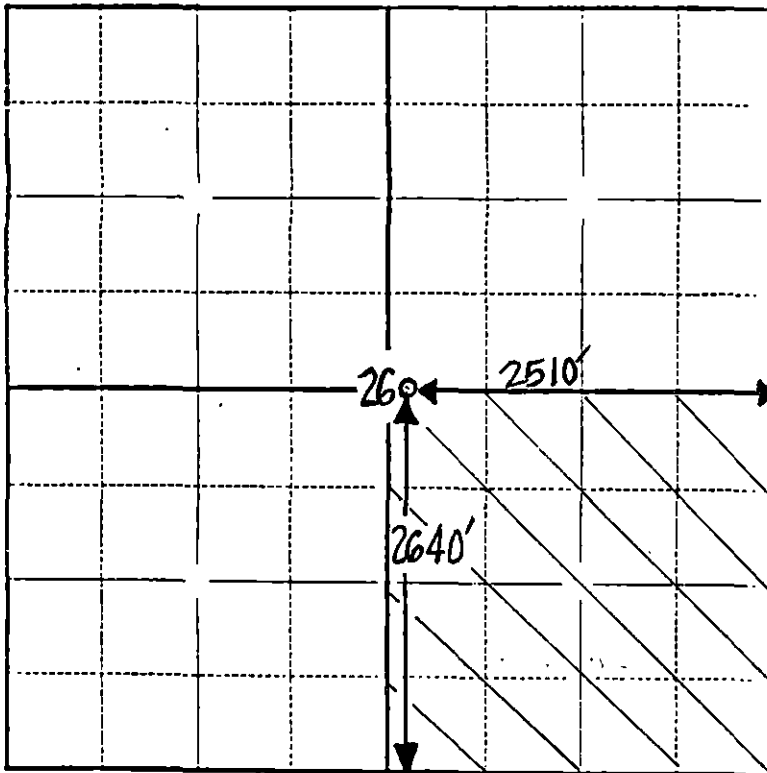

In plotting the proposed location of the well, you must show:

- 1) The manner in which you are using the depicted plat by identifying section lines, i.e. 1 section, 1 section with 8 surrounding sections, 4 sections, etc.;
- 2) the distance of the proposed drilling location from the section's south/north and east/west lines; and
- 3) the distance to the nearest lease or unit boundary line.