



KANSAS CORPORATION COMMISSION 1093858
 OIL & GAS CONSERVATION DIVISION

Form ACO-4
 Form must be typed
 March 2009

APPLICATION FOR COMMINGLING OF **Commingling ID # CO101223**
 PRODUCTION (K.A.R. 82-3-123) OR FLUIDS (K.A.R. 82-3-123a)

OPERATOR: License # 33343
 Name: PostRock Midcontinent Production LLC
 Address 1: Oklahoma Tower
 Address 2: 210 Park Ave, Ste 2750
 City: OKLAHOMA CITY State: OK Zip: 73102 + _____
 Contact Person: CLARK EDWARDS
 Phone: (620) 432-4200

API No. 15 - 15-133-26896-00-00
 Spot Description: _____
NE SE SW SE Sec. 22 Twp. 28 S. R. 18 East West
507 Feet from North / South Line of Section
1600 Feet from East / West Line of Section
 County: Neosho
 Lease Name: TAYLOR, WAYNE L. Well #: 22-4

1. Name and upper and lower limit of each production interval to be commingled:
 Formation: BARTLESVILLE (Perfs): 880-881
 Formation: CATTLEMAN (Perfs): 816-821
 Formation: CATTLEMAN (Perfs): 878-884
 Formation: _____ (Perfs): _____
 Formation: _____ (Perfs): _____

2. Estimated amount of fluid production to be commingled from each interval:
 Formation: BARTLESVILLE BOPD: 0 MCFPD: 26 BWPD: 11
 Formation: CATTLEMAN BOPD: 1.5 MCFPD: 0 BWPD: 10
 Formation: CATTLEMAN BOPD: 1.5 MCFPD: 0 BWPD: 10
 Formation: _____ BOPD: _____ MCFPD: _____ BWPD: _____
 Formation: _____ BOPD: _____ MCFPD: _____ BWPD: _____

3. Plat map showing the location of the subject well, all other wells on the subject lease, and all wells on offsetting leases within a 1/2 mile radius of the subject well, and for each well the names and addresses of the lessee of record or operator.

4. Signed certificate showing service of the application and affidavit of publication as required in K.A.R. 82-3-135a.

For Commingling of PRODUCTION ONLY, include the following:

5. Wireline log of subject well. Previously Filed with ACO-1: Yes No
 6. Complete Form ACO-1 (Well Completion form) for the subject well.

For Commingling of FLUIDS ONLY, include the following:

7. Well construction diagram of subject well.
 8. Any available water chemistry data demonstrating the compatibility of the fluids to be commingled.

AFFIDAVIT: I am the affiant and hereby certify that to the best of my current information, knowledge and personal belief, this request for commingling is true and proper and I have no information or knowledge, which is inconsistent with the information supplied in this application.

Submitted Electronically

| | |
|---------------------------------------|--|
| KCC Office Use Only | |
| <input type="checkbox"/> Denied | <input checked="" type="checkbox"/> Approved |
| 15-Day Periods Ends: <u>11/9/2012</u> | |
| Approved By: <u>Rick Hestermann</u> | Date: <u>11/09/2012</u> |

Protests may be filed by any party having a valid interest in the application. Protests must be in writing and comply with K.A.R. 82-3-135b and must be filed within 15 days of publication of the notice of application.

| | A | B | C | D | E | F | G | H | I | J | K |
|----|--|---|--------------------------|--------------------------|--------------------------|---|--------------------------|-----------------|--|-----------|--------------------------|
| 1 | Produced Fluids # | | 1 | 2 | 3 | 4 | 5 | | Click here to run SSP Goal Seek SSP | | Click |
| 2 | Parameters | Units | Input | Input | Input | Input | Input | | | | Click |
| 3 | Select the brines | Select fluid | <input type="checkbox"/> | <input type="checkbox"/> | <input type="checkbox"/> | <input type="checkbox"/> | <input type="checkbox"/> | Mixed brine: | | | Click |
| 4 | Sample ID | by checking | | | | | | Cell H28 is | | | Click |
| 5 | Date | the box(es), | 3/19/2012 | 3/4/2012 | 3/14/2012 | 1/20/2012 | 1/20/2012 | STP calc. pH. | | | Click |
| 6 | Operator | Row 3 | PostRock | PostRock | PostRock | PostRock | PostRock | Cells H35-38 | | | Click |
| 7 | Well Name | | Ward Feed | Ward Feed | Clinesmith | Clinesmith | Clinesmith | are used in | | | Click |
| 8 | Location | | #34-1 | #4-1 | #5-4 | #1 | #2 | mixed brines | | | Click |
| 9 | Field | | CBM | CBM | Bartles | Bartles | Bartles | calculations. | | | Click |
| 10 | Na ⁺ | (mg/l)* | 19,433.00 | 27,381.00 | 26,534.00 | 25689.00 | 24220.00 | 24654.20 | Initial(BH) | Final(WH) | SI/SR (Final-Initial) |
| 11 | K ⁺ (if not known =0) | (mg/l) | | | | | | 0.00 | Saturation Index values | | |
| 12 | Mg ²⁺ | (mg/l) | 1,096.00 | 872.00 | 1,200.00 | 953.00 | 858.00 | 995.91 | Calcite | | |
| 13 | Ca ²⁺ | (mg/l) | 1,836.00 | 2,452.00 | 2,044.00 | 1920.00 | 1948.00 | 2040.23 | -0.73 | -0.60 | 0.13 |
| 14 | Si ²⁺ | (mg/l) | | | | | | 0.00 | Barite | | |
| 15 | Ba ²⁺ | (mg/l) | | | | | | 0.00 | | | |
| 16 | Fe ²⁺ | (mg/l) | 40.00 | 21.00 | 18.00 | 82.00 | 90.00 | 50.21 | Halite | | |
| 17 | Zn ²⁺ | (mg/l) | | | | | | 0.00 | -1.77 | -1.80 | -0.03 |
| 18 | Pb ²⁺ | (mg/l) | | | | | | 0.00 | Gypsum | | |
| 19 | Cl ⁻ | (mg/l) | 36,299.00 | 48,965.00 | 47,874.00 | 45632.00 | 43147.00 | 44388.44 | -3.19 | -3.18 | 0.00 |
| 20 | SO ₄ ²⁻ | (mg/l) | 1.00 | 1.00 | 8.00 | 1.00 | 1.00 | 2.40 | Hemihydrate | | |
| 21 | F ⁻ | (mg/l) | | | | | | 0.00 | -3.96 | -3.90 | 0.06 |
| 22 | Br ⁻ | (mg/l) | | | | | | 0.00 | Anhydrite | | |
| 23 | SiO ₂ | (mg/l) SiO ₂ | | | | | | 0.00 | -3.47 | -3.36 | 0.12 |
| 24 | HCO ₃ Alkalinity** | (mg/l as HCO ₃) | 190.00 | 234.00 | 259.00 | 268.00 | 254.00 | 241.03 | Celestite | | |
| 25 | CO ₃ Alkalinity | (mg/l as CO ₃) | | | | | | | | | |
| 26 | Carboxylic acids** | (mg/l) | | | | | | 0.00 | Iron Sulfide | | |
| 27 | Ammonia | (mg/L) NH ₃ | | | | | | 0.00 | -0.16 | -0.22 | -0.06 |
| 28 | Borate | (mg/L) H ₃ BO ₃ | | | | | | 0.00 | Zinc Sulfide | | |
| 29 | TDS (Measured) | (mg/l) | | | | | | 72781 | | | |
| 30 | Calc. Density (STP) | (g/ml) | 1.038 | 1.051 | 1.050 | 1.048 | 1.045 | 1.047 | Calcium fluoride | | |
| 31 | CO ₂ Gas Analysis | (%) | 19.97 | 18.76 | 22.41 | 35.53 | 33.79 | 26.16 | | | |
| 32 | H ₂ S Gas Analysis*** | (%) | 0.0289 | 0.0292 | 0.0296 | 0.0306 | 0.0151 | 0.0269 | Iron Carbonate | | |
| 33 | Total H ₂ Saq | (mgH ₂ S/l) | 1.00 | 1.00 | 1.00 | 1.00 | 0.50 | 0.90 | -0.74 | -0.51 | 0.23 |
| 34 | pH, measured (STP) | pH | 5.67 | 5.76 | 5.72 | 5.54 | 5.55 | 5.63 | Inhibitor needed (mg/L) | | |
| | Choose one option to calculate SI† | 0-CO ₂ +Alk, 1-pH+Alk, 2-CO ₂ +pH | 0 | 0 | 0 | 0 | 0 | | Calcite | NTMP | |
| 35 | Gas/day(thousand cf/day) | (Mcf/D) | | | | | | 0 | 0.00 | 0.00 | |
| 36 | Oil/Day | (B/D) | 0 | 0 | 1 | 1 | 1 | 4 | Barite | BHPMP | |
| 37 | Water/Day | (B/D) | 100 | 100 | 100 | 100 | 100 | 500 | 0.00 | 0.00 | |
| 38 | For mixed brines, enter values for temperatures and pressures in Cells (H40-H43) | | | | | | | | (Enter H40-H43) | | pH |
| 39 | Initial T | (F) | 66.0 | 71.0 | 70.0 | 41.0 | 49.0 | 60.0 | 5.69 | 5.60 | |
| 40 | Final T | (F) | 66.0 | 71.0 | 70.0 | 41.0 | 49.0 | 89.0 | Viscosity (Centipoise) | | |
| 41 | Initial P | (psia) | 25.0 | 25.0 | 25.0 | 25.0 | 25.0 | 25.0 | 1.196 | 0.826 | |
| 42 | Final P | (psia) | 25.0 | 25.0 | 25.0 | 25.0 | 25.0 | 120.0 | Heat Capacity (cal/ml/°C) | | |
| 43 | Use TP on Calcite sheet? | 1-Yes;0-No | | | | | | | 0.955 | 0.959 | |
| 44 | API Oil Grav. | API grav. | | | | | | 30.00 | Inhibitor needed (mg/L) | | |
| 45 | Gas Sp.Grav. | Sp.Grav. | | | | | | 0.60 | Gypsum | HDTMP | |
| 46 | MeOH/Day | (B/D) | 0 | | | | | 0 | 0.00 | 0.00 | |
| 47 | MEG/Day | (B/D) | 0 | | | | | 0 | Anhydrite | HDTMP | |
| 48 | Conc. Multiplier | | | | | | | | 0.00 | 0.00 | |
| 49 | H ⁺ (Strong acid) † | (N) | | | | | | | | | |
| 50 | OH ⁻ (Strong base) † | (N) | | | | | | | | | |
| 51 | Quality Control Checks at STP: | | | | | | | | | | |
| 52 | H ₂ S Gas | (%) | | | | | | | | | |
| 53 | Total H ₂ Saq (STP) | (mgH ₂ S/l) | | | | | | | | | |
| 54 | pH Calculated | (pH) | | | | | | | | | |
| 55 | PCO ₂ Calculated | (%) | | | | | | | | | |
| 56 | Alkalinity Calculated | (mg/l) as HCO ₃ | | | | | | | | | |
| 57 | ΣCations= | (equiv./l) | | | | | | | | | |
| 58 | ΣAnions= | (equiv./l) | | | | | | | | | |
| 59 | Calc TDS= | (mg/l) | | | | | | | | | |
| 60 | Inhibitor Selection | Input | Unit | # | Inhibitor | Unit Converter (From metric to English) | | | Value | | |
| 61 | Protection Time | 120 | min | 1 | NTMP | From Unit | Value | To Unit | Value | | |
| 62 | Have ScaleSoftPitzer | | | 2 | BHPMP | °C | 80 | °F | 176 | | |
| 63 | pick inhibitor for you? | 1 | 1-Yes;0-No | 3 | PAA | m ³ | 100 | ft ³ | 3,531 | | |
| 64 | If No, inhibitor # is: | 4 | # | 4 | DTPMP | m ³ | 100 | bbl(42 US gal) | 629 | | |
| 65 | If you select Mixed, | | | 5 | PPCA | MPa | 1,000 | psia | 145,074 | | |
| 66 | 1 st inhibitor # is: | 1 | # | 6 | SPA | Bar | 496 | psia | 7,194 | | |
| 67 | % of 1 st inhibitor is: | 50 | % | 7 | HEDP | Torr | 10,000 | psia | 193 | | |
| 68 | 2 nd inhibitor # is: | 2 | # | 8 | HDTMP | Gal | 10,000 | bbl(42 US gal) | 238 | | |
| 69 | Display act. coeffs? | 0 | 1-Yes;0-No | 9 | Average | Liters | 10,000 | bbl(42 US gal) | 63 | | |
| 70 | | | | 10 | Mixed | | | | | | |

Saturation Index Calculations

Champion Technologies, Inc.
(Based on the Tomson-Oddo Model)

Brine 1: Ward Feed Yard 34-1

Brine 2: Ward Feed Yard 4-1

Brine 3: Clinesmith 5-4

Brine 4: Clinesmith 1

Brine 5: Clinesmith 2

| Component (mg/L) | Ratio | | | | | Mixed Brine |
|--------------------------|-------------|-------------|-------------|-------------|------------|-------------|
| | 20% Brine 1 | 20% Brine 2 | 20% Brine 3 | 20% Brine 4 | 20 Brine 5 | |
| Calcium | 1836 | 2452 | 2044 | 1920 | 1948 | 1952 |
| Magnesium | 1096 | 872 | 1200 | 953 | 858 | 865 |
| Barium | 0 | 0 | 0 | 0 | 0 | 0 |
| Strontium | 0 | 0 | 0 | 0 | 0 | 0 |
| Bicarbonate | 190 | 234 | 259 | 268 | 254 | 253 |
| Sulfate | 1 | 1 | 8 | 1 | 1 | 1 |
| Chloride | 36299 | 48965 | 47874 | 45632 | 43147 | 43206 |
| CO ₂ in Brine | 246 | 220 | 264 | 422 | 405 | 401 |
| Ionic Strength | 1.12 | 1.48 | 1.46 | 1.38 | 1.31 | 1.31 |
| Temperature (°F) | 89 | 89 | 89 | 89 | 89 | 89 |
| Pressure (psia) | 50 | 50 | 120 | 120 | 120 | 119 |

Saturation Index

| | | | | | | |
|-------------|-------|-------|-------|-------|-------|-------|
| Calcite | -1.71 | -1.41 | -1.48 | -1.68 | -1.69 | -1.69 |
| Gypsum | -3.71 | -3.64 | -2.82 | -3.73 | -3.72 | -3.69 |
| Hemihydrate | -3.70 | -3.65 | -2.83 | -3.74 | -3.71 | -3.69 |
| Anhydrite | -3.89 | -3.79 | -2.97 | -3.89 | -3.88 | -3.85 |
| Barite | N/A | N/A | N/A | N/A | N/A | N/A |
| Celestite | N/A | N/A | N/A | N/A | N/A | N/A |

PTB

| | | | | | | |
|-------------|-----|-----|-----|-----|-----|-----|
| Calcite | N/A | N/A | N/A | N/A | N/A | N/A |
| Gypsum | N/A | N/A | N/A | N/A | N/A | N/A |
| Hemihydrate | N/A | N/A | N/A | N/A | N/A | N/A |
| Anhydrite | N/A | N/A | N/A | N/A | N/A | N/A |
| Barite | N/A | N/A | N/A | N/A | N/A | N/A |
| Celestite | N/A | N/A | N/A | N/A | N/A | N/A |

KANSAS CORPORATION COMMISSION
OIL & GAS CONSERVATION DIVISION
WELL COMPLETION FORM
WELL HISTORY - DESCRIPTION OF WELL & LEASE

Form ACO-1
September 1999
Form Must Be Typed

ORIGINAL

Operator: License # 33344
Name: Quest Cherokee, LLC
Address: 211 W. 14th Street
City/State/Zip: Chanute, KS 66720
Purchaser: Bluestem Pipeline, LLC
Operator Contact Person: Jennifer R. Ammann
Phone: (620) 431-9500
Contractor: Name: TXD
License: 33837
Wellsite Geologist: Ken Recoy
Designate Type of Completion:
 New Well Re-Entry Workover
 Oil SWD SLOW Temp. Abd.
 Gas ENHR SIGW
 Dry Other (Core, WSW, Expl., Cathodic, etc)
If Workover/Re-entry: Old Well Info as follows:
Operator: _____
Well Name: _____
Original Comp. Date: _____ Original Total Depth: _____
 Deepening Re-perf. Conv. to Enhr./SWD
 Plug Back _____ Plug Back Total Depth _____
 Commingled _____ Docket No. _____
 Dual Completion _____ Docket No. _____
 Other (SWD or Enhr.?) _____ Docket No. _____
4/14/07 4/27/07 4/27/07
Spud Date or Date Reached TD Completion Date or
Recompletion Date Recompletion Date

CONFIDENTIAL

API No. 15 - 133-26896-0000
County: Neosho
ne _ se _ sw _ se Sec. 22 Twp. 28 S. R. 18 East West
510 feet from (S) N (circle one) Line of Section
1600 feet from (E) W (circle one) Line of Section
Footages Calculated from Nearest Outside Section Corner:
(circle one) NE (SE) NW SW
Lease Name: Taylor, Wayne L. Well #: 22-4
Field Name: Cherokee Basin CBM
Producing Formation: Bartlesville
Elevation: Ground: 1010/1011 Kelly Bushing: n/a
Total Depth: 1160 Plug Back Total Depth: 1154.12
Amount of Surface Pipe Set and Cemented at 22 Feet
Multiple Stage Cementing Collar Used? Yes No
If yes, show depth set _____ Feet
If Alternate II completion, cement circulated from 1154.12
feet depth to surface w/ 101 sx cmt.

Drilling Fluid Management Plan AKINS 3509
(Data must be collected from the Reserve Pit)
Chloride content _____ ppm Fluid volume _____ bbls
Dewatering method used _____
Location of fluid disposal if hauled offsite: _____
Operator Name: _____
Lease Name: _____ License No.: _____
Quarter _____ Sec. _____ Twp. _____ S. R. _____ East West
County: _____ Docket No.: _____

INSTRUCTIONS: An original and two copies of this form shall be filed with the Kansas Corporation Commission, 130 S. Market - Room 2078, Wichita, Kansas 67202, within 120 days of the spud date, recompletion, workover or conversion of a well. Rule 82-3-130, 82-3-106 and 82-3-107 apply. Information of side two of this form will be held confidential for a period of 12 months if requested in writing and submitted with the form (see rule 82-3-107 for confidentiality in excess of 12 months). One copy of all wireline logs and geologist well report shall be attached with this form. ALL CEMENTING TICKETS MUST BE ATTACHED. Submit CP-4 form with all plugged wells. Submit CP-111 form with all temporarily abandoned wells.

All requirements of the statutes, rules and regulations promulgated to regulate the oil and gas industry have been fully complied with and the statements herein are complete and correct to the best of my knowledge.

Signature: Jennifer R. Ammann
Title: New Well Development Coordinator Date: 8/15/07
Subscribed and sworn to before me this 15th day of August
20 07.
Notary Public: Terra Klauman
Date Commission Expires: 8-4-2010

KCC Office Use ONLY
 Letter of Confidentiality Received
 If Denied, Yes
 Wireline Log Received
 Geologist Report Received
 UIC Distribution
RECEIVED
KANSAS CORPORATION COMMISSION
AUG 17 2007

TERRA KLAUMAN
Notary Public - State of Kansas
My Appt. Expires 8-4-2010

CONSERVATION DIVISION
WICHITA, KS

Operator Name: Quest Cherokee, LLC Lease Name: Taylor, Wayne L. Well #: 22-4
 Sec. 22 Twp. 28 S. R. 18 East West County: Neosho

INSTRUCTIONS: Show important tops and base of formations penetrated. Detail all cores. Report all final copies of drill stems tests giving interval tested, time tool open and closed, flowing and shut-in pressures, whether shut-in pressure reached static level, hydrostatic pressures, bottom hole temperature, fluid recovery, and flow rates if gas to surface test, along with final chart(s). Attach extra sheet if more space is needed. Attach copy of all Electric Wireline Logs surveyed. Attach final geological well site report.

| | | | | | |
|--|---|---|-----------------|-----------------|---------------------------------|
| Drill Stem Tests Taken (Attach Additional Sheets) | <input type="checkbox"/> Yes <input checked="" type="checkbox"/> No | <input checked="" type="checkbox"/> Log | Formation (Top) | Depth and Datum | <input type="checkbox"/> Sample |
| Samples Sent to Geological Survey | <input type="checkbox"/> Yes <input checked="" type="checkbox"/> No | Name | Top | Datum | |
| Cores Taken | <input type="checkbox"/> Yes <input checked="" type="checkbox"/> No | See attached | | | |
| Electric Log Run (Submit Copy) | <input type="checkbox"/> Yes <input type="checkbox"/> No | | | | |
| List All E. Logs Run: | | | | | |
| Compensated Density Neutron Log | | | | | |
| Dual Induction Log | | | | | |
| Gamma Ray Neutron Log | | | | | |

CONFIDENTIAL

CONFIDENTIAL

| CASING RECORD <input type="checkbox"/> New <input type="checkbox"/> Used | | | | | | | |
|---|-------------------|---------------------------|-------------------|---------------|----------------|--------------|----------------------------|
| Report all strings set-conductor, surface, intermediate, production, etc. | | | | | | | |
| Purpose of String | Size Hole Drilled | Size Casing Set (In O.D.) | Weight Lbs. / Ft. | Setting Depth | Type of Cement | # Sacks Used | Type and Percent Additives |
| Surface | 12-1/4 | 8-5/8" | 22 | 22 | "A" | 5 | |
| Production | 6-3/4 | 4-1/2 | 10.5 | 1154.12 | "A" | 101 | |

| ADDITIONAL CEMENTING / SQUEEZE RECORD | | | | |
|---|------------------|----------------|-------------|----------------------------|
| Purpose: | Depth Top Bottom | Type of Cement | #Sacks Used | Type and Percent Additives |
| <input type="checkbox"/> Perforate | | | | |
| <input type="checkbox"/> Protect Casing | | | | |
| <input type="checkbox"/> Plug Back TD | | | | |
| <input type="checkbox"/> Plug Off Zone | | | | |

| Shots Per Foot | PERFORATION RECORD - Bridge Plugs Set/Type Specify Footage of Each Interval Perforated | Acid, Fracture, Shot, Cement Squeeze Record (Amount and Kind of Material Used) | Depth |
|----------------|---|---|---------|
| 4 | 880-881 | 250gal 7.5%HCLw/ 25 bbls 2%kcl water | 880-881 |

| | | | | |
|---|---|---------------|------------------|--|
| TUBING RECORD | Size 2-3/8" | Set At 927 | Packer At n/a | Liner Run <input type="checkbox"/> Yes <input checked="" type="checkbox"/> No |
| Date of First, Resumerd Production, SWD or Enh: | Producing Method | | | |
| 6/14/07 | <input type="checkbox"/> Flowing <input checked="" type="checkbox"/> Pumping <input type="checkbox"/> Gas Lift <input type="checkbox"/> Other (Explain) | | | |
| Estimated Production Per 24 Hours | Oil Bbls. | Gas Mcf | Water Bbls. | Gas-Oil Ratio Gravity |
| 55-8 | n/a X | 109.8mcf | 0.3bbls | |

Disposition of Gas Vented Sold Used on Lease (If vented, Submit ACO-18.)

METHOD OF COMPLETION Open Hole Perf. Dually Comp. Commingled Other (Specify)

Production Interval

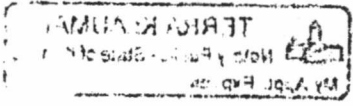

QUEST

Resource Corporation

211 W. 14TH STREET,
CHANUTE, KS 66720
620-431-9500

CONFIDENTIAL

TICKET NUMBER 2149

FIELD TICKET REF #

FOREMAN Joe

621040

TREATMENT REPORT & FIELD TICKET CEMENT

| DATE | WELL NAME & NUMBER | SECTION | TOWNSHIP | RANGE | COUNTY |
|---------|--------------------|---------|----------|-------|--------|
| 4-27-07 | Taylor WAYNE 22-4 | 22 | 20 | 18 | NO |

| FOREMAN / OPERATOR | TIME IN | TIME OUT | LESS LUNCH | TRUCK # | TRAILER # | TRUCK HOURS | EMPLOYEE SIGNATURE |
|--------------------|---------|----------|------------|---------|-----------|-------------|--------------------|
| Joe B | 6:45 | 10:00 | | 903427 | | 3.25 | <i>[Signature]</i> |
| MAVERICK, D | 7:00 | 4:15 | | 903197 | | 3.15 | <i>[Signature]</i> |
| Tyler G | 7:00 | | | 903103 | | 3 | <i>[Signature]</i> |
| Gary C | 7:00 | | | 903142 | 932452 | 3 | <i>[Signature]</i> |
| Bill B | 6:30 | | | 931615 | | 3.5 | <i>[Signature]</i> |
| Paul H | 6:45 | | | | | 3.25 | <i>[Signature]</i> |

JOB TYPE Longstring HOLE SIZE 6 3/4 HOLE DEPTH 1160 CASING SIZE & WEIGHT 4 1/2 10.5
 CASING DEPTH 1154.12 DRILL PIPE _____ TUBING _____ OTHER _____
 SLURRY WEIGHT 14.5 SLURRY VOL _____ WATER gal/sk _____ CEMENT LEFT in CASING 0
 DISPLACEMENT 18.46 DISPLACEMENT PSI _____ MIX PSI _____ RATE 4 bpm

REMARKS:

INSTALLED Cement head RAN 2 SKS gel & 12 bbl dye & 101 SKS of cement to set dye to surface. flush pump. Pump wiper plug to bottom of set that stop.

| | |
|---------|-------------------|
| 1154.12 | ft, 4 1/2" casing |
| 6 | Centralizer |
| 1 | 4 1/2" Foot shoe |

| ACCOUNT CODE | QUANTITY or UNITS | DESCRIPTION OF SERVICES OR PRODUCT | TOTAL AMOUNT |
|--------------|-------------------|--|--------------|
| 903427 | 3.25 hr | Foreman Pickup | |
| 903197 | 3 hr | Cement Pump Truck | |
| 903103 | 3 hr | Bulk Truck | |
| 1104 | 95 SK | Portland Cement | |
| 1124 | 2 | 50/50 POZ Blend Cement Baffle 3 1/2 #3 | |
| 1126 | 1 | OWC - Blend Cement 4 1/2 wiper plug | |
| 1110 | 10 SK | Gilsonite | |
| 1107 | 1 SK | Flo-Seal | |
| 1118 | 2 SK | Premium Gel | |
| 1215A | 1 gal | KCL | |
| 1111B | 2 SK | Sodium Silicate Calchbride | |
| 1123 | 7000 gal | City Water | |
| 903142 | 3 hr | Transport Truck | |
| 932452 | 3 hr | Transport Trailer | |
| 931615 | 3.5 hr | 80 Vac | |

RECEIVED
KANSAS CORPORATION COMMISSION

AUG 17 2007

CONSERVATION DIVISION
WICHITA, KS

TXD SERVICES LP

DRILLERS LOG

TXD SERVICES LP

| | | | | | | | | | | |
|-----------------------------|----------------------------|---------------------|------------------|-----------|-------|---------------|------|--|---------------------|--|
| RIG # | 101 | S. | 22 | T. | 28 | R. | 18 | | | |
| API # | 133-26896 | County: | Neosho | | 436' | 0 | | | | |
| Elev: | 1010' | Location | Kansas | | 498' | 0 | | | | |
| Operator: | Quest Cherokee, LLC | | | | 529' | slight blow | | | | |
| Address: | 9520 N. May Ave, Suite 300 | | | | 653' | 15 - 1/2" | 24.5 | | | |
| | Oklahoma City, OK. 73120 | | | | 901' | 1,612,000 mcf | | | | |
| | | | | | 1087' | 2million+ | | | | |
| Well # | 22-4 | Lease Name | Taylor, Wayne L. | | | | | | | |
| Footage Location | 1510 ft from the | | S | Line | | | | | | |
| | 1600 ft from the | | E | Line | | | | | | |
| Drilling Contractor: | TXD SERVICES LP | | | | | | | | CONFIDENTIAL | |
| Spud Date: | 4/19/2007 | Geologist: | | | | | | | | |
| Date Comp: | 4/27/2007 | Total Depth: | 1170' | | | | | | | |
| Exact spot Location: | SW SE | | | | | | | | | |
| | | | | | | | | | | |
| | Surface | Production | | | | | | | | |
| Size Hole | 12-1/4" | 6-3/4" | | | | | | | | |
| Size Casing | 8-5/8" | 4-1/2" | | | | | | | | |
| Weight | 24# | | | | | | | | | |
| Setting Depth | 21' | | | | | | | | | |
| Type Cement | portland | | | | | | | | | |
| Sacks | | | | | | | | | | |

| Formation | Top | Btm. | Formation | Top | Btm. | Formation | Top | Btm. |
|-----------|-----|------|-----------|-----|------|------------|-----|------|
| top soil | 0 | 3 | lime | 295 | 337 | shale | 568 | 590 |
| shale | 3 | 42 | shale | 337 | 343 | sand | 590 | 598 |
| lime | 42 | 60 | b.shale | 343 | 346 | shale | 598 | 610 |
| shale | 60 | 100 | shale | 346 | 367 | lime | 610 | 627 |
| lime | 100 | 111 | lime | 367 | 369 | shale | 627 | 629 |
| shale | 111 | 123 | shale | 369 | 400 | b.shale | 629 | 633 |
| lime | 123 | 182 | b.shale | 400 | 402 | shale | 633 | 636 |
| shale | 182 | 187 | shale | 402 | 405 | lime | 636 | 644 |
| lime | 187 | 190 | lime | 405 | 425 | shale | 644 | 768 |
| shale | 190 | 192 | shale | 425 | 436 | sand | 768 | 790 |
| sand | 192 | 216 | lime | 436 | 445 | sand/shale | 790 | 799 |
| coal | 216 | 217 | shale | 445 | 452 | coal | 799 | 800 |
| shale | 217 | 227 | sand | 452 | 460 | shale | 800 | 816 |
| coal | 227 | 228 | shale | 460 | 475 | oil sand | 816 | 827 |
| shale | 228 | 230 | coal | 475 | 476 | shale | 827 | 861 |
| lime | 230 | 250 | shale | 476 | 519 | sand | 861 | 869 |
| shale | 250 | 257 | lime | 519 | 525 | shale | 869 | 878 |
| lime | 257 | 269 | shale | 525 | 526 | oil sand | 878 | 885 |
| shale | 269 | 273 | coal | 526 | 527 | shale | 885 | 890 |
| b.shale | 273 | 276 | shale | 527 | 529 | sand | 890 | 894 |
| shale | 276 | 283 | lime | 529 | 565 | shale | 894 | 910 |
| lime | 283 | 288 | shale | 565 | 567 | coal | 910 | 911 |
| sand | 288 | 295 | b.shale | 567 | 568 | shale | 911 | 972 |

290' added water

RECEIVED
KANSAS CORPORATION COMMISSION

AUG 17 2007

8-15-2009

9520 N. May, Suite 300
Oklahoma City, OK 73120
405-488-1304
405-840-1156 fax

QUEST

Resource Corporation

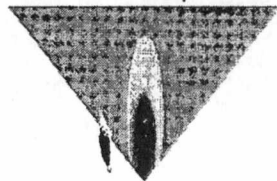

211 West 14th Street
Chanute, KS 66720
620-431-9500
620-431-9501 fax

August 15th, 2007

CONFIDENTIAL

Kansas Corporation Commission
130 S. Market – Room 2078
Wichita, KS 67202

To Whom It May Concern:

RE: Taylor, Wayne L. 22-4
API # 15-133-26896-0000
Sec22-T28S-R18E

At this time we would like to request confidentiality for a period of two years on the above named well location in accordance with Regulation #82-3-107 (e).

I have attached a copy of the ACO-1 for your reference.

Thank you for your time and consideration in this matter.

Sincerely,

Jennifer R. Ammann
New Well Development Coordinator

Enclosure

RECEIVED
KANSAS CORPORATION COMMISSION

AUG 17 2007

CONSERVATION DIVISION
WICHITA, KS

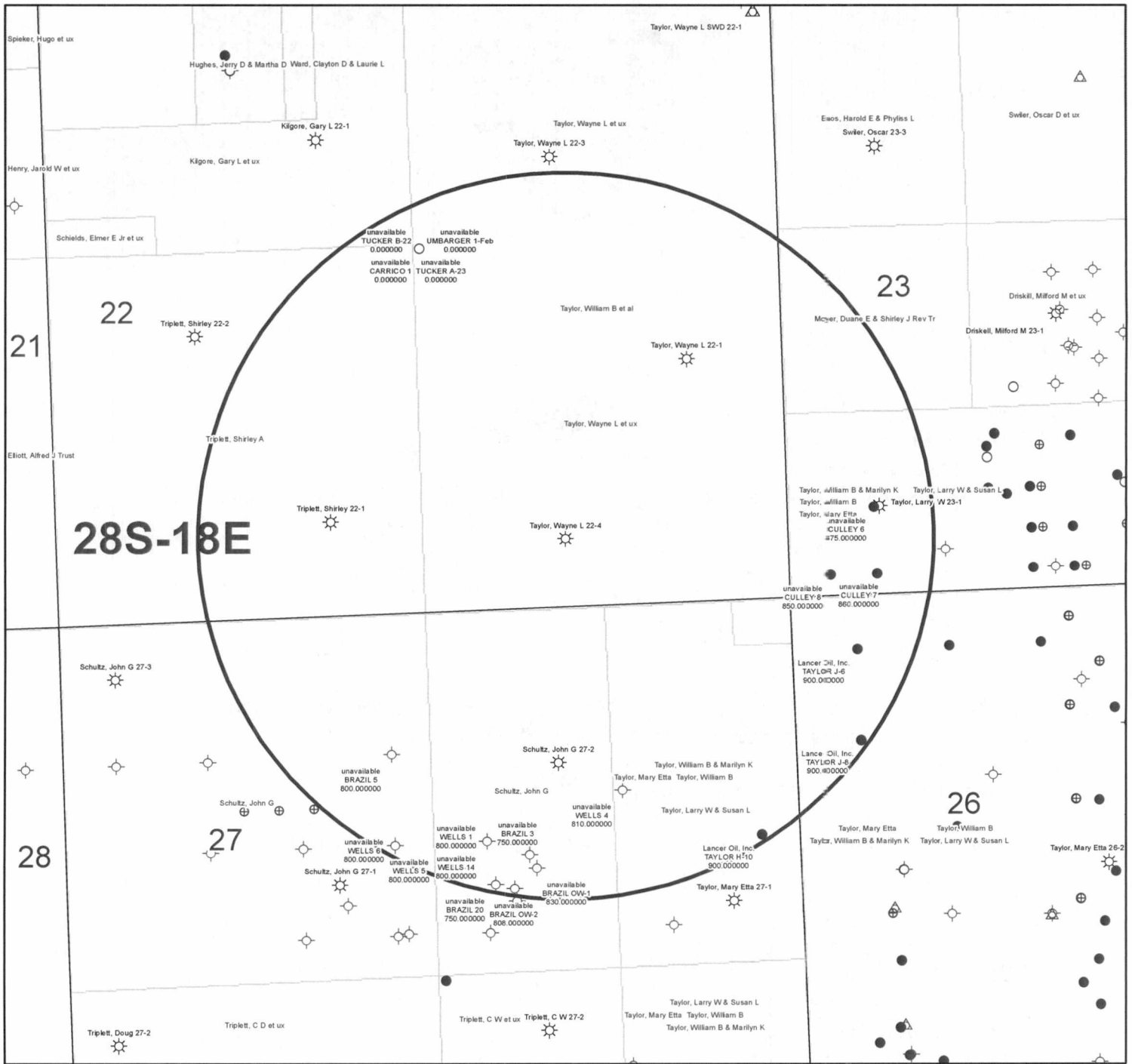

| KGS STATUS | |
|------------|---------|
| ⊙ | DA/PA |
| ⊕ | EOR |
| ★ | GAS |
| △ | INJ/SWD |
| ● | OIL |
| ★ | OIL/GAS |
| ○ | OTHER |

Taylor, Wayne L 22-4
 22-28S-18E
 1" = 1,000'

POSTROCK



Current Completion

WELL : Taylor, Wayne L 22-4
FIELD : Cherokee Basin
STATE : Kansas
COUNTY : Neosho

SPUD DATE : 4/14/2007
COMP. Date : 4/27/2007
API: 15-133-26896-00-00

LOCATION: 22-28S-18E (SW,SE)
ELEVATION: 1010'

8 5/8" 22 lb @ 22' Cement w/5 sks

Wellhead/Surface Equipment

| | |
|-----------------|--|
| Tree Connection | |
| Tree | |
| Tubing Head | |
| Bradenhead | |
| Pumping Unit | |
| Compressor | |

Tubular Detail

| Size | Weight | Grade | Cap(bbl/ft) | Date | Depth |
|--------|---------|-------|-------------|------|-------|
| 8 5/8" | 22 lb | | | 2007 | 22' |
| 4 1/2" | 10.5 lb | | .0159 | 2007 | 1154' |
| 2 3/8" | | | | 2007 | 927' |
| | | | | | |
| | | | | | |
| | | | | | |

Downhole Equipment Detail

Empty box for Downhole Equipment Detail.

Completion Data

| |
|--------------------------------|
| Original as GAS Well per ACO-1 |
| 250 gals 7.5% HCL |
| 25 bbls water |

Perforations

| |
|----------------------------|
| Original Completion: 4 spf |
| 880-881 Bartlesville (5) |

2 3/8" tubing @ 927'

PBTD @ 1154'

4.5" 10.5 lb @ 1154' Cement w/101 sks

Drilled Depth @ 1160'

PREPARED BY: POSTROCK
APPROVED BY: _____

DATE: Sept, 2012
DATE: _____

POSTROCK



LEGEND

PostRock

| | | | |
|-----------------------|------------------|-----------------------------|--------------------------------|
| <p>ESP</p> | <p>Frac Port</p> | <p>SN or Profile Nipple</p> | <p>On-Off Tool</p> |
| <p>Gas Lift Valve</p> | <p>Bit</p> | <p>Perforated Sub</p> | <p>Blast Joints</p> |
| | | <p>Sliding Sleeve</p> | <p>Pkr & Seal Assembly</p> |

| | | | |
|-------------------|-----------------------|-------------------|---------------|
| <p>Fish</p> | <p>Muleshoe Guide</p> | <p>Bladed Bit</p> | <p>TAC</p> |
| <p>Frac Rings</p> | <p>Plunger Lift</p> | <p>Pump</p> | <p>Packer</p> |
| | | <p>Mud Anchor</p> | <p>CIBP</p> |

| | | | | |
|---------------------------|--------------|---------------------|-------------|------------------|
| <p>Casing Restriction</p> | <p>Seals</p> | <p>Cmt Retainer</p> | <p>Fill</p> | <p>Cement PB</p> |
|---------------------------|--------------|---------------------|-------------|------------------|

| | | | | | |
|------------------------|---------------------------|------------------|------------|--------------------|----------------|
| <p>Plug for Nipple</p> | <p>Tubing Restriction</p> | <p>Frac Plug</p> | <p>RBP</p> | <p>Casing Seat</p> | <p>DV Tool</p> |
|------------------------|---------------------------|------------------|------------|--------------------|----------------|

BEFORE THE STATE CORPORATION COMMISSION OF THE STATE OF KANSAS
NOTICE OF FILING APPLICATION

RE: In the Matter of **Postrock Midcontinent Production, LLC** Application for Commingling of Production in the **Taylor, Wayne L 22-4** located in **Neosho** County, Kansas.

TO: All Oil & Gas Producers, Un-leased Mineral Interest Owners, Landowners, and all persons whomsoever concerned.

You, and each of you, are hereby notified that **Postrock Midcontinent Production, LLC** has filed an application to commingle the **Bartlesville and Cattleman** producing formations at the **Taylor, Wayne L 22-4**, located in the **NE SE SW SE, S22-T28S-R18E, Aproximately 507 FSL & 1600 FEL, Neosho** County, Kansas.

Any persons who object to or protest this application shall be required to file their objections or protest with the Conservation Division of the State Corporation Commission of the State of Kansas within fifteen (15) days from the date of this publication. These protests shall be filed pursuant to Commission regulations and must state specific reasons why granting the application may cause waste, violate correlative rights or pollute the natural resources of the State of Kansas.

All persons interested or concerned shall take notice of the foregoing and shall govern themselves accordingly. All person and/or companies wishing to protest this application are required to file a written protest with the Conservation Division of the Kansas Oil and Gas Commission.

Upon the receipt of any protest, the Commission will convene a hearing and protestants will be expected to enter an appearance either through proper legal counsel or as individuals, appearing on their own behalf.

Postrock Midcontinent Production, LLC
210 Park Avenue, Suite 2750
Oklahoma City, Oklahoma 73102
(405) 660-7704

A COPY OF THE AFFIDAVIT OF PUBLICATION MUST ACCOMPANY ALL APPLICATIONS

Affidavit of Publication

STATE OF KANSAS, NEOSHO COUNTY, ss:
Rhonda Howter, being first duly sworn, deposes and says: That *she* is *Classified Manager* of *THE CHANUTE TRIBUNE*, a daily newspaper printed in the State of Kansas, and published in and of general circulation in Neosho County, Kansas, with a general paid circulation on a daily basis in Neosho County, Kansas, and that said newspaper is not a trade, religious or fraternal publication.

Said newspaper is a daily published at least weekly 50 times a year: has been so published continuously and uninterruptedly in said county and state for a period of more than five years prior to the first publication of said notice; and has been admitted at the post office of Chanute, in said county as second class matter.

That the attached notice is a true copy thereof and was published in the regular and entire issue of said newspaper for 1 consecutive time, the first publication thereof being made as aforesaid on the 10 day of October 2012, with subsequent publications being made on the following dates:

_____, 2012 _____, 2012
_____, 2012 _____, 2012

Rhonda Howter

Subscribed and sworn to and before me this 10 day of October, 2012

[Signature]
Notary Public

My commission expires: January 9, 2015
Printer's Fee \$ 108.30
Affidavit, Notary's Fee \$ 3.00
Additional Copies \$ _____
Total Publication Fees \$ 111.30

SHANNA L. GUIOT
Notary Public - State of Kansas
Appt. Expires

AFFIDAVIT

STATE OF KANSAS \
- SS.
County of Sedgwick /

Mark Fletchall, of lawful age, being first duly sworn, deposeth and saith: That he is Record Clerk of The Wichita Eagle, a daily newspaper published in the City of Wichita, County of Sedgwick, State of Kansas, and having a general paid circulation on a daily basis in said County, which said newspaper has been continuously and uninterruptedly published in said County for more than one year prior to the first publication of the notice hereinafter mentioned, and which said newspaper has been entered as second class mail matter at the United States Post Office in Wichita, Kansas, and which said newspaper is not a trade, religious or fraternal publication and that a notice of a true copy is hereto attached was published in the regular and entire Morning issue of said The Wichita Eagle for 1 issues, that the first publication of said notice was

made as aforesaid on the 11th of

October A.D. 2012, with

subsequent publications being made on the following dates:

And affiant further says that he has personal knowledge of the statements above set forth and that they are true.

Mark Fletchall

Subscribed and sworn to before me this

11th day of October, 2012

PENNY L. CASE
Notary Public - State of Kansas
My Appt. Expires 5/28/2014

Penny L. Case
Notary Public Sedgwick County, Kansas

Printer's Fee : \$130.00

LEGAL PUBLICATION
PUBLISHED IN THE WICHITA EAGLE
OCTOBER 11, 2012 (3211682)
BEFORE THE STATE CORPORATION COMMISSION
OF THE STATE OF KANSAS
NOTICE OF FILING APPLICATION
RE: In the Matter of Postrock Midcontinent
Production, LLC Application for Commingling
of Production in the Taylor, Wayne L. 22-4
located in Neosho County, Kansas.
TO: All Oil & Gas Producers, Unleased Mineral
Interest Owners, Landowners, and all persons
whomever concerned.
You, and each of you, are hereby notified
that Postrock Midcontinent Production,
LLC has filed an application to commingle
the Bartlesville and Cattleman producing
formations at the Taylor, Wayne L. 22-4,
located in the NE SE SW SE S22-T285-R18E,
Approximately 507 FSL & 1+00 FEL, Neosho
County, Kansas.
Any persons who object to or protest
this application shall be required to file their
objections or protest with the Conservation
Division of the State Corporation Commission
of the State of Kansas within fifteen (15)
days from the date of this publication. These
protests shall be filed pursuant to Commission
regulations and must state specific reasons
why granting the application may cause waste,
violate correlative rights or deplete the natural
resources of the State of Kansas.
All persons interested or concerned shall
take notice of the foregoing and shall govern
themselves accordingly. All person and/or
companies wishing to protest this application
are required to file a written protest with the
Conservation Division of the Kansas Oil and
Gas Commission.
Upon the receipt of any protest, the
Commission will convene a hearing and
protestants will be expected to enter an
appearance either through proper legal
counsel or as individuals, appearing on their
own behalf.
Postrock Midcontinent Production, LLC
210 Park Avenue, Suite 2750
Oklahoma City, Oklahoma 73102
(405) 660-7704

Affidavit of Notice Served

Re: Application for: APPLICATION FOR COMMINGLING OF PRODUCTION OR FLUIDS ACO-4

Well Name: TAYLOR, WAYNE L 22-4 Legal Location: NESESWSE S22-T28S-R18E

The undersigned hereby certifies that he / she is a duly authorized agent for the applicant, and that on the day 25th of OCTOBER, 2012, a true and correct copy of the application referenced above was delivered or mailed to the following parties:

Note: A copy of this affidavit must be served as a part of the application.

Name

Address (Attach additional sheets if necessary)

LANCER OIL, INC

PO BOX 34, PIQUA, KS 66761

JERRY L & RONDA JO HAINES

6975 150TH RD, CHANUTE, KS 66720

I further attest that notice of the filing of this application was published in the THE CHANUTE TRIBUNE, the official county publication of NEOSHO county. A copy of the affidavit of this publication is attached.

Signed this 25th day of OCTOBER, 2012

[Signature]
Applicant or Duly Authorized Agent

Subscribed and sworn to before me this 25th day of OCTOBER, 2012

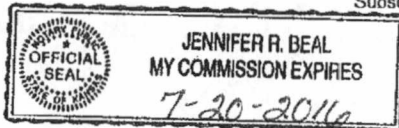

Jennifer R. Beal
Notary Public

My Commission Expires: July 20, 2016

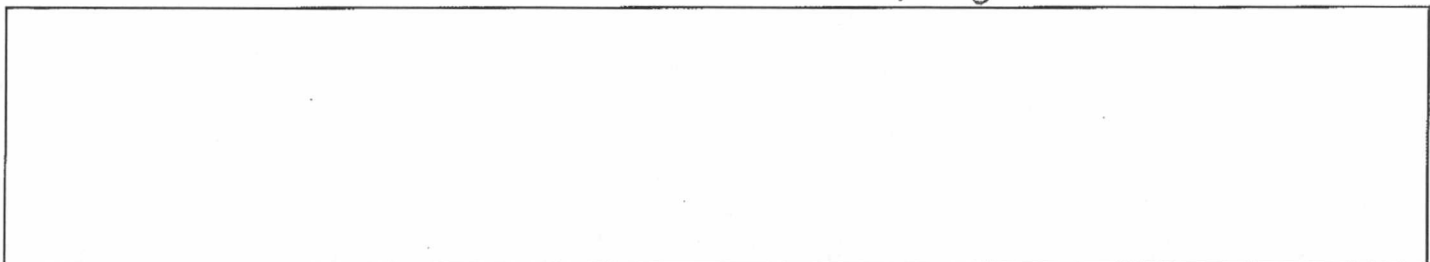

TAYLOR, WAYNE L 22-4-APPLICATION FOR COMMINGLING OF PRODUCTION OR FLUIDS

[]

[]

Offset Operators, Unleased Mineral Owners and Landowners acreage
(Attach additional sheets if necessary)

Name:

Legal Description of Leasehold:

SEE ATTACHED

I hereby certify that the statements made herein are true and correct to the best of my knowledge and belief.

W L Taylor

Applicant or Duly Authorized Agent

Subscribed and sworn before me this 25th day of OCTOBER, 2012

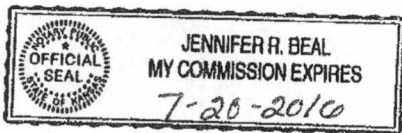

Jennifer R Beal

Notary Public

My Commission Expires: July 20, 2010

[Empty box for additional notes or signatures]

TAYLOR, WAYNE L 22-4

| LEGAL LOCATION | SPOT | CURR_OPERA |
|-----------------------|-------------|-------------------|
| S27-T28S-R18E | NE SE NE | Lancer Oil, Inc. |
| S26-T28S-R18E | NW NW NW | Lancer Oil, Inc. |
| S26-T28S-R18E | SW NW NW | Lancer Oil, Inc. |

Conservation Division
Finney State Office Building
130 S. Market, Rm. 2078
Wichita, KS 67202-3802



Phone: 316-337-6200
Fax: 316-337-6211
<http://kcc.ks.gov/>

Mark Sievers, Chairman
Thomas E. Wright, Commissioner
Shari Feist Albrecht, Commissioner

Sam Brownback, Governor

November 9, 2012

Clark Edwards
PostRock Midcontinent Production LLC
Oklahoma Tower
210 Park Ave, Ste 2750
Oklahoma City, OK 73102

RE: Approved Commingling CO101223
Taylor, Wayne L. 22-4, Sec. 22-T28S-R18E, Neosho County
API No. 15-133-26896-00-00

Dear Mr. Edwards:

Your Application for Commingling (ACO-4) for the above described well, received by the KCC on October 26, 2012, has been reviewed and approved by the Kansas Corporation Commission (KCC) per K.A.R. 82-3-123. Notice was examined and found to be proper per K.A.R. 82-3-135a. No protest had been filed within the 15-day protest period.

Based upon the depth of the Bartlesville formation perforations, total oil production shall not exceed 100 BOPD and total gas production shall not exceed 50% of the absolute open flow (AOF).

File form ACO-1 upon re-completion of the well to commingle.

Commingling ID number CO101223 has been assigned to this approved application. Use this number for well completion reports (ACO-1) and other correspondence that may concern this approved commingling.

Sincerely,

Rick Hestermann
Production Department