



KANSAS CORPORATION COMMISSION 1097415
OIL & GAS CONSERVATION DIVISION

Form ACO-4
Form must be typed
March 2009

APPLICATION FOR COMMINGLING OF *Commingling ID #* **CO111205**
PRODUCTION (K.A.R. 82-3-123) OR FLUIDS (K.A.R. 82-3-123a)

OPERATOR: License # 33343
Name: PostRock Midcontinent Production LLC
Address 1: Oklahoma Tower
Address 2: 210 Park Ave, Ste 2750
City: OKLAHOMA CITY State: OK Zip: 73102 +
Contact Person: CLARK EDWARDS
Phone: (620) 432-4200

API No. 15 - 15-205-26593-00-00
Spot Description: _____
SE NW NE NW Sec. 11 Twp. 28 S. R. 16 East West
617 Feet from North / South Line of Section
1934 Feet from East / West Line of Section
County: Wilson
Lease Name: OLSON RANDALL G Well #: 11-1

1. Name and upper and lower limit of each production interval to be commingled:
Formation: SUMMIT (Perfs): 843-847
Formation: MULKY (Perfs): 857-861
Formation: BEVIER (Perfs): 921-923
Formation: CROWEBURG (Perfs): 939-942
Formation: FLEMING (Perfs): 974-976

2. Estimated amount of fluid production to be commingled from each interval:
Formation: SUMMIT BOPD: 0 MCFPD: 3.57 BWPD: 5.71
Formation: MULKY BOPD: 0 MCFPD: 3.57 BWPD: 5.71
Formation: BEVIER BOPD: 0 MCFPD: 3.57 BWPD: 5.71
Formation: CROWEBURG BOPD: 0 MCFPD: 3.57 BWPD: 5.71
Formation: FLEMING BOPD: 0 MCFPD: 3.57 BWPD: 5.71

3. Plat map showing the location of the subject well, all other wells on the subject lease, and all wells on offsetting leases within a 1/2 mile radius of the subject well, and for each well the names and addresses of the lessee of record or operator.

4. Signed certificate showing service of the application and affidavit of publication as required in K.A.R. 82-3-135a.

For Commingling of PRODUCTION ONLY, include the following:

5. Wireline log of subject well. Previously Filed with ACO-1: Yes No
 6. Complete Form ACO-1 (*Well Completion form*) for the subject well.

For Commingling of FLUIDS ONLY, include the following:

7. Well construction diagram of subject well.
 8. Any available water chemistry data demonstrating the compatibility of the fluids to be commingled.

AFFIDAVIT: I am the affiant and hereby certify that to the best of my current information, knowledge and personal belief, this request for commingling is true and proper and I have no information or knowledge, which is inconsistent with the information supplied in this application.

Submitted Electronically

KCC Office Use Only	
<input type="checkbox"/> Denied	<input checked="" type="checkbox"/> Approved
15-Day Periods Ends: <u>11/14/2012</u>	
Approved By: <u>Rick Hestermann</u>	Date: <u>11/14/2012</u>

Protests may be filed by any party having a valid interest in the application. Protests must be in writing and comply with K.A.R. 82-3-135b and must be filed within 15 days of publication of the notice of application.

	A	B	C	D	E	F	G	H	I	J	K
1	Produced Fluids #		1	2	3	4	5		Click here to run SSP Goal Seek SSP		Click
2	Parameters	Units	Input	Input	Input	Input	Input				Click
3	Select the brines	Select fluid by checking the box(es),	<input type="checkbox"/>	<input type="checkbox"/>	<input type="checkbox"/>	<input type="checkbox"/>	<input type="checkbox"/>	Mixed brine:			Click
4	Sample ID	Row 3						Cell H28 is			Click
5	Date	3/19/2012	3/4/2012	3/14/2012	1/20/2012	1/20/2012		STP calc. pH.			Click
6	Operator	PostRock	PostRock	PostRock	PostRock	PostRock		Cells H35-38			Click
7	Well Name	Ward Feed	Ward Feed	Clinesmith	Clinesmith	Clinesmith		are used in mixed brines			Click
8	Location	#34-1	#4-1	#5-4	#1	#2		calculations.			Click
9	Field	CBM	CBM	Bartles	Bartles	Bartles					
10	Na ⁺	(mg/l)*	19,433.00	27,381.00	26,534.00	25689.00	24220.00	24654.20	Initial(BH)	Final(WH)	SISR (Final-Initial)
11	K ⁺ (if not known =0)	(mg/l)						0.00	Saturation Index values		
12	Mg ²⁺	(mg/l)	1,096.00	872.00	1,200.00	953.00	858.00	995.91	Calcite		
13	Ca ²⁺	(mg/l)	1,836.00	2,452.00	2,044.00	1920.00	1948.00	2040.23	-0.73	-0.60	0.13
14	Sr ²⁺	(mg/l)						0.00	Barite		
15	Ba ²⁺	(mg/l)						0.00			
16	Fe ²⁺	(mg/l)	40.00	21.00	18.00	82.00	90.00	50.21	Halite		
17	Zn ²⁺	(mg/l)						0.00	-1.77	-1.80	-0.03
18	Pb ²⁺	(mg/l)						0.00	Gypsum		
19	Cl ⁻	(mg/l)	36,299.00	48,965.00	47,874.00	45632.00	43147.00	44388.44	-3.19	-3.18	0.00
20	SO ₄ ²⁻	(mg/l)	1.00	1.00	8.00	1.00	1.00	2.40	Hemihydrate		
21	F ⁻	(mg/l)						0.00	-3.96	-3.90	0.06
22	Br ⁻	(mg/l)						0.00	Anhydrite		
23	SiO ₂	(mg/l) SiO ₂						0.00	-3.47	-3.36	0.12
24	HCO ₃ Alkalinity**	(mg/l as HCO ₃)	190.00	234.00	259.00	268.00	254.00	241.03	Celestite		
25	CO ₃ Alkalinity	(mg/l as CO ₃)									
26	Carboxylic acids**	(mg/l)						0.00	Iron Sulfide		
27	Ammonia	(mg/L) NH ₃						0.00	-0.16	-0.22	-0.06
28	Borate	(mg/L) H ₃ BO ₃						0.00	Zinc Sulfide		
29	TDS (Measured)	(mg/l)						72781			
30	Calc. Density (STP)	(g/ml)	1.038	1.051	1.050	1.048	1.045	1.047	Calcium fluoride		
31	CO ₂ Gas Analysis	(%)	19.97	18.76	22.41	35.53	33.79	26.16			
32	H ₂ S Gas Analysis***	(%)	0.0289	0.0292	0.0296	0.0306	0.0151	0.0269	Iron Carbonate		
33	Total H ₂ Saq	(mgH ₂ S/l)	1.00	1.00	1.00	1.00	0.50	0.90	-0.74	-0.51	0.23
34	pH, measured (STP)	pH	5.67	5.76	5.72	5.54	5.55	5.63	Inhibitor needed (mg/L)		
	Choose one option to calculate SI?	0-CO ₂ %+Aik. 1-pH+Aik. 2-CO ₂ %+pH							Calcite	NTMP	
35	Gas/day(thousand cf/day)	(Mcf/D)	0	0	0	0	0	0	0.00	0.00	
36	Oil/Day	(B/D)	0	0	1	1	1	4	Barite	BHPMP	
37	Water/Day	(B/D)	100	100	100	100	100	500	0.00	0.00	
38	For mixed brines, enter values for temperatures and pressures in Cells (H40-H43)								(Enter H40-H43)		
39	Initial T	(F)	66.0	71.0	70.0	41.0	49.0	60.0	5.69	5.60	
40	Final T	(F)	66.0	71.0	70.0	41.0	49.0	89.0	Viscosity (CentiPoise)		
41	Initial P	(psia)	25.0	25.0	25.0	25.0	25.0	25.0	1.196	0.826	
42	Final P	(psia)	25.0	25.0	25.0	25.0	25.0	120.0	Heat Capacity (cal/ml°C)		
43	Use TP on Calcite sheet?	1-Yes;0-No							0.955	0.959	
44	API Oil Grav.	API grav.						30.00	Inhibitor needed (mg/L)		
45	Gas Sp.Grav.	Sp.Grav.						0.60	Gypsum	HDTMP	
46	MeOH/Day	(B/D)	0					0	0.00	0.00	
47	MEG/Day	(B/D)	0					0	Anhydrite	HDTMP	
48	Conc. Multiplier								0.00	0.00	
49	H ⁺ (Strong acid) †	(N)									
50	OH ⁻ (Strong base) †	(N)									
51	Quality Control Checks at STP:										
52	H ₂ S Gas	(%)									
53	Total H ₂ Saq (STP)	(mgH ₂ S/l)									
54	pH Calculated	(pH)									
55	PCO ₂ Calculated	(%)									
56	Alkalinity Calculated	(mg/l) as HCO ₃									
57	ECations=	(equiv./l)									
58	EAnions=	(equiv./l)									
59	Calc TDS=	(mg/l)									
60	Inhibitor Selection	Input	Unit	#	Inhibitor	Unit Converter (From metric to English)			Value		
61	Protection Time	120	min	1	NTMP	From Unit	Value	To Unit	Value		
62	Have ScaleSoftPitzer			2	BHPMP	°C	80	°F	176		
63	pick inhibitor for you?	1	1-Yes;0-No	3	PAA	m ³	100	ft ³	3,531		
64	If No, inhibitor # is:	4	#	4	DTPMP	m ³	100	bb(42 US gal)	629		
65	If you select Mixed,			5	PPCA	MPa	1,000	psia	145,074		
66	1 st inhibitor # is:	1	#	6	SPA	Bar	496	psia	7,194		
67	% of 1 st inhibitor is:	50	%	7	HEDP	Torr	10,000	psia	193		
68	2 nd inhibitor # is:	2	#	8	HDTMP	Gal	10,000	bb(42 US gal)	238		
69	Display act. coeffs?	0	1-Yes;0-No	9	Average	Liters	10,000	bb(42 US gal)	63		
70				10	Mixed						

Saturation Index Calculations

Champion Technologies, Inc.
(Based on the Tomson-Oddo Model)

Brine 1: Ward Feed Yard 34-1

Brine 2: Ward Feed Yard 4-1

Brine 3: Clinesmith 5-4

Brine 4: Clinesmith 1

Brine 5: Clinesmith 2

Component (mg/L)	Ratio					Mixed Brine
	20% Brine 1	20% Brine 2	20% Brine 3	20% Brine 4	20 Brine 5	
Calcium	1836	2452	2044	1920	1948	1952
Magnesium	1096	872	1200	953	858	865
Barium	0	0	0	0	0	0
Strontium	0	0	0	0	0	0
Bicarbonate	190	234	259	268	254	253
Sulfate	1	1	8	1	1	1
Chloride	36299	48965	47874	45632	43147	43206
CO ₂ in Brine	246	220	264	422	405	401
Ionic Strength	1.12	1.48	1.46	1.38	1.31	1.31
Temperature (°F)	89	89	89	89	89	89
Pressure (psia)	50	50	120	120	120	119

Saturation Index

Calcite	-1.71	-1.41	-1.48	-1.68	-1.69	-1.69
Gypsum	-3.71	-3.64	-2.82	-3.73	-3.72	-3.69
Hemihydrate	-3.70	-3.65	-2.83	-3.74	-3.71	-3.69
Anhydrite	-3.89	-3.79	-2.97	-3.89	-3.88	-3.85
Barite	N/A	N/A	N/A	N/A	N/A	N/A
Celestite	N/A	N/A	N/A	N/A	N/A	N/A

PTB

Calcite	N/A	N/A	N/A	N/A	N/A	N/A
Gypsum	N/A	N/A	N/A	N/A	N/A	N/A
Hemihydrate	N/A	N/A	N/A	N/A	N/A	N/A
Anhydrite	N/A	N/A	N/A	N/A	N/A	N/A
Barite	N/A	N/A	N/A	N/A	N/A	N/A
Celestite	N/A	N/A	N/A	N/A	N/A	N/A

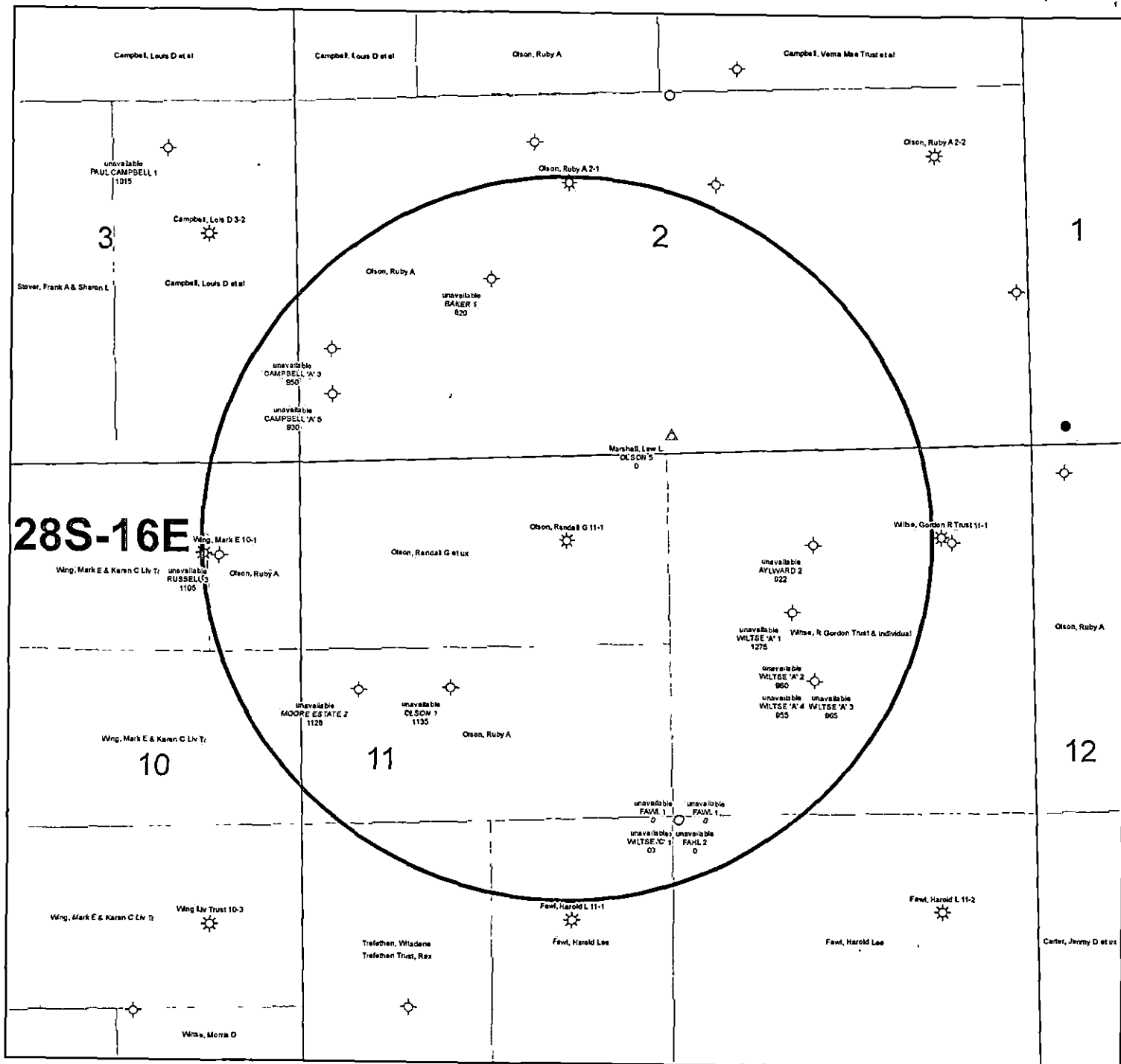

KGS STATUS	
◇	DA/PA
⊕	EOR
☼	GAS
△	INJ/SWD
●	OIL
✱	OIL/GAS
○	OTHER

Olson, Randall G 11-1
 11-28S-16E
 1" = 1,000'

KANSAS CORPORATION COMMISSION
OIL & GAS CONSERVATION DIVISION

ORIGINAL

Form ACO-1
September 1999
Form Must Be Typed

WELL COMPLETION FORM
WELL HISTORY - DESCRIPTION OF WELL & LEASE

Operator: License # 33344
Name: Quest Cherokee, LLC
Address: 211 W. 14th Street
City/State/Zip: Chanute, KS 66720
Purchaser: Bluestem Pipeline, LLC
Operator Contact Person: Jennifer R. Ammann
Phone: (620) 431-9500
Contractor: Name: MOKAT
License: 5831
Wellsite Geologist: Ken Recoy

Designate Type of Completion:
 New Well Re-Entry Workover
 Oil SWD SLOW Temp. Abd.
 Gas ENHR SIGW
 Dry Other (Core, WSW, Expl., Cathodic, etc)

If Workover/Re-entry: Old Well Info as follows:

Operator: _____
Well Name: _____
Original Comp. Date: _____ Original Total Depth: _____
 Deepening Re-perf. Conv. to Enhr./SWD
 Plug Back _____ Plug Back Total Depth _____
 Commingled _____ Docket No. _____
 Dual Completion _____ Docket No. _____
 Other (SWD or Enhr.?) _____ Docket No. _____
5/30/06 6/6/06 6/29/06
Spud Date or Date Reached TD Completion Date or
Recompletion Date Recompletion Date

API No. 15 - 205-26593-00-00
County: Wilson
_____ ne _____ nw Sec. 11 Twp. 28 S. R. 16 East West
660 feet from S (circle one) Line of Section
1980 feet from E (circle one) Line of Section

Footages Calculated from Nearest Outside Section Corner:
(circle one) NE SE NW SW
Lease Name: Olson, Randall G. Well #: 11-1
Field Name: Cherokee Basin CBM
Producing Formation: Multiple
Elevation: Ground: 1055 Kelly Bushing: n/a
Total Depth: 1300 Plug Back Total Depth: 1288
Amount of Surface Pipe Set and Cemented at 20' 5" Feet
Multiple Stage Cementing Collar Used? Yes No
If yes, show depth set _____ Feet
If Alternate II completion, cement circulated from 1288
feet depth to surface w/ 150 _____ sx cmt.

Drilling Fluid Management Plan Alt. II KGR 3/18/08
(Data must be collected from the Reserve Pit)
Chloride content _____ ppm Fluid volume _____ bbls
Dewatering method used _____
Location of fluid disposal if hauled offsite: _____
Operator Name: _____
Lease Name: _____ License No.: 5831-27-2006
Quarter _____ Sec. _____ Twp. _____ East West
County: _____ Docket No.: WICHITA, KS

RECEIVED
KANSAS CORPORATION COMMISSION
SEP-27-2006
CONSERVATION DIVISION
WICHITA, KS

INSTRUCTIONS: An original and two copies of this form shall be filed with the Kansas Corporation Commission, 130 S. Market - Room 2078, Wichita, Kansas 67202, within 120 days of the spud date, recompletion, workover or conversion of a well. Rule 82-3-130, 82-3-106 and 82-3-107 apply. Information of side two of this form will be held confidential for a period of 12 months if requested in writing and submitted with the form (see rule 82-3-107 for confidentiality in excess of 12 months). One copy of all wireline logs and geologist well report shall be attached with this form. ALL CEMENTING TICKETS MUST BE ATTACHED. Submit CP-4 form with all plugged wells. Submit CP-111 form with all temporarily abandoned wells.

All requirements of the statutes, rules and regulations promulgated to regulate the oil and gas industry have been fully complied with and the statements herein are complete and correct to the best of my knowledge.

Signature: Jennifer R. Ammann
Title: New Well Development Coordinator Date: 9/28/06
Subscribed and sworn to before me this 26th day of September,
2006.
Notary Public: Denise V. Venneman
Date Commission Expires: 7-1-08

DENISE V. VENNEMAN
NOTARY PUBLIC
STATE OF KANSAS
MY APPT. EXPIRES 7-1-08

KCC Office Use ONLY
 Letter of Confidentiality Received
If Denied, Yes Date: _____
 Wireline Log Received
 Geologist Report Received
 UIC Distribution

Operator Name: Quest Cherokee, LLC Lease Name: Olson, Randall G. Well #: 11-1
 Sec. 11 Twp. 28 S. R. 16 East West County: Wilson

INSTRUCTIONS: Show important tops and base of formations penetrated. Detail all cores. Report all final copies of drill stems tests giving interval tested, time tool open and closed, flowing and shut-in pressures, whether shut-in pressure reached static level, hydrostatic pressures, bottom hole temperature, fluid recovery, and flow rates if gas to surface test, along with final chart(s). Attach extra sheet if more space is needed. Attach copy of all Electric Wireline Logs surveyed. Attach final geological well site report.

Drill Stem Tests Taken <input type="checkbox"/> Yes <input checked="" type="checkbox"/> No <i>(Attach Additional Sheets)</i> Samples Sent to Geological Survey <input type="checkbox"/> Yes <input checked="" type="checkbox"/> No Cores Taken <input type="checkbox"/> Yes <input checked="" type="checkbox"/> No Electric Log Run <input checked="" type="checkbox"/> Yes <input type="checkbox"/> No <i>(Submit Copy)</i> List All E. Logs Run: Dual Induction Log Compensated Density/Neutron Log Gamma Ray Neutron Log	<input checked="" type="checkbox"/> Log Formation (Top), Depth and Datum <input type="checkbox"/> Sample Name <u>See attached</u> Top Datum
--	--

CASING RECORD <input type="checkbox"/> New <input type="checkbox"/> Used							
Report all strings set-conductor, surface, intermediate, production, etc.							
Purpose of String	Size Hole Drilled	Size Casing Set (In O.D.)	Weight Lbs./FL	Setting Depth	Type of Cement	# Sacks Used	Type and Percent Additives
Surface	12-1/4	8-5/8"	20	20' 5"	"A"	4	
Production	6-3/4	4-1/2	10.5#	1288	"A"	150	

ADDITIONAL CEMENTING / SQUEEZE RECORD				
Purpose:	Depth Top Bottom	Type of Cement	#Sacks Used	Type and Percent Additives
<input type="checkbox"/> Perforate				
<input type="checkbox"/> Protect Casing				
<input type="checkbox"/> Plug Back TD				
<input type="checkbox"/> Plug Off Zone				

Shots Per Foot	PERFORATION RECORD - Bridge Plugs Set/Type Specify Footage of Each Interval Perforated	Acid, Fracture, Shot, Cement Squeeze Record (Amount and Kind of Material Used)		Depth
4	1226-1228	200gal 15% HCL w/ 60 bbls 2% acid water, 3200bbls water w/ 2% KCL, Blocks, 15000# 30/70 sand		1226-1228
4	1062-1064/974-976/939-942/921-923	400gal 15% HCL w/ 31 bbls 2% acid water, 6500bbls water w/ 2% KCL, Blocks, 14000# 30/70 sand		1062-1064/974-976 939-942/921-923
4	857-861/843-847	300gal 15% HCL w/ 30 bbls 2% acid water, 6700bbls water w/ 2% KCL, Blocks, 13200# 30/70 sand		857-861/843-847

TUBING RECORD		Size	Set At	Packer At	Liner Run	<input type="checkbox"/> Yes <input checked="" type="checkbox"/> No	
		2-3/8"	1250	n/a			
Date of First, Resumed Production, SWD or Enthr. <u>waiting on pipeline</u>			Producing Method				
			<input type="checkbox"/> Flowing <input type="checkbox"/> Pumping <input type="checkbox"/> Gas Lift <input type="checkbox"/> Other (Explain)				
Estimated Production Per 24 Hours	Oil Bbls.	Gas Mcf	Water Bbls.	Gas-Oil Ratio	Gravity		

Disposition of Gas METHOD OF COMPLETION Production Interval

Vented Sold Used on Lease
 Open Hole Perf. Dually Comp. Commingled
(If vented, Submit ACO-18.)
 Other (Specify) _____

QUEST

Resource Corporation

211 W. 14TH STREET,
CHANUTE, KS 66720
620-431-9500

TICKET NUMBER 1608

FIELD TICKET REF # _____

FOREMAN Joe/Craig

TREATMENT REPORT & FIELD TICKET CEMENT

DATE	WELL NAME & NUMBER			SECTION	TOWNSHIP	RANGE	COUNTY
6-29-06	OLSON RANDALL 11-1			11	28	16	WA
FOREMAN / OPERATOR	TIME IN	TIME OUT	LESS LUNCH	TRUCK #	TRAILER #	TRUCK HOURS	EMPLOYEE SIGNATURE
Joe B	6:30	12:00		903127		2.5	Joe B
Craig G	6:30	9:30				3	Craig G
Wes T	7:00	12:00		903197		5	Wes T
MAVERICK D	6:45	12:00		903206		5.25	Maverick D
DAVID C	7:00	12:00		903140	932452	5	David C
TROY Whetzel	6:30	12:00		903106		5.5	Troy Whetzel
TROY Wool	7:00	12:00		extra		5	Troy Wool

JOB TYPE Long string HOLE SIZE 6 3/4 HOLE DEPTH 1288 CASING SIZE & WEIGHT 4 1/2 10.5
 CASING DEPTH 1288 DRILL PIPE _____ TUBING _____ OTHER _____
 SLURRY WEIGHT 11.5 SLURRY VOL _____ WATER gal/sk _____ CEMENT LEFT in CASING 0
 DISPLACEMENT 20.64 DISPLACEMENT PSI _____ MIX PSI _____ RATE 46pm

REMARKS:

Ran 2 sks gel swept to surface. Installed cement head Ran 2 sks gel
 of 150 sks of cement To get due to surface Flush pump
 Pump wiper plug to bottom of set float shoe

Drillers T.D. Incorrect by 12 Ft Actual T.D. 1288

ACCOUNT CODE	QUANTITY or UNITS	DESCRIPTION OF SERVICES OR PRODUCT	TOTAL AMOUNT
		4 1/2 weld on collar	
	6	Centralizers	
903140	2 hr	Casing tractor	
607240	2 hr	Casing trailer	
903427	5.5 hr	Foreman Pickup	
903197	5 hr	Cement Pump Truck	
903206	5.25 hr	Bulk Truck	
1104	140 SK	Portland Cement	
1124		50/50 POZ Blend Cement	
1126	1	GWS Blend Cement 4 1/2 wiper plug	
1110	15 SK	Gilsonite	
1107	1.5 SK	Flo-Seal	
1118	4 SK	Premium Gel	
1215A	1 gal	KCL	
1118	3 SK	Sedum Chloride	
1123	7000 gal	City Water	
903140	5 hr	Transport Truck	
932452	5 hr	Transport Trailer	
903106	5.5 hr	80 Vac	
	1	4 1/2 Float shoe	

RECEIVED
 KANSAS CORPORATION COMMISSION
 SEP 27 2006
 CONSERVATION DIVISION
 WICHITA, KS



DATE: 6-7-06

Data from Driller's Log

PW Universal

WELL NAME:	Olson, Randall G.	SECTION:	11	REPORT #:		SPUD DATE:	5/30/2006
WELL #:	11-1	TWP:	28S	DEPTH:	1300		
FIELD:	Cherokee Basin	RANGE:	16E	PBTD:			
COUNTY:	Wilson	ELEVATION:	1055	FOOTAGE:	660	FT FROM:	North
STATE:	Kansas	API #:	15-205-26593-00-00		1980	FT FROM:	West
							NE NW

ACTIVITY DESCRIPTION:

PW Universal, Pete Mukora, drilled to TD 1300 ft. on 6/6/06.

GAS SHOWS:	Gas Measured	COMMENTS:
McHerry Coal	0 mcf/day @ FT. *	Broke pipe off in hole at 650 ft.
Lexington Shale and Coal	0 mcf/day @ FT. *	
Seminole Shale & Coal	0 mcf/day @ 855-858 FT.	
Mudry Shale & Coal	0 mcf/day @ FT. *	
Bevier Coal	0 mcf/day @ 917-919 FT.	
Verdigris Limestone	0 mcf/day @ FT. *	
Crowberry Coal & Shale	0 mcf/day @ 937-940 FT.	
Fleming Coal	0 mcf/day @ 966-968 FT.	
Weir Coal	0 mcf/day @ FT. *	Broke down at 1055 ft. for several days.
Bartlesville Sand	0 mcf/day @ FT. *	Water. Poor samples
Rowe Coal	0 mcf/day @ FT. *	Tri-cone.
Neutral Coal	0 mcf/day @ FT. *	
Riverton Coal	0 mcf/day @ FT. *	
Mississippi	0 mcf/day @ Tap at 1245 FT.	Too much water to take gas tests.
TD: 1300 ft.	0 mcf/day @	Both pits completely full.

Note: * Asterisk denotes Zone not identifiable from Driller's handwritten Notes.

Note: Water coming into the hole from zones drilled affects Drilling and Gas Tests, and these Wells may require a booster to reach target TD.

It should also be noted that in these Wells the water can "kill" the Gas, causing the appearance of much lower Gas Tests in deeper Zones.

Formation Tops and Casing Recommendation made without benefit of viewing open-hole logs first.

Surface Casing @ 20' 5"

Surface Casing Size: 8 5/8"

OTHER COMMENTS:

Information in this report was taken directly from the Driller's hand written notes. All depths and coring checks reflect what the driller recorded during drilling activities. Below Zones fyi only.

Stray Shale / Coal	432-433
Stray Shale / Coal	630-632
Parsons LS / Pink	771-789
Stray Shale / Coal	835-836
Oswego Limestone	836-855
Stray Shale / Coal	895-896
Mineral Coal	975-976
Scammon Coal	984-985
Tobo Coal	1019-1020

CASING RECOMMENDATIONS:

Run casing / Connect to surface

On Site Representative:

Ken McCoy, Senior Geologist, CPG #4630

Cell: (620) 305-9203

krcocx@qrcp.net

End of Drilling Report. Thank You!

RECEIVED
KANSAS CORPORATION COMMISSION

MAR 12 2008

CONSERVATION DIVISION
WICHITA, KS

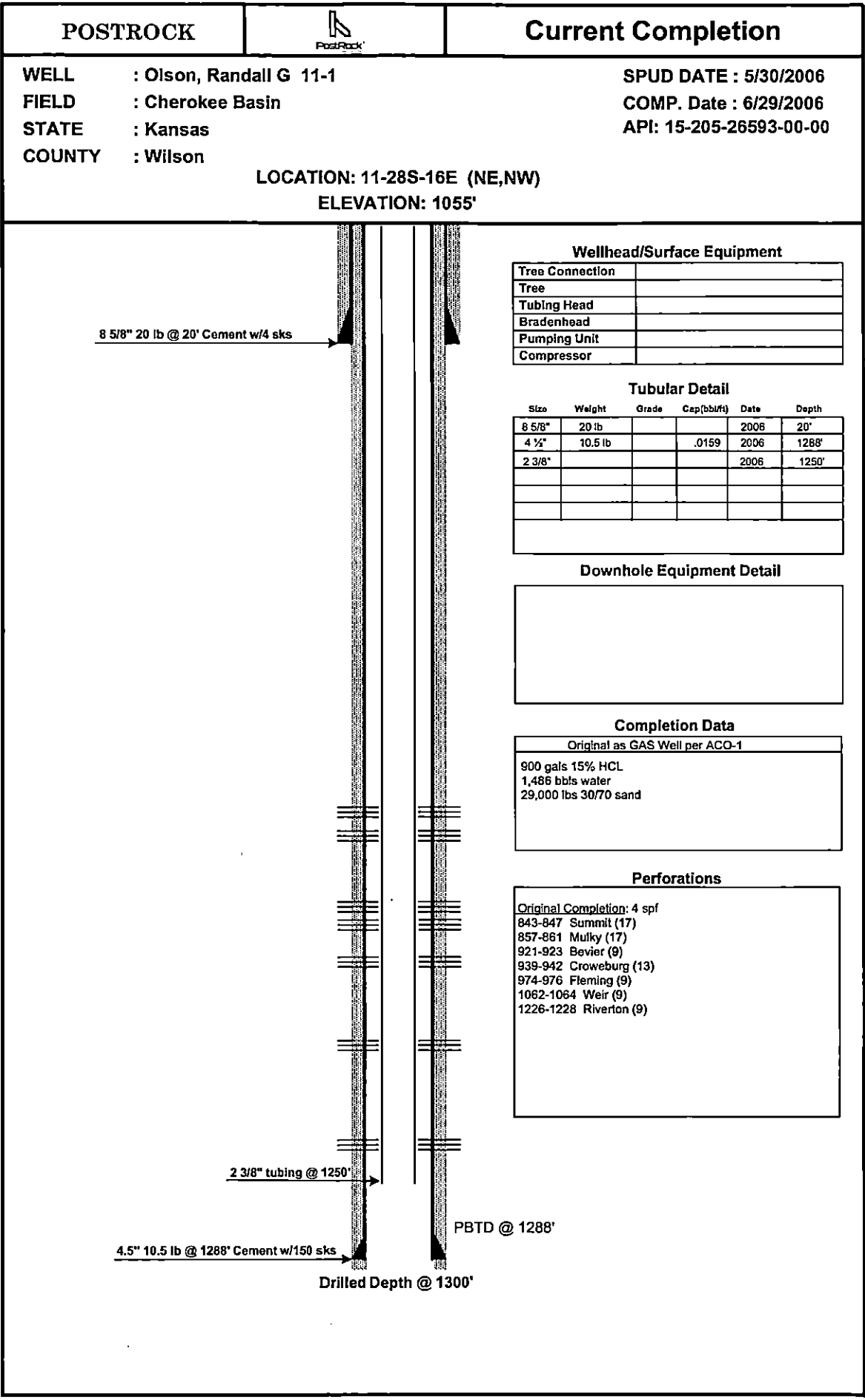

POSTROCK



Current Completion

WELL : Olson, Randall G 11-1 **SPUD DATE** : 5/30/2006
FIELD : Cherokee Basin **COMP. Date** : 6/29/2006
STATE : Kansas **API**: 15-205-26593-00-00
COUNTY : Wilson
LOCATION: 11-28S-16E (NE,NW)
ELEVATION: 1055'

Wellhead/Surface Equipment

Tree Connection	
Tree	
Tubing Head	
Bradenhead	
Pumping Unit	
Compressor	

Tubular Detail

Size	Weight	Grade	Cep(bbl/ft)	Date	Depth
8 5/8"	20 lb			2008	20'
4 1/2"	10.5 lb		.0159	2006	1288'
2 3/8"				2006	1250'

Downhole Equipment Detail

Completion Data

Original as GAS Well per ACO-1

900 gals 15% HCL
 1,486 bbls water
 29,000 lbs 30/70 sand

Perforations

Original Completion: 4 spf

- 843-847 Summit (17)
- 857-861 Mulky (17)
- 921-923 Bevier (9)
- 939-942 Croweburg (13)
- 974-976 Fleming (9)
- 1062-1064 Weir (9)
- 1226-1228 Riverton (9)

PREPARED BY: POSTROCK
 APPROVED BY: _____

DATE: Oct, 2012
 DATE: _____

POSTROCK



LEGEND

PostRock®

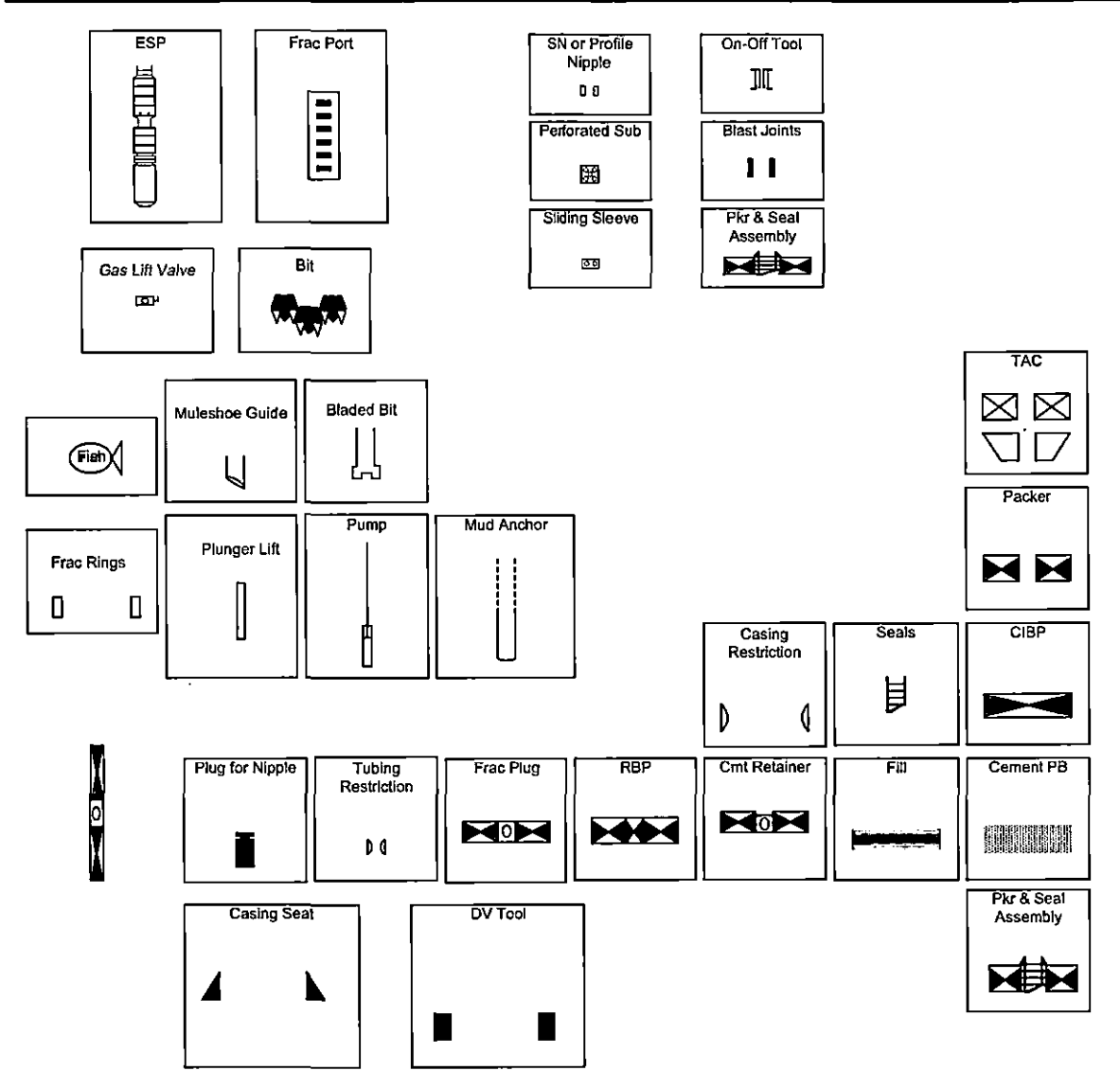

AFFIDAVIT

STATE OF KANSAS \
- SS.
County of Sedgwick /

Mark Fletchall, of lawful age, being first duly sworn, deposeth and saith: That he is Record Clerk of The Wichita Eagle, a daily newspaper published in the City of Wichita, County of Sedgwick, State of Kansas, and having a general paid circulation on a daily basis in said County, which said newspaper has been continuously and uninterruptedly published in said County for more than one year prior to the first publication of the notice hereinafter mentioned, and which said newspaper has been entered as second class mail matter at the United States Post Office in Wichita, Kansas, and which said newspaper is not a trade, religious or fraternal publication and that a notice of a true copy is hereto attached and published in the regular and entire Morning issue of said The Wichita Eagle for 1 issues, that the first publication of said notice was

made as aforesaid on the 27th of

October A.D. 2012, with

subsequent publications being made on the following dates:

And affiant further says that he has personal knowledge of the statements above set forth and that they are true.

Mark Fletchall

Subscribed and sworn to before me this

29th day of October, 2012

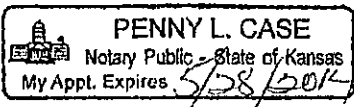

Penny L. Case
Notary Public Sedgwick County, Kansas

Printer's Fee : \$139.60

LEGAL PUBLICATION
Published in The Wichita Eagle
October 27, 2012 (3214838)
BEFORE THE STATE CORPORATION COMMISSION
OF THE STATE OF KANSAS
NOTICE OF FILING APPLICATION
RE: In the Matter of Postrock Midcontinent
Production, LLC Application for
Commingling of Production in the Olson,
Randa# G 11-1 located in Wilson County,
Kansas.
TO: All Oil & Gas Producers, Unleased
Mineral Interest Owners, Landowners, and
all persons whomsoever concerned.
You, and each of you, are hereby notified
that Postrock Midcontinent Production,
LLC has filed an application to commingle
the Summit, Mulky, Beaver, Craweburg,
Fleming, Weir, Riverton and Barnesville
producing formations of the Olson, Randa#
G 11-1, located in the SE, NW, NE, NW,
S11-T285-R16E, Approximately 617 ENL
& 1934 FWL, Wilson County, Kansas.
Any persons who object to or protest
this application shall be required to file their
objections or protest with the Conservation
Division of the State Corporation
Commission of the State of Kansas within
fifteen (15) days from the date of this
publication. These protests shall be filed
pursuant to Commission regulations and
must state specific reasons why granting
the application may cause waste, violate
correlative rights or pollute the natural
resources of the State of Kansas.
All persons interested or concerned
shall take notice of the foregoing and shall
govern themselves accordingly. All persons
and/or companies wishing to protest this
application are required to file a written
protest with the Conservation Division of
the Kansas Oil and Gas Commission.
Upon the receipt of any protest, the
Commission will convene a hearing and
protestants will be expected to enter an
appearance either through proper legal
counsel or as individuals appearing on
their own behalf.
Postrock Midcontinent Production, LLC
210 Park Avenue, Suite 2750
Oklahoma City, Oklahoma 73102
(405) 660-7704

Affidavit of Notice Served

Re: Application for: APPLICATION FOR COMMINGLING OF PRODUCTION OR FLUIDS ACO-4

Well Name: OLSON, RANDALL G 11-1 Legal Location: SENWNENW S11-T28S-R16E

The undersigned hereby certifies that he / she is a duly authorized agent for the applicant, and that on the day 30th of OCTOBER, 2012, a true and correct copy of the application referenced above was delivered or mailed to the following parties:

Note: A copy of this affidavit must be served as a part of the application.

Name

Address (Attach additional sheets if necessary)

LEW L MARSHALL

314 E 1ST, PO BOX 306, EUREKA, KS 67045

I further attest that notice of the filing of this application was published in the THE WILSON COUNTY CITIZEN, the official county publication of WILSON county. A copy of the affidavit of this publication is attached.

Signed this 30th day of OCTOBER, 2012

[Signature]
Applicant or Duly Authorized Agent

Subscribed and sworn to before me this 30th day of OCTOBER, 2012



Jennifer R. Beal
Notary Public

My Commission Expires: July 20, 2014



OLSON, RANDALL G 11-1

LEGAL LOCATION	SPOT	CURR_OPERA
S2-T28S-R16E	SE SE SE SW	Marshall, Lew L.

PROOF OF PUBLICATION

STATE OF KANSAS
Wilson County - SS

JOSEPH S. and RITA M. RELPH, of lawful age, being duly sworn upon oath that they are the Owners and Publishers of the WILSON COUNTY CITIZEN:

THAT said newspaper has been published at least weekly fifty (50) times a year and has been so published for at least five years prior to the first publication of the attached notice:

THAT said newspaper is a general circulation on a daily, or weekly, or monthly, or yearly basis in;

WILSON COUNTY, KANSAS and is NOT a trade, religious or fraternal publication and has been PRINTED and PUBLISHED in Wilson County, Kansas.

THE ATTACHED was published on the following dates in a regular issue of said newspaper:

1st publication was made on the 29th day of October, 2012

2nd publication was made on the _____ day of _____, 20_____

3rd publication was made on the _____ day of _____, 20_____

4th publication was made on the _____ day of _____, 20_____

5th publication was made on the _____ day of _____, 20_____

6th publication was made on the _____ day of _____, 20_____

TOTAL PUBLICATION FEE: \$ 37.93

(Signed) Joseph S. Relph

Subscribed and sworn to before me, this 30th day of October, 2012

Rita M. Relph (Notary Public)

My commission expires Aug. 30, 2014

(Published in the Wilson County Citizen on Monday, October 29, 2012.)

BEFORE THE STATE CORPORATION COMMISSION OF THE STATE OF KANSAS

NOTICE OF FILING APPLICATION

RE: In the Matter of Pustrock Midcontinent Production, LLC Application for Commingling of Production in the Olson, Randall G-11-1 located in Wilson County, Kansas

TO: All Oil & Gas Producers, Unleased Mineral Interest Owners, Landowners, and all persons whomsoever concerned.

You, and each of you, are hereby notified that Pustrock Midcontinent Production, LLC has filed an application to commingle the Summit, Mully, Bevier, Crowburg, Fleming, Weir, Riverton and Bartlesville producing formations at the Olson, Randall G-11-1, located in the SE NW NE NW S11-T28S-R16E, Approximately 617 FNL & 1934 FWL, Wilson County, Kansas.

Any persons who object to or protest this application shall be required to file their objections or protest with the Conservation Division of the State Corporation Commission of the State of Kansas within fifteen (15) days from the date of this publication. These protests shall be filed pursuant to Commission regulations and must state specific reasons why granting the application may cause waste, violate correlative rights or pollute the natural resources of the State of Kansas.

All persons interested or concerned shall take notice of the foregoing and shall govern themselves accordingly. All person and/or companies wishing to protest this application are required to file a written protest with the Conservation Division of the Kansas Oil and Gas Commission.

Upon the receipt of any protest, the Commission will convene a hearing and protestants will be expected to enter an appearance either through proper legal counsel or as individuals, appearing on their own behalf.

Pustrock Midcontinent Production, LLC
210 Park Avenue, Suite 2750
Oklahoma City, Oklahoma 73102
(405) 660-7704
73 1 cp

STATE NOTARY PUBLIC
KANSAS
STATE OF KANSAS

Rita M. Relph
NOTARY PUBLIC
State of Kansas
My Commission Expires

Conservation Division
Finney State Office Building
130 S. Market, Rm. 2078
Wichita, KS 67202-3802



Phone: 316-337-6200
Fax: 316-337-6211
<http://kcc.ks.gov/>

Mark Sievers, Chairman
Thomas E. Wright, Commissioner
Shari Feist Albrecht, Commissioner

Sam Brownback, Governor

November 14, 2012

Clark Edwards
PostRock Midcontinent Production LLC
Oklahoma Tower
210 Park Ave, Ste 2750
Oklahoma City, OK 73102

RE: Approved Commingling CO11205
Olson, Randall G. 11-1, Sec. 11-T28S-R16E, Wilson County
API No. 15-205-26593-00-00

Dear Mr. Edwards:

Your Application for Commingling (ACO-4) for the above described well, received by the KCC on November 8, 2012, has been reviewed and approved by the Kansas Corporation Commission (KCC) per K.A.R. 82-3-123. Notice was examined and found to be proper per K.A.R. 82-3-135a. No protest had been filed within the 15-day protest period.

Based upon the depth of the Riverton formation perforations, total oil production shall not exceed 100 BOPD and total gas production shall not exceed 50% of the absolute open flow (AOF).

File form ACO-1 upon re-completion of the well to commingle.

Commingling ID number CO11205 has been assigned to this approved application. Use this number for well completion reports (ACO-1) and other correspondence that may concern this approved commingling.

Sincerely,

Rick Hestermann
Production Department