



KANSAS CORPORATION COMMISSION 1093844  
OIL & GAS CONSERVATION DIVISION

Form ACO-4  
Form must be typed  
March 2009

APPLICATION FOR COMMINGLING OF **Commingling ID # CO121205**  
PRODUCTION (K.A.R. 82-3-123) OR FLUIDS (K.A.R. 82-3-123a)

OPERATOR: License # 33343  
Name: PostRock Midcontinent Production LLC  
Address 1: Oklahoma Tower  
Address 2: 210 Park Ave, Ste 2750  
City: OKLAHOMA CITY State: OK Zip: 73102 +  
Contact Person: CLARK EDWARDS  
Phone: (620) 432-4200

API No. 15 - 15-205-27013-00-00  
Spot Description: \_\_\_\_\_  
SW SE NE SW Sec. 2 Twp. 28 S. R. 15  East  West  
1580 Feet from  North /  South Line of Section  
2078 Feet from  East /  West Line of Section  
County: Wilson  
Lease Name: ORENDORFF HARRY L Well #: 2-1

1. Name and upper and lower limit of each production interval to be commingled:  
Formation: SUMMIT (Perfs): 813-817  
Formation: MULKY (Perfs): 825-829  
Formation: BEVIER (Perfs): 894-896  
Formation: CROWEBURG (Perfs): 911-914  
Formation: FLEMING (Perfs): 966-968

2. Estimated amount of fluid production to be commingled from each interval:  
Formation: SUMMIT BOPD: 0 MCFPD: 2.57 BWPD: 2.14  
Formation: MULKY BOPD: 0 MCFPD: 2.57 BWPD: 2.14  
Formation: BEVIER BOPD: 0 MCFPD: 2.57 BWPD: 2.14  
Formation: CROWEBURG BOPD: 0 MCFPD: 2.57 BWPD: 2.14  
Formation: FLEMING BOPD: 0 MCFPD: 2.57 BWPD: 2.14

3. Plat map showing the location of the subject well, all other wells on the subject lease, and all wells on offsetting leases within a 1/2 mile radius of the subject well, and for each well the names and addresses of the lessee of record or operator.
4. Signed certificate showing service of the application and affidavit of publication as required in K.A.R. 82-3-135a.

**For Commingling of PRODUCTION ONLY, include the following:**

5. Wireline log of subject well. Previously Filed with ACO-1:  Yes  No
6. Complete Form ACO-1 (Well Completion form) for the subject well.

**For Commingling of FLUIDS ONLY, include the following:**

7. Well construction diagram of subject well.
8. Any available water chemistry data demonstrating the compatibility of the fluids to be commingled.

**AFFIDAVIT:** I am the affiant and hereby certify that to the best of my current information, knowledge and personal belief, this request for commingling is true and proper and I have no information or knowledge, which is inconsistent with the information supplied in this application.

Submitted Electronically

**KCC Office Use Only**

Denied  Approved

15-Day Periods Ends: 12/12/2012

Approved By: Rick Hestermann Date: 12/12/2012

Protests may be filed by any party having a valid interest in the application. Protests must be in writing and comply with K.A.R. 82-3-135b and must be filed within 15 days of publication of the notice of application.

	A	B	C	D	E	F	G	H	I	J	K
1	Produced Fluids #		1	2	3	4	5		Click here to run SSP  Goal Seek SSP		Click
2	Parameters	Units	Input	Input	Input	Input	Input				Click
3	Select the brines	Select fluid by checking the box(es),	<input type="checkbox"/>	<input type="checkbox"/>	<input type="checkbox"/>	<input type="checkbox"/>	<input type="checkbox"/>	Mixed brine: Cell H28 is			Click
4	Sample ID							STP calc. pH.			Click
5	Date	Row 3	3/19/2012	3/4/2012	3/14/2012	1/20/2012	1/20/2012	Cells H35-38 are used in mixed brines calculations.			Click
6	Operator	PostRock	PostRock	PostRock	PostRock	PostRock	PostRock				Click
7	Well Name	Ward Feed	Ward Feed	Clinesmith	Clinesmith	Clinesmith	Clinesmith				Click
8	Location	#34-1	#4-1	#5-4	#1	#2					Click
9	Field	CBM	CBM	Bartles	Bartles	Bartles					
10	Na <sup>+</sup>	(mg/l)*	19,433.00	27,381.00	26,534.00	25,689.00	24,220.00	24,654.20	Initial(BH)	Final(WH)	St/SR (Final-Initial)
11	K <sup>+</sup> (if not known =0)	(mg/l)						0.00	Saturation Index values		
12	Mg <sup>2+</sup>	(mg/l)	1,096.00	872.00	1,200.00	953.00	858.00	995.91	Calcite		
13	Ca <sup>2+</sup>	(mg/l)	1,836.00	2,452.00	2,044.00	1,920.00	1,948.00	2,040.23	-0.73	-0.60	0.13
14	Sr <sup>2+</sup>	(mg/l)						0.00	Barite		
15	Ba <sup>2+</sup>	(mg/l)						0.00			
16	Fe <sup>2+</sup>	(mg/l)	40.00	21.00	18.00	82.00	90.00	50.21	Halite		
17	Zn <sup>2+</sup>	(mg/l)						0.00	-1.77	-1.80	-0.03
18	Pb <sup>2+</sup>	(mg/l)						0.00	Gypsum		
19	Cl <sup>-</sup>	(mg/l)	36,299.00	48,965.00	47,874.00	45,632.00	43,147.00	44,388.44	-3.19	-3.18	0.00
20	SO <sub>4</sub> <sup>2-</sup>	(mg/l)	1.00	1.00	8.00	1.00	1.00	2.40	Hemihydrate		
21	F <sup>-</sup>	(mg/l)						0.00	-3.96	-3.90	0.06
22	Br <sup>-</sup>	(mg/l)						0.00	Anhydrite		
23	SiO <sub>2</sub>	(mg/l) SiO <sub>2</sub>						0.00	-3.47	-3.36	0.12
24	HCO <sub>3</sub> Alkalinity**	(mg/l as HCO <sub>3</sub> )	190.00	234.00	259.00	268.00	254.00	241.03	Celestite		
25	CO <sub>3</sub> Alkalinity	(mg/l as CO <sub>3</sub> )									
26	Carboxylic acids**	(mg/l)						0.00	Iron Sulfide		
27	Ammonia	(mg/L) NH <sub>3</sub>						0.00	-0.16	-0.22	-0.06
28	Borate	(mg/L) H <sub>3</sub> BO <sub>3</sub>						0.00	Zinc Sulfide		
29	TDS (Measured)	(mg/l)						72781			
30	Calc. Density (STP)	(g/ml)	1.038	1.051	1.050	1.048	1.045	1.047	Calcium fluoride		
31	CO <sub>2</sub> Gas Analysis	(%)	19.97	18.76	22.41	35.53	33.79	26.16			
32	H <sub>2</sub> S Gas Analysis***	(%)	0.0289	0.0292	0.0296	0.0306	0.0151	0.0269	Iron Carbonate		
33	Total H <sub>2</sub> Saq	(mgH <sub>2</sub> S/l)	1.00	1.00	1.00	1.00	0.50	0.90	-0.74	-0.51	0.23
34	pH, measured (STP)	pH	5.67	5.76	5.72	5.54	5.55	5.63	Inhibitor needed (mg/L)		
35	Choose one option to calculate SI7	1-pH+Alk, 2-CO <sub>2</sub> %+pH	0	0	0	0	0		Calcite	NTMP	
36	Gas/day(thousand cf/day)	(Mcf/D)						0	0.00	0.00	
37	Oil/Day	(B/D)	0	0	1	1	1	4	Barite	BHPMP	
38	Water/Day	(B/D)	100	100	100	100	100	500	0.00	0.00	
39	For mixed brines, enter values for temperatures and pressures In Cells (H40-H43)								(Enter H40-H43)		pH
40	Initial T	(F)	66.0	71.0	70.0	41.0	49.0	60.0	5.69	5.60	
41	Final T	(F)	66.0	71.0	70.0	41.0	49.0	89.0	Viscosity (CentiPoise)		
42	Initial P	(psia)	25.0	25.0	25.0	25.0	25.0	25.0	1.196	0.826	
43	Final P	(psia)	25.0	25.0	25.0	25.0	25.0	120.0	Heat Capacity (cal/ml/C)		
44	Use TP on Calcite sheet?	1-Yes;0-No							0.955	0.959	
45	API Oil Grav.	API grav.						30.00	Inhibitor needed (mg/L)		
46	Gas Sp.Grav.	Sp.Grav.						0.60	Gypsum	HDTMP	
47	MeOH/Day	(B/D)	0					0	0.00	0.00	
48	MEG/Day	(B/D)	0					0	Anhydrite	HDTMP	
49	Conc. Multiplier								0.00	0.00	
50	H <sup>+</sup> (Strong acid) †	(N)									
51	OH <sup>-</sup> (Strong base) †	(N)									
52	Quality Control Checks at STP:										
53	H <sub>2</sub> S Gas	(%)									
54	Total H <sub>2</sub> Saq (STP)	(mgH <sub>2</sub> S/l)									
55	pH Calculated	(pH)									
56	PCO <sub>2</sub> Calculated	(%)									
57	Alkalinity Calculated	(mg/l) as HCO <sub>3</sub>									
58	ECations=	(equiv./l)									
59	EAnions=	(equiv./l)									
60	Calc TDS=	(mg/l)									
61	Inhibitor Selection	Input	Unit	#	Inhibitor	Unit Converter (From metric to English)					
62	Protection Time	120	min	1	NTMP	From Unit	Value	To Unit	Value		
63	Have ScaleSoftPitzer			2	BHPMP	°C	80	°F	176		
64	pick inhibitor for you?	1	1-Yes;0-No	3	PAA	m <sup>3</sup>	100	ft <sup>3</sup>	3,531		
65	If No, inhibitor # is:	4	#	4	DTPMP	m <sup>3</sup>	100	bbl(42 US gal)	629		
66	If you select Mixed,			5	PPCA	MPa	1,000	psia	145,074		
67	1 <sup>st</sup> inhibitor # is:	1	#	6	SPA	Bar	496	psia	7,194		
68	% of 1 <sup>st</sup> inhibitor is:	50	%	7	HEDP	Torr	10,000	psia	193		
69	2 <sup>nd</sup> inhibitor # is:	2	#	8	HDTMP	Gal	10,000	bbl(42 US gal)	238		
70	Display act. coeffs?	0	1-Yes;0-No	9	Average	Liters	10,000	bbl(42 US gal)	63		
71				10	Mixed						

KANSAS CORPORATION COMMISSION  
OIL & GAS CONSERVATION DIVISION

ORIGINAL

Form ACO-1  
September 1999  
Form Must Be Typed

WELL COMPLETION FORM  
WELL HISTORY - DESCRIPTION OF WELL & LEASE

Operator: License # 33344  
Name: Quest Cherokee, LLC  
Address: 211 W. 14th Street  
City/State/Zip: Chanute, KS 66720  
Purchaser: Bluestem Pipeline, LLC  
Operator Contact Person: Jennifer R. Ammann  
Phone: (620) 431-9500  
Contractor: Name: TXD Services LP  
License: 33837  
Wellsite Geologist: Ken Recoy

Designate Type of Completion:  
 New Well  Re-Entry  Workover  
 Oil  SWD  SLOW  Temp. Abd.  
 Gas  ENHR  SIGW  
 Dry  Other (Core, WSW, Expl., Cathodic, etc)

If Workover/Re-entry: Old Well Info as follows:

Operator: \_\_\_\_\_  
Well Name: \_\_\_\_\_  
Original Comp. Date: \_\_\_\_\_ Original Total Depth: \_\_\_\_\_  
 Deepening  Re-perf.  Conv. to Enhr./SWD  
 Plug Back \_\_\_\_\_ Plug Back Total Depth \_\_\_\_\_  
 Commingled \_\_\_\_\_ Docket No. \_\_\_\_\_  
 Dual Completion \_\_\_\_\_ Docket No. \_\_\_\_\_  
 Other (SWD or Enhr.?) \_\_\_\_\_ Docket No. \_\_\_\_\_

11/29/06	12/04/06	12/05/06
Spud Date or Recompletion Date	Date Reached TD	Completion Date or Recompletion Date

API No. 15 - 205-27013-00-00  
County: Wilson  
\_\_\_\_\_ - nb - sw Sec. 2 Twp. 28 S. R. 15  East  West  
1980 feet from (S) N (circle one) Line of Section  
1980 feet from E / (W) (circle one) Line of Section

Footages Calculated from Nearest Outside Section Corner:  
(circle one) NE SE NW (SW)  
Lease Name: Orendorff, Harry L. Well #: 2-1  
Field Name: Cherokee Basin CBM  
Producing Formation: Multiple  
Elevation: Ground: 890 Kelly Bushing: n/a  
Total Depth: 1262 Plug Back Total Depth: 1242.44  
Amount of Surface Pipe Set and Cemented at 32' 6" Feet  
Multiple Stage Cementing Collar Used?  Yes  No  
If yes, show depth set \_\_\_\_\_ Feet  
If Alternate II completion, cement circulated from 1242.44  
feet depth to surface w/ 161 \_\_\_\_\_ sx cmf.

Drilling Fluid Management Plan ALT#2 RGR 6/15/07  
(Data must be collected from the Reserve Pit)  
Chloride content \_\_\_\_\_ ppm Fluid volume \_\_\_\_\_ bbls  
Dewatering method used \_\_\_\_\_  
Location of fluid disposal if hauled offsite: \_\_\_\_\_  
Operator Name: \_\_\_\_\_  
Lease Name: \_\_\_\_\_  
Quarter \_\_\_\_\_ Sec. \_\_\_\_\_ Twp. \_\_\_\_\_ S. R. \_\_\_\_\_  East  West  
County: \_\_\_\_\_ Docket No. \_\_\_\_\_

RECEIVED  
MAR 26 2007  
KCC WICHITA

**INSTRUCTIONS:** An original and two copies of this form shall be filed with the Kansas Corporation Commission, 130 S. Market - Room 2078, Wichita, Kansas 67202, within 120 days of the spud date, recompletion, workover or conversion of a well. Rule 82-9-130, 82-9-106 and 82-9-107 apply. Information of side two of this form will be held confidential for a period of 12 months if requested in writing and submitted with the form (see rule 82-9-107 for confidentiality in excess of 12 months). One copy of all wireline logs and geologist well report shall be attached with this form. ALL CEMENTING TICKETS MUST BE ATTACHED. Submit CP-4 form with all plugged wells. Submit CP-111 form with all temporarily abandoned wells.

All requirements of the statutes, rules and regulations promulgated to regulate the oil and gas industry have been fully complied with and the statements herein are complete and correct to the best of my knowledge.

Signature: Jennifer R. Ammann  
Title: New Well Development Coordinator Date: 3/23/07

Subscribed and sworn to before me this 23rd day of March,  
2007.

Notary Public: Debra Klaueman  
Date Commission Expires: 8-4-2010

TERRA-KLAUMAN  
Notary Public - State of Kansas  
My Appt. Expires 8-4-2010

KCC Office Use ONLY  
 Letter of Confidentiality Received  
If Denied, Yes  Date: \_\_\_\_\_  
 Wireline Log Received  
 Geologist Report Received  
VIC Distribution

## Saturation Index Calculations

*Champion Technologies, Inc.*

(Based on the Tomson-Oddo Model)

**Brine 1:** Ward Feed Yard 34-1

**Brine 2:** Ward Feed Yard 4-1

**Brine 3:** Clinesmith 5-4

**Brine 4:** Clinesmith 1

**Brine 5:** Clinesmith 2

Component (mg/L)	Ratio					
	20% Brine 1	20% Brine 2	20% Brine 3	20% Brine 4	20 Brine 5	Mixed Brine
Calcium	1836	2452	2044	1920	1948	1952
Magnesium	1096	872	1200	953	858	865
Barium	0	0	0	0	0	0
Strontium	0	0	0	0	0	0
Bicarbonate	190	234	259	268	254	253
Sulfate	1	1	8	1	1	1
Chloride	36299	48965	47874	45632	43147	43206
CO <sub>2</sub> in Brine	246	220	264	422	405	401
Ionic Strength	1.12	1.48	1.46	1.38	1.31	1.31
Temperature (°F)	89	89	89	89	89	89
Pressure (psia)	50	50	120	120	120	119

### Saturation Index

Calcite	-1.71	-1.41	-1.48	-1.68	-1.69	-1.69
Gypsum	-3.71	-3.64	-2.82	-3.73	-3.72	-3.69
Hemihydrate	-3.70	-3.65	-2.83	-3.74	-3.71	-3.69
Anhydrite	-3.89	-3.79	-2.97	-3.89	-3.88	-3.85
Barite	N/A	N/A	N/A	N/A	N/A	N/A
Celestite	N/A	N/A	N/A	N/A	N/A	N/A

### PTB

Calcite	N/A	N/A	N/A	N/A	N/A	N/A
Gypsum	N/A	N/A	N/A	N/A	N/A	N/A
Hemihydrate	N/A	N/A	N/A	N/A	N/A	N/A
Anhydrite	N/A	N/A	N/A	N/A	N/A	N/A
Barite	N/A	N/A	N/A	N/A	N/A	N/A
Celestite	N/A	N/A	N/A	N/A	N/A	N/A

**TXD SERVICES LP DRILLERS LOG**

**TXD SERVICES LP**

RIG #	101	S. 2	T. 2B	R. 15		
API #	205-27013	County:	Wilson	470'	0'	
Elev:	890'	Location	Kansas	563'	0'	
Operator:	Quest Cherokee, LLC			752'	slight blow	
Address:	9520 N. May Ave, Suite 300			783'	slight blow	
	Oklahoma City, OK, 73120			815'	20 - 1/2"	28
Well #		Lease Name	Arundel, Harry W	845'	24 - 1/2"	30.7
Footage Location	1980 ft from the		S Line	908'	26 - 1/2"	31.9
	1980 ft from the		W Line	940'	5 - 3/4"	33.2
Drilling Contractor:	TXD SERVICES LP			970'	6 - 3/4"	34.7
Spud Date:	11/29/2006	Geologist:	Ken Reocy	1001'	11 - 3/4"	47.2
Date Comp:	12/4/2006	Total Depth:	1263'	1032'	11 - 3/4"	47.2
Exact spot Location:	NE SW			1063'	11 - 3/4"	47.2
				1157'	2 - 1 1/4"	62
				1189'	2 - 1 1/4"	62
				1263'	2 - 1 1/4"	62
Surface	Production					
Size Hole	12-1/4"	6-3/4"				
Size Casing	8-5/8"	4-1/2"				
Weight	24#					
Setting Depth	32.5'					
Type Cement	portland					
Sacks						

**RECEIVED  
MAR 26 2007**

**KCC WICHITA**

Formation	Top	Btm.	Formation	Top	Btm.	Formation	Top	Btm.
top soil	0	11	sand/shale	564	595	sand	817	820
shale	11	130	lime	596	616	shale	820	822
lime	130	154	shale	616	626	coal	822	823
shale	154	200	lime	626	635	shale	823	905
lime	200	243	b.shale	635	639	coal	905	908
shale	243	296	lime	639	657	shale	908	915
lime	296	300	shale	657	677	coal	915	916
shale	300	304	coal	677	678	shale	916	927
lime	304	312	shale	678	683	coal	927	928
shale	312	323	coal	683	684	shale	928	952
lime	323	338	shale	684	736	sand	952	960
shale	338	340	lime	736	739	shale	960	962
lime	340	380	coal	739	740	coal	962	963
sand	380	385	coal	740	756	shale	963	968
lime	385	425	shale	756	758	coal	968	969
sand	425	437	lime	758	765	shale	969	982
sand/shale	437	448	shale	765	781	coal	982	983
lime	448	455	coal	781	782	shale	983	993
sand/shale	455	465	shale	782	797	coal	993	994
lime	465	481	lime	797	805	shale	994	1024
b.shale	481	489	shale	805	811	coal	1024	1025
lime	489	563	coal	811	812	shale	1025	1038
coal	563	564	shale	812	817	coal	1038	1040

564-595' odor

Operator Name: Quest Cherokee, LLC Lease Name: Orendorff, Harry L. Well #: 2-1  
 Sec. 2 Twp. 28 S. R. 15  East  West County: Wilson

**INSTRUCTIONS:** Show important tops and base of formations penetrated. Detail all cores. Report all final copies of drill stems tests giving interval tested, time tool open and closed, flowing and shut-in pressures, whether shut-in pressure reached static level, hydrostatic pressures, bottom hole temperature, fluid recovery, and flow rates if gas to surface test, along with final chart(s). Attach extra sheet if more space is needed. Attach copy of all Electric Wireline Logs surveyed. Attach final geological well site report.

Drill Stem Tests Taken  Yes  No  
 (Attach Additional Sheets)  
 Samples Sent to Geological Survey  Yes  No  
 Cores Taken  Yes  No  
 Electric Log Run  Yes  No  
 (Submit Copy)

Log Formation (Top), Depth and Datum  Sample  
 Name See attached Top Datum

List All E. Logs Run:

Compensated Density/Neutron Log  
 Dual Induction Log  
 Gamma Ray Neutron Log

CASING RECORD <input type="checkbox"/> New <input type="checkbox"/> Used							
Report all strings set-conductor, surface, intermediate, production, etc.							
Purpose of String	Size Hole Drilled	Size Casing Set (In O.D.)	Weight Lbs. / Ft.	Setting Depth	Type of Cement	# Sacks Used	Type and Percent Additives
Surface	12-1/4	8-5/8"	20	32' 6"	"A"	5	
Production	6-3/4	4-1/2	10.5	1242.44	"A"	161	

ADDITIONAL CEMENTING / SQUEEZE RECORD				
Purpose:	Depth Top Bottom	Type of Cement	#Sacks Used	Type and Percent Additives
<input type="checkbox"/> Perforate				
<input type="checkbox"/> Protect Casing				
<input type="checkbox"/> Plug Back TD				
<input type="checkbox"/> Plug Off Zone				

Shots Per Foot	PERFORATION RECORD - Bridge Plugs Set/Type Specify Footage of Each Interval Perforated	Acid, Fracture, Shot, Cement Squeeze Record (Amount and Kind of Material Used)	Depth
4	1190-1192	100gal 15% HCL w/ 30 bbls 2% acid water, 200bbls water w/ 2% KCL, Blocks, 3100# 30/70 sand	1190-1192
4	1059-1061/966-968/911-914/894-896	400gal 15% HCL w/ 60 bbls 2% acid water, 700bbls water w/ 2% KCL, Blocks, 13100# 30/70 sand	1059-1061/906-908 911-914/894-896
4	825-829/813-817	300gal 15% HCL w/ 60 bbls 2% acid water, 615bbls water w/ 2% KCL, Blocks, 13100# 30/70 sand	825-829/813-817

TUBING RECORD		Size	Set At	Packer At	Liner Run
		2-3/8"	1213	n/a	<input type="checkbox"/> Yes <input checked="" type="checkbox"/> No
Date of First, Resumend Production, SWD or Enhr.			Producing Method		
waiting on pipeline			<input type="checkbox"/> Flowing <input type="checkbox"/> Pumping <input type="checkbox"/> Gas Lift <input type="checkbox"/> Other (Explain)		
Estimated Production Per 24 Hours	Oil Bbls.	Gas Mcf	Water Bbls.	Gas-Oil Ratio	Gravity

Disposition of Gas  Vented  Sold  Used on Lease (If vented, Submit ACO-18.)

METHOD OF COMPLETION  Open Hole  Perf.  Dually Comp.  Commingled  Other (Specify) \_\_\_\_\_

Production Interval \_\_\_\_\_

# QUEST

Resource Corporation



211 W. 14TH STREET,  
CHANUTE, KS 66720  
620-431-9500

TICKET NUMBER 1939

FIELD TICKET REF #

FOREMAN Jac/craig

419040

## TREATMENT REPORT & FIELD TICKET CEMENT

DATE	WELL NAME & NUMBER	SECTION	TOWNSHIP	RANGE	COUNTY
12-5-06	Orendorff Harry 2-1	2	28	15	WJL

FOREMAN / OPERATOR	TIME IN	TIME OUT	LESS LUNCH	TRUCK #	TRAILER #	TRUCK HOURS	EMPLOYEE SIGNATURE
Joe P	6:45	5:30		903427		1.15	<i>[Signature]</i>
Craig C	6:00	5:40					<i>[Signature]</i>
Wes T	7:00	5:45		903197		10.75	<i>[Signature]</i>
Russell A	7:00	5:45		903103		10.75	<i>[Signature]</i>
Brandon M	11:45	6:30		903400	932705	6.50	<i>[Signature]</i>
TRUY W	11:45	6:00		931420		6.50	<i>[Signature]</i>

JOB TYPE Loss string HOLE SIZE 6 3/4 HOLE DEPTH 1262 CASING SIZE & WEIGHT 4 1/2 10.5  
 CASING DEPTH 1242.44 DRILL PIPE \_\_\_\_\_ TUBING \_\_\_\_\_ OTHER \_\_\_\_\_  
 SLURRY WEIGHT 14.5 SLURRY VOL \_\_\_\_\_ WATER gal/sk \_\_\_\_\_ CEMENT LEFT in CASING 0  
 DISPLACEMENT 19.81 DISPLACEMENT PSI \_\_\_\_\_ MIX PSI \_\_\_\_\_ RATE 4bpm

REMARKS:

Installed cement head, pumped 2 sacks of gel, 13 barrel dye; and 161 sacks of cement to get dye to surface. Flushed pump, pumped wiper plug to bottom; set float shoe

RECEIVED

MAR 26 2007

KCC WICHITA

1242.44	6	4 1/2 Casing
	6	Controlizers
	1	4 1/2 float shoe

ACCOUNT CODE	QUANTITY or UNITS	DESCRIPTION OF SERVICES OR PRODUCT	TOTAL AMOUNT
903427	1.15 hr	Foreman Pickup	
903197	10.75 hr	Cement Pump Truck	
903103	10.75 hr	Bulk Truck	
1104	153 SK	Portland Cement	
1124	2	50/50 POZ Blend Cement Baffle 2 1/2 + 3	
1126	1	OWC Blend Cement Plug 4 1/2	
1110	15 SK	Gilsonite	
1107	1 SK	Flo-Seal	
1118	2 SK	Premium Gel	
1215A	1 gal	KCL	
1111B	3 SK	Sodium Silicate Catchloride	
1123	7000 gal	City Water	
903414	6.50 hr	Transport Truck	
932705	6.50 hr	Transport Trailer	
931	6.50 hr	80 Vac	





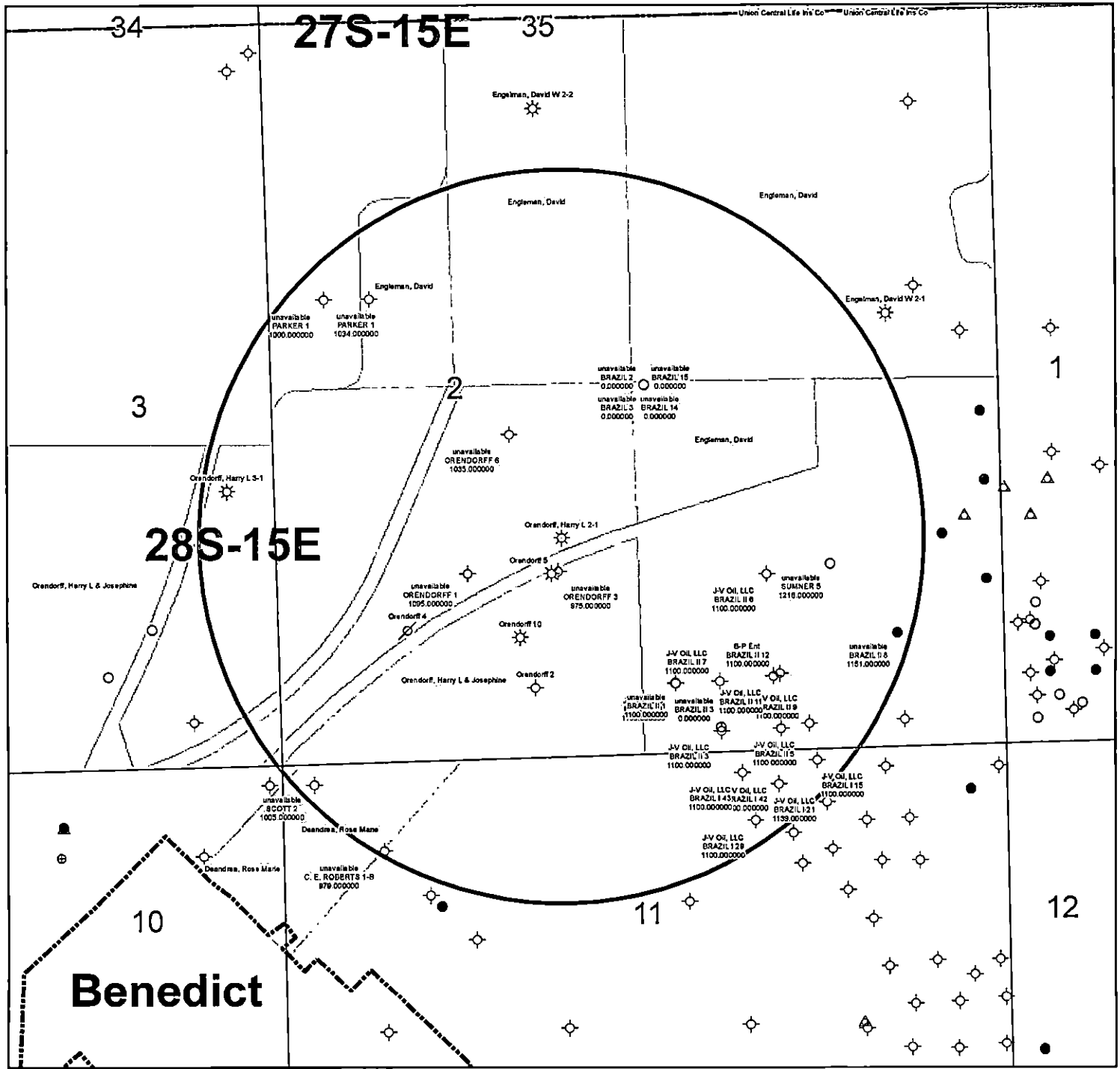

**KGS STATUS**

◇	DA/PA
⊕	EOR
☼	GAS
△	INJ/SWD
●	OIL
✱	OIL/GAS
○	OTHER

Orendorff, Harry L 2-1  
 2-28S-15E  
 1" = 1,000'

POSTROCK



### Current Completion

WELL : Orendorff, Harry L 2-1  
 FIELD : Cherokee Basin  
 STATE : Kansas  
 COUNTY : Wilson

SPUD DATE : 11/29/2006  
 COMP. Date : 12/05/2006  
 API: 15-205-27013-00-00

LOCATION: 2-28S-15E (NE,SW)  
 ELEVATION: 890'

8 5/8" 20 lb @ 32' Cement w/5 sks

#### Wellhead/Surface Equipment

Tree Connection	
Tree	
Tubing Head	
Bradenhead	
Pumping Unit	
Compressor	

#### Tubular Detail

Size	Weight	Grade	Cap(bbl/ft)	Date	Depth
8 5/8"	20 lb			2006	32'
4 1/2"	10.5 lb		.0159	2006	1242'
2 3/8"				2006	1213'

#### Downhole Equipment Detail

#### Completion Data

Original as GAS Well per ACO-1
800 gals 15% HCL
1,561 bbls water
29,300 lbs 30/70 sand

#### Perforations

Original Completion: 4 spf
813-817 Summit (17)
825-829 Mulky (17)
894-896 Bevier (9)
911-914 Croweburg (13)
966-968 Fleming (9)
1059-1061 Weir (9)
1190-1192 Riverton (9)

2 3/8" tubing @ 1213'

PBTD @ 1242'

4.5" 10.5 lb @ 1242' Cement w/161 sks

Drilled Depth @ 1262'

PREPARED BY: POSTROCK  
 APPROVED BY: \_\_\_\_\_

DATE: Sept, 2012  
 DATE: \_\_\_\_\_

# POSTROCK



## LEGEND

PostRock®

<b>ESP</b> 	<b>Frac Port</b> 	<b>SN or Profile Nipple</b> 	<b>On-Off Tool</b> 
<b>Gas Lift Valve</b> 	<b>Bit</b> 	<b>Perforated Sub</b> 	<b>Blast Joints</b> 
		<b>Sliding Sleeve</b> 	<b>Pkr &amp; Seal Assembly</b> 
<b>Fish</b> 	<b>Muleshoe Guide</b> 	<b>Bladed Bit</b> 	<b>TAC</b> 
<b>Frac Rings</b> 	<b>Plunger Lift</b> 	<b>Pump</b> 	<b>Packer</b> 
		<b>Mud Anchor</b> 	<b>Casing Restriction</b> 
			<b>Seals</b> 
			<b>CIBP</b> 
	<b>Plug for Nipple</b> 	<b>Tubing Restriction</b> 	<b>Frac Plug</b> 
			<b>RBP</b> 
			<b>Cmt Retainer</b> 
			<b>Fill</b> 
			<b>Cement PB</b> 
	<b>Casing Seat</b> 	<b>DV Tool</b> 	<b>Pkr &amp; Seal Assembly</b> 



**AFFIDAVIT**

STATE OF KANSAS \  
- SS.  
County of Sedgwick /

Mark Fletchall, of lawful age, being first duly sworn, depose and saith: That he is Record Clerk of The Wichita Eagle, a daily newspaper published in the City of Wichita, County of Sedgwick, State of Kansas, and having a general paid circulation on a daily basis in said County, which said newspaper has been continuously and *uninterruptedly published in said County for more than one year prior to the first publication of the notice hereinafter mentioned, and which said newspaper has been entered as second class mail matter at the United States Post Office in Wichita, Kansas, and which said newspaper is not a trade, religious or fraternal publication and that a notice of a true copy is hereto attached was published in the regular and entire Morning issue of said The Wichita Eagle for 1 issues, that the first publication of said notice was*

made as aforesaid on the 11th of

October A.D. 2012, with

subsequent publications being made on the following dates:

And affiant further says that he has personal knowledge of the statements above set forth and that they are true.

*Mark Fletchall*

Subscribed and sworn to before me this

11th day of October, 2012

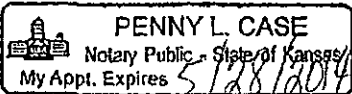

*Penny L Case*  
Notary Public Sedgwick County, Kansas

Printer's Fee : \$132.40

**LEGAL PUBLICATION**

**PUBLISHED IN THE WICHITA EAGLE  
OCTOBER 11, 2012 (3211698)  
BEFORE THE STATE CORPORATION  
COMMISSION  
OF THE STATE OF KANSAS  
NOTICE OF FILING APPLICATION**  
RE: In the Matter of Postrock Midcontinent Production, LLC Application for Commencement of Production in the Orendorf, Harry L 2-1 located in Wilson County, Kansas.  
TO: All Oil & Gas Producers, Unleased Mineral Interest Owners, Landowners, and all persons whomsoever concerned.  
You, and each of you, are hereby notified that Postrock Midcontinent Production, LLC has filed an application to commence the Summit, Mulky, Beverly, Croweburg, Fleming, Waly, Riverton and Catterman production formations at the Orendorf, Harry L 2-1, located in the SW SE NE SW S2-T285-R15E, Approximately 1580 FSL & 2078 FWL, Wilson County, Kansas.  
Any persons who object to or protest this application shall be required to file their objections or protest with the Conservation Division of the State Corporation Commission of the State of Kansas within fifteen (15) days from the date of this publication. These protests shall be filed pursuant to Commission regulations and must state specific reasons why granting the application may cause waste, violate correlative rights or deplete the natural resources of the State of Kansas.  
All persons interested or concerned shall take notice of the foregoing and shall govern themselves accordingly. All persons and/or companies wishing to protest this application are required to file a written protest with the Conservation Division of the Kansas Oil and Gas Commission.  
Upon the receipt of any protest, the Commission will convene a hearing and protestants will be expected to enter an appearance either through proper legal counsel or as individuals, appearing on their own behalf.  
Postrock Midcontinent Production, LLC  
210 Park Avenue, Suite 2750  
Oklahoma City, Oklahoma 73102  
(405) 650-7700

PROOF OF PUBLICATION

STATE OF KANSAS  
Wilson County - SS

JOSEPH S. and RITA M. RELPH, of lawful age, being duly sworn upon oath that they are the Owners and Publishers of the WILSON COUNTY CITIZEN:

THAT said newspaper has been published at least weekly fifty (50) times a year and has been so published for at least five years prior to the first publication of the attached notice:

THAT said newspaper is a general circulation on a daily, or weekly, or monthly, or yearly basis in;

WILSON COUNTY, KANSAS and is NOT a trade, religious or fraternal publication and has been PRINTED and PUBLISHED in Wilson County, Kansas.

THE ATTACHED was published on the following dates in a regular issue of said newspaper:

1st publication was made on the 15th day of October, 2012

2nd publication was made on the \_\_\_\_\_ day of \_\_\_\_\_, 20\_\_\_\_

3rd publication was made on the \_\_\_\_\_ day of \_\_\_\_\_, 20\_\_\_\_

4th publication was made on the \_\_\_\_\_ day of \_\_\_\_\_, 20\_\_\_\_

5th publication was made on the \_\_\_\_\_ day of \_\_\_\_\_, 20\_\_\_\_

6th publication was made on the \_\_\_\_\_ day of \_\_\_\_\_, 20\_\_\_\_

TOTAL PUBLICATION FEE: \$ 40<sup>00</sup>

(Signed) Mina S. DeBerry

Subscribed and sworn to before me, this 16th day of October, 2012

Rita M. Relph (Notary Public)

My commission expires Aug. 30, 2014

(Published in the Wilson County Citizen on Monday, October 15, 2012.)

BEFORE THE STATE CORPORATION COMMISSION OF THE STATE OF KANSAS

NOTICE OF FILING APPLICATION

RE: In the Matter of Postrock Midcontinent Production, LLC Application for Commencing of Production in the Orendorf, Harry L 2-1 located in Wilson County, Kansas

TO: All Oil & Gas Producers, Unleased Mineral Interest Owners, Landowners, and all persons whomsoever concerned.

You, and each of you, are hereby notified that Postrock Midcontinent Production, LLC has filed an application to commence the Summit, Mulky, Beyer, Crowburg, Fleming, Weir, Riverton and Cattleman producing formations at the Orendorf, Harry L 2-1, located in the SW SE NE SW, S2-T289-R15E, Approximately 1580 FSL & 2079 FWL, Wilson County, Kansas.

Any persons who object to or protest this application shall be required to file their objections or protest with the Conservation Division of the State Corporation Commission of the State of Kansas within fifteen (15) days from the date of this publication. These protests shall be filed pursuant to Commission regulations and must state specific reasons why granting the application may cause waste, violate correlative rights or pollute the natural resources of the State of Kansas.

All persons interested or concerned shall take notice of the foregoing and shall govern themselves accordingly. All persons and/or companies wishing to protest this application are required to file a written protest with the Conservation Division of the Kansas Oil and Gas Commission.

Upon the receipt of any protest, the Commission will convene a hearing and protestants will be expected to enter an appearance either through proper legal counsel or as individuals, appearing on their own behalf.

Postrock Midcontinent Production, LLC  
210 Park Avenue, Suite 2750  
Oklahoma City, Oklahoma 73102  
(405) 660-7704  
691 cpy

STATE NOTARY PUBLIC  
Rita M. Relph  
NOTARY PUBLIC  
State of Kansas  
My Commission Expires

PAID



**ORENDORFF, HARRY L 2-1**

<b>LEGAL LOCATION</b>	<b>SPOT</b>	<b>CURR_OPERA</b>
S2-T28S-R15E	SE SW SE	B-P Ent.
S11-T28S-R15E	SE NW NE	J-V Oil, LLC
S11-T28S-R15E	NE NW NE	J-V Oil, LLC
S11-T28S-R15E	NE NW NE	J-V Oil, LLC
S11-T28S-R15E	NE NW NE	J-V Oil, LLC
S11-T28S-R15E	NW NW NE	J-V Oil, LLC
S2-T28S-R15E	SW SW SE	J-V Oil, LLC
S2-T28S-R15E	SE SW SE	J-V Oil, LLC
S2-T28S-R15E	SW SW SE	J-V Oil, LLC
S2-T28S-R15E	SE SW SE	J-V Oil, LLC
S2-T28S-R15E	NE SW SE	J-V Oil, LLC
S2-T28S-R15E	SW SW SE	J-V Oil, LLC
S2-T28S-R15E	SW SE	J-V Oil, LLC



**ORENDORFF, HARRY L 2-1**

**2-28S-15E**

**W2SWNW**

Charles T. Jr. & Dulcie M. Parker  
227S 8th  
Fredonia, KS 66736

**W2SE S. of RR & SESE less tract**

Crown Properties  
PO Box 97  
Bendict, KS 66714

**NESE & tract**

Midwest Minerals, Inc.  
PO Box 412  
Pittsburg, KS 66762

AT&SF Railway Co  
PO Box 961089  
Fort Worth, TX 76161

**3-28S-15E**

**Tract in E2E2**

Charles T. Jr. & Dulcie M. Parker  
227S 8th  
Fredonia, KS 66736

**Affidavit of Notice Served**

Re: Application for: APPLICATION FOR COMMINGLING OF PRODUCTION OR FLUIDS ACO-4

Well Name: ORENDORFF, HARRY L 2-1 Legal Location: SWSENE SW S2-T28S-R15E

The undersigned hereby certifies that he / she is a duly authorized agent for the applicant, and that on the day 27<sup>th</sup> of NOVEMBER 2012, a true and correct copy of the application referenced above was delivered or mailed to the following parties:

Note: A copy of this affidavit must be served as a part of the application.

Name Address (Attach additional sheets if necessary)

SEE ATTACHED

I further attest that notice of the filing of this application was published in the THE WILSON COUNTY CITIZEN, the official county publication of WILSON county. A copy of the affidavit of this publication is attached.

Signed this 27<sup>th</sup> day of NOVEMBER, 2012

[Signature]  
Applicant or Duly Authorized Agent

Subscribed and sworn to before me this 27<sup>th</sup> day of NOVEMBER, 2012



[Signature]  
Notary Public  
My Commission Expires: July 20, 2016



**ORENDORFF, HARRY L 2-1**

<b>LEGAL LOCATION</b>	<b>SPOT</b>	<b>CURR_OPERA</b>
S2-T28S-R15E	SE SW SE	B-P Ent.
S11-T28S-R15E	SE NW NE	J-V Oil, LLC
S11-T28S-R15E	NE NW NE	J-V Oil, LLC
S11-T28S-R15E	NE NW NE	J-V Oil, LLC
S11-T28S-R15E	NE NW NE	J-V Oil, LLC
S11-T28S-R15E	NW NW NE	J-V Oil, LLC
S2-T28S-R15E	SW SW SE	J-V Oil, LLC
S2-T28S-R15E	SE SW SE	J-V Oil, LLC
S2-T28S-R15E	SW SW SE	J-V Oil, LLC
S2-T28S-R15E	SE SW SE	J-V Oil, LLC
S2-T28S-R15E	NE SW SE	J-V Oil, LLC
S2-T28S-R15E	SW SW SE	J-V Oil, LLC
S2-T28S-R15E	SW SE	J-V Oil, LLC

BP Ent.  
1803 Ridgebrook Drive  
Arlington, TX 76015

J-V Oil, LLC  
PO Box 151  
Chanute, KS 66720

**ORENDORFF, HARRY L 2-1**

**2-28S-15E**

**W2SWNW**

Charles T. Jr. & Dulcie M. Parker  
227S 8th  
Fredonia, KS 66736

**W2SE S. of RR & SESE less tract**

Crown Properties  
PO Box 97  
Bendict, KS 66714

**NESE & tract**

Midwest Minerals, Inc.  
PO Box 412  
Pittsburg, KS 66762

AT&SF Railway Co  
PO Box 961089  
Fort Worth, TX 76161

**3-28S-15E**

**Tract in E2E2**

Charles T. Jr. & Dulcie M. Parker  
227S 8th  
Fredonia, KS 66736

Conservation Division  
Finney State Office Building  
130 S. Market, Rm. 2078  
Wichita, KS 67202-3802



Phone: 316-337-6200  
Fax: 316-337-6211  
<http://kcc.ks.gov/>

Mark Sievers, Chairman  
Thomas E. Wright, Commissioner  
Shari Feist Albrecht, Commissioner

Sam Brownback, Governor

December 12, 2012

Clark Edwards  
PostRock Midcontinent Production LLC  
Oklahoma Tower  
210 Park Ave, Ste 2750  
Oklahoma City, OK 73102

RE: Approved Commingling CO121205  
Orendorff, Harry L. 2-1, Sec. 2-T28S-R15E, Wilson County  
API No. 15-205-27013-00-00

Dear Mr. Edwards:

Your Application for Commingling (ACO-4) for the above described well, received by the KCC on December 10, 2012, has been reviewed and approved by the Kansas Corporation Commission (KCC) per K.A.R. 82-3-123. Notice was examined and found to be proper per K.A.R. 82-3-135a. No protest had been filed within the 15-day protest period.

Based upon the depth of the Riverton formation perforations, total oil production shall not exceed 100 BOPD and total gas production shall not exceed 50% of the absolute open flow (AOF).

**File form ACO-1 upon re-completion of the well to commingle.**

Commingling ID number CO121205 has been assigned to this approved application. Use this number for well completion reports (ACO-1) and other correspondence that may concern this approved commingling.

Sincerely,

Rick Hestermann  
Production Department