

STATE OF KANSAS
STATE CORPORATION COMMISSION
200 Colorado Derby Bldg.
Wichita, Kansas 67202

Form CP-4
Rev. 12-15-80

WELL PLUGGING RECORD

Give All Information Completely
Make Required Affidavit

COUNTY Pratt SEC. 13 TWP. 27 RGE. 14 SE/W
Location as in quarters or footage from lines:
SW SW NW

Locate Well
correctly on above
Section Platt.

Lease Owner Texas Energies, Inc.
Lease Name Jones Well No. 3-13
Office Address P. O. Box 947
Character of Well (Completed as Oil, Gas or Dry Hole): Dry Hole
Date Well Completed 08-02-81
Application for plugging filed 08-04-81
Plugging commenced 08-02-81
Plugging completed 08-02-81
Reason for abandonment of well or producing formation

Dry-Abandoned
Was permission obtained from the Conservation Division or it's
Agent's before plugging was commenced? yes

Name of Conservation Agent who supervised plugging of this well Maurice Leslie

Producing formation _____ Depth to top _____ bottom T.D. 4728'

Show depth and thickness of all water, oil and gas formations.

OIL, GAS OR WATER RECORDS Casing Record

Formation	Content	From	To	Size	Put in	Pulled Out

Describe in detail the manner in which the well was plugged, indicating where the mud
fluid was placed and the method or methods used in introducing it into the hold. If cement
or other plugs were used, state the character of same and depth placed, from _____ feet
to _____ feet for each plug set.

Plugged as follows:

1st plug @ 820' w/60 sks. 50/50Pos-Mix 4% Gel 3% CC
2nd plug @ 390' w/40 sks. 50/50Pos-Mix 4% Gel 3% CC
Bridge plug @ 40' w/10 sks
2 sks. water well
Cement - 122 sks. 50/50 Pos-mix 4% Gel 3% CC
Plug set & job completed at 1:50 p.m. 8-2-81

Witnesses: Gale Patrick, Steve Greer, David Hull, Patrick
Easter, Merle Staats, Maurice Towns

RECEIVED
STATE CORPORATION COMMISSION

(If additional description is necessary, use BACK of this sheet)
Name of Plugging Contractor Texas Energies Xploration Co., Inc.

AUG 5 1981

STATE OF Kansas COUNTY OF Pratt, ss.
Lloyd E. Geoffroy, Jr. (employee of owner) or (owner or operator) of the
above-described well, being first duly sworn on oath, says: That I have knowledge of the
facts, statements, and matters herein contained and the log of the above-described well as
filed and that the same are true and correct. So help me God.

CONSERVATION DIVISION
Wichita, Kansas

(Signature) [Signature]
Lloyd E. Geoffroy, Jr., President

(Address) P.O. Box 947, Pratt, KS 67124

SUBSCRIBED AND SWORN TO before me this 4 day of August, 1981

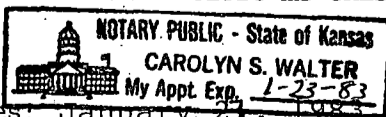

[Signature]
Carolyn S. Walter Notary Public.

My Commission expires: January 23, 1983

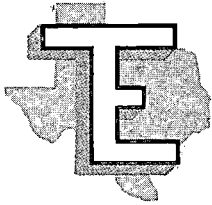

TEXAS ENERGIES, INC.

DRILLERS' WELL LOG

Jones 3-13
SW SW NW, Sec. 13, TWP. 27S, R14W
Pratt County, Kansas

Commenced 07-18-81

Completed 08-02-81

OPERATOR: Texas Energies, Inc./Company Tools (TEXPLOR)

<u>DEPTH</u>		<u>FORMATION</u>	<u>REMARKS</u>
FROM	TO		
0	290	Sand	Spudded at 11:00 p.m. 7-18-81
290	1180	Redbed	Ran 9 jts. 28# 8 5/8" csg. 381.81
1180	4725	Lime & Shale	set @ 393.81 Cement w/150 sks. Howcolite & 150 sks. Common 2% Gel 3% CC Plugged down @ 3:00 a.m. 7-19-81
			Total Depth of well 4728'
			1st plug @ 820' w/60 sks. 50/50
			Pos-mix 4% Gel 3% CC 2nd plug
			@ 390' cemented w/40 sks. 50/50
			Pos-mix 4% Gel 3% CC
			Bridge plug @ 40' w/10 sks.
			10 sks. in rathole 2 sks water
			well Cement = 122 sks 50/50
			Pos-mix 4% Gel 3% CC
			Plug set & job complete @ 1:50
			p.m. 8-2-81

STATE OF KANSAS)
) ss.
COUNTY OF PRATT)

I, the undersigned, being duly sworn on oath, state that the above Drillers' Log is true and correct to the best of my knowledge and belief and according to the records of this office.

TEXAS ENERGIES XPLORATION CO., INC.

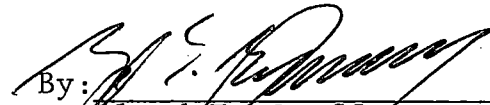
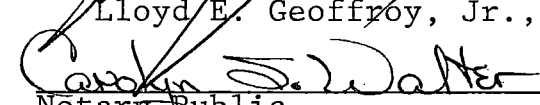
By: 
Lloyd E. Geoffroy, Jr., President

Notary Public
Carolyn S. Walter

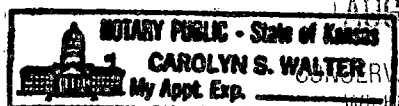
RECEIVED
STATE CORPORATION COMMISSION
MY COMMISSION EXPIRES:



AUG 5 1981
CONSERVATION DIVISION
Pratt, Kansas

KANSAS

WELL COMPLETION REPORT AND DRILLER'S LOG

S. 13 T. 27 R. 15 W

Loc. SW SW NW

County Pratt

API No. 15 - 151 - 20,912
County Number

Operator
Texas Energies, Inc.

Address
P. O. Box 947, Pratt, KS 67124

Well No. 3-13 Lease Name Jones

Footage Location
2310' feet from (N) (S) line 330 feet from (E) (W) line

Principal Contractor TEXPLOR Geologist Scott Alberg

Spud Date 07-18-81 Date Completed 08-02-81 Total Depth 4728 P.B.T.D.

Directional Deviation Oil and/or Gas Purchaser

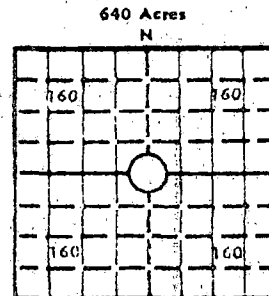

Elev.: Gr. 2034

DF KB 2045

CASING RECORD

Report of all strings set — surface, intermediate, production, etc.

Purpose of string	Size hole drilled	Size casing set (in O.D.)	Weight lbs/ft.	Setting depth	Type cement	Sacks	Type and percent additives
Surface	12 1/4	8 5/8	28	393	Howco Lite Common	150 150	2% Gel 3% CC

LINER RECORD

PERFORATION RECORD

Top, ft.	Bottom, ft.	Sacks cement	Shots per ft.	Size & type	Depth interval

TUBING RECORD

Size	Setting depth	Packer set at

ACID, FRACTURE, SHOT, CEMENT SQUEEZE RECORD

Amount and kind of material used	Depth interval treated

INITIAL PRODUCTION

RECEIVED

STATE CORPORATION COMMISSION

Date of first production Producing method (flowing, pumping, gas lift, etc.)

RATE OF PRODUCTION PER 24 HOURS Oil Gas Water
bbis. MCF bbls. CFPB

Disposition of gas (vented, used on lease or sold) Producing interval
CONSERVATION DIVISION
Wichita, Kansas

INSTRUCTIONS: As provided in KCC Rule 82-2-125, within 90 days after completion of a well, one completed copy of this Drillers Log shall be transmitted to the State Geological Survey of Kansas, 4150 Monroe Street, Wichita, Kansas 67209. Copies of this form are available from the Conservation Division, State Corporation Commission, 245 No. Water, Wichita, Kansas 67202. Phone AC 316-522-2206. If confidential custody is desired, please note Rule 82-2-125. Drillers Logs will be on open file in the Oil and Gas Division, State Geological Survey of Kansas, Lawrence, Kansas 66044.

Operator: Texas Energies, Inc. DESIGNATE TYPE OF COMP.: OIL, GAS, DRY HOLE, SWDW, ETC.: Dry Hole

Well No. 3-13 Lease Name Jones

§ 13 T 27 R 15 W

WELL LOG

Show all important zones of porosity and contents thereof; cored intervals, and all drill-stem tests, including depth interval tested, cushion used, time tool open, flowing and shut-in pressures, and recoveries.

SHOW GEOLOGICAL MARKERS, LOGS RUN, OR OTHER DESCRIPTIVE INFORMATION.

FORMATION DESCRIPTION, CONTENTS, ETC.	TOP	BOTTOM	NAME	DEPTH
DST # 1, 30-30-30-30, IHP 2031 FHP 2031, IFP 37-55 FFP 55-55, ISIP 129 FSIP 129, Rec. 5' M	4098	4119	Admire Tarkio Howard Topeka	2935 (-890) 3118 (-1073) 3263 (-1223) 3363 (-1318)
DST # 2, 30-30-30-30, IHP 2125 FHP 2106, IFP 37-55 FFP 55-55, ISIP 1089 FSIP 370, Rec. 5; M	4138	4155	Heebner Br. Lime Lansing B/KC	3788 (-1743) 3938 (-1893) 3964 (-1919) 4296 (-2251)
DST # 3, 30-30-30-30, IHP 2246 FHP 2181, IFP 37-46 FFP 46-54, ICIP 59 FCIP 56 BHT 114, Rec. 20' M	4348	4390	Miss. Viola Simp. Sh. Simp. Sd. Arbuckle	4415 (-2370) 4543 (-2498) 4645 (-2600) 4665 (-2620) 4718 (-2673)
DST # 4, 30-60-45-75, ISIP 1062 FSIP 740, IFP 100-plugged FFP 97- 102, IHP 2386 FHP 2209, BHT 113, Rec. 200' GCM	4384	4440		
DST # 5, 30-45-45-75, BHT 110, IHP 2349 FHP 2246, IFP 37-39 FFP 37-54, ISIP 58 FSIP 58, Rec. 25' M	4456	4482		
DST # 6 30-45-45-60, IHP 2293 FHP 2265, IFP 92-120 FFP 148-146 ISIP 1016 FSIP 776, BHT 118, Rec. 150' M	4527	4607		

USE ADDITIONAL SHEETS, IF NECESSARY, TO COMPLETE WELL RECORD.

Date Received _____



 Signature
 Vice President of Operations

 Title
 August 3, 1981

 Date