

15-151-20372-00-00

STATE OF KANSAS
 STATE CORPORATION COMMISSION
 CONSERVATION DIVISION
 P. O. BOX 17027
 WICHITA, KANSAS 67217

FORM CP-4

WELL PLUGGING RECORD

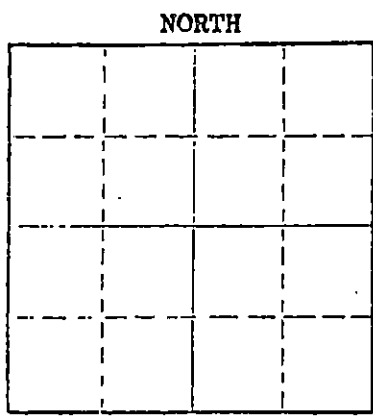

Pratt County, Sec. 15 Twp. 28S Rge. (E) 13W(W)
 Location as "NE/CNWSW" or footage from lines. 1320 FNL 1320 FWL
 Lease Owner Continental Oil Company
 Lease Name Calbeck Well No. 1
 Office Address 3535 N. W. 58th Street, Oklahoma City, Ok. 73112
 Character of Well (completed as Oil, Gas or Dry Hole) Dryhole
 Date well completed February 10, 1977
 Application for plugging filed February 9, 1977
 Application for plugging approved February 9, 1977
 Plugging commenced February 10, 1977
 Plugging completed February 10, 1977
 Reason for abandonment of well or producing formation Dry

If a producing well is abandoned, date of last production 19____
 Was permission obtained from the Conservation Division or its agents before plugging was commenced? Yes

Name of Conservation Agent who supervised plugging of this well Metz
 Producing formation _____ Depth to top _____ Bottom _____ Total Depth of Well 3230 Feet
 Show depth and thickness of all water, oil and gas formations.

OIL, GAS OR WATER RECORDS				CASING RECORD		
FORMATION	CONTENT	FROM	TO	SIZE	PUT IN	FULLED OUT
		0	262	8 5/8	262	None

Describe in detail the manner in which the well was plugged, indicating where the mud fluid was placed and the method or methods used in introducing it into the hole. If cement or other plugs were used, state the character of same and depth placed, from _____ feet to _____ feet for each plug set.

Plugged: 20 sacks @ 695; 25 sacks @ 248,
 Filled with mud to 40, 1/2 sacks
 hulls and plug; 15 sacks to base of
 cellar, 5 sacks in rathole, 5 sacks
 in mousehole.
 Completed: 9:00 pm 2-10-77 by Sun Cementing

RECEIVED
 STATE CORPORATION COMMISSION

(If additional description is necessary, use BACK of this sheet)
 Name of Plugging Contractor DaMac Drilling Inc.
 Address Box 1164, Great Bend, Kansas 67530
 FEB 18 1977
 2-18-77
 CONSERVATION DIVISION

STATE OF Kansas COUNTY OF Barton ss.
 Martha J. McKown (employee of owner) or (owner or operator) of the above-described

well, being first duly sworn on oath, says: That I have knowledge of the facts, statements, and matters herein contained and the log of the above-described well as filed and that the same are true and correct. So help me God.

DONALD SLOUP
 STATE NOTARY PUBLIC
 Barton County, Kansas
 My Commission Expires
 November 11, 1978

(Signature) Martha J. McKown
 Box 1164, Great Bend, Kansas 67530
 (Address)

SUBSCRIBED AND SWORN to before me this 14th day of February, 1977

My commission expires 11-11-78 Notary Public.

KANSAS DRILLERS LOG

API No. 15 — 151 — 20372-00-00
 County Number

S. 15 T. 28S R. 13W ^E/_W
 Loc. 320 FNL 320 FWL
 County Pratt

Operator
Continental Oil Company

Address
3535 NW 58 Street, Oklahoma City, Oklahoma 73112

Well No. 1 Lease Name Calbeck

Footage Location
1320 feet from (N) (S) line 1320 feet from (E) (W) line

Principal Contractor DaMac Drilling Inc. Geologist Fred Lillibridge

Spud Date 2-1-77 Total Depth 3230 P.B.T.D. 0

Date Completed 2-10-77 Oil Purchaser -----

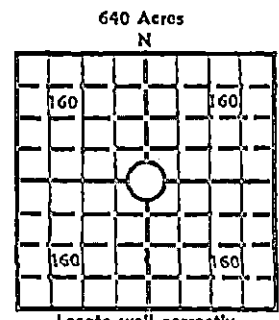

Elev.: Gr. 1930'
 DF ----- KB 1938'

CASING RECORD

Report of all strings set — surface, intermediate, production, etc.

Purpose of string	Size hole drilled	Size casing set (in O.D.)	Weight lbs/ft.	Setting depth	Type cement	Sacks	Type and percent additives
Surface	12 1/4	8 5/8	24	262	Reg & 2% Gel	225	3% CC

LINER RECORD

PERFORATION RECORD

Top, ft.	Bottom, ft.	Sacks cement	Shots per ft.	Size & type	Depth Interval

TUBING RECORD

Size	Setting depth	Packer set at

ACID, FRACTURE, SHOT, CEMENT SQUEEZE RECORD

Amount and kind of material used

RECEIVED
 STATE GEOLOGICAL SURVEY
 CORPORATION
 FEB 18 1977
 2-18-77
 CONSERVATION DIVISION
 WICHITA, KANSAS

DRYHOLE

INITIAL PRODUCTION

Date of first production _____ Producing method (flowing, pumping, gas lift, etc.) _____

RATE OF PRODUCTION PER 24 HOURS
 Oil _____ Gas _____ Water _____ Gas-oil ratio _____
 bbls. MCF bbls. CFPB

Disposition of gas (vented, used on lease or sold) _____ Producing interval(s) _____

INSTRUCTIONS: As provided in KCC Rule 82-2-125, within 90 days after completion of a well, one completed copy of this Drillers Log shall be transmitted to the State Geological Survey of Kansas, 4150 Monroe Street, Wichita, Kansas 67209. Copies of this form are available from the Conservation Division, State Corporation Commission, 3830 So. Meridian (P.O. Box 17027), Wichita, Kansas 67227. Phone AC 316-523-2206. If confidentiality is desired, please note Rule 82-2-125. Drillers fees shall be as set forth in the General Code of Regulations.

Operator CONTINENTAL OIL COMPANY DESIGNATE TYPE OF COMP.: OIL, GAS, DRY HOLE, SWDW, ETC.:

Well No. 1 Lease Name CALBECK No. 1

S 15 T 28S R 13W^E_W Dryhole

WELL LOG
 Show all important zones of porosity and contents thereof; cored intervals, and all drill-stem tests, including depth interval tested, cushion used, time tool open, flowing and shut-in pressures, and recoveries.
 SHOW GEOLOGICAL MARKERS, LOGS RUN, OR OTHER DESCRIPTIVE INFORMATION.

FORMATION DESCRIPTION, CONTENTS, ETC.	TOP	BOTTOM	NAME	DEPTH
Sand & RedBed	0	262		
Sand & Shale	262	365		
Shale	365	1109		
Lime & Shale	1109	3230RTD		

USE ADDITIONAL SHEETS, IF NECESSARY, TO COMPLETE WELL RECORD.

Date Received _____
 Signature: Martha J. McKown
 Title: Vice President
 Date: February 14, 1977