

STATE OF KANSAS  
STATE CORPORATION COMMISSION

WELL PLUGGING RECORD

Give All Information Completely  
Make Required Affidavit  
Mail or Deliver Report to:  
Conservation Division  
State Corporation Commission  
212 North Market, Insurance Bldg.  
Wichita, Kansas

MEADE County. Sec. 20 Twp. 33S Rge. (E) 30(W)

Location as "NE/CNW/SW" or footage from lines C NE/4 SW/4  
Lease Owner TEXACO INC.  
Lease Name H. C. BAKER Well No. 1  
Office Address 614 Bitting Building - Wichita, Kansas  
Character of Well (completed as Oil, Gas or Dry Hole) Dry  
Date well completed May 29, 1959  
Application for plugging filed Feb. 16, 1961  
Application for plugging approved Feb. 20, 1961  
Plugging commenced March 7, 1961  
Plugging completed March 15, 1961  
Reason for abandonment of well or producing formation Dry

NORTH

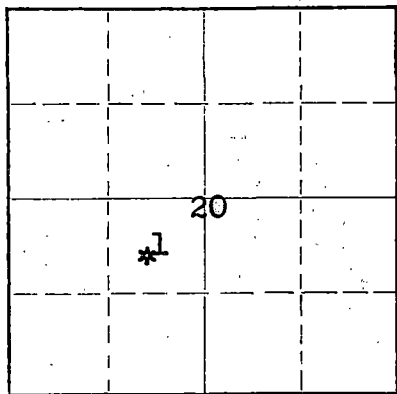

Locate well correctly on above  
Section Plat

If a producing well is abandoned, date of last production None 19  
Was permission obtained from the Conservation Division or its agents before plugging was commenced? Yes

Name of Conservation Agent who supervised plugging of this well W. L. Lackamp  
Producing formation Morrow Sd. Depth to top 5659 Bottom 5730 Total Depth of Well 5810 Feet  
Show depth and thickness of all water, oil and gas formations.

OIL, GAS OR WATER RECORDS

CASING RECORD

FORMATION	CONTENT	FROM	TO	SIZE	PUT IN	PULLED OUT
Morrow Sd.	Sho Oil & Gas	5659	5730	8-5/8"	1490	None
				5-1/2"	5810	3012

Describe in detail the manner in which the well was plugged, indicating where the mud fluid was placed and the method or methods used in introducing it into the hole. If cement or other plugs were used, state the character of same and depth placed, from feet to feet for each plug set.

From 5810 to 5765 with cement, 5765 to 5670 with heavy mud, 5670 to 5634 with cement, 5634 to 550 with heavy mud, 550 to 494 with cement, 494 to 50 with heavy mud, 50 to 22 with cement, 22 to ground level with surface clay.

RECEIVED  
STATE CORPORATION COMMISSION  
MAR 24 1961  
CONSERVATION DIVISION  
Wichita, Kansas

(If additional description is necessary, use BACK of this sheet)  
Name of Plugging Contractor Knight Casing Pulling Company  
Address Chase, Kansas

STATE OF KANSAS, COUNTY OF SEDGWICK, ss.  
M. C. HARRELL (employee of owner) of the above-described well, being first duly sworn on oath, says: That I have knowledge of the facts, statements, and matters herein contained and the log of the above-described well as filed and that the same are true and correct. So help me God.

(Signature) M. C. Harrell  
Wichita, Kansas (Address)

SUBSCRIBED AND SWORN TO before me this 22nd day of March, 1961

A. E. Boyd

My commission expires June 20, 1964

Notary Public.

THE TEXAS COMPANY—LOG OF WELL  
Tulsa DIVISION

640 ACRES  
N

INDICATE EXACT WELL LOCATION & LEASE BOUNDARY WITHIN SECTION

WELL Hugh C. Baker L. D. FILE NO. 57488  
 LOC. Center NE 1/4 SW 1/4 SEC. 20 TWP. 33S RSE. 20W  
Banked 660' S & 660' W of NE Cor SW 1/4  
 DIST. Kansas CO. PARISH. Wade STATE Kansas  
 COMM. DRLG. 4-23-59 COMP. DRLG. 5-15-59 DAYS DRLG. 23  
 ROT. FROM 0 TO 5810 CABLE FROM \_\_\_\_\_ TO \_\_\_\_\_  
 CONTR. OR CO. RIG NO. Lyon Drilling Company T. D. DRILLED. 5810  
KR 2736  
 COMP. T. D. 03 5765 ZERO ELEV. 01 2223 GRC. ELEV. 2711 CSG. FLG. ELEV. 03-01 151

DATE OF FIRST PROD. Dry OFFICIAL COMP. DATE 5-29-59  
 LOGS RUN Garma Ray, Radiation Shield Log.

CASING RECORD

SIZE INCHES	DEPTH FEET	WEIGHT = FT	GRADE	RANGE	REMARKS—QUAN. CMT., TEMP. SURV., ETC.
13 3/8"	35'		SW	R-3	Set & cemented @ 35' w/3 yds ready mix
8 5/8"	1490'	11.8	J-55	R-2	Set & cemented @ 1490' w/400 sx pozmix w/4 % jel & 2% C.C. cement circ.
5 1/2"	5810'	14.8 15.4	J-55	R-2	Set & cemented @ 5810' w/75 sx pozmix. Top cement @ 5575'
			<u>EXT. JOBS</u>		5762 - 5732 - 5702 - 5672
			<u>DR. JOBS</u>		5762 - 5747 - 5722 - 5717 - 5702 - 5687 - 5672 - 5657

COMPLETION DATA

FORMATION	<u>Dry</u>			
DATE OF TEST				
DEPTH OF PROD. INTERVAL				
INITIAL PRODUCTION	OIL - BPD			
	GAS - MCF			
	WATER - BPD			
	GOR			
	BHP - PSI			
CORRECTED API GRAVITY				
PRODUCING CONDITIONS	<u>Dry</u>			

**RECEIVED**  
 STATE CORPORATION COMMISSION  
 FEB 17 1961  
 CONSERVATION DIVISION  
 Wichita, Kansas

15-119-10209-0000  
 COUNTY, MANASSAS REC. NO., TWP. 33S, RGE. 30E  
 COUNTY, WELL NO. 1  
 FARM NAME

**FORMATION RECORD**

Give detailed description and thickness of all formations drilled through, contents of sand, whether dry, water, oil or gas.

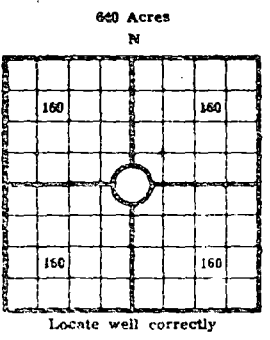

COUNTY Meade SEC. 20 TWP. 33S RGE. 30E  
 COMPANY OPERATING TRILACO Inc.  
 OFFICE ADDRESS \_\_\_\_\_  
 FARM NAME HUGH O. BAKER WELL NO. 1  
 DRILLING STARTED 4-22-59 DRILLING FINISHED 5-15-59  
 DATE OF FIRST PRODUCTION \_\_\_\_\_ COMPLETED \_\_\_\_\_  
 WELL LOCATED  $\frac{1}{4}$   $\frac{1}{4}$   $\frac{1}{4}$  \_\_\_\_\_ North of South  
 Line and \_\_\_\_\_ ft. East of West Line of Quarter Section  
 Elevation (Relative to sea level) DERRICK FLOOR \_\_\_\_\_ GROUND \_\_\_\_\_  
 CHARACTER OF WELL (Oil, gas or dryhole) \_\_\_\_\_

**OIL OR GAS SANDS OR ZONES**

Name	From	To	Name	From	To
1			4		
2			5		
3			6		

**Perforating Record if Any**

**Shot Record**

Formation	From	To	No of Shots	Formation	From	To	Size of Shot

**CASING RECORD**

Amount Set						Amount Pulled				Packer Record	
Size	Wt.	Thds.	Make	Ft.	In	Ft.	In	Size	Length	Depth Set	Make
2 5/8	12.75			1129	56	cemented w/ 1550		sls	pozzix	24	30
5 1/2	28.5			511	9	cemented w/ 75		sls	pozzix		

Liner Record: Amount \_\_\_\_\_ Kind \_\_\_\_\_ Top \_\_\_\_\_ Bottom \_\_\_\_\_

**CEMENTING AND MUDDING**

Size	Amount Set		Sacks Cement	Chemical		Method of Cementing	Amount	Mudding Method	Results (See Note)
	Ft.	In		Gal.	Make				

Note: What method was used to protect sands if outer strings were pulled? \_\_\_\_\_

NOTE: Were bottom hole plugs used? \_\_\_\_\_ If so, state kind, depth set and results of test.

**TOOLS USED**

Rotary Tools were used from \_\_\_\_\_ feet to \_\_\_\_\_ feet. Cable tools were used from \_\_\_\_\_ feet to \_\_\_\_\_ feet, and from \_\_\_\_\_ feet to \_\_\_\_\_ feet, and from \_\_\_\_\_ feet to \_\_\_\_\_ feet.  
 Type Rig National 50

**INITIAL PRODUCTION TEST**

Describe initial test: whether by flow through tubing or casing or by pumping \_\_\_\_\_  
 Amount of Oil Production \_\_\_\_\_ bbls. Size of choke, if any \_\_\_\_\_ Length of test \_\_\_\_\_ Water  
 Production \_\_\_\_\_ bbls. Gravity of oil \_\_\_\_\_ Type of Pump as used, describe \_\_\_\_\_

Formation	Top	Bottom	Formation	Top	Bottom
Sd & shells	0	520			
Red bed & sand	520	790			
Red bed, Anhy Sh&Sd	790	1260			
Sd & sh	1260	1459			
Anhy. Dol.	1459	1490			
Bolg. Sd Sh	1490	1780			
Sh, Shell & Ln	1780	2000			
Sh Ln & anhy strks	2000	2125			
Sh & Ln	2125	3679			
Chalk Ln	3679	3728			
Ln & chky Ln	3728	3800			
Ln	3800	3881			
Ln & sh	3881	3955			
Sh, Ln, sd	3955	4080			
sh & Ln	4080	4405			
Ln	4405	4466			
Ln & sh	4466	4613			
Ln	4613	4691			
Ln & sh	4691	4740			
Ln	4740	4889			
Ln & sh	4889	4989			
Ln & sd	4989	5046			
Ln	5046	5129			
Ln & sh	5129	5237			
Ln	5237	5327			
Ln & sh	5327	5360			
Ln	5360	5431			
Ln & sh	5431	5680			
Ln, Sd & sh	5680	5770			
Ln & sh	5770	5810			
TOTAL DEPTH		5810			

**RECEIVED**  
 STATE CORPORATION COMMISSION

FEB 1 1961

STATE CORPORATION COMMISSION  
 WASHINGTON, D.C.

I, the undersigned, being first duly sworn upon oath, state that this well record is true, correct and complete according to the records of this office and to the best of my knowledge and belief.

Name and title of representative of company \_\_\_\_\_

Subscribed and sworn to before me this 15th day of July, 1959

My Commission expires \_\_\_\_\_ Notary Public.