

15-119-10037-0000

STATE OF KANSAS  
STATE CORPORATION COMMISSION

WELL PLUGGING RECORD

Give All Information Completely  
Make Required Affidavit  
Mail or Deliver Report to:  
Conservation Division  
State Corporation Commission  
800 Biting Building  
Wichita, Kansas

Moade County, Sec. 20 Twp. 33 Rge. 30 (E) W (W)

Location as "NE/CNW/SW" or footage from lines Center of NW/4 of SE/4

Lease Owner Columbian Fuel Corporation

Lease Name G. Gibler Well No. 4-1

Office Address Drawer 31, Liberal, Kansas

Character of Well (completed as Oil, Gas or Dry Hole) Dry hole

Date well completed October 19, 1953

Application for plugging filed October 19, 1953

Application for plugging approved 19

Plugging commenced October 19, 1953

Plugging completed October 19, 1953

Reason for abandonment of well or producing formation Dry

If a producing well is abandoned, date of last production None 19

Was permission obtained from the Conservation Division or its agents before plugging was commenced? Yes

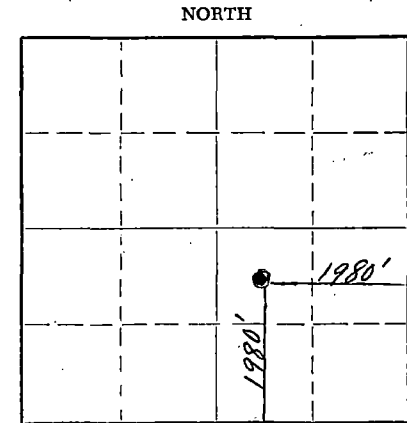

Locate well correctly on above Section Plat

Name of Conservation Agent who supervised plugging of this well M. A. Rives

Producing formation None Depth to top Bottom Total Depth of Well 5850 Feet

Show depth and thickness of all water, oil and gas formations.

OIL, GAS OR WATER RECORDS

CASING RECORD

FORMATION	CONTENT	FROM	TO	SIZE	PUT-IN	PULLED OUT
None				13 3/8"	643'	None
				8 5/8"	2629'	None

Describe in detail the manner in which the well was plugged, indicating where the mud fluid was placed and the method or methods used in introducing it into the hole. If cement or other plugs were used, state the character of same and depth placed, from feet to feet for each plug set.

5850' to 546' filled with 9 1/2 lb. 41 Vis. mud  
546' to 440' cement plug (33 sacks)  
440' to 42' 9 1/2 lb., 41 Vis. mud  
42' to 0' cement plug (12 sacks)

All cement plugs displaced through drill pipe.

RECEIVED  
STATE CORPORATION COMMISSION  
OCT 22 1953  
CONSERVATION DIVISION  
Wichita, Kansas

Name of Plugging Contractor Done by company  
Address Drawer 31, Liberal, Kansas

STATE OF Kansas COUNTY OF Seward, ss.  
I, Robert Grady, (employee of owner) or (owner or operator) of the above-described

well, being first duly sworn on oath, says: That I have knowledge of the facts, statements, and matters herein contained and the log of the above-described well as filed and that the same are true and correct. So help me God.

(Signature) Robert Grady  
Robert Grady, Superintendent  
Drawer 31, Liberal, Kansas  
(Address)

SUBSCRIBED AND SWORN TO before me this 19th day of October, 1953

Wallace B. Pedigo  
Wallace B. Pedigo Notary Public.

My commission expires June 4, 1955

PLUGGING  
FILE SEC 20 T 33 R 30 W  
BOOK PAGE 137 LINE 34

# LOG OF WELL

CODE GW 2055 Columbian Fuel Corp SHEET \_\_\_\_\_  
(COMPANY)  
 STATE Kansas DISTRICT 72 COUNTY Meade  
 LEASE C. Gibler WELL NO. 1 SEC. 20 TWP. 33 R. 30  
 DATE OF LOG 10-31-53 LOCATION IN SEC. 1980' From East & 1980' From South Lines  
 LOCATION MADE 9-19-53 COMM. RIGGING UP 9-18-53 COMM. DRILLING 9-19-53 COMP. DRILLING 10-19-53  
 TOTAL DEPTH 5850' ELEVATION 2717.4' Ground STATE PERMIT NO. \_\_\_\_\_  
 DAY DRILLER Bill Jones NIGHT DRILLER Audie Holland CONTRACTOR Helmerich & Payne Inc.  
 CABLE TOOLS FROM \_\_\_\_\_ TO \_\_\_\_\_ ROTARY TOOLS FROM 0 TO 5850'  
 OPEN FLOW CAPACITY \_\_\_\_\_ M. CU. FT. ROCK PRESSURE \_\_\_\_\_ GASOLINE CONTENT PER M. CU. FT. \_\_\_\_\_  
 DEPTH IN SAND Thru PRODUCING SANDS AND THICKNESS OF EACH Non Productive  
 PRODUCTION FIRST 24 HOURS \_\_\_\_\_ SETTLED PRODUCTION \_\_\_\_\_ STARTED PRODUCTION \_\_\_\_\_  
 DATE TUBED None SYPHON SET \_\_\_\_\_ SIZE \_\_\_\_\_ FEET \_\_\_\_\_

### CASING RECORD

SIZE	WEIGHT	PUT IN WELL		PULLED OUT		LEFT IN WELL		SHOES		PACKERS		
		FEET	IN.	FEET	IN.	FEET	IN.	LENGTH	MAKE	KIND	LENGTH	SET AT
13 3/8"	48#	643.90'				643.90'						
8 5/8"	24#	2629.60'				2629.60'						

LINER: STATE SIZE AND WEIGHT \_\_\_\_\_ WHERE SET \_\_\_\_\_ FT. AND INS. BLANK \_\_\_\_\_ FT. AND INS. PERFORATED \_\_\_\_\_  
 HOW PUT TOGETHER \_\_\_\_\_ COUPLING \_\_\_\_\_ FLUSH-JOINT \_\_\_\_\_ INSERTED \_\_\_\_\_  
 REMARKS \_\_\_\_\_

### EQUIPMENT RECORD

TUBING				SUCKER RODS			PUMPING OUTFIT
SIZE	WEIGHT	FEET	IN.	FEET	IN.	SIZE AND KIND	DESCRIPTION, KIND, SIZE, ETC.

KIND OF SHOT \_\_\_\_\_ SIZE OF SHOT QUARTS \_\_\_\_\_ NUMBER OF SHOTS \_\_\_\_\_  
 NUMBER OF SHELLS \_\_\_\_\_ SIZE OF SHELLS \_\_\_\_\_ INCHES, DIAMETER \_\_\_\_\_  
 LENGTH OF SHELLS \_\_\_\_\_ FT. \_\_\_\_\_ INS. SHOT FURNISHED BY \_\_\_\_\_ TOP OF SHOT \_\_\_\_\_  
 BOTTOM OF SHOT \_\_\_\_\_ ANCHOR \_\_\_\_\_ WELL BRIDGED TO \_\_\_\_\_  
 PRODUCTION BEFORE SHOT \_\_\_\_\_ PRODUCTION AFTER SHOT \_\_\_\_\_  
 NAME OF SHOOTER \_\_\_\_\_ SHOT INSPECTED \_\_\_\_\_ BY \_\_\_\_\_ (COMPANY EMPLOYEE)  
 COMMENCED DRILLING DEEPER \_\_\_\_\_ COMPLETED DRILLING DEEPER \_\_\_\_\_  
 TOTAL DEPTH \_\_\_\_\_ PRODUCTION FIRST 24 HOURS \_\_\_\_\_ SETTLED PRODUCTION \_\_\_\_\_

REMARKS: Drilled To A T.D. Of 5850'. No 5 1/2" O.D. Casing Set. Non Productive. Dry  
& Abandoned. Plugging Commenced 10-19-53 And Completed 10-19-53.

**RECEIVED**  
 STATE CORPORATION COMMISSION

NOV 2 1953  
 CONSERVATION DIVISION  
 Wichita, Kansas

**PLUGGING**  
 FORM NO 19 PO 730  
 SEC 20 T 33 R 30W  
 PAGE 132 LINE 24

C. GIBLER WELL No. 1  
C NW SE, SECTION 20-33S-30W  
MEADE COUNTY, KANSAS  
COLUMBIAN FUEL CORPORATION

CASING RECORD:

SET 13-3/8" CASING @ 642' WITH 500 SACKS.  
" 8-5/8" CASING @ 2640' WITH 1000 SACKS.

COMMENCED: SEPTEMBER 19, 1953  
COMPLETED: OCTOBER 19, 1953  
RESULT: D&A

SURFACE CLAY & SAND	0	575
RED BED	575	675
RED BED, SAND, SHELLS	675	921
RED BED	921	1472
RED BED & ANHYDRITE	1472	1590
SHALE, LIME SHELLS & ANHYDRITE	1590	1875
LIME & ANHYDRITE	1875	2030
SHALE & ANHYDRITE	2030	2417
ANHYDRITE	2417	2632
ANHYDRITE & LIME	2632	2640
LIME	2640	3642
LIME & SHALE	3642	4395
LIMEY SHALE	4395	4438
LIME	4438	4699
LIME & SHALE	4699	4750
LIME & CHERT	4750	4834
LIME	4834	4904
SHALE & LIME	4904	5060
LIME	5060	5109
SHALE & LIME	5109	5850
TOTAL DEPTH		5850

STATE OF OKLAHOMA )  
                          ) ss  
COUNTY OF TULSA   )

I HEREBY AFFIRM THAT THE ABOVE AND FOREGOING IS A TRUE AND CORRECT COPY OF THE LOG OF THE C. GIBLER WELL No. 1 LOCATED IN THE CENTER OF THE NORTHWEST QUARTER OF THE SOUTHEAST QUARTER OF SECTION 20, TOWNSHIP 33 SOUTH, RANGE 30 WEST, MEADE COUNTY, KANSAS.

HELMERICH & PAYNE, INC.

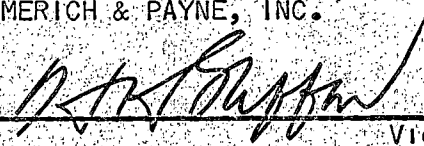
  
\_\_\_\_\_  
VICE PRESIDENT

SUBSCRIBED AND SWORN TO BEFORE ME A NOTARY PUBLIC THIS 28TH DAY OF OCTOBER, 1953.

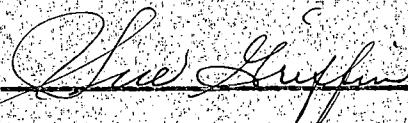
  
\_\_\_\_\_  
NOTARY PUBLIC

MY COMMISSION EXPIRES JULY 22, 1955.

**PLUGGING**  
FILE SEC 20 T 33 R 30W  
BOOK PAGE 132 LINE 24

VED  
CORPORATION COMMISSION  
NOV 2 1953  
CONSERVATION DIVISION  
Wichita, Kansas