

STATE CORPORATION COMMISSION OF KANSAS
OIL & GAS CONSERVATION DIVISION
WELL COMPLETION OR RECOMPLETION FORM
ACO-1 WELL HISTORY
DESCRIPTION OF WELL AND LEASE

API NO. 15-129-20,869-00-00
County... Morton
.....G...SE. Sec. 5 Twp 33S Rge 39 East
..... X West

Operator: License # 5598
Name APX Corporation
Address P.O. Box 351
City/State/Zip Liberal, Kansas 67905-0351

1320 Ft North from Southeast Corner of Section
1320 Ft West from Southeast Corner of Section
(Note: Locate well in section plat below)

Purchaser Panhandle Eastern Pipe Line Co
(Transporter)

Lease Name Gunzenhauser "A" Well # 1H

Operator Contact Person M. L. Pease
Phone (316) 624-6253

Field Name Hugoton

Producing Formation Chase

Contractor: License # 5842
Name Gabbert-Jones, Inc.

Elevation: Ground 3229.8 KB

Wellsite Geologist NA
Phone

Designate Type of Completion
 New Well Re-Entry Workover
 Oil SWD Temp Abd
 Gas Inj Delayed Comp.
 Dry Other (Core, Water Supply etc.)

RECEIVED
STATE CORPORATION COMMISSION
12-29-88
DEC 29 1988
CONSERVATION DIVISION
Wichita, Kansas

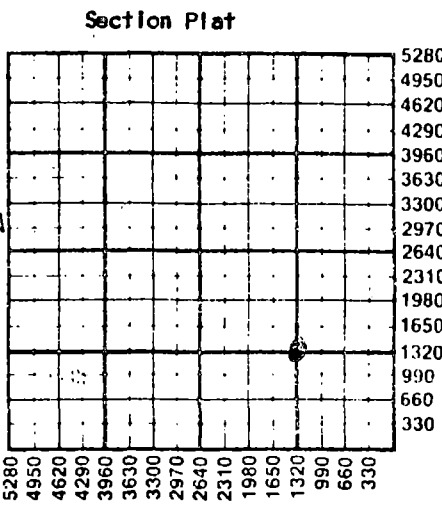

If ONWO: old well info as follows:
Operator
Well Name
Comp. Date Old Total Depth

WATER SUPPLY INFORMATION
Disposition of Produced Water: Disposal
Docket # Repressuring

WELL HISTORY
Drilling Method:
 Mud Rotary Air Rotary Cable
8/10/87 8/14/87 10/18/88
Spud Date Date Reached TD Completion Date
2820 2794
Total Depth PBTD

Amount of Surface Pipe Set and Cemented at 560 feet
Multiple Stage Cementing Collar Used? Yes No
If yes, show depth set feet
If alternate 2 completion, cement circulated from feet depth to w/ SX cmt
Cement Company Name Dowell-Schlumberger, Inc.
Invoice # 03-12-9871

Questions on this portion of the ACO-1 call:
Water Resources Board (913) 296-3717
Source of Water:
Division of Water Resources Permit #
 Groundwater.....Ft North from Southeast Corner
(Well)Ft West from Southeast Corner of
Sec Twp Rge East West
 Surface Water.....Ft North from Southeast Corner
(Stream, pond etc).....Ft West from Southeast Corner
Sec Twp Rge East West
 Other (explain)... Contractor provided water
(purchased from city, R.W.D. #)

INSTRUCTIONS: This form shall be completed in triplicate and filed with the Kansas Corporation Commission, 200 Colorado Derby Building, Wichita, Kansas 67202, within 120 days of the spud date of any well. Rule 82-3-130, 82-3-107 and 82-3-106 apply. Information on side two of this form will be held confidential for a period of 12 months if requested in writing and submitted with the form. See rule 82-3-107 for confidentiality in excess of 12 months. One copy of all wireline logs and drillers time log shall be attached with this form. Submit CP-4 form with all plugged wells. Submit CP-111 form with all temporarily abandoned wells.

All requirements of the statutes, rules and regulations promulgated to regulate the oil and gas industry have been fully complied with and the statements herein are complete and correct to the best of my knowledge.

Signature M. L. Pease
Title Division Production Manager Date 12/22/88

Subscribed and sworn to before me this 28th day of December 1988.
Notary Public Kathryn A. Rowley
Date Commission Expires 8-1-92

K.C.C. OFFICE USE ONLY
F Letter of Confidentiality Attached
C Wireline Log Received
C Drillers Timelog Received
Distribution
 KCC SWD/Rep NGPA
 KGS Plug Other (Specify)
12-29-88
Form ACO-1 (5-86)

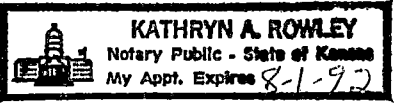

Sec 5 Twp 33S Rge 39W

Operator Name APX Corporation Lease Name..... Gunzenhauser "A" Well #..... 1H.....

Sec... 5 Twp... 33S Rge... 39 East West County..... Morton

WELL LOG

INSTRUCTIONS: Show important tops and base of formations penetrated. Detail all cores. Report all drill stem tests giving interval tested, time tool open and closed, flowing and shut-in pressures, whether shut-in pressure reached static level, hydrostatic pressures, bottom hole temperature, fluid recovery, and flow rates if gas to surface during test. Attach extra sheet if more space is needed. Attach copy of log.

Drill Stem Tests Taken Yes No
 Samples Sent to Geological Survey Yes No
 Cores Taken Yes No

Formation Description
 Log Sample

Name	Top	Bottom
Sand	0'	370'
Shale, Redbed	370'	565
Redbed, Sand	565	1223
Redbed, Lime, Shale	1223	1745
Shale, Lime	1745	2585
Lime	2585	2820
TD		2820

CASING RECORD <input checked="" type="checkbox"/> New <input type="checkbox"/> Used							
Report all strings set-conductor, surface, intermediate, production, etc.							
Purpose of String	Size Hole Drilled	Size Casing Set (in O.D.)	Weight Lbs/Ft.	Setting Depth	Type of Cement	#Sacks Used	Type and Percent Additives
Surface	12-1/4"	8-5/8"	24.0	560	Pozmix & Common	350	3% CC
Production	7-7/8"	5-1/2"	14.0	2817	Class C	225	10% DCD, 20% DCD
PERFORATION RECORD				Acid, Fracture, Shot, Cement Squeeze Record			
Shots Per Foot	Specify Footage of Each Interval Perforated			(Amount and Kind of Material Used)		Depth	
2	2418-2428, 2434-2461, 2480-2519, 2557-2586, 2615-2652, 2670-2680, 2710-2721			Brk dwn w/18,300 gals 2% KCL wtr. Frac w/135,000 gals gelled OA & 367,800# 12/20 sd		2418-2721	
TUBING RECORD		Size	Set At	Packer at	Liner Run	<input type="checkbox"/> Yes <input checked="" type="checkbox"/> No	
Date of First Production	Producing Method						
	<input checked="" type="checkbox"/> Flowing <input type="checkbox"/> Pumping <input type="checkbox"/> Gas Lift <input type="checkbox"/> Other (explain).....						
Estimated Production Per 24 Hours	Oil	Gas	Water	Gas-Oil Ratio	Gravity		
	Bbls	1350 MCF @ 70 psig	Bbls	CFPB			

METHOD OF COMPLETION

Production Interval

Disposition of gas: Vented Sold Used on Lease Open Hole Perforation Other (Specify) 2418-2721 OA...
 Dually Completed Commingled

