

15-175-20420-0000

KANSAS

WELL COMPLETION REPORT AND DRILLER'S LOG

S. 21 T. 33S R. 34 ~~W~~ W

API No. 15 — 175 — 20,420
County Number

Loc. C SW SW

County Seward

Operator
Anadarko Production Company

Address
P. O. Box 351, Liberal, Kansas 67901

Well No. 4 Lease Name MORLAN "A"

Footage Location
660 feet from ~~XX~~ (S) line 660 feet from ~~XX~~ (W) line

Principal Contractor Lohmann-Johnson Geologist Joe Blair

Spud Date 9/17/79 Date Completed 11/13/79 Total Depth 6290 P.B.T.D. 6285

Directional Deviation 1 deg @ 6290' Oil ~~XXXXXX~~ Purchaser Diamond Shamrock Corp.

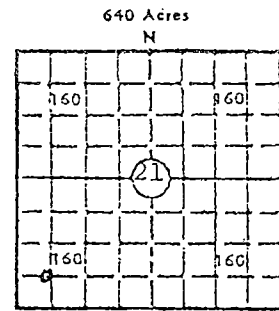

Locate well correctly 2918
Elev.: Gr. _____
DF 2927 KB 2929

CASING RECORD

Report of all strings set — surface, intermediate, production, etc.

| Purpose of string | Size hole drilled | Size casing set (in O.D.) | Weight lbs./ft. | Setting depth | Type cement | Sacks | Type and percent additives |
|-------------------|-------------------|---------------------------|-----------------|---------------|-------------|-------|----------------------------|
| Surface | 12-1/4" | 8-5/8" | 24# | 1673 | Pozmix | 600 | 4% gel 3% CaCl |
| | | | | | Common | 200 | 3% CaCl |
| Production | 7-7/8" | 4-1/2" | 10.5# | 6290 | Pozmix | 175 | .05% CFR-2 |
| | | | | | Lite-wate | 75 | 4% gel |
| | | | | | | | |
| | | | | | | | |

LINER RECORD

PERFORATION RECORD

| Top, ft. | Bottom, ft. | Sacks cement | Shots per ft. | Size & type | Depth interval |
|----------|-------------|--------------|---------------|----------------|----------------|
| | | | 2 | 3-1/8" csg gun | 6227-36' |

TUBING RECORD

ACID, FRACTURE, SHOT, CEMENT SQUEEZE RECORD

| Amount and kind of material used | Depth interval treated |
|---|------------------------|
| A/500 gal 7.5% MS Acid | 6227-36' |
| F/15,500 gal Titan III + 15,000# 20-40 sand | 6227-36' |

RECEIVED
STATE CORPORATION COMMISSION

INITIAL PRODUCTION

MAY 09 1983

| | | | |
|--|--|--|------------------|
| Date of first production 11/9/79 | Producing method (flowing, pumping, gas lift, etc.) Pumping | CONSERVATION DIVISION Wichita, Kansas | |
| RATE OF PRODUCTION PER 24 HOURS | Oil 37 bbls. | Gas 30.1 MCF | Water 6 bbls. |
| Disposition of gas (vented, used on lease or sold) used on lease/remainder to be sold | Gas-oil ratio 814 CFPB | Producing interval(s) 6227-36' | |

INSTRUCTIONS: As provided in KCC Rule 82-2-125, within 90 days after completion of a well, one completed copy of this Drillers Log shall be transmitted to the State Geological Survey of Kansas, 4150 Monroe Street, Wichita, Kansas 67209. Copies of this form are available from the Conservation Division, State Corporation Commission, 245 No. Water, Wichita, Kansas 67202. Phone AC 316-522-2206. If confidential custody is desired, please note Rule 82-2-125. Drillers Logs will be on open file in the Oil and Gas Division, State Geological Survey of Kansas, Lawrence, Kansas 66044.

Anadarko Production Company

DESIGNATE TYPE OF COMP.: OIL, GAS, DRY HOLE, SWDW, ETC.:

| | | |
|---------------|--------------------------|-----|
| Well No. 4 | Lease Name MORLAN "A" | OIL |
|---------------|--------------------------|-----|

S 21 T 33S R 34 ^{Ec}/_W

WELL LOG

Show all important zones of porosity and contents thereof; cored intervals, and all drill-stem tests, including depth interval tested, cushion used, time tool open, flowing and shut-in pressures, and recoveries.

SHOW GEOLOGICAL MARKERS, LOGS RUN, OR OTHER DESCRIPTIVE INFORMATION.

| FORMATION DESCRIPTION, CONTENTS, ETC. | TOP | BOTTOM | NAME | DEPTH |
|---------------------------------------|-------|--------|----------------------|-------|
| | | | LOGS: | |
| Sand | 0' | 580' | Schlumberger | |
| Redbed | 580' | 1068' | DIL-SFL | |
| Shale | 1068' | 1675' | Compensated Neutron- | |
| Lime and Shale | 2130' | 2541' | Formation Density | |
| Shale | 2541' | 3024' | | |
| Lime and Shale | 3024' | 6291' | | |

USE ADDITIONAL SHEETS, IF NECESSARY, TO COMPLETE WELL RECORD.

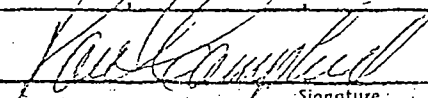
| | | |
|---------------|--|---|
| Date Received | <p>RECEIVED STATE CORPORATION COMMISSION</p> <p>MAY 09 1983</p> <p>CONSERVATION DIVISION Wichita, Kansas</p> |  Signature |
| | | Paul Campbell, Division Production Manager Title November 15, 1979 Date |