

15-175-20389-0000

ORIGINAL

KANSAS DRILLERS LOG

S. 29 T. 33S R. 34 ^{Ex} _W

API No. 15 — 175 — 20,389
County Number

Loc. SE SE

County Seward

Operator
Anadarko Production Company

Address
P. O. Box 351, Liberal, Kansas 67901

Well No. 2 Lease Name FINCHAM "D"

Footage Location
660 feet from ~~xxx~~ (S) line 660 feet from (E) ~~xxx~~ line

Principal Contractor Lohmann-Johnson Drilling Co. Geologist Joe Blair

Spud Date 1-15-79 Total Depth 6355 P.B.T.D. 6312

Date Completed 2-13-79 Oil Purchaser The Permian Corporation

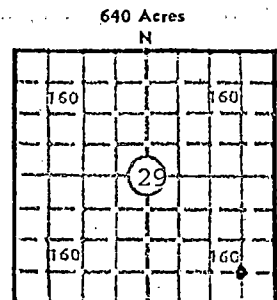

Elev.: Gr. 2930.5

DF KB

CASING RECORD

Report of all strings set— surface, intermediate, production, etc.

Purpose of string	Size hole drilled	Size casing set (in O.D.)	Weight lbs/ft.	Setting depth	Type cement	Sacks	Type and percent additives
Surface	12-1/4"	8-5/8"	24#	1697	Pozmix Common	500 200	4% Gel 2% CaCl 3% CaCl
Production	7-7/8"	5-1/2"	15.5#	6354	Pozmix	175	.05 CRF-2

LINER RECORD

PERFORATION RECORD

Top, ft.	Bottom, ft.	Sacks cement	Shots per ft.	Size & type	Depth interval
			2		6252-6259'

TUBING RECORD

Size	Setting depth	Packer set at
2-3/8"	6286'	

ACID, FRACTURE, SHOT, CEMENT SQUEEZE RECORD

Amount and kind of material used	Depth interval treated
A/1700 gal 10% NE, F/17,500 gal Versa-Gel + 27,250# 20-40 sand.	6252-6259'

INITIAL PRODUCTION

Date of first production <u>2-25-79</u>		Producing method (flowing, pumping, gas lift, etc.) <u>Pumping</u>			
RATE OF PRODUCTION PER 24 HOURS	Oil <u>12</u> bbls.	Gas <u>0</u> MCF	Water <u>25</u> bbls.	Gas-oil ratio <u>CFPB</u>	
Disposition of gas (vented, used on lease or sold) <u>No Gas</u>			Producing Interval(s) <u>6252-59'</u>		

INSTRUCTIONS: As provided in KCC Rule 82-2-125, within 90 days after completion of a well, one completed copy of this Drillers Log shall be transmitted to the State Geological Survey of Kansas, 4150 Monroe Street, Wichita, Kansas 67209. Copies of this form are available from the Conservation Division, State Corporation Commission, 3830 So. Meridian (P.O. Box 17027), Wichita, Kansas 66217. Phone AC 316-522-2206. If confidential custody is desired, please note Rule 82-2-125. Drillers Logs will be on open file in the Oil and Gas Division, State Geological Survey of Kansas, Lawrence, Kansas 66044.

Operator
Anadarko Production Company

DESIGNATE TYPE OF COMP.: OIL, GAS,
DRY HOLE, SWDW, ETC.:

Well No. 2 Lease Name FINCHAM "D" Oil

S 29 T 33S R 34 ^{EX}
W

WELL LOG

Show all important zones of porosity and contents thereof; cored intervals, and all drill-stem tests, including depth interval tested, cushion used, time tool open, flowing and shut-in pressures, and recoveries.

SHOW GEOLOGICAL MARKERS, LOGS RUN,
OR OTHER DESCRIPTIVE INFORMATION.

FORMATION DESCRIPTION, CONTENTS, ETC.	TOP	BOTTOM	NAME	DEPTH
Sand & Redbed	0'	1698'	Logs: Schlumberger Dual Induction-SFL Comp. Neutron-FD 6354-1698 Rosel Gamma-Ray-CCL 6306-5700	
Redbed & Lime	1698'	2000'		
Redbed, Shale & Lime	2000'	2600'		
Shale & Lime	2600'	6246'		
Shale & Sand	6246'	6274'		
Lime & Shale	6274'	6355'		
Cut Core #1 6246-74', rec 28'.				

USE ADDITIONAL SHEETS, IF NECESSARY, TO COMPLETE WELL RECORD.

Date Received

Paul Campbell
Signature

Paul Campbell, Division Production Manager

Title

March 7, 1979

Date

15-175-20389-0000

ANADARKO PETROLEUM CORPORATION

PHONE 316 - 624 - 6253 1701 NORTH KANSAS AVE. P.O. BOX 351 LIBERAL, KANSAS 67905 - 0351



December 31, 1996

Kansas Corporation Commission
Conservation Division
Finney State Office Building
130 South Market, Rm. 2078
Wichita, Kansas 67202

Attn.: Priscilla Zadoka

Re: Workover Completion (Form ACO-1)

Fincham "D" No. 2
Sec. 29-33S-34W
Seward County, Kansas

RECEIVED
KANSAS CORPORATION COMMISSION
DEC 31 1996

Dear Ms. Zadoka:

Enclosed in triplicate is an affidavit of completion (KCC Form ACO-1) for the workover performed on the referenced well. This previously TA'd well was recompleted to the Lower Morrow (5962'-5988') and the zone was fracture stimulated. Also enclosed is a copy of the original drillers log. Please file accordingly.

If you require additional information, please contact this office at the letterhead address or call me at (316) 629-4306.

Sincerely,

John M. Dolan
Senior Technical Assistant
/sh

Enclosures

cc: Well File
Ken Lester - HGO
Manager Land Administration - HGO
WI Owners