



KANSAS CORPORATION COMMISSION 1093824
OIL & GAS CONSERVATION DIVISION

Form ACO-4
Form must be typed
March 2009

APPLICATION FOR COMMINGLING OF *Commingling ID # CO121208*
PRODUCTION (K.A.R. 82-3-123) OR FLUIDS (K.A.R. 82-3-123a)

OPERATOR: License # 33343
Name: PostRock Midcontinent Production LLC
Address 1: Oklahoma Tower
Address 2: 210 Park Ave, Ste 2750
City: OKLAHOMA CITY State: OK Zip: 73102 +
Contact Person: CLARK EDWARDS
Phone: (620) 432-4200

API No. 15 - 15-205-26419-00-00
Spot Description:
SW NE NE SE Sec. 4 Twp. 29 S. R. 16 East West
2027 Feet from North / South Line of Section
560 Feet from East / West Line of Section
County: Wilson
Lease Name: ESTES REVOCABLE TRUST Well #: 4-1

1. Name and upper and lower limit of each production interval to be commingled:
Formation: SUMMIT (Perfs): 676-679
Formation: MULKY (Perfs): 692-696
Formation: BEVIER (Perfs): 748-750
Formation: CROWEBURG (Perfs): 767-770
Formation: FLEMING (Perfs): 804-806

2. Estimated amount of fluid production to be commingled from each interval:
Formation: SUMMIT BOPD: 0 MCFPD: 5 BWPD: 8
Formation: MULKY BOPD: 0 MCFPD: 5 BWPD: 8
Formation: BEVIER BOPD: 0 MCFPD: 5 BWPD: 8
Formation: CROWEBURG BOPD: 0 MCFPD: 5 BWPD: 8
Formation: FLEMING BOPD: 0 MCFPD: 5 BWPD: 8

3. Plat map showing the location of the subject well, all other wells on the subject lease, and all wells on offsetting leases within a 1/2 mile radius of the subject well, and for each well the names and addresses of the lessee of record or operator.
4. Signed certificate showing service of the application and affidavit of publication as required in K.A.R. 82-3-135a.

For Commingling of PRODUCTION ONLY, include the following:

5. Wireline log of subject well. Previously Filed with ACO-1: Yes No
6. Complete Form ACO-1 (*Well Completion form*) for the subject well.

For Commingling of FLUIDS ONLY, include the following:

7. Well construction diagram of subject well.
8. Any available water chemistry data demonstrating the compatibility of the fluids to be commingled.

AFFIDAVIT: I am the affiant and hereby certify that to the best of my current information, knowledge and personal belief, this request for commingling is true and proper and I have no information or knowledge, which is inconsistent with the information supplied in this application.

Submitted Electronically

KCC Office Use Only	
<input type="checkbox"/> Denied	<input checked="" type="checkbox"/> Approved
15-Day Periods Ends: <u>12/12/2012</u>	
Approved By: <u>Rick Hestermann</u>	Date: <u>12/12/2012</u>

Protests may be filed by any party having a valid interest in the application. Protests must be in writing and comply with K.A.R. 82-3-135b and must be filed within 15 days of publication of the notice of application.

KANSAS CORPORATION COMMISSION
OIL & GAS CONSERVATION DIVISION

ORIGINAL

Form ACO-1
September 1999
Form Must Be Typed

WELL COMPLETION FORM
WELL HISTORY - DESCRIPTION OF WELL & LEASE

Operator: License # 33344
Name: Quest Cherokee, LLC
Address: 211 W. 14th Street
City/State/Zip: Chanute, KS 66720
Purchaser: Bluestem Pipeline, LLC
Operator Contact Person: Gary Laswell
Phone: (620) 431-9500
Contractor: Name: Well Refined Drilling Company
License: 33072

Wellsite Geologist: Ken Recoy
Designate Type of Completion:
 New Well Re-Entry Workover
 Oil SWD SLOW Temp. Abd.
 Gas ENHR SIGW
 Dry Other (Core, WSW, Expl., Cathodic, etc)

If Workover/Re-entry: Old Well Info as follows:

Operator: _____
Well Name: _____
Original Comp. Date: _____ Original Total Depth: _____
 Deepening Re-parf. Conv. to Enhr./SWD
 Plug Back _____ Plug Back Total Depth - _____
 Commingled _____ Docket No. _____
 Dual Completion _____ Docket No. _____
 Other (SWD or Enhr.?) _____ Docket No. _____

<u>4/5/06</u>	<u>4/7/06</u>	<u>4/11/06</u>
Spud Date or Recompletion Date	Date Reached TD	Completion Date or Recompletion Date

API No. 15 - 205-26419-00-00
County: Neosho
_____ ne - se Sec. 4 Twp. 29 S. R. 16 East West
1980 feet from S / N (circle one) Line of Section
660 feet from E / W (circle one) Line of Section

Footages Calculated from Nearest Outside Section Corner:
(circle one) NE SE NW SW
Lease Name: Estes Revocable Trust Well #: 4-1

Field Name: Cherokee Basin CBM
Producing Formation: Multiple
Elevation: Ground: 855 Kelly Bushing: n/a
Total Depth: 1155 Plug Back Total Depth: 1149.56
Amount of Surface Pipe Set and Cemented at 21' 5" Feet
Multiple Stage Cementing Collar Used? Yes No
If yes, show depth set _____ Feet
If Alternate II completion, cement circulated from 1149.56
feet depth to surface w/ 137 sx cmt.

Drilling Fluid Management Plan alt II NR 3/17/08
(Data must be collected from the Reserve Pit)
Chloride content _____ ppm Fluid volume _____ bbls
Dewatering method used _____
Location of fluid disposal if hauled offsite: **RECEIVED**
KANSAS CORPORATION COMMISSION
Operator Name: _____ JUL 27 2006
Lease Name: _____ License No.: _____
Quarter _____ Sec. _____ Twp. _____ S. R. WICHITA, KS East West
County: _____ Docket No.: _____

INSTRUCTIONS: An original and two copies of this form shall be filed with the Kansas Corporation Commission, 130 S. Market - Room 2078, Wichita, Kansas 67202, within 120 days of the spud date, recompletion, workover or conversion of a well. Rule 82-3-130, 82-3-106 and 82-3-107 apply. Information of side two of this form will be held confidential for a period of 12 months if requested in writing and submitted with the form (see rule 82-3-107 for confidentiality in excess of 12 months). One copy of all wireline logs and geologist well report shall be attached with this form. ALL CEMENTING TICKETS MUST BE ATTACHED. Submit CP-4 form with all plugged wells. Submit CP-111 form with all temporarily abandoned wells.

All requirements of the statutes, rules and regulations promulgated to regulate the oil and gas industry have been fully complied with and the statements herein are complete and correct to the best of my knowledge.

Signature: [Signature]
Title: Head of Operations Date: 7/26/06
Subscribed and sworn to before me this 20th day of July,
2006.
Notary Public: Jennifer R. Ammann
Date Commission Expires: July 30, 2009

KCC Office Use ONLY
 Letter of Confidentiality Received
If Denied, Yes Date: _____
 Wireline Log Received
 Geologist Report Received
 UIC Distribution

JENNIFER R. AMMANN
Notary Public - State of Kansas
My Appt. Expires 7-30-09

ORIGINAL

Side Two

Operator Name: Quest Cherokee, LLC

Lease Name: Estes Revocable Trust

Well #: 4-1

Sec. 4 Twp. 29 S. R. 16 East West

County: Neosho

INSTRUCTIONS: Show important tops and base of formations penetrated. Detail all cores. Report all final copies of drill stems tests giving interval tested, time tool open and closed, flowing and shut-in pressures, whether shut-in pressure reached static level, hydrostatic pressures, bottom hole temperature, fluid recovery, and flow rates if gas to surface test, along with final chart(s). Attach extra sheet if more space is needed. Attach copy of all Electric Wireline Logs surveyed. Attach final geological well site report.

Drill Stem Tests Taken Yes No (Attach Additional Sheets)
Samples Sent to Geological Survey Yes No
Cores Taken Yes No
Electric Log Run Yes No (Submit Copy)

Log Formation (Top), Depth and Datum Sample
Name See attached Top Datum

List All E. Logs Run:

Comp. Density Neutron Log
Gamma Ray CCL
Dual Induction Log

CASING RECORD New Used

Report all strings set-conductor, surface, intermediate, production, etc.

Table with 8 columns: Purpose of String, Size Hole Drilled, Size Casing Set (In O.D.), Weight Lbs. / FL, Setting Depth, Type of Cement, # Sacks Used, Type and Percent Additives. Rows include Surface and Production data.

ADDITIONAL CEMENTING / SQUEEZE RECORD

Table with 5 columns: Purpose, Depth Top Bottom, Type of Cement, #Sacks Used, Type and Percent Additives. Includes checkboxes for Perforate, Protect Casing, Plug Back TD, Plug Off Zone.

Table with 4 columns: Shots Per Foot, PERFORATION RECORD - Bridge Plugs Set/Type, Acid, Fracture, Shot, Cement Squeeze Record, Depth. Includes detailed perforation and squeeze data.

TUBING RECORD table with columns for Size, Set At, Packer At, Liner Run, Date of First Resumed Production, Producing Method, and Estimated Production Per 24 Hours.

Disposition of Gas METHOD OF COMPLETION Production Interval
 Vented Sold Used on Lease Open Hole Perf. Dually Comp. Commingled
(If vented, Submit ACO-18.) Other (Specify)

QUEST

Resource Corporation

211 W. 14TH STREET,
CHANUTE, KS 66720
620-431-9500

TICKET NUMBER 1462

FIELD TICKET REF # _____

FOREMAN Dwayne

TREATMENT REPORT & FIELD TICKET CEMENT

DATE	WELL NAME & NUMBER	SECTION	TOWNSHIP	RANGE	COUNTY
4-11-06	Estes Rev. Trust 4-1	4	29S	16 E	WL

FOREMAN / OPERATOR	TIME IN	TIME OUT	LESS LUNCH	TRUCK #	TRAILER #	TRUCK HOURS	EMPLOYEE SIGNATURE
Dwayne	10:45	2:00	NO	901640		3 1/4 hr	<i>[Signature]</i>
Tim	10:45	2:00	NO	903255		3 1/4 hr	<i>[Signature]</i>
Russell	10:45	2:00	NO	903230		3 1/4 hr	<i>[Signature]</i>
David W	10:45	2:00	NO	903139	932452	3 1/4 hr	<i>[Signature]</i>
Jerry H. Moverick	10:45	2:00	NO	903157		3 1/4 hr	<i>[Signature]</i>
	10:45	2:45				4	<i>[Signature]</i>

JOB TYPE Long String HOLE SIZE 6 3/4 HOLE DEPTH 1155 CASING SIZE & WEIGHT 4.5 10.5
 CASING DEPTH 1149.56 DRILL PIPE _____ TUBING _____ OTHER _____
 SLURRY WEIGHT 14.5 SLURRY VOL _____ WATER gal/sk _____ CEMENT LEFT IN CASING 0
 DISPLACEMENT 18.34 DISPLACEMENT PSI _____ MIX PSI _____ RATE 4 BPM

REMARKS:

Wash Down Lost 40' of casing then Pump 2 SK Prem Gel and Sweep to surface. Then Pump 1 SK Prem Gel Followed by 13 BPM Dye and Start Cement. Pump 147 Sacks to get Dye Back. Stop and wash out Pump then Pump wiper Plug to Bottom and set Float Shoe

ACCOUNT CODE	QUANTITY or UNITS	DESCRIPTION OF SERVICES OR PRODUCT	TOTAL AMOUNT
	1149.56	4 1/2 Casing	
	5	4 1/2 Centralizers	
	1	4 1/2 Float Shoe	
931320	4 hr hr	Casing Tractor	
607240	4 hr hr	Casing Trailer	
901640	3 1/4 hr	Foreman Pickup	
901255	3 1/4 hr	Cement Pump Truck	
901230	3 1/4 hr	Bulk Truck	
1104	137 SK	Portland Cement	
1124	2	FRAC Baffles FRAC Baffles 3" 3 1/2"	
1126	1	Wiper Plug 4 1/2 Wiper Plug	
1110	14 SK	Gilsonite	
1107	1.5 SK	Flo-Seal	
1118	2 SK	Premium Gel	
1215A	1 gal	KCL	
1111B	3 SK	Col Chloride Col Chloride	
1123	7000 Gal	City Water	
901139	3 1/4 hr	Transport Truck	
932452	3 1/4 hr	Transport Trailer	
901157	3 1/4 hr	80 Vac	

RECEIVED
KANSAS CORPORATION COMMISSION

JUL 27 2006

CONSERVATION DIVISION
WICHITA, KS



DATE: 4/7/06

Data from Driller's Log

Well Refined Drilling

WELL NAME:	Estes Rev. Trust	SECTION:	4	REPORT #:		SPUD DATE:	4/5/2006
WELL #:	4-1	TWP:	29S	DEPTH:	1155		
FIELD:	Cherokee Basin	RANGE:	16E	PBYD:			
COUNTY:	Wilson	ELEVATION:	855	FOOTAGE:	1980	FT FROM:	South
STATE:	Kansas	API #:	15-205-26419-00-00		660	FT FROM:	East
							NE SE

ACTIVITY DESCRIPTION:

Well Refined Drilling, Randy Cox, drilled to TD 1155 ft. on 4/5/06 and 4/7/06.

GAS SHOWS:	Gas Measured	COMMENTS:
Mulberry Coal	0 mcf/day @ 584-585 FT.	
Lexington Shale and Coal	0 mcf/day @ FT. *	Gas check at 630 ft. No flow
Summit Shale & Coal	0 mcf/day @ 675-678 FT.	
Mulky Shale & Coal	0 mcf/day @ FT. *	GCS. Gas check at 705 ft.
Bevier Coal	0 mcf/day @ 747-748 FT.	
Verdigris Limestone	0 mcf/day @ 764-766 FT.	
Crowebery Coal & Shale	0 mcf/day @ 767-770 FT.	
Fleming Coal	0 mcf/day @ 801-804 FT.	GCS. Gas check at 830 ft.
Weir Coal	0 mcf/day @ 905-907 FT.	
Bartterville Sand - Good oil show	23 mcf/day @ 925-1048 FT.	23 mcf/day from this area. Gas check at 830 ft.
Rowe Coal	23 mcf/day @ FT. *	
Neutral Coal	23 mcf/day @ FT. *	
Riverton Coal	25 mcf/day @ 1053-1054 FT.	2 mcf/day from this area. Gas check at 1055 ft.
Mississippi	28 mcf/day @ Top at 1060 FT.	3 mcf/day from this area. Gas check at 1105 ft.
TD: 1155 ft.	28 mcf/day @	GCS. Gas check at TD 1155 ft.

*Zone not identifiable from Driller's handwritten notes.

Formation Tops and Casing Recommendation made without benefit of viewing open-hole logs first.

Surface Casing @ 21' 5"

Surface Casing Size: 8 5/8"

OTHER COMMENTS:

Information in this report was taken directly from the Driller's hand written notes. All depths and orifice checks reflect what the driller recorded during drilling activities. Below Zones fyi only.

Stray Coal	286-287
Stray Black Shale	380-382
Stray Black Shale	393-395
Pawnee LS / Pink	587-611
Oswego Limestone	657-674
Mineral Coal	821-822

RECEIVED
KANSAS CORPORATION COMMISSION

MAR 12 2008

CONSERVATION DIVISION
WICHITA, KS

CASING RECOMMENDATIONS: Run casing / Cement to surface

On Site Representative: Ken Racey, Senior Geologist, CPG #4630 Thank you! Cell: (620-305-9203) krcopy@quest.net
End of Drilling Report. Thank You!

	A	B	C	D	E	F	G	H	I	J	K
1	Produced Fluids #		1	2	3	4	5		Click here to run SSP Goal Seek SSP		Click
2	Parameters	Units	Input	Input	Input	Input	Input				Click
3	Select the brines	Select fluid by checking the box(es),	<input type="checkbox"/>	<input type="checkbox"/>	<input type="checkbox"/>	<input type="checkbox"/>	<input type="checkbox"/>	Mixed brine: Cell H28 is			Click
4	Sample ID	Row 3	PostRock	PostRock	PostRock	PostRock	PostRock	STP calc. pH. Cells H35-38 are used in mixed brines calculations.			Click
5	Date	3/19/2012	3/4/2012	3/14/2012	1/20/2012	1/20/2012					Click
6	Operator	Ward Feed	Ward Feed	Clinesmith	Clinesmith	Clinesmith					Click
7	Well Name	#34-1	#4-1	#5-4	#1	#2					Click
8	Location	CBM	CBM	Bartles	Bartles	Bartles					Click
9	Field										
10	Na ⁺	(mg/l)*	19,433.00	27,381.00	26,534.00	25,689.00	24,220.00	24,654.20	Initial(BH)	Final(WH)	SUSR (Final-Initial)
11	K ⁺ (if not known =0)	(mg/l)							Saturation Index values		
12	Mg ²⁺	(mg/l)	1,096.00	872.00	1,200.00	953.00	858.00	995.91	Calcite		
13	Ca ²⁺	(mg/l)	1,836.00	2,452.00	2,044.00	1,920.00	1,948.00	2,040.23	-0.73	-0.60	0.13
14	Sr ²⁺	(mg/l)						0.00	Barite		
15	Ba ²⁺	(mg/l)						0.00			
16	Fe ²⁺	(mg/l)	40.00	21.00	18.00	82.00	90.00	50.21	Halite		
17	Zn ²⁺	(mg/l)						0.00	-1.77	-1.80	-0.03
18	Pb ²⁺	(mg/l)						0.00	Gypsum		
19	Cl ⁻	(mg/l)	36,299.00	48,965.00	47,874.00	45,632.00	43,147.00	44,388.44	-3.19	-3.18	0.00
20	SO ₄ ²⁻	(mg/l)	1.00	1.00	8.00	1.00	1.00	2.40	Hemihydrate		
21	F ⁻	(mg/l)						0.00	-3.96	-3.90	0.06
22	Br ⁻	(mg/l)						0.00	Anhydrite		
23	SiO ₂	(mg/l) SiO ₂						0.00	-3.47	-3.36	0.12
24	HCO ₃ Alkalinity**	(mg/l as HCO ₃)	190.00	234.00	259.00	268.00	254.00	241.03	Celestite		
25	CO ₃ Alkalinity	(mg/l as CO ₃)									
26	Carboxylic acids**	(mg/l)						0.00	Iron Sulfide		
27	Ammonia	(mg/L) NH ₃						0.00	-0.16	-0.22	-0.06
28	Borate	(mg/L) H ₃ BO ₃						0.00	Zinc Sulfide		
29	TDS (Measured)	(mg/l)						72781			
30	Calc. Density (STP)	(g/ml)	1.038	1.051	1.050	1.048	1.045	1.047	Calcium Fluoride		
31	CO ₂ Gas Analysis	(%)	19.97	18.76	22.41	35.53	33.79	26.16			
32	H ₂ S Gas Analysis***	(%)	0.0289	0.0292	0.0296	0.0306	0.0151	0.0269	Iron Carbonate		
33	Total H ₂ Saq	(mgH ₂ S/l)	1.00	1.00	1.00	1.00	0.50	0.90	-0.74	-0.51	0.23
34	pH, measured (STP)	pH	5.67	5.76	5.72	5.54	5.55	5.63	Inhibitor needed (mg/L)		
		1-pH+Alk. 2-CO ₂ %+pH							Calcite	NTMP	
35	Choose one option to calculate SI?		0	0	0	0	0				
36	Gas/day(thousand cf/day)	(Mcf/D)						0	0.00	0.00	
37	Oil/Day	(B/D)	0	0	1	1	1	4	Barite	BHPMP	
38	Water/Day	(B/D)	100	100	100	100	100	500	0.00	0.00	
39	For mixed brines, enter values for temperatures and pressures in Cells (H40-H43)							(Enter H40-H43)	pH		
40	Initial T	(F)	66.0	71.0	70.0	41.0	49.0	60.0	5.69	5.60	
41	Final T	(F)	66.0	71.0	70.0	41.0	49.0	89.0	Viscosity (CentiPoise)		
42	Initial P	(psia)	25.0	25.0	25.0	25.0	25.0	25.0	1.196	0.826	
43	Final P	(psia)	25.0	25.0	25.0	25.0	25.0	120.0	Heat Capacity (cal/ml/C)		
44	Use TP on Calcite sheet?	1-Yes;0-No							0.955	0.959	
45	API Oil Grav.	API grav.						30.00	Inhibitor needed (mg/L)		
46	Gas Sp.Grav.	Sp.Grav.						0.60	Gypsum	HDTMP	
47	MeOH/Day	(B/D)	0					0	0.00	0.00	
48	MEG/Day	(B/D)	0					0	Anhydrite	HDTMP	
49	Conc. Multiplier								0.00	0.00	
50	H ⁺ (Strong acid) [†]	(N)									
51	OH ⁻ (Strong base) [†]	(N)									
52	Quality Control Checks at STP:										
53	H ₂ S Gas	(%)									
54	Total H ₂ Saq (STP)	(mgH ₂ S/l)									
55	pH Calculated	(pH)									
56	P _{CO2} Calculated	(%)									
57	Alkalinity Calculated	(mg/l) as HCO ₃									
58	ΣCations=	(equiv/l)									
59	ΣAnions=	(equiv/l)									
60	Calc TDS=	(mg/l)									
61	Inhibitor Selection	Input	Unit	#	Inhibitor	Unit Converter (From metric to English)			Value		
62	Protection Time	120	min	1	NTMP	From Unit	Value	To Unit	Value		
63	Have ScaleSoftPitzer			2	BHPMP	°C	80	°F	176		
64	pick inhibitor for you?	1	1-Yes;0-No	3	PAA	m ³	100	ft ³	3,531		
65	If No, inhibitor # is:	4	#	4	DTPMP	m ³	100	bbl(42 US gal)	629		
66	If you select Mixed,			5	PPCA	MPa	1,000	psia	145,074		
67	1 st inhibitor # is:	1	#	6	SDA	Bar	496	psia	7,194		
68	% of 1 st inhibitor is:	50	%	7	HEDP	Torr	10,000	psia	193		
69	2 nd inhibitor # is:	2	#	8	HDTMP	Gal	10,000	bbl(42 US gal)	238		
70	Display act. coeffs?	0	1-Yes;0-No	9	Average	Liters	10,000	bbl(42 US gal)	63		
71				10	Mixed						

Saturation Index Calculations

Champion Technologies, Inc.
(Based on the Tomson-Oddo Model)

Brine 1: Ward Feed Yard 34-1

Brine 2: Ward Feed Yard 4-1

Brine 3: Clinesmith 5-4

Brine 4: Clinesmith 1

Brine 5: Clinesmith 2

Component (mg/L)	Ratio					
	20% Brine 1	20% Brine 2	20% Brine 3	20% Brine 4	20 Brine 5	Mixed Brine
Calcium	1836	2452	2044	1920	1948	1952
Magnesium	1096	872	1200	953	858	865
Barium	0	0	0	0	0	0
Strontium	0	0	0	0	0	0
Bicarbonate	190	234	259	268	254	253
Sulfate	1	1	8	1	1	1
Chloride	36299	48965	47874	45632	43147	43206
CO ₂ in Brine	246	220	264	422	405	401
Ionic Strength	1.12	1.48	1.46	1.38	1.31	1.31
Temperature (°F)	89	89	89	89	89	89
Pressure (psia)	50	50	120	120	120	119

Saturation Index

Calcite	-1.71	-1.41	-1.48	-1.68	-1.69	-1.69
Gypsum	-3.71	-3.64	-2.82	-3.73	-3.72	-3.69
Hemihydrate	-3.70	-3.65	-2.83	-3.74	-3.71	-3.69
Anhydrite	-3.89	-3.79	-2.97	-3.89	-3.88	-3.85
Barite	N/A	N/A	N/A	N/A	N/A	N/A
Celestite	N/A	N/A	N/A	N/A	N/A	N/A

PTB

Calcite	N/A	N/A	N/A	N/A	N/A	N/A
Gypsum	N/A	N/A	N/A	N/A	N/A	N/A
Hemihydrate	N/A	N/A	N/A	N/A	N/A	N/A
Anhydrite	N/A	N/A	N/A	N/A	N/A	N/A
Barite	N/A	N/A	N/A	N/A	N/A	N/A
Celestite	N/A	N/A	N/A	N/A	N/A	N/A

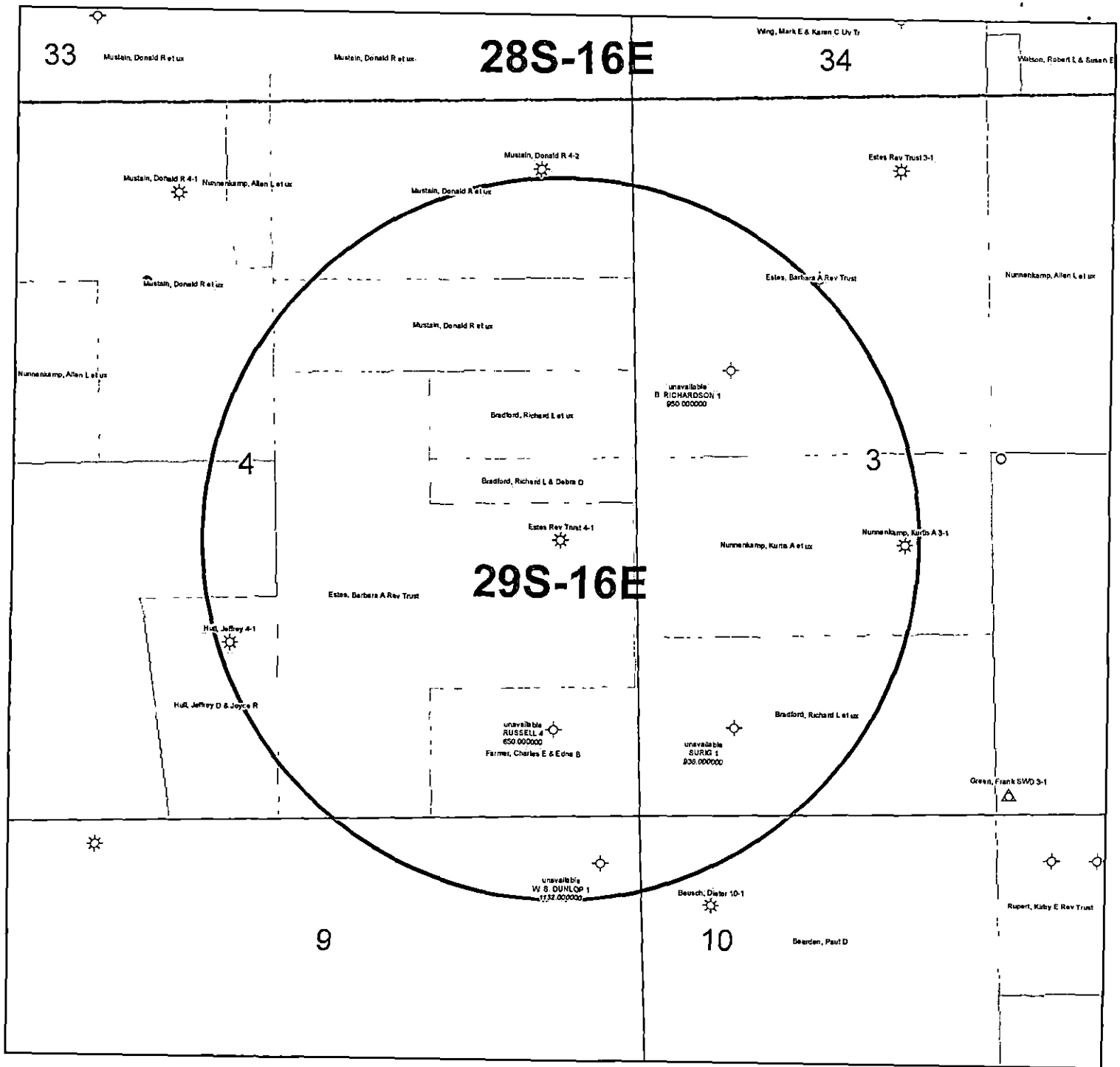

KGS STATUS

◇	DA/PA
⊕	EOR
⊛	GAS
△	INJ/SWD
●	OIL
⊛	OIL/GAS
○	OTHER

Estes Rev Trust 4-1
 4-29S-16E
 1" = 1,000'

POSTROCK



Current Completion

WELL : Estes Rev Trust 4-1
FIELD : Cherokee Basin
STATE : Kansas
COUNTY : Wilson

SPUD DATE : 4/5/2006
COMP. Date : 4/11/2006
API: 15-205-26419-00-00

LOCATION: 4-29S-16E (NE,SE)
ELEVATION: 855'

8 5/8" 20 lb @ 21' Cement w/4 sks

Wellhead/Surface Equipment

Tree Connection	
Tree	
Tubing Head	
Bradenhead	
Pumping Unit	
Compressor	

Tubular Detail

Size	Weight	Grade	Cap(bbl/ft)	Date	Depth
8 5/8"	20 lb			2006	21'
4 1/2"	10.5 lb		.0159	2006	1149'
2 3/8"				2006	1122'

Downhole Equipment Detail

Completion Data

Original as GAS Well per ACO-1
1,000 gals 15% HCL
893 bbls water
18,100 lbs 20/40 sand

Perforations

Original Completion: 4 spt
676-679 Summit (13)
692-696 Mulky (17)
748-750 Bevier (9)
767-770 Croweburg (9)
804-806 Fleming (9)
1080-1082 Riverton (9)

2 3/8" tubing @ 1122'

4.5" 10.5 lb @ 1149' Cement w/137 sks

PBTD @ 1149'

Drilled Depth @ 1155'

PREPARED BY: POSTROCK
APPROVED BY: _____

DATE: Sept, 2012
DATE: _____

POSTROCK



LEGEND

PostRock®

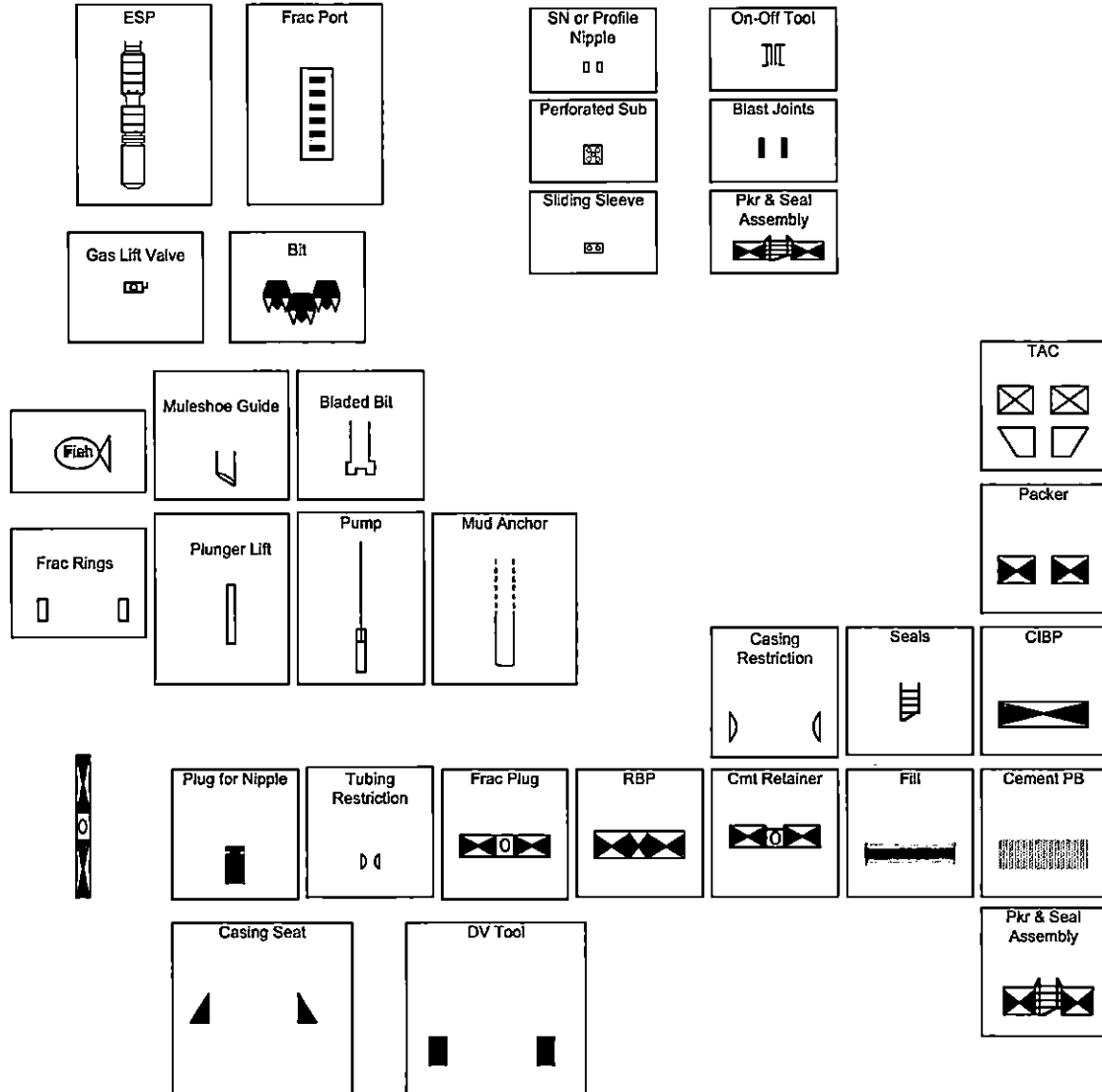

AFFIDAVIT

STATE OF KANSAS \
- SS.
County of Sedgwick /

Mark Fletchall, of lawful age, being first duly sworn, deposeth and saith: That he is Record Clerk of The Wichita Eagle, a daily newspaper published in the City of Wichita, County of Sedgwick, State of Kansas, and having a general paid circulation on a daily basis in said County, which said newspaper has been continuously and uninterruptedly published in said County for more than one year prior to the first publication of the notice hereinafter mentioned, and which said newspaper has been entered as second class mail matter at the United States Post Office in Wichita, Kansas, and which said newspaper is not a trade, religious or fraternal publication and that a notice of a true copy is hereto attached was published in the regular and entire Morning issue of said The Wichita Eagle for 1 issues, that the first publication of said notice was

made as aforesaid on the 1st of

October A.D. 2012, with

subsequent publications being made on the following dates:

And affiant further says that he has personal knowledge of the statements above set forth and that they are true.

Mark Fletchall

Subscribed and sworn to before me this

1st day of October, 2012

PENNY L. CASE
Notary Public - State of Kansas
My Appt. Expires 5/20/2014

Penny L. Case
Notary Public Sedgwick County, Kansas

Printer's Fee : \$139.60

LEGAL PUBLICATION
PUBLISHED IN THE WICHITA EAGLE
OCTOBER 1, 2012 (3209761)
BEFORE THE STATE CORPORATION
COMMISSION
OF THE STATE OF KANSAS
NOTICE OF FILING APPLICATION
RE: In the Matter of Postrock Midcontinent
Production, LLC Application for Commencement
of Production in the Estes Revocable Trust
#1 located in Wilson County, Kansas.
TO: All Oil & Gas Producers, Unleased
Mineral Interest Owners, Landowners, and
all persons whomsoever concerned.
You, and each of you, are hereby notified
that Postrock Midcontinent Production,
LLC has filed an application to commence
the Summit, Mulky, Beaver, Crowberry,
Flamingo, Riverton and Barbetsville production
formations of the Estes Revocable Trust #1,
located in the SW NE SE S4-T9S-R4E,
Approximately 2027 F81 & 500 FEL, Wilson
County, Kansas.
Any persons who object to or protest
this application shall be required to file their
objections or protest with the Conservation
Division of the State Corporation Commission
of the State of Kansas within fifteen (15)
days from the date of this publication. These
protests shall be filed pursuant to Commission
regulations and must state specific reasons
why granting the application may cause
waste, violate Correlative Rights or pollute the
natural resources of the State of Kansas.
All persons interested or concerned shall
take notice of the foregoing and shall govern
themselves accordingly. All persons and/or
companies wishing to protest this application
are required to file a written protest with the
Conservation Division of the Kansas Oil and
Gas Commission.
Upon the receipt of any protest, the
Commission will convene a hearing and
protestants will be expected to enter an
appearance either through proper legal
counsel or as individuals appearing on their
own behalf.
Postrock Midcontinent Production, LLC
210 Park Avenue, Suite 2750
Oklahoma City, Oklahoma 73102
(405) 650-7704
**A COPY OF THE AFFIDAVIT OF
PUBLICATION MUST ACCOMPANY ALL
APPLICATIONS**

PROOF OF PUBLICATION

STATE OF KANSAS
Wilson County - SS

JOSEPH S. and RITA M. RELPH, of lawful age, being duly sworn upon oath that they are the Owners and Publishers of the WILSON COUNTY CITIZEN:

THAT said newspaper has been published at least weekly fifty (50) times a year and has been so published for at least five years prior to the first publication of the attached notice:

THAT said newspaper is a general circulation on a daily, or weekly, or monthly, or yearly basis in;

WILSON COUNTY, KANSAS and is NOT a trade, religious or fraternal publication and has been PRINTED and PUBLISHED in Wilson County, Kansas.

THE ATTACHED was published on the following dates in a regular issue of said newspaper:

1st publication was made on the 1st day of October, 2012

2nd publication was made on the ___ day of ___, 20__

3rd publication was made on the ___ day of ___, 20__

4th publication was made on the ___ day of ___, 20__

5th publication was made on the ___ day of ___, 20__

6th publication was made on the ___ day of ___, 20__

TOTAL PUBLICATION FEE: \$ 39.27

(Signed) Mina & Deborah

Subscribed and sworn to before me, this 16th day of October, 2012

Rita M. Relph (Notary Public)

My commission expires Aug. 30, 2014

(Published in the Wilson County Citizen on Monday, October 1, 2012.)

BEFORE THE STATE CORPORATION COMMISSION OF THE STATE OF KANSAS

NOTICE OF FILING APPLICATION

RE: In the Matter of Postrock Midcontinent Production, LLC Application for Commingling of Production in the Estes Revocable Trust 4-1 located in Wilson County, Kansas.

TO: All Oil & Gas Producers, Unleased Mineral Interest Owners, Landowners, and all persons whomsoever concerned.

You, and each of you, are hereby notified that Postrock Midcontinent Production, LLC has filed an application to commingle the Summit, Mulky, Bevier, Crowburg, Fleming, Riverton and Bartlesville producing formations at the Estes Revocable Trust 4-1, located in the SW, NE NE SE, S4 T29S-R16E, Approximately 2027 FSL & 680 FEET, Wilson County, Kansas.

Any persons who object to or protest this application shall be required to file their objections or protest with the Conservation Division of the State Corporation Commission of the State of Kansas within fifteen (15) days from the date of this publication. These protests shall be filed pursuant to Commission regulations and must state specific reasons why granting the application may cause waste, violate correlative rights or pollute the natural resources of the State of Kansas.

All persons interested or concerned shall take notice of the foregoing and shall govern themselves accordingly. All persons and/or companies wishing to protest this application are required to file a written protest with the Conservation Division of the Kansas Oil and Gas Commission.

Upon the receipt of any protest, the Commission will convene a hearing and protestants will be expected to enter an appearance either through proper legal counsel or as individuals, appearing on their own behalf.

Postrock Midcontinent Production, LLC
210 Park Avenue, Suite 2760,
Oklahoma City, Oklahoma 73102
(405) 680-7704
85 1 cpy

PAID



Rita M. Relph
NOTARY PUBLIC
State of Kansas
My Commission Expires

Affidavit of Notice Served

Re: Application for: APPLICATION FOR COMMINGLING OF PRODUCTION OR FLUIDS ACO-4

Well Name: ESTES REVOCABLE TRUST 4-1 Legal Location: SWNESE S4-T29S-R16E

The undersigned hereby certifies that he / she is a duly authorized agent for the applicant, and that on the day ^{27th}~~26th~~ of NOVEMBER, 2012, a true and correct copy of the application referenced above was delivered or mailed to the following parties:

Note: A copy of this affidavit must be served as a part of the application.

Name

Address (Attach additional sheets if necessary)

SEE ATTACHED

I further attest that notice of the filing of this application was published in the THE WILSON COUNTY CITIZEN, the official county publication of WILSON county. A copy of the affidavit of this publication is attached.

Signed this ^{27th}~~26th~~ day of NOVEMBER, 2012

Jess Morris
Applicant, or Duly Authorized Agent

Subscribed and sworn to before me this 27th day of NOVEMBER, 2012



Jennifer R. Smith
Notary Public
My Commission Expires: July 20, 2016

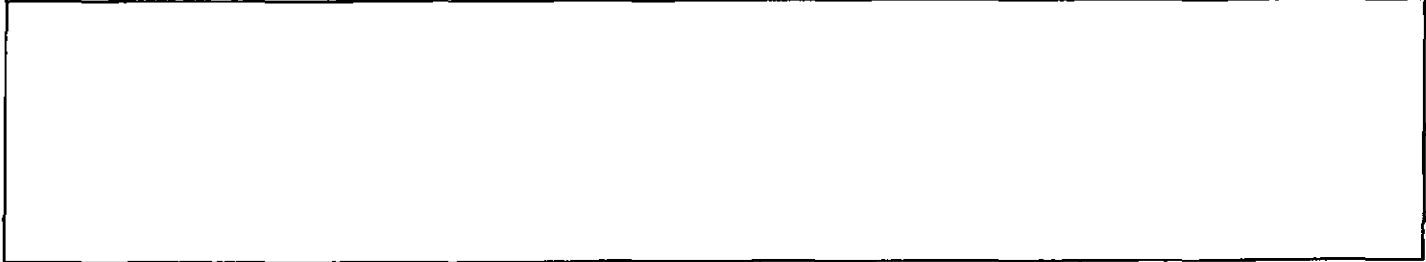

ESTES REV TRUST 4-1

4-29S-16E

NESW

Wilson County Board of Commissioners
615 Madison
Fredonia, KS 66736

9-29S-16E

NE4

Kent Estes
8893 Scott Rd
Altoona, KS 66710

ESTES REV TRUST 4-1-APPLICATION FOR COMMINGLING OF PRODUCTION OR FLUIDS

Offset Operators, Unleased Mineral Owners and Landowners acreage
(Attach additional sheets if necessary)

Name:
SEE ATTACHED

Legal Description of Leasehold:

Multiple horizontal lines for entering names and legal descriptions.

I hereby certify that the statements made herein are true and correct to the best of my knowledge and belief.

Jess Morris
Applicant of Duty Authorized Agent

Subscribed and sworn before me this ~~27th~~ day of NOVEMBER, 2012



Jennifer R. Seal
Notary Public
My Commission Expires: July 20, 2016

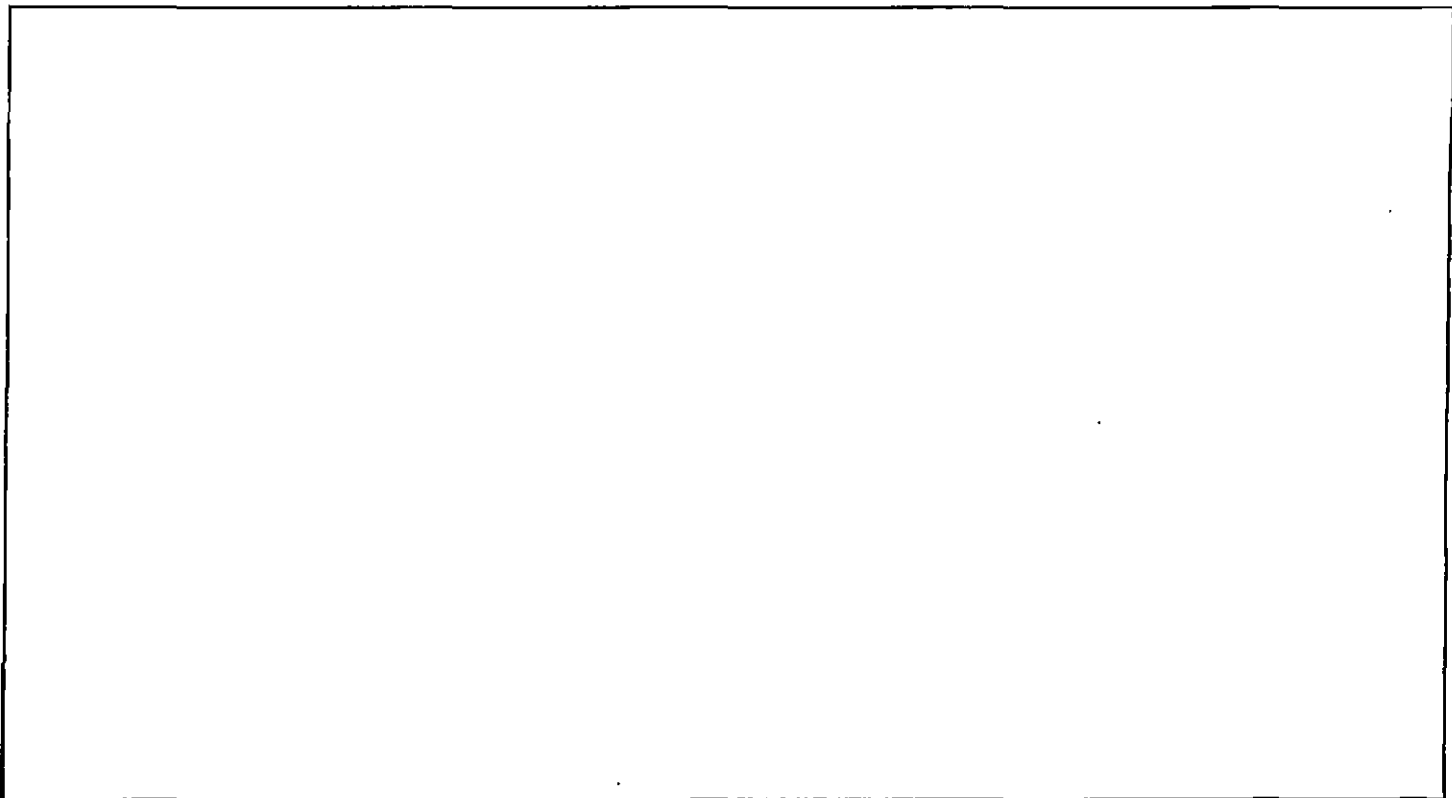

ESTES REV TRUST 4-1

4-29S-16E

NESW Wilson County Board of Commissioners
615 Madison
Fredonia, KS 66736

9-29S-16E

NE4 Kent Estes
8893 Scott Rd
Altoona, KS 66710

Conservation Division
Finney State Office Building
130 S. Market, Rm. 2078
Wichita, KS 67202-3802



Phone: 316-337-6200
Fax: 316-337-6211
<http://kcc.ks.gov/>

Mark Sievers, Chairman
Thomas E. Wright, Commissioner
Shari Feist Albrecht, Commissioner

Sam Brownback, Governor

December 12, 2012

Clark Edwards
PostRock Midcontinent Production LLC
Oklahoma Tower
210 Park Ave, Ste 2750
Oklahoma City, OK 73102

RE: Approved Commingling CO121208
Estes Revocable Trust 4-1, Sec. 4-T29S-R16E, Wilson County
API No. 15-205-26419-00-00

Dear Mr. Edwards:

Your Application for Commingling (ACO-4) for the above described well, received by the KCC on December 10, 2012, has been reviewed and approved by the Kansas Corporation Commission (KCC) per K.A.R. 82-3-123. Notice was examined and found to be proper per K.A.R. 82-3-135a. No protest had been filed within the 15-day protest period.

Based upon the depth of the Riverton formation perforations, total oil production shall not exceed 100 BOPD and total gas production shall not exceed 50% of the absolute open flow (AOF).

File form ACO-1 upon re-completion of the well to commingle.

Commingling ID number CO121208 has been assigned to this approved application. Use this number for well completion reports (ACO-1) and other correspondence that may concern this approved commingling.

Sincerely,

Rick Hestermann
Production Department