

STATE OF KANSAS  
STATE CORPORATION COMMISSION

WELL PLUGGING RECORD

Give All Information Completely  
Make Required Affidavit  
Mail or Deliver Report to  
Conservation Division  
State Corporation Comm.  
245 North Water  
Wichita, KS 67202

Seward County, Sec. 16 Twp. 33S Rge. 34 E/W  
Location as "NE/CNW $\frac{1}{4}$ SW $\frac{1}{4}$ " or footage from lines  
C SW NW

Lease Owner Anadarko Production Company  
Lease Name HITCH "B" Well No. 1  
Office Address P. O. Box 351, Liberal, Kansas 67901  
Character of Well (Completed as Oil, Gas or Dry Hole)  
Oil

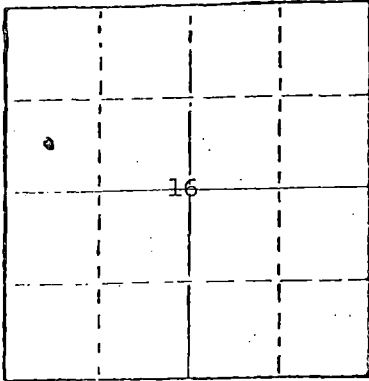

Locate well correctly on above  
Sectional Plat

Date Well completed July 31 19 77  
Application for plugging filed February 23 19 81  
Application for plugging approved April 3 19 81  
Plugging commenced May 20 19 81  
Plugging completed May 22 19 81

Reason for abandonment of well or producing formation  
Uneconomical to produce

If a producing well is abandoned, date of last production  
February 14 19 81

Was permission obtained from the Conservation Division or  
its agents before plugging was commenced? yes

Name of Conservation Agent who supervised plugging of this well Clarence Thomas  
Producing formation Lower Chester Depth to top 6149 Bottom 6191 Total Depth of Well 6378  
Show depth and thickness of all water, oil and gas formations.

OIL, GAS OR WATER RECORDS

CASING RECORD

FORMATION	CONTENT	FROM	TO	SIZE	PUT IN	PULLED OUT
Lower Chester	Oil	6149	6191	8-5/8	1677	-0-
				4-1/2	6377	3407'

Describe in detail the manner in which the well was plugged, indicating where the mud fluid was placed and the method or methods used in introducing it into the hold. If cement or other plugs were used, state the character of same and depth placed, from \_\_\_\_\_ feet to \_\_\_\_\_ feet for each plug set.

- 6290-6191': 20 sxs cmt + 2 sxs hulls, shot off 4-1/2" casing @ 3407.
- 1600': Spot 50 sxs cmt
- 700': Spot 25 sxs cmt.
- 40-3': Spot 10 sxs cmt, surface casing cut off and capped 3' below ground level.

(If additional description is necessary, use BACK of this sheet)

Name of Plugging Contractor Sargents Casing Pulling Service

STATE OF KANSAS COUNTY OF SEWARD, ss.  
Paul Campbell (employee of owner) or ~~XXXXXXXXXXXXXXXXXXXX~~

of the above-described well, being first duly sworn on oath, says: That I have knowledge of the facts, statements, and matters herein contained and the log of the above-described well as filed and that the same are true and correct. So help me God.

(Signature) Paul Campbell  
P. O. Box 351, Liberal, Kansas 67901  
(Address)

SUBSCRIBED AND SWORN TO before me this 4/26 day of June, 1981

Beverly J. Williams  
Notary Public.

My commission expires November 21, 1982

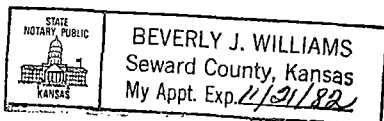

15-175-20322-0000

**KANSAS DRILLERS LOG**

API No. 15 — 175 — 20,322  
 County Number

S.16 T. 33S R. 34 <sup>R</sup> W  
 Loc. SW NW  
 County SEWARD

Operator  
 ANADARKO PRODUCTION COMPANY - DIAMOND SHAMROCK CORP.

Address  
 P. O. BOX 351, LIBERAL, KANSAS 67901

Well No. Lease Name  
 1 HITCH "B"

Footage Location  
 1980 feet from (N) line 660 feet from (E) (W) line

Principal Contractor Geologist  
 Lohmann-Johnson Drlg Co., Inc. Mr. Chuck Severy

Spud Date Total Depth P.B.T.D.  
 7/19/77 10AM 6378' 6290'

Date Completed Oil Purchaser  
 9/9/77 Diamond Shamrock Corp.

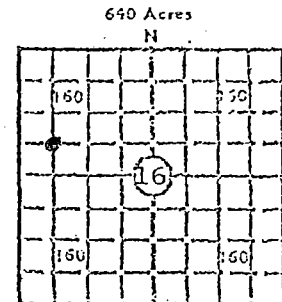

Locate well correctly  
 Elev.: Gr. 2903'  
 DF \_\_\_\_\_ KB \_\_\_\_\_

**CASING RECORD**

Report of all strings set— surface, intermediate, production, etc.

Purpose of string	Size hole drilled	Size casing set (in O.D.)	Weight lbs/ft.	Setting depth	Type cement	Socks	Type and percent additives
Surface	12-1/4"	8-5/8"	24	1677'	Pozmix Common	800	4% gel, 2% CaCl, 3% CaCl
Production	7-7/8"	4-1/2"	10.5	6377'	SS Poz	150	.5% CFR-2 1/4# Tuff Fiber

**LINER RECORD**

**PERFORATION RECORD**

Top, ft.	Bottom, ft.	Socks cement	Shots per ft.	Size & type	Depth interval
			2		6312-18
			2		6183-6191
			2		6149-57

**TUBING RECORD**

**ACID, FRACTURE, SHOT, CEMENT SQUEEZE RECORD**

Amount and kind of material used	Depth interval treated
A/1000 gals Mod 202 + 10BS	6312-18'
A/2000 gals Mod 202 + 14BS	6183-91'
A/2000 gals Mod 202 + 14BS	6149-57'

**INITIAL PRODUCTION**

Date of first production 9/1/77	Producing method (flowing, pumping, gas lift, etc.) Pumping
RATE OF PRODUCTION PER 24 HOURS	Oil 144 bbls. Gas MCF Water bbls. CFPB
Disposition of gas (vented, used on lease or sold)	Producing interval(s) 6149-91' Chester (overall)

MAR 30 1991  
 RECEIVED  
 CONSERVATION DIVISION  
 WICHITA, KANSAS  
 STATE CORPORATION COMMISSION

INSTRUCTIONS: As provided in KCC Rule 82-2-125, within 90 days after completion of a well, one completed copy of this Drillers Log shall be transmitted to the State Geological Survey of Kansas, 4150 Monroe Street, Wichita, Kansas 67209. Copies of this form are available from the Conservation Division, State Corporation Commission, 3830 So. Meridian (P.O. Box 17027), Wichita, Kansas 66217. Phone AC 316-522-2206. If confidential custody is desired, please note Rule 82-2-125. Drillers Logs will be on open file in the Oil and Gas Division, State Geological Survey of Kansas, Lawrence, Kansas 66044.

Operator <b>ANADARKO PRODUCTION COMPANY</b>		DESIGNATE TYPE OF COMP.: OIL, GAS, DRY HOLE, SWDW, ETC.: <b>OIL</b>
Well No. <b>1</b>	Lease Name <b>HITCH "B"</b>	
<b>S 16 T 33S R 34 K W</b>		

**WELL LOG**

Show all important zones of porosity and contents thereof; cored intervals, and all drill-stem tests, including depth interval tested, cushion used, time tool open, flowing and shut-in pressures, and recoveries.

SHOW GEOLOGICAL MARKERS, LOGS RUN, OR OTHER DESCRIPTIVE INFORMATION.

FORMATION DESCRIPTION, CONTENTS, ETC.	TOP	BOTTOM	NAME	DEPTH
Redbed & Sand	0'	1348'		
Gyp, Shale & Andy	1348'	1678'		
Shale	1678'	2433'		
Shale & Lime	2433'	3135'		
Shale, Dolo & Lime	3135'	3334'		
Shale & Dolo	3334'	4639'		
Shale & Lime	4639'	5312'		
Lime	5312'	5400'		
Lime & Shale	5400'	5775'		
Shale	5775'	6126'		
Shale & Sand	6126'	6171'		
Shale	6171'	6235'		
Sandy Lime & Shale	6235'	6354'		
Lime	6354'	6378'		
TOTAL DEPTH		6378'		

DST #1 6149-6171 (Chester) 20MPF w/GTS 15M 20M gas 25 Mcfd, tool open 40M w/gas decrg to 15 Mcfd, rec 3640' GCO, ISIP 1808 (40), PFP 167-267, FP 333-565, FSIP 1808 (120), HP 2959-2860, BH sampler 350, 1200 cc oil, .435 cc gas, API Grav 39.4 60°.

USE ADDITIONAL SHEETS, IF NECESSARY, TO COMPLETE WELL RECORD.

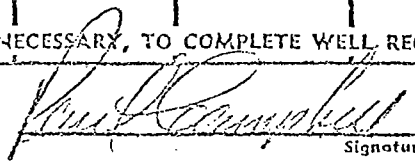
Date Received	 Signature
	Paul Campbell, Division Production Manager Title
	September 30, 1977 Date