

STATE OF KANSAS
STATE CORPORATION COMMISSION

WELL PLUGGING RECORD

Give All Information Completely
Make Required Affidavit
Mail or Deliver Report to
Conservation Division
State Corporation Comm.
245 North Water
Wichita, KS 67202

Seward County. Sec. 22 Twp. 33 Rge. 34 ~~EX~~W
Location as "NE/CNW $\frac{1}{4}$ SW $\frac{1}{4}$ " or footage from lines
C-SW-SE

Lease Owner Anadarko Production Co.
Lease Name Cosgrove A Well No. 4
Office Address Box 351, Liberal, Kansas 67901
Character of Well (Completed as Oil, Gas or Dry Hole) _____
Dry Hole

Date Well completed 4/19 1980
Application for plugging filed 5/16 1980
Application for plugging approved 4/19 - verbal 1980
Plugging commenced 4/19 1980
Plugging completed 4/20 1980

Reason for abandonment of well or producing formation _____
Dry Hole
If a producing well is abandoned, date of last production _____
19 _____

Was permission obtained from the Conservation Division or its agents before plugging was commenced? Yes

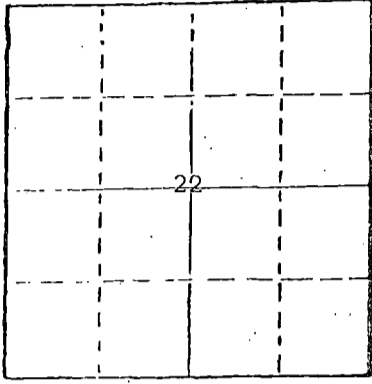

Locate well correctly on above Section Plat

Name of Conservation Agent who supervised plugging of this well William T. Owen
Producing formation _____ Depth to top _____ Bottom _____ Total Depth of Well 16528
Show depth and thickness of all water, oil and gas formations.

OIL, GAS OR WATER RECORDS

CASING RECORD

FORMATION	CONTENT	FROM	TO	SIZE	PUT IN	PULLED OUT
Surface	1693	0	1693	8 5/8	1693'	-0-

Describe in detail the manner in which the well was plugged, indicating where the mud fluid was placed and the method or methods used in introducing it into the hold. If cement or other plugs were used, state the character of same and depth placed, from _____ feet to _____ feet for each plug set. Spotted 50 sxs cmt 5650'-5560', spotted 50 sxs plug @ 1620'-1520', filled hole w/heavy drlg mud, 10 sxs 40'-0', 5 sxs ea RH & MH

(If additional description is necessary, use BACK of this sheet)

Name of Plugging Contractor Lohmann-Johnson,

STATE OF KANSAS COUNTY OF SEWARD, ss.
Paul Campbell (employee of owner) or ~~XXXXXXXXXXXXXXXXXXXX~~

of the above-described well, being first duly sworn on oath, says: That I have knowledge of the facts, statements, and matters herein contained and the log of the above-described well as filed and that the same are true and correct. So help me God.

(Signature) Paul Campbell
P. O. Box 351, Liberal, Kansas 67901
(Address)

SUBSCRIBED AND SWORN TO before me this 20th day of May, 1980

Beverly J. Williams
Notary Public.

My commission expires November 21, 1982

RECEIVED
MAY 21 1980
CONSERVATION DIVISION
Wichita, Kansas

STATE OF KANSAS
BEVERLY J. WILLIAMS
Seward County, Kansas
My Appt. Exp. 11/21/82

15-175-20463-0000

KANSAS

WELL COMPLETION REPORT AND DRILLER'S LOG

API No. 15 — 175 — 20463
County Number

S. 22 T. 33 R. 34 E
W
 Loc. C - SW - SE
 County Seward

Operator
Anadarko Production Co.

Address
Box 351 Liberal, Kansas 67901

Well No. 4 Lease Name Cosgrove A

Footage Location
660 feet from ~~XXX~~ (S) line 1980 feet from (E) ~~XXX~~ line

Principal Contractor Lohmann-Johnson Geologist Joe Blair

Spud Date 4/9/80 Date Completed 4/20/80 Total Depth 6528 P.B.T.D.

Directional Deviation 3/4 deg 6250' Oil and/or Gas Purchaser Dry Hole

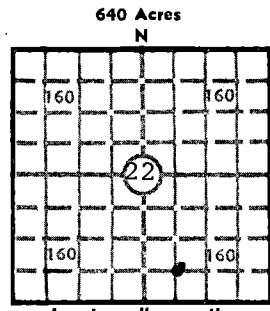

640 Acres
 N
 Locate well correctly
 Elev.: Gr. 2906'
 DF 2907' KB 2917'

CASING RECORD

Report of all strings set — surface, intermediate, production, etc.

Purpose of string	Size hole drilled	Size casing set (in O.D.)	Weight lbs/ft.	Setting depth	Type cement	Sacks	Type and percent additives
Surface	12 1/4"	8 5/8"	24#	1693	Pozmix Common	600 200	4% gel 2% C&C 3% C&C

LINER RECORD

PERFORATION RECORD

Top, ft.	Bottom, ft.	Sacks cement	Shots per ft.	Size & type	Depth interval

TUBING RECORD

Size	Setting depth	Packer set at

ACID, FRACTURE, SHOT, CEMENT SQUEEZE RECORD

Amount and kind of material used	Depth interval treated

INITIAL PRODUCTION

Date of first production <u>Dry Hole</u>	Producing method (flowing, pumping, gas lift, etc.)
RATE OF PRODUCTION PER 24 HOURS	Oil Gas Water Gas-oil ratio bbls. MCF
Disposition of gas (vented, used on lease or sold)	Producing interval (s)

RECEIVED
 STATE CORPORATION COMMISSION
 MAY 1 1980
 CONSERVATION DIVISION
 Wichita, Kansas
 CFPE

INSTRUCTIONS: As provided in KCC Rule 82-2-125, within 90 days after completion of a well, one completed copy of this Drillers Log shall be transmitted to the State Geological Survey of Kansas, 4150 Monroe Street, Wichita, Kansas 67209. Copies of this form are available from the Conservation Division, State Corporation Commission, 245 No. Water, Wichita, Kansas 67202. Phone AC 316-522-2206. If confidential custody is desired, please note Rule 82-2-125. Drillers Logs will be on an open file in the Oil and Gas Division, State Geological Survey of Kansas, Lawrence, Kansas 66044.

Operator

Anadarko Production Company

DESIGNATE TYPE OF COMP.: OIL, GAS, DRY HOLE, SWDW, ETC.:

Well No.

4

Lease Name

COSGROVE "A"

DRY HOLE

S 22 T 33S R 34 ~~X~~ W

WELL LOG

Show all important zones of porosity and contents thereof; cored intervals, and all drill-stem tests, including depth interval tested, cushion used, time tool open, flowing and shut-in pressures, and recoveries.

SHOW GEOLOGICAL MARKERS, LOGS RUN, OR OTHER DESCRIPTIVE INFORMATION.

FORMATION DESCRIPTION, CONTENTS, ETC.	TOP	BOTTOM	NAME	DEPTH
Redbed	0'	1175'	LOGS: Schlumberger Compensated Neutron- Formation Density Dual Induction-SFL	
Anhydrite	1175'	1195'		
Redbed	1195'	1696'		
Lime and Shale	1696'	6520'		
Core #1 6250-83', rec 27'.				

USE ADDITIONAL SHEETS, IF NECESSARY, TO COMPLETE WELL RECORD.

Date Received

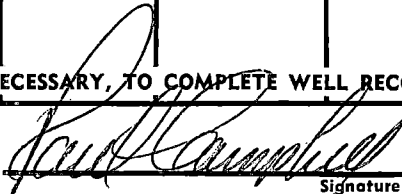

Signature

Paul Campbell, Division Production Manager

Title

May 16, 1980

Date