

WELL PLUGGING RECORD

Give All Information Completely
Make Required Affidavit
Mail or Deliver Report to:
Conservation Division
State Corporation Commission
800 Bittling Building
Wichita, Kansas

Meade County. Sec. 8 Twp. 33 Rge. 33 (E) W (W)

Location as "NE/CNW/SW" or footage from lines center SW/4 of NE/4
Lease Owner Columbian Fuel Corporation
Lease Name Frank Armentrout Well No. "B" #2
Office Address Drawer 31, Liberal, Kansas
Character of Well (completed as Oil, Gas or Dry Hole) Dry hole
Date well completed December 24, 1953
Application for plugging filed December 28, 1953
Application for plugging approved (by phone) December 28, 1953
Plugging commenced December 28, 1953
Plugging completed December 28, 1953
Reason for abandonment of well or producing formation Dry hole

NORTH

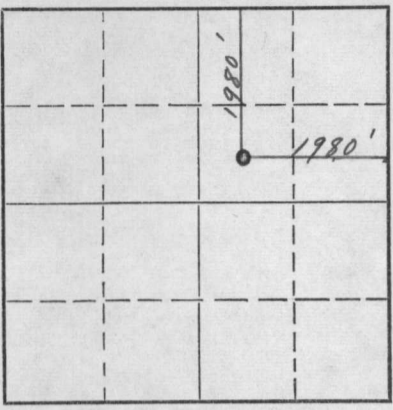

Locate well correctly on above
Section Plat

If a producing well is abandoned, date of last production None 19
Was permission obtained from the Conservation Division or its agents before plugging was commenced? Yes.

Name of Conservation Agent who supervised plugging of this well M. A. Rives
Producing formation None Depth to top Bottom Total Depth of Well 5752 Feet
Show depth and thickness of all water, oil and gas formations.

OIL, GAS OR WATER RECORDS

CASING RECORD

FORMATION	CONTENT	FROM	TO	SIZE	PUT IN	PULLED OUT
				13 3/8"	630'	None
				9 5/8"	2679'	None

Describe in detail the manner in which the well was plugged, indicating where the mud fluid was placed and the method or methods used in introducing it into the hole. If cement or other plugs were used, state the character of same and depth placed, from feet to feet for each plug set.

5752' - 600' -- 9.5#, 40 vis. mud
600' - 524' -- cement (30 sacks)
524' - 40' -- 9.5#, 40 vis. mud
40' - 0' -- cement (20 sacks)

Cement plug displaced through drill pipe from 524' to 600'.

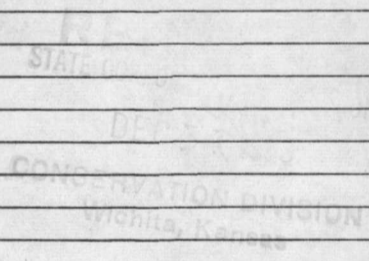

(If additional description is necessary, use BACK of this sheet)

Name of Plugging Contractor done by company (Columbian Fuel Corp.)
Address Drawer 31, Liberal, Kansas

STATE OF Kansas, COUNTY OF Seward, ss.
I, Robert Grady, (employee of owner) of the above-described well, being first duly sworn on oath, says: That I have knowledge of the facts, statements, and matters herein contained and the log of the above-described well as filed and that the same are true and correct. So help me God.

(Signature) Robert Grady
Robert Grady, Superintendent
Drawer 31, Liberal, Kansas
(Address)

SUBSCRIBED AND SWORN TO before me this 30th day of December, 1953

Wallace B. Pedigo
Wallace B. Pedigo Notary Public.

My commission expires June 5, 1955

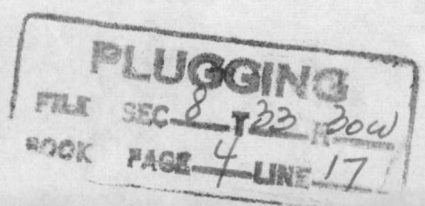

"B"
FRANK ARMENTROUT ^{1/2"} WELL No. 2
SECTION 8 - 33S - 30W.
MEADE COUNTY, KANSAS
COLUMBIAN FUEL CORPORATION

CASING RECORD:

SET 13-3/8" CASING @ 630' w/500 SACKS CEMENT.
SET 9-5/8" CASING @ 2679' w/800 SACKS CEMENT.

COMMENCED: NOVEMBER 27, 1953
COMPLETED: DECEMBER 24, 1953
RESULT: D & A

SAND ROCK	0	580
RED BED	580	650
RED BED, SAND, SHELLS	650	864
SAND, SHELLS, SHALE	864	1361
RED BED, SHELLS, SHALE	1361	1507
SHALE, SHELLS	1507	1721
LIME, SHALE	1721	1730
SHALE, LIME, SHELLS & ANHYDRITE	1730	2000
ANHYDRITE	2000	2261
ANHYDRITE, SHALE	2261	2492
ANHYDRITE	2492	2622
ANHYDRITE, SHALE	2622	2680
LIME	2680	3844
LIME, SHALE	3844	3945
LIME	3945	4050
LIME, SHALE	4050	4522
LIME	4522	4525
LIME, CHERTY	4525	4553
LIME	4553	4644
LIME, CHERTY	4644	4709
LIME, SHALE	4709	4748
LIME	4748	4858
LIME, SHALE	4858	5100
LIME	5100	5108
LIME, SHALE	5108	5150
LIME	5150	5230
SHALE, LIME	5230	5750
TOTAL DEPTH		5750

STATE OF OKLAHOMA)
) ss
COUNTY OF TULSA)

I HEREBY AFFIRM THAT THE ABOVE AND FOREGOING IS A TRUE AND CORRECT COPY OF THE LOG OF THE FRANK ARMENTROUT ^{1/2"} WELL No. 2 LOCATED IN SECTION 8, TOWNSHIP 33 SOUTH, RANGE 30 WEST, MEADE COUNTY, KANSAS. ^B

HELMERICH & PAYNE, INC.

[Signature]
VICE PRESIDENT

SUBSCRIBED AND SWORN TO BEFORE ME A NOTARY PUBLIC THIS 31ST DAY OF DECEMBER, 1953.

[Signature]
NOTARY PUBLIC

MY COMMISSION EXPIRES JULY 22, 1955.

PLUGGING
FILE SEC. 8 33 30W
BOOK PAGE 7 LINE 17

JAN 21 1954
RECORDS & COMM. DIVISION
-Muskogee, Oklahoma

LOG OF WELL

CODE GW 2063 Columbian Fuel Corp SHEET _____
 (COMPANY)
 STATE Kansas DISTRICT 72 COUNTY Meade
 LEASE Frank Armentrout WELL NO. B-2 SEC. 8 TWP. 33 R. 30
 DATE OF LOG 1-19-54 LOCATION IN SEC. 1980' From North & 1980' From East Line
 LOCATION MADE 11-11-53 COMM. RIGGING UP 11-27-53 COMM. DRILLING 11-27-53 COMP. DRILLING 12-24-53
 TOTAL DEPTH 5750' ELEVATION 2728.8' Ground STATE PERMIT NO. _____
 DAY DRILLER Bill Jones NIGHT DRILLER J.W. Gardner CONTRACTOR Helmerich & Payne
 CABLE TOOLS FROM _____ TO _____ ROTARY TOOLS FROM 0 TO 5750'
 OPEN FLOW CAPACITY _____ M. CU. FT. ROCK PRESSURE _____ GASOLINE CONTENT _____ PER M. CU. FT. _____
 DEPTH IN SAND Thru PRODUCING SANDS AND THICKNESS OF EACH Non Productive
 PRODUCTION FIRST 24 HOURS _____ SETTLED PRODUCTION _____ STARTED PRODUCTION _____
 DATE TUBED _____ SYPHON SET _____ SIZE _____ FEET _____

CASING RECORD

SIZE	WEIGHT	PUT IN WELL		PULLED OUT		LEFT IN WELL		SHOES		PACKERS		
		FEET	IN.	FEET	IN.	FEET	IN.	LENGTH	MAKE	KIND	LENGTH	SET AT
13 3/8"	48#	630'				630'						
9 5/8"	36#	2679'				2679'						

LINER: STATE SIZE AND WEIGHT _____ WHERE SET _____ FT. AND INS. BLANK _____ FT. AND INS. PERFORATED _____
 HOW PUT TOGETHER _____ COUPLING _____ FLUSH-JOINT _____ INSERTED _____
 REMARKS _____

EQUIPMENT RECORD

TUBING				SUCKER RODS			PUMPING OUTFIT
SIZE	WEIGHT	FEET	IN.	FEET	IN.	SIZE AND KIND	DESCRIPTION, KIND, SIZE, ETC.

KIND OF SHOT _____ SIZE OF SHOT QUARTS _____ NUMBER OF SHOTS _____
 NUMBER OF SHELLS _____ SIZE OF SHELLS _____ INCHES, DIAMETER _____
 LENGTH OF SHELLS _____ FT. _____ INS. SHOT FURNISHED BY _____ TOP OF SHOT _____
 BOTTOM OF SHOT _____ ANCHOR _____ WELL BRIDGED TO _____
 PRODUCTION BEFORE SHOT _____ PRODUCTION AFTER SHOT _____
 NAME OF SHOOTER _____ SHOT INSPECTED _____ BY _____ (COMPANY EMPLOYEE)
 COMMENCED DRILLING DEEPER _____ COMPLETED DRILLING DEEPER _____
 TOTAL DEPTH _____ PRODUCTION FIRST 24 HOURS _____ SETTLED PRODUCTION _____
 REMARKS: Non Productive. Dry & Abandoned. Plugging Completed 12-28-53.

NOTE: IF WELL WAS DRY, STATE UNDER REMARKS, WHEN, HOW, AND BY WHOM PLUGGED.
 STATE UNDER REMARKS ANYTHING OF INTEREST NOT COVERED IN LOG.
 IF SPACE PROVIDED FOR REMARKS IS NOT SUFFICIENT WRITE ON BOTTOM OF LAST SHEET OF LOG.