

STATE OF KANSAS
STATE CORPORATION COMMISSION

WELL PLUGGING RECORD

Give All Information Completely
Make Required Affidavit
Mail or Deliver Report to:
Conservation Division
State Corporation Commission
800 Biting Building
Wichita, Kansas

Meade County. Sec. 9 Twp. 33 Rge. 30 (X) W (W)
Location as "NE/CNW%SW%" or footage from lines center SW/4 of NE/4
Lease Owner Columbian Fuel Corporation
Lease Name C. E. Leslie Well No. 1
Office Address Drawer 31, Liberal, Kansas
Character of Well (completed as Oil, Gas or Dry Hole) Dry hole
Date well completed November 23, 19 53
Application for plugging filed November 24, 19 53
Application for plugging approved (by phone) November 24, 19 53
Plugging commenced November 24, 19 53
Plugging completed November 25, 19 53
Reason for abandonment of well or producing formation Dry hole.

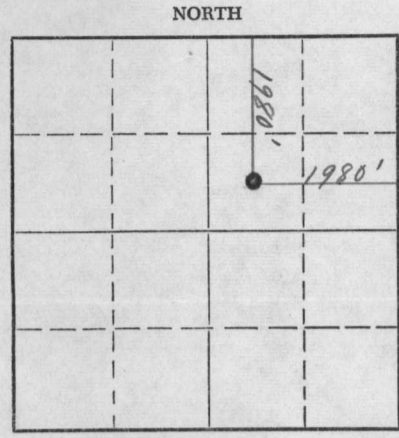

Locate well correctly on above
Section Plat

If a producing well is abandoned, date of last production None 19
Was permission obtained from the Conservation Division or its agents before plugging was commenced? Yes.

Name of Conservation Agent who supervised plugging of this well M. A. Rives
Producing formation J None Depth to top Bottom Total Depth of Well Feet
Show depth and thickness of all water, oil and gas formations.

OIL, GAS OR WATER RECORDS

CASING RECORD

FORMATION	CONTENT	FROM	TO	SIZE	PUT IN	PULLED OUT
				13 3/8"	630.74'	None
					2689'	None

Describe in detail the manner in which the well was plugged, indicating where the mud fluid was placed and the method or methods used in introducing it into the hole. If cement or other plugs were used, state the character of same and depth placed, from feet to feet for each plug set.

6155' to 550' -- 9 1/2# 40 vis. mud
550' to 450' -- Cement plug (35 sacks)
450' to 30' -- 9 1/2# 40 vis. mud
30' to 0' -- Cement plug (15 sacks)

(If additional description is necessary, use BACK of this sheet)
Name of Plugging Contractor done by company (Columbian Fuel Corp.)
Address P.O. Drawer 31, Liberal, Kansas

STATE OF Kansas, COUNTY OF Seward, ss.
I, Robert Grady (employee of owner) ~~or owner or operator~~ of the above-described well, being first duly sworn on oath, says: That I have knowledge of the facts, statements, and matters herein contained and the log of the above-described well as filed and that the same are true and correct. So help me God.
(Signature) Robert Grady
Robert Grady, Superintendent
Drawer 31, Liberal, Kansas
(Address)

SUBSCRIBED AND SWORN TO before me this 28th day of November, 19 53
Wallace B. Pedigo
Wallace B. Pedigo Notary Public.

My commission expires June 5, 1955

PLUGGING
FILE SEC 9 T 33 R 30W
BOOK PAGE 145 LINE 15

24-7368-S 3-53-20M

STATE CORPORATION COMMISSION
NOV 30 1953
CONSERVATION DIVISION
Wichita, Kansas

DRILLER'S LOG

OPERATOR: Columbia Fuel Corporation

ELEVATION:

CONTRACTOR: Midwestern Drillers
227 Wright Building
Tulsa 3, Oklahoma

WELL COMMENCED: Oct. 9, 1953

WELL COMPLETED: Nov. 24, 1953

LEASE NAME: C. E. Leslie #1

TOTAL DEPTH: 6147'

Location: Sec. 9-T33S-R30W
Meade County, Kansas

CASING RECORD: Set 13-3/8" @ 631' and cemented with 500 sacks cement
Set 8-5/8" @ 2689' and cemented with 800 sacks cement

FORMATION

DEPTH FROM ROTARY BUSHING

FORMATION	DEPTH FROM ROTARY BUSHING
Clay & Sand	0
Red Bed	65
Red Bed & Sypsum	605
Red Bed, Shells	1080 Ran 631' of 13-3/8"
Sypsum & Shale	1855
Shale & Anhydrite	2310
Lime	2400
Shale & Shells	2405
Shale & Anhydrite	2530
Lime	2615
Lime 2689	2670
Lime & Shale	2689 Ran 2689' of 8-5/8"
Lime & Shale	2740
Lime & Shale	3130
Lime & Shale	3485
Lime & Shale	3700
Lime & Shale	3950
Lime	4000
Shale & Lime	4165
Lime	4173
Shale, Lime	4440
Lime	4575
Lime & Shale	4865
Lime	4900
Lime & Shale	5240
Lime	5290
Lime & Shale	5445
Lime	5465 Schlumberger
Lime & Shale coring	5668
Lime & Shale coring	5703
Lime & Shale coring	5744
Lime & Shale coring	5733
Lime & Shale coring	5768
Lime	5867
Lime coring	6093
Lime coring	6105 DST
Lime coring	6144
Lime coring	6155 Schlumberger
	6147 TD

I hereby certify that the above is a true and correct copy of Driller's Log of the C. E. Leslie #1 Well.

Subscribed and sworn to before me this 31st day of Dec, 1953.

MIDWESTERN DRILLERS

J. W. Wyatt
Notary Public

by G. A. Dow
STATE DRILLER

My Commission Expires August 12, 1956.

PLUGGING
FILE SEC 9 T 33 R 30W
BOOK 143 LINE 15

CONSERVED

LOG OF WELL

CODE GW 2054 Columbian Fuel Corp SHEET _____
(COMPANY)
 STATE Kansas DISTRICT 72 COUNTY Meade
 LEASE C.E. ~~MM~~ Leslie WELL NO. 1 SEC. 9 TWP. 33 R. 30
 DATE OF LOG 1-4-54 LOCATION IN SEC. 1980' From North & 1980' From East Line
 LOCATION MADE 9-9-53 COMM. RIGGING UP 10-9-53 COMM. DRILLING 10-9-53 COMP. DRILLING 11-24-53
 TOTAL DEPTH 6147' ELEVATION 2740.1' Ground STATE PERMIT NO. _____
 DAY DRILLER James Stewart NIGHT DRILLER Paul Jones CONTRACTOR Midwestern Drillers
 CABLE TOOLS FROM _____ TO _____ ROTARY TOOLS FROM 0 TO 6147'
 OPEN FLOW CAPACITY _____ M. CU. FT. ROCK PRESSURE _____ GASOLINE CONTENT _____
PER M. CU. FT.
 DEPTH IN SAND Thru PRODUCING SANDS AND THICKNESS OF EACH None
 PRODUCTION FIRST 24 HOURS None SETTLED PRODUCTION None STARTED PRODUCTION _____
 DATE TUBED _____ SYPHON SET _____ SIZE _____ FEET _____

CASING RECORD

SIZE	WEIGHT	PUT IN WELL		PULLED OUT		LEFT IN WELL		SHOES		PACKERS		
		FEET	IN.	FEET	IN.	FEET	IN.	LENGTH	MAKE	KIND	LENGTH	SET AT
13 3/8"	48#	631'				631'						
8 5/8"	24#	2689'				2689'						

LINER: STATE SIZE AND WEIGHT _____ WHERE SET _____ FT. AND INS. _____
BLANK FT. AND INS. _____
 HOW PUT TOGETHER _____ COUPLING _____ FLUSH-JOINT _____ INSERTED _____
 REMARKS _____

EQUIPMENT RECORD

TUBING				SUCKER RODS			PUMPING OUTFIT
SIZE	WEIGHT	FEET	IN.	FEET	IN.	SIZE AND KIND	DESCRIPTION, KIND, SIZE, ETC.

KIND OF SHOT _____ SIZE OF SHOT QUARTS _____ NUMBER OF SHOTS _____
 NUMBER OF SHELLS _____ SIZE OF SHELLS _____ INCHES, DIAMETER _____
 LENGTH OF SHELLS _____ FT. _____ INS. SHOT FURNISHED BY _____ TOP OF SHOT _____
 BOTTOM OF SHOT _____ ANCHOR _____ WELL BRIDGED TO _____
 PRODUCTION BEFORE SHOT _____ PRODUCTION AFTER SHOT _____
 NAME OF SHOOTER _____ SHOT INSPECTED _____ BY _____
(COMPANY EMPLOYEE)
 COMMENCED DRILLING DEEPER _____ COMPLETED DRILLING DEEPER _____
 TOTAL DEPTH _____ PRODUCTION FIRST 24 HOURS _____ SETTLED PRODUCTION _____

REMARKS: No 5 1/2" O.D. Casing Set. Plugging Completed 11-25-53.
Well Non Productive...Dry & Abandoned.

NOTE: IF WELL WAS DRY, STATE UNDER REMARKS, WHEN, HOW, AND BY WHOM PLUGGED.
 STATE UNDER REMARKS ANYTHING OF INTEREST NOT COVERED IN LOG.
 IF SPACE PROVIDED FOR REMARKS IS NOT SUFFICIENT WRITE ON BOTTOM OF LAST SHEET OF LOG.