

15-119-00159-0000

STATE OF KANSAS
STATE CORPORATION COMMISSION

Give All Information Completely
Make Required Affidavit
Mail or Deliver Report to:
Conservation Division
State Corporation Commission
800 Bitting Building
Wichita, Kansas

WELL PLUGGING RECORD

Corporation File #127-29

Meade County, Sec. 10 Twp. 33 Rge. 30 (W)

Location as "NE/CNW/SW" or footage from lines Center NE SW

Lease Owner Columbian Fuel Corporation

Lease Name H. A. Holmes Well No. 1

Office Address P.O. Box 994, Liberal, Kansas

Character of Well (completed as Oil, Gas or Dry Hole) Dry hole.

Date well completed September 5, 1953

Application for plugging filed September 5, 1953

Application for plugging approved by telephone September 5, 1953

Plugging commenced September 6, 1953

Plugging completed September 6, 1953

Reason for abandonment of well or producing formation Dry hole

If a producing well is abandoned, date of last production None 19

Was permission obtained from the Conservation Division or its agents before plugging was commenced? Yes.

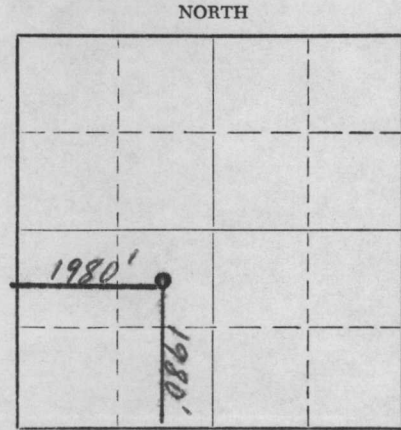

Locate well correctly on above Section Plat

Name of Conservation Agent who supervised plugging of this well M. A. Rives

Producing formation None Depth to top Bottom Total Depth of Well 6165 Feet

Show depth and thickness of all water, oil and gas formations.

OIL, GAS OR WATER RECORDS

CASING RECORD

FORMATION	CONTENT	FROM	TO	SIZE	PUT IN	PULLED OUT
<u>None</u>				<u>13 3/8</u>	<u>641.28'</u>	<u>None</u>
				<u>9 5/8</u>	<u>2689.47'</u>	<u>None</u>

Describe in detail the manner in which the well was plugged, indicating where the mud fluid was placed and the method or methods used in introducing it into the hole. If cement or other plugs were used, state the character of same and depth placed, from feet to feet for each plug set.

9 1/2 lb. Drilling mud from 6165' to 2700'
Cement plug -- 35 sacks 2700' to 2630'
9 1/2 lb. Drilling mud from 2630' to 630'
Cement plug -- 15 sacks 630' to 600'
9 1/2 lb. Drilling mud from 600' to 25'
Cement plug -- 8 sacks 25' to 0'

Casing cut off 30" below ground level.

(If additional description is necessary, use BACK of this sheet)

Name of Plugging Contractor Plugged by company

Address Columbian Fuel Corp., Liberal, Kansas

STATE OF Kansas, COUNTY OF Seward, ss.

Robert Grady (employee of owner) or ~~(owner)~~ of the above-described well, being first duly sworn on oath, says: That I have knowledge of the facts, statements, and matters herein contained and the log of the above-described well as filed and that the same are true and correct. So help me God.

(Signature) Robert Grady
Robert Grady, Supt.
P.O. Box 994, Liberal, Kansas
(Address)

SUBSCRIBED AND SWORN to before me this 10th day of September, 1953

My commission expires June 4, 1955

Wallace B. Pedigo
Wallace B. Pedigo Notary Public.

24-2675-S 2-52-20M

PLUGGING
FILE SEC 10 T 33 R 30W
BOOK PAGE 127 LINE 29

SEP 11 1953
STATE CORPORATION COMMISSION
CONSERVATION DIVISION
WICHITA, KANSAS

LOG OF WELL

CODE GW 2048 Columbian Fuel Corp SHEET _____
 (COMPANY)
 STATE Kansas DISTRICT 72 COUNTY Meade
 LEASE H.A. Holmes WELL NO. 1 SEC. 10 TWP. 33 R. 30
 DATE OF LOG 10-3-53 LOCATION IN SEC. 1980' From West & 1980' From South Lines.
 LOCATION MADE 7-7-53 COMM. RIGGING UP 7-24-53 COMM. DRILLING 7-24-53 COMP. DRILLING 9-6-53
 TOTAL DEPTH 6165' ELEVATION 2723.5' Ground STATE PERMIT NO. _____
 DAY DRILLER Stewart NIGHT DRILLER Paul Jones CONTRACTOR Midwestern Drillers
 CABLE TOOLS FROM _____ TO _____ ROTARY TOOLS FROM 0 TO 6165'
 OPEN FLOW CAPACITY _____ M. CU. FT. ROCK PRESSURE _____ GASOLINE CONTENT _____ PER M. CU. FT. _____
 DEPTH IN SAND Thru PRODUCING SANDS AND THICKNESS OF EACH None
 PRODUCTION FIRST 24 HOURS _____ SETTLED PRODUCTION _____ STARTED PRODUCTION _____
 DATE TUBED _____ SYPHON SET _____ SIZE _____ FEET _____

CASING RECORD

SIZE	WEIGHT	PUT IN WELL		PULLED OUT		LEFT IN WELL		SHOES		PACKERS		
		FEET	IN.	FEET	IN.	FEET	IN.	LENGTH	MAKE	KIND	LENGTH	SET AT
13 3/8"	48#	641.28'				641.28'						
9 5/8"	36#	2689.47'				2689.47'						

LINER: STATE SIZE AND WEIGHT _____ WHERE SET _____ FT. AND INS. BLANK _____ FT. AND INS. PERFORATED _____
 HOW PUT TOGETHER _____ COUPLING _____ FLUSH-JOINT _____ INSERTED _____
 REMARKS _____

EQUIPMENT RECORD

TUBING				SUCKER RODS			PUMPING OUTFIT
SIZE	WEIGHT	FEET	IN.	FEET	IN.	SIZE AND KIND	DESCRIPTION, KIND, SIZE, ETC.

KIND OF SHOT _____ SIZE OF SHOT QUARTS _____ NUMBER OF SHOTS _____
 NUMBER OF SHELLS _____ SIZE OF SHELLS _____ INCHES. DIAMETER _____
 LENGTH OF SHELLS _____ FT. _____ INS. SHOT FURNISHED BY _____ TOP OF SHOT _____
 BOTTOM OF SHOT _____ ANCHOR _____ WELL BRIDGED TO _____
 PRODUCTION BEFORE SHOT _____ PRODUCTION AFTER SHOT _____
 NAME OF SHOOTER _____ SHOT INSPECTED _____ BY _____ (COMPANY EMPLOYEE)
 COMMENCED DRILLING DEEPER _____ COMPLETED DRILLING DEEPER _____
 TOTAL DEPTH _____ PRODUCTION FIRST 24 HOURS _____ SETTLED PRODUCTION _____

REMARKS: Not Productive . No 5 1/2" O.D. Casing Set. Dry & Abandoned. Plugging
Completed Sept 6, 1953

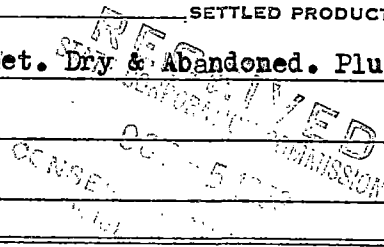

DRILLER'S LOG

OPERATOR: Columbian Fuel Corporation

ELEVATION:

CONTRACTOR: Midwestern Drillers
221 Wright Building
Tulsa, Oklahoma

WELL COMMENCED: July 20, 1953

WELL COMPLETED: Sept. 6, 1953

LEASE NAME: H. A. Holmes #1

TOTAL DEPTH: 6165' RB

LOCATION: NE $\frac{1}{4}$, SW $\frac{1}{4}$, Sec. 10, T33S,
R30W, Meade County, Kansas

CASING RECORD: Surface - Set 630' of 13-3/8" with 500 sacks cement.
Intermediate - Set 2690' of 9-5/8" with 800 sacks cement.
Production - Dry and abandoned. Set cement plug 2700' - 35 sacks cement.

FORMATION

DEPTH FROM ROTARY BUSHING

	0	
Sand and Clay	310	
Blue Clay and Sand	550	
Sandy Clay	580	
Red Bed	676	Ran 630' of 13-3/8" casing
Red Bed	1005	
Sand, Red Bed, Gypsum	1545	
Shale	2175	
Anhydrite and Shale	2360	
Lime and Shale	2430	
Anhydrite and Shale	2542	
Lime and Shale and some Chert	2600	
Chert and Lime	2693	Ran Electric Log
Lime and Shale	2846	Ran 2690' of 9-5/8" casing
Lime and Shale	3190	DST #1
Lime and Shale	3495	DST #2
Lime and Shale	3668	
Lime and Shale	3895	
Lime and Shale	4240	
Lime	4575	
Lime	4774	DST #3
Shale	5006	DST #4
Lime	5078	DST #5
Lime	5120	
Lime	5277	
Lime	5305	
Lime and Shale	5355	
Lime and Shale	5540	
Lime and Shale	5665	
Lime and Shale	5775	DST #6
Shale and Lime	5966	DST #7
Shale and Lime	6065	
Shale and Lime	6115	DST #8
Shale and Lime	6165	Ran Electric Log
Shale and Lime	6165	TD

I hereby certify that the above is a true and correct copy of Driller's Log of the H. A. Holmes #1 Well.

Subscribed and sworn to before me this 28th day of Sept, 1953.

MIDWESTERN DRILLERS

by Glen A. Saw

J. W. Bryant
Notary Public

My Commission Expires: 8-12, 1956

PLUGGING
PRY SEC 10 T 33 R 30 W
BOOK PAGE 127 LINE 22

RECEIVED
MIDWESTERN DRILLERS
TULSA, OKLAHOMA

15-119-00159-0000

COLUMBIAN FUEL CORPORATION

P. O. BOX 994

LIBERAL, KANSAS

Order No. **5374**

This number must appear on all invoices or correspondence.

September 15, 1953

TO State Corporation Commission
800 Bitting Building
Wichita, Kansas

Please enter our order for the following goods in accordance with specifications, prices and conditions shown below:

Quantity	Description	Price
----------	-------------	-------

PLUGGING:

Holmes #1

CNE SW 10-33-30W

Meade County

File No. 127-29

\$ 25.00

Confirms statement, dated 9-9-53

Req. No. 2510

SHIP TO Columbian Fuel Corporation, Liberal, Kansas

BY _____ Date Shipment Required Received 9-9-53

All materials must conform to above description or specification and be the best of their respective kinds and subject to this Company's inspection and acceptance at destination; if rejected they will be held subject to your order and risk and returnable at your expense. All invoices must show terms, how shipped and whether transportation charges are prepaid or collect. Original shipping documents must accompany invoice.

This order is placed on the express condition and understanding that the price hereunder involves no discrimination in favor of or against this Company in violation of the provisions of the Robinson-Patman Act.

Invoices must be rendered in duplicate.

Required for G.W. 2018-20-6J-178

COLUMBIAN FUEL CORPORATION

By W. M. Greenwell,
General Superintendent

PLUGGING
 FILE SEC 10 T-33 R-304
 BOOK PAGE 127 LINE 29

STATE CORPORATION COMMISSION
 SEP 18 1953
 REGISTRATION DIVISION
 Liberal, Kansas