

STATE CORPORATION COMMISSION OF KANSAS
OIL & GAS CONSERVATION DIVISION
WELL COMPLETION OR RECOMPLETION FORM
ACO-1 WELL HISTORY
DESCRIPTION OF WELL AND LEASE

S

API NO. 15-175-21044-2000

County...Seward

...G-SW/4 NE/4 Sec 6... Twp. 33S Rge. 33... East
X West

3300 Ft North from Southeast Corner of Section
1980 Ft West from Southeast Corner of Section
(Note: Locate well in section plat below)

Lease Name...Cooper H Well # 1

Field Name...Evalyn Condit

Producing Formation...(Dry)

Elevation: Ground...2850' KB...2861'

Operator: License # 5447
Name...OXY USA Inc
Address...P.O. Box 26100
Oklahoma City, OK 73126-0100
City/State/Zip

Purchaser...None (Dry Hole)

Operator Contact Person...Raymond Hui
Phone... (405) 749-2471

Contractor: License #
Name...H-30 Drilling Company

Wellsite Geologist...Robert Vicks
Phone... (405) 749-2000

Designate Type of Completion
X New Well Re-Entry Workover
Oil SWD Temp Abd
Gas Inj Delayed Comp.
X Dry Other (Core, Water Supply etc.)

If OWN: old well info as follows:
Operator
Well Name
Comp. Date Old Total Depth

WELL HISTORY

Drilling Method:
X Mud Rotary Air Rotary Cable
9-23-1988 9-30-1988 10-2-1988
Spud Date Date Reached TD Completion Date
6400 PBT
Total Depth

Amount of Surface Pipe Set and Cemented at 1624' feet
Multiple Stage Cementing Collar Used? Yes X No
If yes, show depth set...feet
If alternate 2 completion, cement circulated
from...feet depth to...w/...SX cmt
Cement Company Name
Invoice #
D-I D+D

RECEIVED
STATE CORPORATION COMMISSION
NOV 14 1988
CONSERVATION DIVISION
Wichita, Kansas

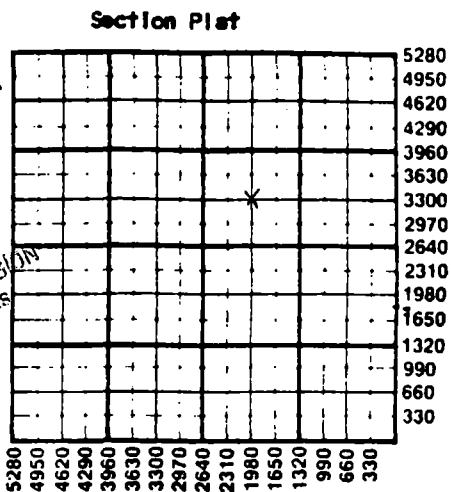

WATER SUPPLY INFORMATION

Disposition of Produced Water: Disposal
Docket # Repressuring

Questions on this portion of the ACO-1 call:
Water Resources Board (913) 296-3717

Source of Water:
Division of Water Resources Permit # T88-477

X Groundwater 3375 Ft North from Southeast Corner
(Well) 2110 Ft West from Southeast Corner of
Sec 6 Twp 33S Rge 33 East X West

Surface Water...Ft North from Southeast Corner
(Stream, pond etc)...Ft West from Southeast Corner
Sec Twp Rge East West

Other (explain)
(purchased from city, R.W.D. #)

INSTRUCTIONS: This form shall be completed in triplicate and filed with the Kansas Corporation Commission, 200 Colorado Derby Building, Wichita, Kansas 67202, within 120 days of the spud date of any well. Rule 82-3-130, 82-3-107 and 82-3-106 apply. Information on side two of this form will be held confidential for a period of 12 months if requested in writing and submitted with the form. See rule 82-3-107 for confidentiality in excess of 12 months. One copy of all wireline logs and drillers time log shall be attached with this form. Submit CP-4 form with all plugged wells. Submit CP-111 form with all temporarily abandoned wells.

All requirements of the statutes, rules and regulations promulgated to regulate the oil and gas industry have been fully complied with and the statements herein are complete and correct to the best of my knowledge.

Signature...Bryan Humphries
Title...Engineering Manager Date 11-8-1988

Subscribed and sworn to before me this 8th day of November 1988
Notary Public...Marsha P. Wilson

Date Commission Expires...4-1-92

K.C.C. OFFICE USE ONLY
F Letter of Confidentiality Attached
C Wireline Log Received
C Drillers Time Log Received
Distribution
KCC SWD/Rep NGPA
KGS Plug Other
(Specify)
11-14-88 X10

Sec. 6 Twp. 33S Rge. 33E

SIDE TWO

Operator Name OXY USA Inc Lease Name Cooper H Well # 1

Sec. 6 Twp. 33S Rge. 33 East West County Seward

WELL LOG

INSTRUCTIONS: Show important tops and base of formations penetrated. Detail all cores. Report all drill stem tests giving interval tested, time tool open and closed, flowing and shut-in pressures, whether shut-in pressure reached static level, hydrostatic pressures, bottom hole temperature, fluid recovery, and flow rates if gas to surface during test. Attach extra sheet if more space is needed. Attach copy of log.

Drill Stem Tests Taken Yes No
 Samples Sent to Geological Survey Yes No
 Cores Taken Yes No

Formation Description
 Log Sample

Ran Dual Induction - SFL w/SP & GR Log, Compensated Neutron/Litho. w/GR & Caliper log, Micro w/GR & Caliper & BHC Acoustic log w/GR.

Name	Top	Bottom
Red Bed	0	1525
Lime & Shale	1525	1750
Shale	1750	3180
Lime & Shale	3180	4170
Lime	4170	5430
Lime & Shale	5430	6400
TD		6400

CASING RECORD New Used
 Report all strings set-conductor, surface, intermediate, production, etc.

Purpose of String	Size Hole Drilled	Size Casing Set (In O.D.)	Weight Lbs/Ft.	Setting Depth	Type of Cement	#Sacks Used	Type and Percent Additives
Conductor Pipe	30"	20"		37'	Redi-Mix	5 yds	
Surface	12-1/4"	8-5/8"	24#	1624'	Cl C	650	6% total gel, 2% CaCl ² 1#/sx Flo.

PERFORATION RECORD

Acid, Fracture, Shot, Cement Squeeze Record (Amount and Kind of Material Used) Depth

Shots Per Foot	Specify Footage of Each Interval Perforated	Depth
	Not perforated (Dry Hole)	

TUBING RECORD Size ___ Set At ___ Packer at ___ Liner Run Yes No

Date of First Production _____ Producing Method Flowing Pumping Gas Lift Other (explain).....

Estimated Production Per 24 Hours	Oil Bbls	Gas MCF	Water Bbls	Gas-Oil Ratio	Gravity
	--	--	--	CFPB	

METHOD OF COMPLETION

Production Interval

Disposition of gas: Vented Open Hole Perforation
 Sold Other (Specify) Dry Hole
 Used on Lease Dually Completed
 Commingled