

STATE OF KANSAS
STATE CORPORATION COMMISSION

WELL PLUGGING RECORD

Give All Information Completely
Make Required Affidavit
Mail or Deliver Report to:
Conservation Division
State Corporation Commission
800 Bittling Building
Wichita, Kansas

NORTH

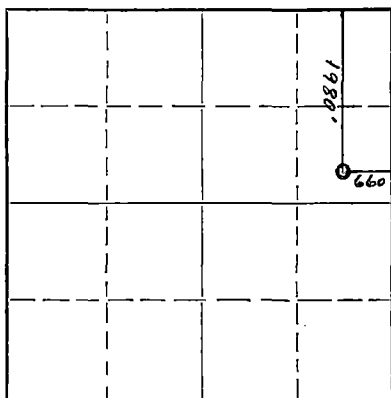

Locate well correctly on above
Section Plat

Meade County. Sec. 16 Twp. 33 Rge. 30 E. W. (W)
Location as "NE/CNW 1/4 SW 1/4" or footage from lines center SE 1/4 of NE 1/4
Lease Owner Columbian Fuel Corporation
Lease Name Frank Armentrout Well No. A-3
Office Address Drawer 31, Liberal, Kansas
Character of Well (completed as Oil, Gas or Dry Hole) Dry hole
Date well completed May 5, 1954
Application for plugging filed May 5, 1954
Application for plugging approved (by phone) May 5, 1954
Plugging commenced May 5, 1954
Plugging completed May 5, 1954
Reason for abandonment of well or producing formation Dry hole

If a producing well is abandoned, date of last production 19
Was permission obtained from the Conservation Division or its agents before plugging was commenced? Yes

Name of Conservation Agent who supervised plugging of this well M. A. Rives
Producing formation None Depth to top Bottom Total Depth of Well 5866 Feet
Show depth and thickness of all water, oil and gas formations.

OIL, GAS OR WATER RECORDS

CASING RECORD

Formation	Content	From	To	Size	Put In	Pulled Out
				13 3/8"	623'	None
				9 5/8"	2675'	None

Describe in detail the manner in which the well was plugged, indicating where the mud fluid was placed and the method or methods used in introducing it into the hole. If cement or other plugs were used, state the character of same and depth placed, from feet to feet for each plug set.

5866' to 550' -- Filled with 9.5#, 66 viscosity mud
550' to 461' -- Cement plug (35 sacks cement.)
461' to 38' -- Filled with 9.5#, 66 viscosity mud
38' to 0' -- Cement plug (15 sacks cement.)

(If additional description is necessary, use BACK of this sheet)

Name of Plugging Contractor done by company (Columbian Fuel Corp.)
Address Drawer 31, Liberal, Kansas

STATE OF Kansas, COUNTY OF Seward, ss.
I, Robert Grady, (employee of owner) or (conservationist) of the above-described well,

being first duly sworn on oath, says: That I have knowledge of the facts, statements, and matters herein contained and the log of the above-described well as filed and that the same are true and correct. So help me God.

(Signature) Robert Grady
Robert Grady, Superintendent
Drawer 31, Liberal, Kansas
(Address)

SUBSCRIBED AND SWORN to before me this 6th day of May, 1954

My commission expires June 4, 1955

Wallace B. Pedigo
Wallace B. Pedigo, Notary Public.
STATE CORPORATION COMMISSION

23-8390-s 6-51-20M

PLUGGING
FILE SEC 16 T 33 R 30W
BOOK PAGE 32 LINE 23

MAY 7 - 1954
CONSERVATION DIVISION
Wichita, Kansas

FRANK ARMENTROUT "A" No. 3
 C SE NE SECTION 16-33S-30W
 MEADE COUNTY, KANSAS
COLUMBIAN FUEL CORPORATION

CASING RECORD:

SET 13-3/8" CSG. @ 630' w/500 SXS. CEMENT
 SET 9-5/8" CSG. @ 2675' w/800 SXS. CEMENT

COMMENCED: 4/2/54
 COMPLETED: 5/5/54
 RESULT: D & A

SAND, SHELLS	0	100
SAND ROCK	100	465
SURFACE CLAY & SAND	465	580
RED BED	580	630
RED BED, SAND & SHELLS	630	912
SAND, SHELLS & SHALE	912	1127
SAND & SHALE	1127	1495
LIME, SHELLS, SALT, SHALE	1495	1800
LIME, SHALE, ANHYDRITE	1800	1978
SHALE, ANHYDRITE	1978	2387
ANHYDRITE	2387	2553
ANHYDRITE, SHALE	2553	2675
LIME	2675	3721
LIME, SHALE	3721	3807
LIME	3807	3820
LIME, SHALE	3820	3927
LIME	3927	4000
LIME, SHALE	4000	4035
SHALE	4035	4094
LIMEY SHALE	4094	4165
LIME	4165	4413
SHALE	4413	4416
LIME, SHALE	4416	4520
LIME	4520	4669
LIME, SHALE	4669	4674
LIME	4674	4706
LIME, SHALE	4706	4747
LIME	4747	4763
LIME CHERTY	4763	4769
LIME	4769	4820
LIME, SHALE	4820	4833
LIME	4833	4915
LIME, SHALE	4915	5100
LIME	5100	5261
SHALE, LIME	5261	5402
LIME	5402	5451
LIME, SHALE	5451	5826
LIME	5826	5853
LIME, SHALE	5853	5860
<u>TOTAL DEPTH</u>		5860

RECEIVED
 STATE CORPORATION COMMISSION
 MAY 22 1954
 OIL & GAS DIVISION
 OF THE STATE OF KANSAS

STATE OF OKLAHOMA)
) ss
 COUNTY OF TULSA)

I HEREBY AFFIRM THAT THE ABOVE AND FOREGOING IS A TRUE AND CORRECT COPY OF THE LOG OF THE FRANK ARMENTROUT "A" No. 3 WELL, LOCATED IN THE CENTER OF THE SOUTHEAST QUARTER OF THE NORTH-EAST QUARTER OF SECTION 16, TOWNSHIP 33 SOUTH, RANGE 30 WEST, MEADE COUNTY, KANSAS.

HELMERICH & PAYNE, INC.

[Signature]

 VICE PRESIDENT

SUBSCRIBED AND SWORN TO BEFORE ME A NOTARY PUBLIC THIS 13TH DAY OF MAY, 1954.

[Signature]

 NOTARY PUBLIC

MY COMMISSION EXPIRES JULY 22, 1955.

PLUGGING
 FILE SEC 16 T 33 R 30W
 BOOK PAGE 32 LINE 23

15-119-10035-0000

LOG OF WELL

CODE GW 2067 Columbian Fuel Corp SHEET _____
(COMPANY)

STATE Kansas DISTRICT 72 COUNTY Meade

LEASE Frank Armentrout WELL NO. A-3 SEC. 16 TWP. 33 R. 30

DATE OF LOG May 18, 1954 LOCATION IN SEC. 1980' From North & 660' From East Line

LOCATION MADE 3-31-54 COMM. RIGGING UP 4-2-54 COMM. DRILLING 4-2-54 COMP. DRILLING 5-5-54

TOTAL DEPTH 5860' ELEVATION 2727.6' Ground STATE PERMIT NO. _____

DAY DRILLER Bill Jones NIGHT DRILLER J.W. Gardiner CONTRACTOR Helmerich & Payne Inc.

CABLE TOOLS FROM _____ TO _____ ROTARY TOOLS FROM 0 TO 5860'

OPEN FLOW CAPACITY _____ M. CU. FT. ROCK PRESSURE _____ GASOLINE CONTENT PER M. CU. FT. _____

DEPTH IN SAND _____ PRODUCING SANDS AND THICKNESS OF EACH None

PRODUCTION FIRST 24 HOURS _____ SETTLED PRODUCTION _____ STARTED PRODUCTION _____

DATE TUBED _____ SYPHON SET _____ SIZE _____ FEET _____

CASING RECORD

SIZE	WEIGHT	PUT IN WELL		PULLED OUT		LEFT IN WELL		SHOES		PACKERS		
		FEET	IN.	FEET	IN.	FEET	IN.	LENGTH	MAKE	KIND	LENGTH	SET AT
13 3/8"	48#	624.25'				624.25'						
9 5/8"	36#	2675'				2675'						

LINER: STATE SIZE AND WEIGHT _____ WHERE SET _____ FT. AND INS. BLANK _____ FT. AND INS. PERFORATED _____

HOW PUT TOGETHER _____ COUPLING _____ FLUSH-JOINT _____ INSERTED _____

REMARKS _____

EQUIPMENT RECORD

TUBING				SUCKER RODS			PUMPING OUTFIT
SIZE	WEIGHT	FEET	IN.	FEET	IN.	SIZE AND KIND	DESCRIPTION, KIND, SIZE, ETC.

KIND OF SHOT _____ SIZE OF SHOT QUARTS _____ NUMBER OF SHOTS _____

NUMBER OF SHELLS _____ SIZE OF SHELLS _____ INCHES, DIAMETER _____

LENGTH OF SHELLS _____ FT. _____ INS. SHOT FURNISHED BY _____ TOP OF SHOT _____

BOTTOM OF SHOT _____ ANCHOR _____ WELL BRIDGED TO _____

PRODUCTION BEFORE SHOT _____ PRODUCTION AFTER SHOT _____

NAME OF SHOOTER _____ SHOT INSPECTED _____ BY _____ (COMPANY EMPLOYEE)

COMMENCED DRILLING DEEPER _____ COMPLETED DRILLING DEEPER _____

TOTAL DEPTH _____ PRODUCTION FIRST 24 HOURS _____ SETTLED PRODUCTION _____

REMARKS: Dry Hole. Plugging Completed May 5, 1954

RECEIVED
STATE CORPORATION COMMISSION
MAY 22 1954
CONSERVATION DIVISION
WELL BRIDGED TO _____

NOTE: IF WELL WAS DRY, STATE UNDER REMARKS, WHEN, HOW, AND BY WHOM PLUGGED. STATE UNDER REMARKS ANYTHING OF INTEREST NOT COVERED IN LOG. IF SPACE PROVIDED FOR REMARKS IS NOT SUFFICIENT WRITE ON BOTTOM OF LAST SHEET OF LOG.