

ORIGINAL

SIDE ONE

CONFIDENTIAL

RELEASED

STATE CORPORATION COMMISSION OF KANSAS
OIL & GAS CONSERVATION DIVISION
WELL COMPLETION FORM
ACO-1 WELL HISTORY
DESCRIPTION OF WELL AND LEASE

API NO. 15- 175-21150-0000

County Seward ✓ FFR n 6 002

N/2 NE Sec. 26 Twp. 33 Rge. 32 East West

4950' ✓ Ft. North from Southeast Corner of Section

1320' ✓ Ft. West from Southeast Corner of Section
(NOTE: Locate well in section plat below.)

Lease Name Leshinsky ✓ Well # 1-26

Field Name Unknown

Producing Formation Morrow

Elevation: Ground 2566' KB 2577'

Total Depth 6200' PBDT 5782'

Operator: License # 04782

Name: Ensign Operating Co.

Address 621 17th St., Suite 1800

Denver, Colorado 80293

City/State/Zip

Purchaser: Panhandle

Operator Contact Person: J. C. Simmons

Phone (303) 293-9999

Contractor: Name: Cheyenne Drilling, #4

License:

Wellsite Geologist: Duane E. Moredock

Designate Type of Completion

New Well Re-Entry Workover

Oil SWD Temp. Abd.

Gas Inj Delayed Comp.

Dry Other (Core, Water Supply, etc.)

If OWMO: old well info as follows:

Operator:

Well Name:

Comp. Date Old Total Depth

Drilling Method:

Mud Rotary Air Rotary Cable

9/24/90 10/5/90 10/28/90
Spud Date Date Reached TD Completion Date

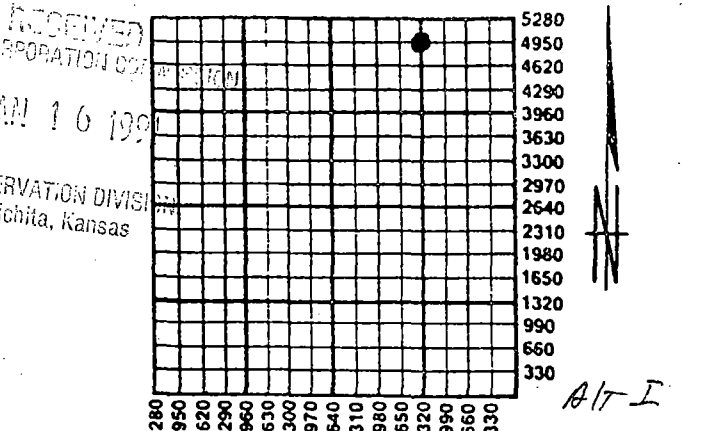

Amount of Surface Pipe Set and Cemented at 1458' Feet:

Multiple Stage Cementing Collar Used? Yes No

If yes, show depth set Feet

If Alternate II completion, cement circulated from

feet depth to w/ sx cmt.

INSTRUCTIONS: This form shall be completed in triplicate and filed with the Kansas Corporation Commission, 200 Colorado Derby Building, Wichita, Kansas 67202, within 120 days of the spud date of any well. Rule 82-3-130, 82-3-107 and 82-3-106 apply. Information on side two of this form will be held confidential for a period of 12 months if requested in writing and submitted with the form. See rule 82-3-107 for confidentiality in excess of 12 months. One copy of all wireline logs and drillers time log shall be attached with this form. ALL CEMENTING TICKETS MUST BE ATTACHED. Submit CP-1 form with all plugged wells. Submit CP-111 form with all temporarily abandoned wells. Any recompletion, workover or conversion of a well requires filing of ACO-2 within 120 days from commencement date of such work.

All requirements of the statutes, rules and regulations promulgated to regulate the oil and gas industry have been fully complied with and the statements herein are complete and correct to the best of my knowledge.

Signature: Ann Smith

Title: Sr. Engineering Tech. Date 1/9/91

Subscribed and sworn to before me this 9 day of January

19 91 Stiers
Notary Public

Date Commission Expires October 21, 1991

K.C.C. OFFICE USE ONLY

F Letter of Confidentiality Attached

C Wireline Log Received

C Drillers Timelog Received

Distribution

KCC SWD/Rep NGPA

KGS Plug Other

(Specify)

CONFIDENTIAL

SIDE TWO

Operator Name Ensign Operating Co Lease Name Leshinsky Well # 1-26
Sec. 26 Twp. 33 Rge. 32 East West
County Seward

INSTRUCTIONS: Show important tops and base of formations penetrated. Detail all cores. Report all drill stem tests giving interval tested, time tool open and closed, flowing and shut-in pressures, whether shut-in pressure reached static level, hydrostatic pressures, bottom hole temperature, fluid recovery, and flow rates if gas to surface during test. Attach extra sheet if more space is needed. Attach copy of log.

Drill Stem Tests Taken Yes No
 (Attach Additional Sheets.)

Samples Sent to Geological Survey Yes No

Cores Taken Yes No

Electric Log Run Yes No
 (Submit Copy.)

See Attached

Formation Description

Log Sample

Name Top Bottom

See Attached

CASING RECORD New Used
 Report all strings set-conductor, surface, intermediate, production, etc.

Purpose of String	Size Hole Drilled	Size Casing Set (In O.D.)	Weight Lbs./Ft.	Setting Depth	Type of Cement	# Sacks Used	Type and Percent Additives
Surface	12-1/4	8-5/8	24	1458'	Howco Lite	535	2% CaCl ₂ , 1/4#/sx Flocele
					Premium +	150	Same as above
Production	7-7/8	4-1/2	10.5	6203'	Premium	425	3% KCl, 0.7% Halad 322 + 0.25% CBL

PERFORATION RECORD

Shots Per Foot	Specify Footage of Each Interval Perforated	Acid, Fracture, Shot, Cement Squeeze Record (Amount and Kind of Material Used)	Depth
8 Sqz Holes	5788-5790	750 Gals 7% Fe-HCl	5618-5680'
1	5642-43; 5645-48; 5652		
2	5666-74	44,000 Gals 70% Quality Nitrogen F + 65,000# 20/40 Mesh Sand	5618-5680'
		EZ-SV Cmt Retainer	5782'
		375 sx Premium, 3% KCl, .7% Halad 322 + .25% CBL	

TUBING RECORD

Size	Set At	Packer At	Liner Run
2-3/8	5630		<input type="checkbox"/> Yes <input checked="" type="checkbox"/> No

Date of First Production SI-WOPL 10/30/90 Test Producing Method Flowing Pumping Gas Lift Other (Explain)

Estimated Production Per 24 Hours	Oil Bbls.	Gas Mcf	Water Bbls.	Gas-Oil Ratio	Gravity
		1120			

Disposition of Gas: Vented Sold Used on Lease (If vented, submit ACO-18.)

METHOD OF COMPLETION: Open Hole Perforation Dually Completed Commingled Other (Specify) _____

Production Interval _____

TRILOBITE TESTING COMPANY

ORIGINAL

P.O. Box 362 • Hays, Kansas 67601

RELEASED

CONFIDENTIAL

Drill-Stem Test Data

FROM CONFIDENTIAL

Well Name & No.	LESHINSKY #1-26	Test No.	1	Date	10/3/90
Company	ENSIGN OPERATING COMPANY	Zone Tested	MORROW		
Address	621 17th ST #1800 DENVER CO 80293	Elevation	2577 KB		
Co. Rep./Geo.	ED LoCRICCHIO	Cont.	CHEYENNE RIG #4	Est. Ft. of Pay	20
Location: Sec.	26	Twp.	33S	Rge.	32W
Co.	SEWARD	State	KANSAS		

Interval Tested	5618-5680	Drill Pipe Size	4.5" XH
Anchor Length	62	Top Choke — 1"	Bottom Choke — 3/4"
Top Packer Depth	5613	Hole Size — 7 7/8"	Rubber Size — 6 3/4"
Bottom Packer Depth	5618	Wt. Pipe I.D. — 2.7 Ft. Run	0
Total Depth	5680	Drill Collar — 2.25 Ft. Run	534
Mud Wt.	9.0 lb/gal.	Viscosity	55
		Filtrate	6.8
Tool Open @	4:20 PM	Initial Blow	OFF BOTTOM IN 1 MINUTE - GAS TO SURFACE IN 20 MINUTES ON SHUTIN
Final Blow	MCF/D 8.74-OFF BOTTOM IN 1 MINUTE		

Recovery — Total Feet	85	Flush Tool?	
Rec.	5533	Feet of	GAS IN PIPE
Rec.	85	Feet of	GASSY MUD-10%GAS/90%MUD
Rec.	0	Feet of	
Rec.	0	Feet of	
Rec.	0	Feet of	
BHT	126	°F Gravity	°API @ 0 °F Corrected Gravity 0 °API
RW	@	°F Chlorides	ppm Recovery Chlorides 800 ppm System
(A) Initial Hydrostatic Mud	2638.2	PSI	Ak1 Recorder No. 13308 Range 4700
(B) First Initial Flow Pressure	68.1	PSI	@ (depth) 5620 w/Clock No. 27573
(C) First Final Flow Pressure	68.1	PSI	Ak1 Recorder No. 10248 Range 4400
(D) Initial Shut-in Pressure	75.3	PSI	@ (depth) 5676 w/Clock No. 17638
(E) Second Initial Flow Pressure	58.4	PSI	Ak1 Recorder No. 0 Range 0
(F) Second Final Flow Pressure	58.4	PSI	@ (depth) 0 w/Clock No. 0
(G) Final Shut-in Pressure	1457.5	PSI	Initial Opening 30
(H) Final Hydrostatic Mud	2534.1	PSI	Initial Shut-in 60
			Final Flow 60
			Final Shut-in 120

STATE OF KANSAS
 CONSERVATION DIVISION
 WICHITA, KANSAS
 OCT 10 1991

MR MARK HERSKOWITZ

1150

Our Representative _____

TOTAL PRICE \$ _____

ORIGINAL

RELEASED

CONFIDENTIAL

FORMATION TOPS NO. 1-26 LESHINSKY

G.L. 2566'
K.B. 2577'

Comparison Well No. 2-22 Arkalon & Samples K.B. 2649'
Drill Time
Bore Hole Geophysical Logs

FROM CONFIDENTIAL

	Surface +2637	Surface +2966'	Surface +2966'
Tertiary			
Permian	NL		
Guadalupian			
Day Creek	NL		
Whitehorse	NL		
Leonardian			
Nippewalla Gr.			
Blaine	NL	670' +1907'	675' +1902'
Cedar Hill	NL	850' +1727'	850' +1727'
Salt Plain	NL	960' +1617'	960' +1617'
Sumner Gr.			
Stone Corral	NL	1346' +1231'	1343' +1234'
Ninnescah	1470' +1179'	1419' +1158'	1418' +1159'
Wellington	1925' +724'	1881' +696'	1873' +704'
Wolfcampian			
Chase Gr.			
Herington	2449' +200'	2398' +179'	2412' +165'
Krider	2516' +133'	2470' +107'	2478' +99'
Winfield	2580' +69'	2539' +38'	2546' +31'
Towanda	2650' -1'	2612' -35'	2609' -32'
Fort Riley	2703' -54'	2670' -93'	2672' -95'
Wreford	2817' -168'	2786' -209'	2784' -207'
Council Grove Gr.	2924' -275'	2899' -322'	2892' -315'
Admire Gr.	3431' -782'	3354' -777'	
Pennsylvanian			
Virgilian			
Wabaunsee Gr.	3583' -934'	3520' -943'	3520' -943'
Douglas Gr.			
Heebner	4178' -1529'	4141' -1564'	4142' -1565'
Toronto	4198' -1549'	4168' -1591'	4168' -1591'
Missourian			
Lansing Gr.	4334' -1685'	4297' -1718'	4289' -1712'
Kansas City Gr.	4594' -1945'	4575' -1998'	4578' -2001'
Desmoinesian			
Marmaton Gr.	4990' -2341'	4961' -2384'	4970' -2213'
Cherokee Gr.	5184' -2535'	5156' -2579'	5158' -2581'
Atokian	5376' -2727'	5342' -2765'	5346' -2769'
Morrowian	5522' -2873'	5494' -2917'	5502' -2925'
Lower Sandstone	5640' -2991'	5662' -3085'	5663' -3086'
Chester*	5664' -3015'	5672' -3095'	5675' -3096'
Mississippian			
Meramecian			
Ste. Genevieve	6032' -3383'	5989' -3412'	5994' -3417'
Total Depth	6208' -3559'	6200' -3623'	6203' -3626'

STATE CORPORATION COMMISSION
JAN 16 1991
CONSERVATION DIVISION

APT 151752130

26 33 32W

1-8-92

DRILLERS LOG
RELEASED

KCC

OCT. 11 1990

ENSIGN OPERATING COMPANY
LESHINSKY #1-26
SECTION 26-T33S-R32W
SEWARD COUNTY, KANSAS

FEB 6 1992

FROM CONFIDENTIAL

COMMENCED: 09-24-90
COMPLETED: 10-07-90

SURFACE CASING: 1452' OF 8 5/8"
CMTD W/535 SX PREM LITE, 2% C.C.,
1/4#/SX FLO-CELE; TAILED IN W/150
SX "C", 2% C.C., 1/4#/SX FLO-CELE

FORMATION

DEPTH

FORMATION	DEPTH
CONDUCTOR CASING	0- 52
SURFACE HOLE	52-1463
ANHYDRITE & SHALE	1463-1625
RED BED & SHALE	1625-2125
SHALE	2125-2760
LIME & SHALE	2760-3460
LIME	3460-3655
DOLOMITE	3655-3870
LIME & SHALE	3870-4535
LIME	4535-4968
LIME & SHALE	4968-5090
LIME	5090-5420
LIME & SHALE	5420-5680
LIME	5680-5965
LOWER MISSISSIPPIAN	5965-6069
LIME & SHALE	6069-6165
LIME	6165-6200 RTD

I DO HEREBY CERTIFY THAT THE FOREGOING STATEMENTS ARE TRUE AND CORRECT TO THE BEST OF MY KNOWLEDGE AND BELIEF.

CHEYENNE DRILLING, INC.

A. J. JACQUES

STATE OF KANSAS :ss:

SUBSCRIBED AND SWORN TO BEFORE ME THIS 9TH DAY OF OCTOBER, 1990.

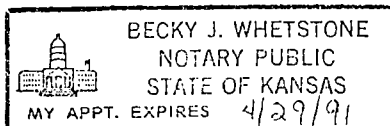

Becky J Whetstone

OCT 11 1990

BECKY J. WHETSTONE, NOTARY PUBLIC

ORIGINAL

P.O. BOX 951046
DALLAS, TX 75395-1046

CONFIDENTIAL

HALLIBURTON SERVICES

ORIGINAL

INVOICE

A Halliburton Company

RECEIVED
NOV 16 1990

INVOICE NO. 014340
DATE 10/19/1990

WELL LEASE NO./PLANT NAME WELL/PLANT LOCATION STATE WELL/PLANT OWNER

LESHINSKY 1-26

SEWARD

ENSIGN OIL & GAS INC

SERVICE LOCATION

CONTRACTOR

JOB PURPOSE

TICKET DATE

LIBERAL

PATRICK WELL SERVICE RECEMENT

10/19/1990

ACCT. NO. CUSTOMER AGENT VENDOR NO. CUSTOMER P.O. NUMBER SHIPPED VIA FILE NO.

273943 B J MCGRIFF

COMPANY TRUCK 04410

DIRECT CORRESPONDENCE TO:

ENSIGN OPERATING COMPANY
P O BOX 937
GARDEN CITY, KS 67846

SUITE 1300
LIBERTY TOWER
100 BROADWAY AVENUE
OKLAHOMA CITY, OK 73102-0000

PRICE REF. NO.	DESCRIPTION	QUANTITY	U/M	UNIT PRICE	AMOUNT
PRICING AREA - MID CONTINENT					
000-117	MILEAGE	15	MI	2.35	35.25
		1	UNT		
009-134	CEMENT SQUEEZE	5790	FT	1,435.00	1,435.00
009-019		1	UNT		
018-317	SUPER FLUSH	18	SK	74.00	1,332.00
218-746	CLA-STA XP WINTER GRADE	4	GAL	36.00	144.00
218-703	LOSURF 300	4	GAL	24.50	98.00
504-043	PREMIUM CEMENT	375	SK	6.85	2,568.75
507-775	HALAD-322	247	LB	5.75	1,420.25
508-002	POTASSIUM CHLORIDE	450	LB	.25	112.50
500-959	SUPER CBL	88	LB	21.50	1,892.00
500-207	BULK SERVICE CHARGE	375	CFT	1.10	412.50
500-306	MILEAGE CMTG MAT DEL OR RETURN	810.7875	TMI	.75	608.09

INVOICE SUBTOTAL

10,058.34

DISCOUNT-(BID)
INVOICE BID AMOUNT

2,011.66-
8,046.68

*-KANSAS STATE SALES TAX
*-SEWARD COUNTY SALES TAX

288.49
67.87

LOE _____
W/O _____
CAP _____
APPROVAL _____

STATE OF KANSAS
JAN 15 1991
CONSERVATION DIVISION
Wichita, Kansas

Leshinsky 1-26
Rwaka

INVOICE TOTAL - PLEASE PAY THIS AMOUNT =====> \$8,403.04

TERMS INVOICES PAYABLE NET BY THE 20TH OF THE FOLLOWING MONTH AFTER DATE OF INVOICE. UPON CUSTOMER'S DEFAULT IN PAYMENT OF CUSTOMER'S ACCOUNT BY THE LAST DAY OF THE MONTH FOLLOWING THE MONTH IN WHICH THE INVOICE IS DATED. CUSTOMER AGREES TO PAY INTEREST THEREON AFTER DEFAULT AT THE HIGHEST LAWFUL CONTRACT RATE APPLICABLE BUT NEVER TO EXCEED 18% PER ANNUM. IN THE EVENT IT BECOMES NECESSARY TO EMPLOY AN ATTORNEY TO ENFORCE COLLECTION OF SAID ACCOUNT, CUSTOMER AGREES TO PAY ALL COLLECTION COSTS AND ATTORNEY FEES IN THE AMOUNT OF 20% OF THE AMOUNT OF THE UNPAID ACCOUNT.

REF ID: A11111

ORIGINAL



ORIGINAL

P.O. BOX 951046 DALLAS, TX 75395-1046

INVOICE

HALLIBURTON SERVICES

CONFIDENTIAL

A Halliburton Company

INVOICE NO.	DATE
014517	10/06/1990

WELL LEASE NO./PLANT NAME		WELL/PLANT LOCATION		STATE	WELL/PLANT OWNER	
LESHINSKY 1-26		SEWARD		OK	ISAME	
SERVICE LOCATION		CONTRACTOR		JOB PURPOSE		TICKET DATE
LIBERAL		CHYENNE RIG 4		CEMENT PRODUCTION CASING		10/06/1990
ACCT. NO.	CUSTOMER AGENT	VENDOR NO.	CUSTOMER P.O. NUMBER	SHIPPED VIA	FILE NO.	
273945	B. J. MCGRIFF			COMPANY TRUCK	03536	

ENSIGN OIL & GAS INC.
621 17TH STREET, SUITE 1800
DENVER, CO 80293

DIRECT CORRESPONDENCE TO:
SUITE 1300
LIBERTY TOWER
100 BROADWAY AVENUE
OKLAHOMA CITY, OK 73102-0000

RECEIVED
JAN 10 1991
DIVISION
Wichita, Kansas

PRICE REF. NO.	DESCRIPTION	QUANTITY	U/M	UNIT PRICE	AMOUNT
PRICING AREA - MID CONTINENT					
000-117	MILEAGE	15	MI	2.35	35.25
		1	UNT		
001-016	CEMENTING CASING	6217	FT	1,475.00	1,475.00
		1	UNT		
030-016	CEMENTING PLUG SW ALUM TOP	4 1/2	IN	32.00	32.00
		1	EA		
018-317	SUPER FLUSH	18	SK	74.00	1,332.00
218-738	CLAYFIX II	2	GAL	20.00	40.00
12A	GUIDE SHOE - 4 1/2" 8RD THD.	1	EA	83.00	83.00
825.201					
4A	FLOAT COLLAR 4-1/2" 8RD SS II	1	EA	198.00	198.00
836.00100					
50	FLUIDMASTER CENTRALIZER 4 1/2"	2	EA	42.00	84.00
807.93504					
40	CENTRALIZER 4-1/2" MODEL S-4	4	EA	41.00	164.00
807.93004					
66	FASGRIP LIMIT CLAMP 5 1/2"	1	EA	9.60	9.60
807.64021					
350	HALLIBURTON WELD-A	1	LB	11.00	11.00
890.10802					
504-043	PREMIUM CEMENT	425	SK	6.85	2,911.25
507-775	HALAD-322	280	LB	5.75	1,610.00
508-002	POTASSIUM CHLORIDE	500	LB	.25	125.00
500-959	SUPER CBL BLENDED	100	LB	21.50	2,150.00
500-207	BULK SERVICE CHARGE	425	CFT	1.10	467.50
500-306	MILEAGE CMTG MAT DEL OR RETURN	918.675	TMI	.75	689.01

INVOICE SUBTOTAL

11,416.61

DISCOUNT-(BID)
INVOICE BID AMOUNT

2,283.32-
9,133.29

RECEIVED
OCT 29 1990
ENSIGN OIL & GAS INC

***** CONTINUED ON NEXT PAGE *****

TERMS INVOICES PAYABLE NET BY THE 20TH OF THE FOLLOWING MONTH AFTER DATE OF INVOICE. UPON CUSTOMER'S DEFAULT IN PAYMENT OF CUSTOMER'S ACCOUNT BY THE LAST DAY OF THE MONTH FOLLOWING THE MONTH IN WHICH THE INVOICE IS DATED. CUSTOMER AGREES TO PAY INTEREST THEREON AFTER DEFAULT AT THE HIGHEST LAWFUL CONTRACT RATE APPLICABLE BUT NEVER TO EXCEED 18% PER ANNUM. IN THE EVENT IT BECOMES NECESSARY TO EMPLOY AN ATTORNEY TO ENFORCE COLLECTION OF SAID ACCOUNT. CUSTOMER AGREES TO PAY ALL COLLECTION COSTS AND ATTORNEY FEES IN THE AMOUNT OF 20% OF THE AMOUNT OF THE UNPAID ACCOUNT.

ORIGINAL

HALLIBURTON SERVICES

P.O. BOX 951046 DALLAS, TX 75395-1046

INVOICE

A Halliburton Company

CONFIDENTIAL

INVOICE NO.	DATE
014517	10/06/1990

WELL LEASE NO./PLANT NAME		WELL/PLANT LOCATION		STATE	WELL/PLANT OWNER
LESHINSKY 1-26		SEWARD		KS	SAME
SERVICE LOCATION		CONTRACTOR		JOB PURPOSE	
LIBERAL		CHYENNE RIG 4		CEMENT PRODUCTION CASING	
ACCT. NO.		CUSTOMER AGENT		VENDOR NO.	
273945		B. J. MCGRIFF		CUSTOMER P.O. NUMBER	
				SHIPPED VIA	
				COMPANY TRUCK	
				FILE NO.	
				03536	

ENSIGN OIL & GAS INC.
 621 17TH STREET, SUITE 1800
 DENVER, CO 80293

DIRECT CORRESPONDENCE TO:
 SUITE 1300
 LIBERTY TOWER
 100 BROADWAY AVENUE
 OKLAHOMA CITY, OK 73102-0000

PRICE REF. NO.	DESCRIPTION	QUANTITY	U/M	UNIT PRICE	AMOUNT
	*-KANSAS STATE SALES TAX				290.18
	*-SEWARD COUNTY SALES TAX				68.27
INVOICE TOTAL - PLEASE PAY THIS AMOUNT =====>					\$9,491.74

RECEIVED
 OCT 29 1990
 ENSIGN OIL & GAS INC.

STATE OF KANSAS RECEIVED
 JAN 10 1991
 CONCERNATION DIVISION
 Wichita, Kansas

Leshinsky 1-26
Rubick

TERMS INVOICES PAYABLE NET BY THE 20TH OF THE FOLLOWING MONTH AFTER DATE OF INVOICE. UPON CUSTOMER'S DEFAULT IN PAYMENT OF CUSTOMER'S ACCOUNT BY THE LAST DAY OF THE MONTH FOLLOWING THE MONTH IN WHICH THE INVOICE IS DATED. CUSTOMER AGREES TO PAY INTEREST THEREON AFTER DEFAULT AT THE HIGHEST LAWFUL CONTRACT RATE APPLICABLE BUT NEVER TO EXCEED 18% PER ANNUM. IN THE EVENT IT BECOMES NECESSARY TO EMPLOY AN ATTORNEY TO ENFORCE COLLECTION OF SAID ACCOUNT. CUSTOMER AGREES TO PAY ALL COLLECTION COSTS AND ATTORNEY FEES IN THE AMOUNT OF 20% OF THE AMOUNT OF THE UNPAID ACCOUNT.

A Halliburton Company

ORIGINAL

INVOICE NO. DATE
RELEASED 09/25/1990

WELL LEASE NO./PLANT NAME LESHINSKY 1-26		WELL/PLANT LOCATION SEWARD		STATE KS	WELL/PLANT OWNER SAME
SERVICE LOCATION LIBERAL	CONTRACTOR CHEYENNE DRLG #4	JOB PURPOSE CEMENT SURFACE CASING		TICKET DATE 09/25/1990	
ACCT. NO. 273943	CUSTOMER AGENT R F BURKE	VENDOR NO.	CUSTOMER P.O. NUMBER	SHIPPED VIA COMPANY TRUCK	FILE NO. 02384

CONFIDENTIAL

FROM CONFIDENTIAL

ENSIGN OPERATING COMPANY
P O BOX 937
GARDEN CITY, KS 67846

DIRECT CORRESPONDENCE TO:
SUITE 1300
LIBERTY TOWER
100 BROADWAY AVENUE
OKLAHOMA CITY, OK 73102-0000

PRICE REF. NO.	DESCRIPTION	QUANTITY	U/M	UNIT PRICE	AMOUNT
PRICING AREA - MID CONTINENT					
000-117	MILEAGE	15	MI	2.35	35.25
		1	UNT		
001-016	CEMENTING CASING	1460	FT	835.00	835.00
		1	UNT		
030-016	CEMENTING PLUG SW ALUM TOP	8 5/8	IN	92.00	92.00
		1	EA		
12A	GUIDE SHOE - 8 5/8" 8RD THD.	1	EA	188.00	188.00
825.217					
24A	INSERT FLOAT VALVE - 8 5/8" 8RD	1	EA	171.00	171.00
815.19502					
27	FILL-UP UNIT 7"- 8 5/8"	1	EA	29.00	29.00
815.19414					
40	CENTRALIZER 8-5/8" MODEL S-4	3	EA	53.00	159.00
807.93059					
504-050	PREMIUM PLUS CEMENT	150	SK	7.08	1,062.00
504-120	HALL. LIGHT -PREMIUM PLUS	535	SK	6.29	3,365.15
507-210	FLOCELE	171	LB	1.30	222.30
509-406	ANHYDROUS CALCIUM CHLORIDE	12	SK	26.25	315.00
500-207	BULK SERVICE CHARGE	720	CFT	1.10	792.00
500-306	MILEAGE CMTG MAT DEL OR RETURN	1033.104	TMI	.75	774.83
INVOICE SUBTOTAL					8,040.53
DISCOUNT-(BID)					1,608.10-
INVOICE BID AMOUNT					6,432.43
*-KANSAS STATE SALES TAX					243.80
*-SEWARD COUNTY SALES TAX					57.37
INVOICE TOTAL - PLEASE PAY THIS AMOUNT =====>					\$6,733.60

RECEIVED
OCT 15 1990
ENSIGN OIL & GAS INC.

TERMS INVOICES PAYABLE NET BY THE 20TH OF THE FOLLOWING MONTH AFTER DATE OF INVOICE. UPON CUSTOMER'S DEFAULT IN PAYMENT OF CUSTOMER'S ACCOUNT BY THE LAST DAY OF THE MONTH FOLLOWING THE MONTH IN WHICH THE INVOICE IS DATED. CUSTOMER AGREES TO PAY INTEREST THEREON AFTER DEFAULT AT THE HIGHEST LAWFUL CONTRACT RATE APPLICABLE BUT NEVER TO EXCEED 18% PER ANNUM. IN THE EVENT IT BECOMES NECESSARY TO EMPLOY AN ATTORNEY TO ENFORCE COLLECTION OF SAID ACCOUNT, CUSTOMER AGREES TO PAY ALL COLLECTION COSTS AND ATTORNEY FEES IN THE AMOUNT OF 20% OF THE AMOUNT OF THE UNPAID ACCOUNT.

ORIGINAL

HALLIBURTON SERVICES ORIGINAL

P.O. BOX 951046 DALLAS, TX 75395-1046

INVOICE

A Halliburton Company

CONFIDENTIAL

INVOICE NO.	DATE
014541	09/22/1990

RELEASED FEB 06 1992

WELL LEASE NO./PLANT NAME		WELL/PLANT LOCATION		STATE	WELL/PLANT OWNER	
LESHINSKY 1-26		SEWARD		KS	SAME	
SERVICE LOCATION		CONTRACTOR		JOB PURPOSE		TICKET DATE
LIBERAL		R & W RAT HOLE		CEMENT CONDUCTOR CASING		09/22/1990
ACCT. NO.	CUSTOMER AGENT	VENDOR NO.	CUSTOMER P.O. NUMBER	SHIPPED VIA	FILE NO.	
273943	RANDY HAZARD			COMPANY TRUCK	02272	

ENSIGN OPERATING COMPANY
P O BOX 937
GARDEN CITY, KS 67846

DIRECT CORRESPONDENCE TO:
SUITE 1300
LIBERTY TOWER
100 BROADWAY AVENUE
OKLAHOMA CITY, OK 73102-0000

PRICE REF. NO.	DESCRIPTION	QUANTITY	U/M	UNIT PRICE	AMOUNT
000-117	MILEAGE	10	MI	2.35	23.50
001-016	CEMENTING CASING	50	FT	440.00	440.00
504-043	PREMIUM CEMENT	150	SK	6.85	1,027.50
509-406	ANHYDROUS CALCIUM CHLORIDE	4	SK	26.25	105.00
500-207	BULK SERVICE CHARGE	158	CFT	1.10	173.80
500-306	MILEAGE CMTG MAT DEL OR RETURN	288.4	TMI	.75	216.30
INVOICE SUBTOTAL					1,986.10
DISCOUNT-(BID)					397.22-
INVOICE BID AMOUNT					1,588.88
*-KANSAS STATE SALES TAX					51.77
*-SEWARD COUNTY SALES TAX					12.18
INVOICE TOTAL - PLEASE PAY THIS AMOUNT =====>					\$1,652.83

STATE OF KANSAS COMMISSION
OCT 10 1991
CONSERVATION DIVISION
Wichita, Kansas

RECEIVED
OCT 9 1990
ENSIGN OIL & GAS INC.

TERMS INVOICES PAYABLE NET BY THE 20TH OF THE FOLLOWING MONTH AFTER DATE OF INVOICE. UPON CUSTOMER'S DEFAULT IN PAYMENT OF CUSTOMER'S ACCOUNT BY THE LAST DAY OF THE MONTH FOLLOWING THE MONTH IN WHICH THE INVOICE IS DATED, CUSTOMER AGREES TO PAY INTEREST THEREON AFTER DEFAULT AT THE HIGHEST LAWFUL CONTRACT RATE APPLICABLE BUT NEVER TO EXCEED 18% PER ANNUM. IN THE EVENT IT BECOMES NECESSARY TO EMPLOY AN ATTORNEY TO ENFORCE COLLECTION OF SAID ACCOUNT, CUSTOMER AGREES TO PAY ALL COLLECTION COSTS AND ATTORNEY FEES IN THE AMOUNT OF 20% OF THE AMOUNT OF THE UNPAID ACCOUNT.