

ORIGINAL

STATE CORPORATION COMMISSION OF KANSAS
OIL & GAS CONSERVATION DIVISION
WELL COMPLETION FORM
ACO-1 WELL HISTORY
DESCRIPTION OF WELL AND LEASE

API NO. 15- 189-21845-00-00
County STEVENS
SE - NW - NE Sec. 12 Twp. 33 Rge. 39 X W

Operator: License # 5208
Name: Mobil Oil Corporation
Address P.O. Box 2173
2319 North Kansas Avenue
City/State/Zip Liberal, KS 67905-2173

4030 FSL Feet from S/N (circle one) Line of Section
1350 FEL Feet from E/W (circle one) Line of Section
Footages Calculated from Nearest Outside Section Corner:
NE, NW or SW (circle one)

Purchaser: N/A
Operator Contact Person: Sharon Cook
Phone (316) 626-1142
Contractor Name: Cathodic Protection Services
License: 31474

Lease Name CP- CHRISTOPHER #1 UNIT Well # 2
Field Name Hugoton
Producing Formation NA [ANODE REPOSITORY]
Elevation: Ground 3214 KB NA
Total Depth 100 PBDT NA
Amount of Surface Pipe Set and Cemented at None Feet
Multiple Stage Cementing Collar Used? NA Yes NA No
If yes, show depth set NA Feet
If Alternate II completion, cement circulated from NA
feet depth to NA w/ NA sx cmt.

Wellsite Geologist:
Designate Type of Completion
New Well Re-Entry Workover
Oil SWD SIOW Temp. Abd.
Gas ENHR SIGW
Dry X Other (Coke, WSW, Expl., Cathodic, etc)

Drilling Fluid Management Plan ALT 3 10-18-95
(Data must be collected from the Reserve Pit)

If Workover:
Operator:
Well Name:
Comp. Date Old Total Depth
Deepening Re-perf. Conv. to Inj/SWD
Plug Back PBDT
Commingled Docket No.
Dual Completion Docket No.
Other (SWD or Inj?) Docket No.
1/10/95 1/10/95 1/10/95
Spud Date Date Reached TD Completion Date

Chloride content NA ppm Fluid volume NA bbls
Dewatering method used NA
Location of fluid disposal if hauled offsite:
Operator Name NA
Lease Name NA License No.
NA Quarter Sec. NA Twp. NA S Rng. NA E/W
County NA Docket No. NA

INSTRUCTIONS: An original and two copies of this form shall be filed with the Kansas Corporation Commission, 200 Colorado Derby Building, Wichita, Kansas 67202, within 120 days of the spud date, recompletion, workover or conversion of a well. Rule 82-3-130, 82-3-106 and 82-3-107 apply. Information on side two of this form will be held confidential for a period of 12 months if requested in writing and submitted with the form (see rule 82-3-107 for confidentiality in excess of 12 months). One copy of all wireline logs and geologist well report shall be attached with this form. ALL CEMENTING TICKETS MUST BE ATTACHED. Submit CP-4 form with all plugged wells. Submit CP-111 form with all temporarily abandoned wells.

All requirements of the statutes, rules and regulations promulgated to regulate the oil and gas industry have been fully complied with and the statements herein are complete and correct to the best of my knowledge.

Signature Sharon A. Cook Sharon A. Cook
Title Regulatory Assistant Date 2-13-95
Subscribed and sworn to before me this 13th day of February, 1995.
Notary Public Kathleen R. Poulton
Date Commission Expires AUGUST 18, 1998

K.C.C. OFFICE USE ONLY
F Letter of Confidentiality Attached
C Wireline Log Received
C Geologist Report Received
Distribution
KCC SMD/Rep NGPA
KGS Plug Other (Specify)

DEW95097.SAC



SIDE TWO

Operator Name Mobil Oil Corporation Lease Name CP-CHRISTOPHER #1 UNIT Well # 2

Sec. 12 Twp. 33 Rge. 39 East West County STEVENS

INSTRUCTIONS: Show important tops and base of formations penetrated. Detail all cores. Report all drill stem tests giving interval tested, time tool open and closed, flowing and shut-in pressures, whether shut-in pressure reached static level, hydrostatic pressures, bottom hole temperature, fluid recovery, and flow rates if gas to surface during test. Attach extra sheet if more space is needed. Attach copy of log.

Drill Stem Tests Taken (Attach Additional Sheets.) <input type="checkbox"/> Yes <input checked="" type="checkbox"/> No Samples Sent to Geological Survey <input type="checkbox"/> Yes <input checked="" type="checkbox"/> No Cores Taken <input type="checkbox"/> Yes <input checked="" type="checkbox"/> No Electric Log Run (Submit Copy.) <input type="checkbox"/> Yes <input checked="" type="checkbox"/> No List All E.Logs Run: Electric Resistance Log - Attached	<input checked="" type="checkbox"/> Log <input type="checkbox"/> Sample Formation (Top), Depth and Datums Name Top Datum SEE ATTACHED DRILLER'S LOG
---	--

CASING RECORD <input type="checkbox"/> New <input type="checkbox"/> Used							
Report all strings set-conductor, surface, intermediate, production, etc.							
Purpose of String	Size Hole Drilled	Size Casing Set (In O.D.)	Weight Lbs./Ft.	Setting Depth	Type of Cement	# Sacks Used	Type and Percent Additives

ADDITIONAL CEMENTING/SQUEEZE RECORD				
Purpose:	Depth Top Bottom	Type of Cement	#Sacks Used	Type and Percent Additives
<input type="checkbox"/> Perforate				
<input type="checkbox"/> Protect Casing				
<input type="checkbox"/> Plug Back TD				
<input checked="" type="checkbox"/> Plug Off Zone	(1) First plug	Bentonite set at	13' - 3'	plug.
	(2) Second plug	Bentonite set at	28' - 25'	plug.

Shots Per Foot	PERFORATION RECORD - Bridge Plugs Set/Type Specify Footage of Each Interval Perforated	Acid, Fracture, Shot, Cement Squeeze Record (Amount and Kind of Material Used)	
			Depth
First anode set at	80', second anode at 65', third anode at 40'.		

TUBING RECORD		Size Set At	Packer At	Liner Run <input type="checkbox"/> Yes <input type="checkbox"/> No
1" PVC vent from TD to 3' above surface.				
Date of First, Resumed Production, SWD or Inj. Installed 1/10/95		Producing Method <input type="checkbox"/> Flowing <input type="checkbox"/> Pumping <input type="checkbox"/> Gas Lift <input type="checkbox"/> Other (Explain)		
Estimated Production Per 24 Hours	Oil Bbls. NA	Gas Mcf NA	Water Bbls. NA	Gas-Oil Ratio Gravity

Disposition of Gas: Vented Sold Used on Lease (If vented, submit ACO-18.)

METHOD OF COMPLETION: Open Hole Perf. Dually Comp. Commingled

Production Interval: Other (Specify) _____

DATA SHEET

COMPANY MOBIL E+P JOB No. 80100370 DATE: 1-10-95
 WELL: CHRISTOPHER 1-2 PIPELINE: _____
 LOCATION: SEC. 12 TWP. 33 RGE. 39 CO. STEVENS STATE KS.
 ANODE TYPE LIDA ONE FT: ROTARY 85' FT: CASING _____ FT.

DEEP GROUND BED LOGGING DATA

DRILL. DEPTH LOG (FT)	ANODE TO STRUCTURE		ANODES		DRILL DEPTH LOG (FT)	ANODE TO STRUCTURE		ANODES	
	EXPLOR OHM	FINAL OHM	NO	TOP DEPTH		EXPLOR OHM	FINAL OHM	NO	TOP DEPTH
5					205				
HOLE PLUG 10				3'-13'	210				
15					215				
EARTH FILL 20				13'-25'	220				
HOLE PLUG 25				25'-28'	225				
30	.620				230				
35	.650				235				
40	.770		3		240				
45	.560				245				
50	.250				250				
55	.290				255				
60	.260				260				
65	.800		2		265				
70	.710				270				
75	.650				275				
80	1.050		1		280				
85					285				
90					290				
95					295				
100					300				
105					305				
110					310				
115					315				
120					320				
125					325				
130					330				
135					335				
140					340				
145					345				
150					350				
155					355				
160					360				
165					365				
170					370				
175					375				
180					380				
185					385				
190					390				
195					395				
200					400				

PIT CLOSED 1-10-95 HOLE PLUG SET 1-10-95

CHRISTOPHER 1-2 12-33-38 Stevens
4030 FSL 1250FEE
Elec? y Crop Wheat

29

0-40 Brown Clay
40-85 - BROWN SAND
1-10 95

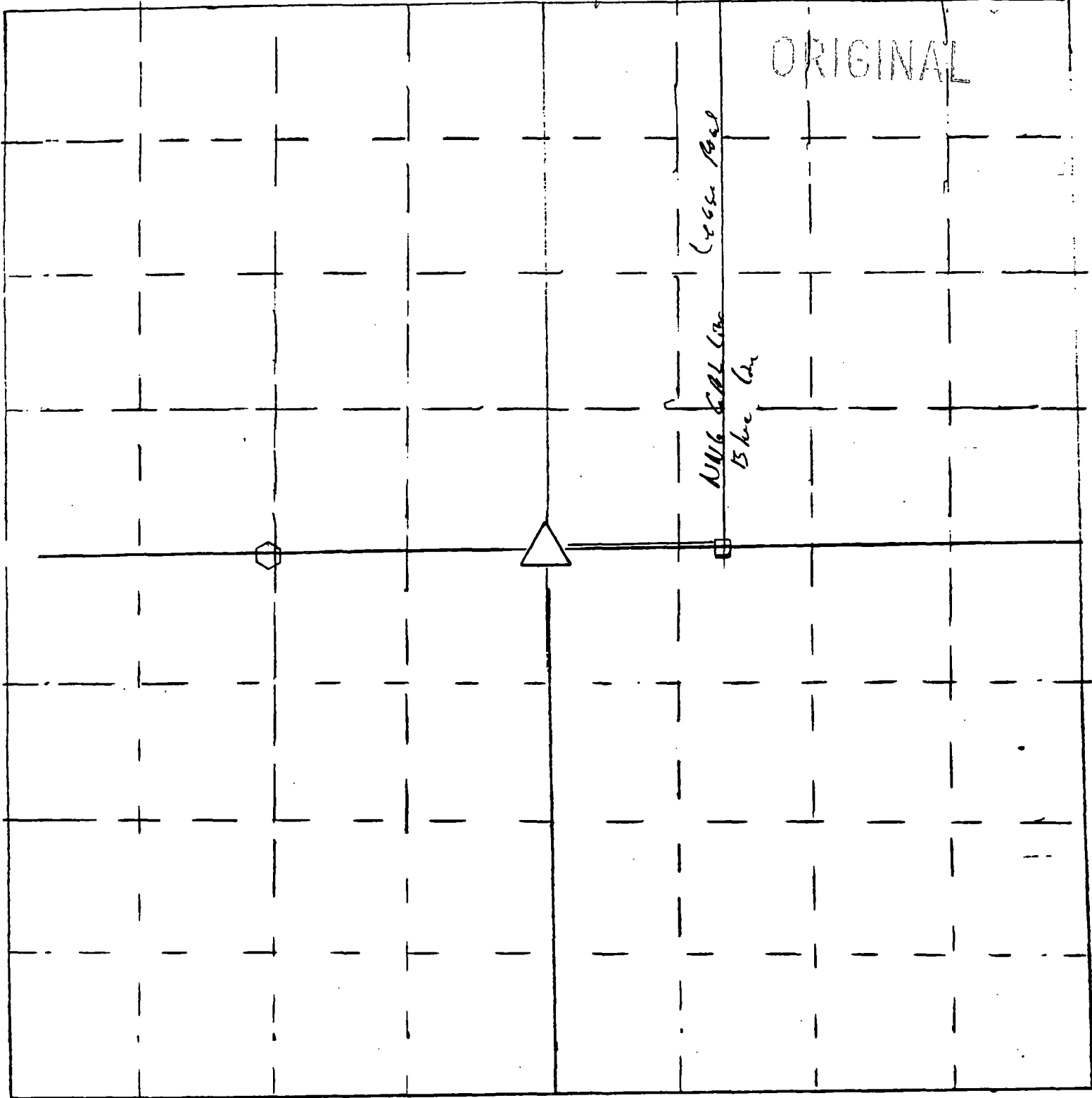
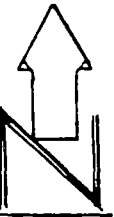

- △ = gas well location
- ⬡ = cathodic deep well location

Scale = 1" = 50'
□ = Meter house