

ORIGINAL SIDE ONE

STATE CORPORATION COMMISSION OF KANSAS  
OIL & GAS CONSERVATION DIVISION  
WELL COMPLETION FORM  
ACO-1 WELL HISTORY  
DESCRIPTION OF WELL AND LEASE

Operator: License # 5171  
Name: Marathon Oil Company  
Address Two Leadership Square  
211 N. Robinson, Suite 600  
City/State/Zip Oklahoma City, OK 73102  
Purchaser: \_\_\_\_\_  
Operator Contact Person: Cory West  
Phone (405) 235-3761

Contractor: Name: H-30 Drilling, Inc. LICENSE NO. 5107

Wellsite Geologist: \_\_\_\_\_

Designate Type of Completion  
 New Well  Re-Entry  Workover  
 Oil  SWD  Temp. Abd.  
 Gas  Inj  Delayed Comp.  
 Dry  Other (Core, Water Supply, etc.)

If ~~OWO~~ old well info as follows:  
Operator: \_\_\_\_\_  
Well Name: \_\_\_\_\_  
Comp. Date \_\_\_\_\_ Old Total Depth \_\_\_\_\_

Drilling Method:  
 Mud Rotary  Air Rotary  Cable  
1-12-91 1-21-91 3-1-91  
Spud Date Date Reached TD Completion Date

API NO. 15- 007-22,353 - 0000  
County Barber ✓  
NW SE SE Sec. 18 Twp. 34S Rge. 13  East  West  
990 ✓ Ft. North from Southeast Corner of Section  
990 ✓ Ft. West from Southeast Corner of Section  
(NOTE: Locate well in section plat below.)  
Lease Name Graves "G" ✓ Well # 1  
Field Name Aetna  
Producing Formation Mississippi  
Elevation: Ground 1,649' KB 1,659'  
Total Depth 5,050' PBTD 4,983'

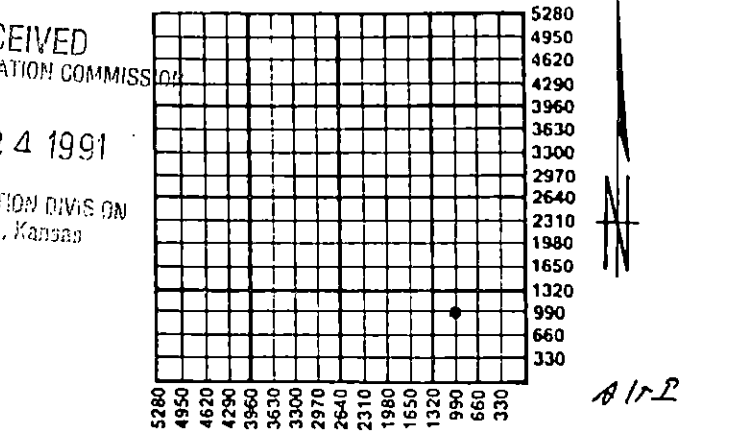

Amount of Surface Pipe Set and Cemented at 385 Feet  
Multiple Stage Cementing Collar Used?  Yes  No  
If yes, show depth set \_\_\_\_\_ Feet  
If Alternate II completion, cement circulated from \_\_\_\_\_  
feet depth to \_\_\_\_\_ w/ \_\_\_\_\_ sx cmt.

INSTRUCTIONS: This form shall be completed in triplicate and filed with the Kansas Corporation Commission, 200 Colorado Derby Building, Wichita, Kansas 67202, within 120 days of the spud date of any well. Rule 82-3-130, 82-3-107 and 82-3-106 apply. Information on side two of this form will be held confidential for a period of 12 months if requested in writing and submitted with the form. See rule 82-3-107 for confidentiality in excess of 12 months. One copy of all wireline logs and drillers time log shall be attached with this form. ALL CEMENTING TICKETS MUST BE ATTACHED. Submit CP-4 form with all plugged wells. Submit CP-111 form with all temporarily abandoned wells. Any recompletion, workover or conversion of a well requires filing of ACO-2 within 120 days from commencement date of such work.

All requirements of the statutes, rules and regulations promulgated to regulate the oil and gas industry have been fully complied with and the statements herein are complete and correct to the best of my knowledge.

Signature Kristina G. Gosh  
Title Production Engineer Date 4/22/91  
Subscribed and sworn to before me this 22nd day of April, 1991.  
Notary Public Supri Crump  
Date Commission Expires May 17, 1991

K.C.C. OFFICE USE ONLY  
F  Letter of Confidentiality Attached  
C  Wireline Log Received  
C  Drillers Timelog Received  
Distribution  
 KCC  SWD/Rep  NGPA  
 KGS  Plug  Other  
(Specify)

**SIDE TWO**

Operator Name Marathon Oil Company Lease Name Graves "G" Well # 1  
 Sec. 18 Twp. 34S Rge. 13  East County Barber  West

**INSTRUCTIONS:** Show important tops and base of formations penetrated. Detail all cores. Report all drill stem tests giving interval tested, time tool open and closed, flowing and shut-in pressures, whether shut-in pressure reached static level, hydrostatic pressures, bottom hole temperature, fluid recovery, and flow rates if gas to surface during test. Attach extra sheet if more space is needed. Attach copy of log.

Drill Stem Tests Taken <input checked="" type="checkbox"/> Yes <input type="checkbox"/> No (Attach Additional Sheets.)  Samples Sent to Geological Survey <input checked="" type="checkbox"/> Yes <input type="checkbox"/> No  Cores Taken <input type="checkbox"/> Yes <input checked="" type="checkbox"/> No  Electric Log Run <input checked="" type="checkbox"/> Yes <input type="checkbox"/> No (Submit Copy.)	<p style="text-align: center;"><b>Formation Description</b></p> <p style="text-align: center;"><input type="checkbox"/> Log <input checked="" type="checkbox"/> Sample</p> <table style="width:100%; border-collapse: collapse;"> <thead> <tr> <th style="text-align: left;">Name</th> <th style="text-align: center;">Top</th> <th style="text-align: center;">Bottom</th> </tr> </thead> <tbody> <tr> <td>Red Bed</td> <td style="text-align: center;">0</td> <td style="text-align: center;">71'</td> </tr> <tr> <td>Red Bed and Shale</td> <td style="text-align: center;">71'</td> <td style="text-align: center;">640'</td> </tr> <tr> <td>Shale</td> <td style="text-align: center;">640'</td> <td style="text-align: center;">2,805'</td> </tr> <tr> <td>Shale and Lime</td> <td style="text-align: center;">2,805'</td> <td style="text-align: center;">3,290'</td> </tr> <tr> <td>Lime and Shale</td> <td style="text-align: center;">3,290'</td> <td style="text-align: center;">3,960'</td> </tr> <tr> <td>Shale and Lime</td> <td style="text-align: center;">3,960'</td> <td style="text-align: center;">4,170'</td> </tr> <tr> <td>Lime and Shale</td> <td style="text-align: center;">4,170'</td> <td style="text-align: center;">4,500'</td> </tr> <tr> <td>Shale and Lime</td> <td style="text-align: center;">4,500'</td> <td style="text-align: center;">4,670'</td> </tr> <tr> <td>Lime</td> <td style="text-align: center;">4,670'</td> <td style="text-align: center;">5,050'</td> </tr> <tr> <td>Rotary Total Depth</td> <td></td> <td style="text-align: center;">5,050'</td> </tr> </tbody> </table>	Name	Top	Bottom	Red Bed	0	71'	Red Bed and Shale	71'	640'	Shale	640'	2,805'	Shale and Lime	2,805'	3,290'	Lime and Shale	3,290'	3,960'	Shale and Lime	3,960'	4,170'	Lime and Shale	4,170'	4,500'	Shale and Lime	4,500'	4,670'	Lime	4,670'	5,050'	Rotary Total Depth		5,050'
Name	Top	Bottom																																
Red Bed	0	71'																																
Red Bed and Shale	71'	640'																																
Shale	640'	2,805'																																
Shale and Lime	2,805'	3,290'																																
Lime and Shale	3,290'	3,960'																																
Shale and Lime	3,960'	4,170'																																
Lime and Shale	4,170'	4,500'																																
Shale and Lime	4,500'	4,670'																																
Lime	4,670'	5,050'																																
Rotary Total Depth		5,050'																																

**CASING RECORD**  
 Surface  New  Used Production  
 Report all strings set-conductor, surface, intermediate, production, etc.

Purpose of String	Size Hole Drilled	Size Casing Set (In O.D.)	Weight Lbs./Ft.	Setting Depth	Type of Cement	# Sacks Used	Type and Percent Additives
Surface	12-1/4"	8-5/8"	24#	385'	Lite Wt.	175	2% cc
Production	7-7/8"	4-1/2"	10.5#	4983'	Class A Surefill	75 150	2% cc 5% Gilsonite 1/4# Celloflake

Shots Per Foot	PERFORATION RECORD Specify Footage of Each Interval Perforated	Acid, Fracture, Shot, Cement Squeeze Record (Amount and Kind of Material Used) Depth
4	4712'-4722 (38 holes)	42,994 gal X-link gel w/CO2, 100 mesh sd & 100,000# 20/40 Ott sd.

**TUBING RECORD** Size 2 3/8" Set At 4689' Packer At \_\_\_\_\_ Liner Run  Yes  No

Date of First Production 3-1-91 Producing Method  Flowing  Pumping  Gas Lift  Other (Explain) \_\_\_\_\_  
 Estimated Production Per 24 Hours  
 Oil 0 Bbls. Gas 352 Mcf Water .96 Bbls. Gas-Oil Ratio \_\_\_\_\_ Gravity \_\_\_\_\_

Disposition of Gas:  Vented  Sold  Used on Lease (If vented, submit ACO-18.)  
 METHOD OF COMPLETION:  Open Hole  Perforation  Dually Completed  Commingled  
 Other (Specify) \_\_\_\_\_

## ORIGINAL

## FORMATION TOPS FOR:

Marathon: Graves "G" #1  
Sec. 18-24S-13W  
Barber Co., KS

LECOMPTON	3698
ELGIN	3756
OREAD	3930
HEEBNER	3950
LANSING	4140
STARK SHALE	4558
HUSH SHALE	4580
MISSISSIPPIAN	4712

RECEIVED  
STATE CORPORATION COMMISSION

MAY 09 1991

CONSERVATION DIVISION  
Wichita, Kansas

P. O. BOX 1599 PHONE (316) 262-5661  
WICHITA, KANSAS 67201

WESTERN TESTING CO., INC.  
FORMATION TESTING  
ORIGINAL TICKET

Elevation 1649 GL Formation MISS

District PRATT Date 1-19-91 Customer Order No. \_\_\_\_\_

COMPANY NAME TXO, Corp - Marathon Oil Co - Two Leadership Sq - 211 N. Robinson  
ADDRESS OKLAHOMA CITY, OK, 73102 Suite 600

LEASE AND WELL NO. Greaves G #1 COUNTY Becker STATE KANSAS Sec. 18 Twp. 34S Rge. 6E

Mail Invoiced To TXO - RR #1 Box 125 Mediciana Lodge Mus 67124 No. Copies Requested 109  
Co. Name Address  
Mail Chars To TXO - Two Leadership Sq - 211 N. Robinson - Suite 600 OK City, 73102 No. Copies Requested 109  
Address

Formation Test No. 1 Interval Tested From 4700 ft. to 4770 ft. Total Depth 4770 ft.  
Packer Depth 4695 ft. Size 6 5/8 in. Packer Depth \_\_\_\_\_ ft. Size \_\_\_\_\_ in.  
Packer Depth 4700 ft. Size 6 5/8 in. Packer Depth \_\_\_\_\_ ft. Size \_\_\_\_\_ in.

Depth of Selective Zone Set \_\_\_\_\_  
Top Recorder Depth (Inside) 4703 ft. Recorder Number 1051 Cap 4250  
Bottom Recorder Depth (Outside) 4765 ft. Recorder Number 4332 Cap 4200  
Below Straddle Recorder Depth \_\_\_\_\_ ft. Recorder Number \_\_\_\_\_ Cap \_\_\_\_\_

Drilling Contractor H-30 Re Rig #2 Drill Collar Length 540 I. D. 2 1/4 in.  
Mud Type Chem Viscosity 38 Weight Pipe Length NO I. D. \_\_\_\_\_ in.  
Weight 9.0 Water Loss 10.0 cc. Drill Pipe Length 4132 I. D. 3.8 in.  
Chlorides 3,200 P.P.M. Test Tool Length 28 ft. Tool Size 5 1/2 OD in.  
Jars: Make WTC Serial Number 404 Anchor Length 20 (29+14) ft. Size 4 1/2 x 5 1/2 OD in.  
Did Well Flow? NO Reversed Out NO Surface Choke Size 3/4 in. Bottom Choke Size 3/4 in.  
Main Hole Size 7 1/8 in. Tool Joint Size 4 1/2 X N in.

Blow: Weak building to a 10 inch blow on initial flow period  
Strong blow on final flow - would maintain 2" head

Recovered \_\_\_\_\_ ft. of \_\_\_\_\_  
Recovered 780 ft. of 9 1/2 in pipe  
Recovered \_\_\_\_\_ ft. of \_\_\_\_\_  
Recovered 20 ft. of mud  
Recovered \_\_\_\_\_ ft. of \_\_\_\_\_  
Chlorides \_\_\_\_\_ P.P.M. Sample Jars used \_\_\_\_\_ Remarks: \_\_\_\_\_

STATE OF KANSAS  
APR 24 1991  
COMMERCIAL DIVISION

Time On Location 2:00 AM Time Pick Up Tool 4:15 AM Time Off Location 2:00 AM  
Time Set Packer(s) 6:30 AM Time Started Off Bottom 11:00 AM Maximum Temperature 124 °F  
Initial Hydrostatic Pressure \_\_\_\_\_ (A) 2294 P.S.I.  
Initial Flow Period \_\_\_\_\_ Minutes 30 (B) 107 P.S.I. to (C) 107 P.S.I.  
Initial Closed In Period \_\_\_\_\_ Minutes 60 (D) 622 P.S.I.  
Final Flow Period \_\_\_\_\_ Minutes 60 (E) 107 P.S.I. to (F) 107 P.S.I.  
Final Closed In Period \_\_\_\_\_ Minutes 120 (G) 975 P.S.I.  
Final Hydrostatic Pressure \_\_\_\_\_ (H) 2294 P.S.I.

COMPANY TERMS

Western Testing Co., Inc. shall not be liable for damages of any kind to the property or personnel of the one for whom a test is made or for any loss suffered or sustained directly or indirectly through the use of its equipment, of its statements or opinion concerning the results of any test. Tools lost or damaged in the hole shall be paid at cost by the party for whom the test is made.  
All charges subject to 12% interest after 60 days from date of invoice. Any expense incurred for collection will be added to the original amount.

Test Approved By Kon G B Bmc  
Signature of Customer or his authorized representative

Western Representative Red Witt - Thank you!

FIELD INVOICE

Open Hole Test  \$ \_\_\_\_\_  
Miscrun \$ \_\_\_\_\_  
Straddle Test \$ \_\_\_\_\_  
Jars  \$ \_\_\_\_\_  
Selective Zone \$ \_\_\_\_\_  
Safety Joint  \$ \_\_\_\_\_  
Standby \$ \_\_\_\_\_  
Evaluation \$ \_\_\_\_\_  
Extra Packer \$ \_\_\_\_\_  
Circ. Sub. \$ \_\_\_\_\_  
Mileage \$ \_\_\_\_\_  
Fluid Sampler \$ \_\_\_\_\_  
Extra Charts \$ \_\_\_\_\_



P.O. Box 4442  
Houston, Tx. 77210

**SERVICE OPERATIONS CONTRACT**  
TERMS NET 30 DAYS FROM DATE OF CONTRACT

REMIT TO: P.O. Box 100806, Houston, Tx. 77212

ORIGINAL

DATE: 1-22-91  
SERVICE CONTRACT NO.: 636462

CUSTOMER ACCOUNT NO.	DIST NAME MED. LOUSE	NEW WELL <input checked="" type="checkbox"/> OLD WELL <input type="checkbox"/>	WELL TYPE 6	JOB NUMBER 500865
CUSTOMER MARATHON OIL Co.	DIST NUMBER 534	WELL NO. 1	LEASE NAME & FEDERAL OFFSHORE LEASE NO. BRAVES 6	
ADDRESS ROUTE 1 Box 175 B	CITY MEDICINE LOUSE	STATE KANSAS	ZIP 67104	COUNTY BARBER
CITY MEDICINE LOUSE	STATE KANSAS	ZIP 67104	FIELD NAME AETNA	CITY CODE 14
AUTHORIZED BY: GENEVEE VEATCH	ORDER NO.	WELL OWNER MARATHON OIL Co.	MTA CODE	

STAGE NO.	JOB CODE 0106 - CEMENT	WORKING DEPTH 4933	FT	PUMPING EQUIPMENT	TIME (A OR P)	DATE
TOTAL PREV. GALS.	1 SURFACE <input type="checkbox"/> 2 INTERMEDIATE <input type="checkbox"/> 3 PRODUCTION <input checked="" type="checkbox"/> 4 REMEDIAL <input type="checkbox"/>	SIZE HOLE 7 7/8"	DEPTH 5050	FT	TRUCK CALLED	3:30 P
TOTAL MEAS. DEPTH FT	SIZE & WT. CASING 4 1/2" 10.5#	DEPTH 4933	FT	ARRIVED AT JOB	9:45 P	01/21/91
PACKER DEPTH	FLUID PUMPED	TIME RELEASED	6:00 A	START OPERATION	5:00 A	01/25/91
AUG. PSI 1300	MAX. PSI	MILES FROM STATION TO WELL 25	SALESMAN NUMBER	FINISH OPERATION	5:00 A	01/25/91

CUSTOMER INSTRUCTIONS FOR DISPOSAL OF RETURNED CEMENT

REMARKS

RECEIVED  
STATE OF KANSAS COMMISSION  
APR 24 1991  
CONSERVATION DIVISION

**CONTRACT CONDITIONS:** (This contract must be signed before the job is commenced or merchandise is delivered)  
The undersigned is authorized to execute this contract as an agent of the customer. As such, the undersigned agrees and acknowledges that this contract for services, material, products, and/or supplies includes all of and only those terms and conditions appearing on the front and back of this document. No additional or substitute terms and/or conditions shall become a part of this contract without the written consent of an officer of BJ SERVICES.

PRICE BOOK 01  
SIGNED: [Signature]  
(WELL OWNER, OPERATOR, CONTRACTOR OR AGENT)

PRICE BOOK REF. NO.	QUANTITY	DESCRIPTION	UNIT PRICE	U/M	PRICE EXTENSION
101100326	1	4,501' - 5,000' TUMP CHANGE	1260.00	E	1260 00
10109005	25	MILEAGE, ONE WAY	235.00	E	58 75
10410504	150	CLASS A	5.50	Q	825 00
10423020	346	A-10	.22	L	136 12
10415049	141	A-7P	.46	L	64 86
10423048	100	A-9	.25	L	25 00
10420145	141	BJ BEL	.13	L	18 33
10415032	750	KOL-SEAL	.33	L	247 50
10422003	33	CELLOFLAKE	1.21	L	45 93
10330001	182	MIXING CHANGE	1.10	Q	200 20

SERVICE REPRESENTATIVE: KAREN LANGRISH  
THE ABOVE MATERIAL AND SERVICE ORDERED BY CUSTOMER AND RECEIVED BY: [Signature]

CHECK IF CONTINUATION IS USED (WELL OWNER, OPERATOR, CONTRACTOR OR AGENT)

CUSTOMER: This is not an invoice - This Service Operations Contract is subject to review and correction by our Accounting Department.



**SERVICE OPERATIONS CONTRACT CONTINUATION**

CONTRACT NO. 636462

DATE OF JOB: MM 01 DD 22 YY 91 DISTRICT MEN. LODGE DIST. NO. 384 AUTHORIZED BY GENEAL KETCH

CUSTOMER MARATHON OIL CO

PRICE BOOK 01

PRICE BOOK REF. NO.	QUANTITY	DESCRIPTION	UNIT PRICE	U/M	PRICE EXTENSION
10940101	203	DROPS B.1 X25	.75	E	152.25
10409600	1	4 1/2" AFU SHOE - W	199.00	F	199.00
10409600	1	4 1/2" LATCH DOWN PLUG - W	307.00	F	307.00
10409600	1	4 1/2" BASKETS - K	125.00	F	125.00
10409600	5	4 1/2" CENTRALIZERS - W	43.55	F	217.75
		BOOK PRICE			\$ 3932.74
		LESS			589.91
		TOTAL			\$ 3342.83

RECEIVED  
STATE COMMISSION  
APR 24 1991  
CONSULTANT

SERVICE REPRESENTATIVE L. BUNSAWOT THE ABOVE MATERIAL AND SERVICE ORDERED BY CUSTOMER AND RECEIVED BY Geneal Ketch

CHECK IF CONTINUATION IS USED (WELL OWNER, OPERATOR, CONTRACTOR OR AGENT)

CUSTOMER: This is not an invoice - This Service Operations Contract is subject to review and correction by our Accounting Department.



P.O. Box 4442  
Houston, Texas 77210

# CEMENTING LOG

STAGE NO

Date 1-22-91 District MHEU Lodge Ticket No 636462  
 Company MARATHON OIL CO Rig H-30#2  
 Lease GRAVES Well No. 8-1  
 County BARBER State KANSAS  
 Location 13-34S-13W Field HEITNA  
UNION (HARL, W. TO D.F. 4 1/4 S, 1/2 E)

CEMENT DATA.  
 Spacer Type: 500 GALS. 2% KCL WATER  
 Amt. \_\_\_\_\_ Sks Yield \_\_\_\_\_ ft/sk Density 3.42 PPG

CASING DATA PTA  Squeere   
 Surface  Intermediate  Production  Liner   
 Size 4 1/2" Type K-55 Weight 10.5# Collar ST-6  
USED  
FIRST - 4790'  
COLLAPSE - 4010'  
 Casing Depths. Top KR Bottom 4993'  
378" - BC -

LEAD. Pump Time \_\_\_\_\_ hrs Type \_\_\_\_\_  
 Excess \_\_\_\_\_  
 Amt \_\_\_\_\_ Sks Yield \_\_\_\_\_ ft/sk Density \_\_\_\_\_ PPG  
 TAIL. Pump Time \_\_\_\_\_ hrs Type CLASE SURE-FLO  
5 APP KCL SEAL, YAPPS (FLARE EXCESS  
 Amt 1.50 Sks Yield 1.44 ft/sk Density 15.0 PPG  
 WATER Load \_\_\_\_\_ gals/sk Tail 6.2 gals/sk Total 22 Bbls  
 Pump Trucks Used 2902-6431 HOV BALL  
 Bulk Equip 2902-6433 JULIAN HART

Drill Pipe Size 4 1/2" Weight 16.6# Collars 8H  
 Open Hole Size 7 7/8" T.D. 5051 ft P.B. to \_\_\_\_\_ ft

Float Equip Manufacturer WEATHER FORD  
 Shoe Type AFU Depth 4993  
 Float Type LATCH DOWN PLUG Depth 4951  
 Centralizers Quantity 5 Plugs Top \_\_\_\_\_ Btm. \_\_\_\_\_  
 Stage Collars \_\_\_\_\_  
 Special Equip 1 BASKETS  
 Disp Fluid Type FRESH H<sub>2</sub>O Amt 3074 Bbls Weight 8.34 PPG  
 Mud Type CHEMICAL Weight 9.0 PPG

CAPACITY FACTORS  
 Casing Bbls/Lin ft. .0159 Lin ft / Bbl 62.70  
 Open Hole Bbls/Lin ft .0602 Lin ft / Bbl 16.59  
 Drill Pipe Bbls/Lin ft \_\_\_\_\_ Lin ft / Bbl \_\_\_\_\_  
 Annulus Bbls/Lin ft .0406 Lin ft / Bbl 24.61  
 Bbls/Lin ft \_\_\_\_\_ Lin ft / Bbl \_\_\_\_\_  
 Perforations: From \_\_\_\_\_ ft. to \_\_\_\_\_ ft Amt. \_\_\_\_\_

COMPANY REPRESENTATIVE BENJAMIN VEATCH

CEMENTER KEVIN LAMBERT

TIME	PRESSURES PSI		FLUID PUMPED DATA			REMARKS
	DRILL PIPE CASING	ANNULUS	TOTAL FLUID	Pumped Per-Sk Time Period	LEAK RATE Bbls Min/M	
9:45						ON LOCATION, <u>REG UP</u> <u>JOB + SAFETY MEETING</u> <u>RUN 4 1/2" CASING</u>
						<u>CASING ON BOTTOM, ROTATE WHEEL</u> <u>DEGRADATING</u>
5:00						<u>REG UP TO CEMENT PUMP</u> <u>START KCL WATER</u> <u>KCL WATER IN - START CEMENT</u> <u>INC RATE</u> <u>13Z DADP</u> <u>CEMENT IN - STOP PUMP - CHANGE VALVES</u> <u>FLUSH PUMP + LINES - CHANGE VALVES</u> <u>RELEASE PLUG - START DEGRADATION</u> <u>INCREASE RATE</u> <u>FLUSH @ 500</u> <u>CEMENT @ 1100 - FLOW RATE</u> <u>GRADUAL T<sub>2</sub> INCREASE - STOP CEMENT</u> <u>RELEASE PLUG</u> <u>RELEASE 15Z + FLOAT UP</u>
	350				6	
	500		10	10	6	
	500		12	2	7	
	300		15	3	7	
			48 1/2	2.2 1/2	7	
	150				2	
	150		50 1/2	2	6	
	150		73 1/2	23	6	
	100		88 1/2	10	4	
	750		116 1/2	23	4	
5:30	1500		129 1/4	12 3/4	4	

FINAL DISP PRESS: 750 PSI BUMP PLUG TO 1500 PSI BLEEDBACK 1/2 BBLs (THANK YOU)  
 Form No. SR 0502 (Rev. 3/90)  
 Note: Must accompany job ticket.

JOB NUMBER <b>500365</b>	CONTRACT NUMBER <b>636462</b>	DATE <b>1-21-91</b>	DISTRICT NAME <b>Med. Lodge, Mo</b>
CUSTOMER NAME AND ADDRESS <b>Marathon Oil Co. Route 1, Box 1256 Medicine Lodge, Kansas 67104</b>		DIRECT SHIPMENT FROM <b>VENDOR NAME</b>	

Item No.	Part Number	Description	UNIT OF MEASURE	AMOUNT LOADED	DIRECT SHIPPED	AMOUNT RETURNED
1	4110504	Class A	Q	150		0
2	415049	A7P	L	141		0
3	420145	BJ Oil	L	141		0
4	428020	A10	L	846		0
5	415082	Kul Seal	L	750		0
6	422008	Cello-Flake	L	38		0
7	423043	A-9	L	100		0
8						
9						
10						
11						
12						
13						
14						
15						
16						
17						
18						
19						
20						
21						
22						
23						
24						
25						
26						
27						

RECEIVED  
STATE OF  
APR 24 1991

COPY 1 - DISTRICT COPY COPY 2 - CUSTOMER COPY COPY 3 - HOUSTON	LOADED BY: <b>John Kellger</b>	CUSTOMER: <b>Marathon Oil Co.</b>	
	PRINTED: <b>John Kellger</b>	SIGNATURE: <b>[Signature]</b>	DATE: <b>1-22-91</b>
	SIGNATURE: <b>[Signature]</b>		





P.O. Box 4442  
Houston, Tx. 77210

**SERVICE OPERATIONS CONTRACT**

TERMS NET 30 DAYS FROM DATE OF CONTRACT

REMIT TO: P.O. Box 100806, Houston, Tx. 77212

DATE 1-13-91 SERVICE CONTRACT NO. 636454

CUSTOMER ACCOUNT NO. MARATHON OIL DIST NAME MED. COBE NEW WELLS  WELL TYPE G JOB NUMBER 500943  
 CUSTOMER MARATHON OIL DIST NUMBER 534 WELL NO. 1 LEASE NAME & FEDERAL OFFSHORE LEASE NO. CRAWS 6  
 ADDRESS Rt. 1, Box 125 B COUNTY PARISH BARREN CODE 007 STATE Ks CODE 74  
 CITY MEDICINE COBE STATE KANSAS ZIP 67104 FIELD NAME HETNH CITY CODE  
 AUTHORIZED BY: GERRELL VATCH (Please Print) ORDER NO. WELL OWNER MARATHON OIL MTA CODE

STAGE NO. 1 JOB CODE 0100 - CEMENT WORKING DEPTH 331 FT. PUMPING EQUIPMENT 7.20 A TIME (A OR P) MM DATE 01/13/91  
 TOTAL PREV. GALS. 7 1/8" SURFACE  INTERMEDIATE  PRODUCTION  REMEDIAL  ARRIVED AT JOB 10 00 H 01/13/91  
 TOTAL MEAS. DEPTH 12 1/4" SIZE HOLE 12 1/4" DEPTH 1102 FT. START OPERATION 2 55 P 01/13/91  
 FT. 3 1/8" 24# SIZE & WT. CASING 3 1/8" 24# DEPTH 331 FT. FINISH OPERATION 3 15 P 01/13/91  
 FT. 4 1/2" 16.6# SIZE & WT. DRILL PIPE OR TUBING 4 1/2" 16.6# DEPTH 1103 FT. TIME RELEASED 4 15 P  
 AVG. PSJ. 400 Packer DEPTH FLUID PUMPED SALESMAN NUMBER

CUSTOMER INSTRUCTIONS FOR DISPOSAL OF RETURNED CEMENT  
 MAX. BPM 6 1/2  
 S/S EMPLOYEE NUMBER 666454

REMARKS  
 APR 24 1991

**CONTRACT CONDITIONS:** (This contract must be signed before the job is commenced or merchandise is delivered)  
 The undersigned is authorized to execute this contract as an agent of the customer. As such, the undersigned agrees and acknowledges that this contract for services, materials, products, and/or supplies includes all of and only those terms and conditions appearing on the front and back of this document. No additional or substitute terms and/or conditions shall become a part of this contract without the written consent of an officer of BJ SERVICES.

PRICE BOOK 01 SIGNED: [Signature] (WELL OWNER, OPERATOR, CONTRACT OR AGENT)

PRICE BOOK REF. NO.	QUANTITY	DESCRIPTION	UNIT PRICE	U.M.	PRICE EXTENSION
10100504	1	301' - 500' PUMP (CHANGE)	430.00	F	430 00
10109005	25	RELEASE ONE WAY	2.35	F	58 75
10410504	139	CLASS A	5.50	Q	1039 50
10415013	61	FLUSH	2.91	Q	177 51
10420145	1054	BT GEL	.12	L	137 02
10415049	663	A-M	.46	L	307 28
10330001	279	MIXING SERVICE	1.10	Q	306 90
10940101	300	DRAINAGE 12 X 25	.75	F	225 00
1043	1	3 1/8" TOP PLUG	100.00	F	100 00
10409600	2	3 1/8" BASKETS - B	193.00	F	396 00

SERVICE REPRESENTATIVE KEVIN BRUNGART THE ABOVE MATERIAL AND SERVICE ORDERED BY CUSTOMER AND RECEIVED BY: [Signature]

CHECK IF CONTINUATION IS USED (WELL OWNER, OPERATOR, CONTRACT OR AGENT)  
 CUSTOMER: This is not an invoice This Service Operations Contract is subject to review and correction by our Accounting Department.

ORIGINAL

JOB NUMBER 500843	CONTRACT NUMBER 500454	DATE 1-13-91	DISTRICT NAME Med. Lodge, Ms.
CUSTOMER NAME AND ADDRESS Marathon Oil P. 1, Box 125 B Medicine Lodge, KS 67104		DIRECT SHIPMENT FROM VENDOR NAME	

Item No.	Part Number	Description	UNIT OF MEASURE	AMOUNT LOADED	DIRECT SHIPPED	AMOUNT RETURNED
1		FRONT CAN				
2	410504	Class A	Q	114		0
3	415018	Fly Ash	Q	61		0
4	420145	B I Mul	L	913		0
5	415049	A7P	L	454		0
6						
7						
8						
9						
10		REAR CAN				
11	410504	Class A	Q	75		0
12	420145	B I Mul	L	141		0
13	415049	A7P	L	212		0
14						
15	430636	3 7/8" TOP Plug	E	1		0
16						
17						
18						
19					RECEIVED STATE CORPORATION	
20					APR 24 1991	
21						
22						
23						
24						
25						
26						
27						

COPY 1 - DISTRICT COPY COPY 2 - CUSTOMER COPY COPY 3 - HOUSTON	LOADED BY: <u>John Kelley</u>	CUSTOMER: <u>[Signature]</u>
	PRINTED: <u>[Signature]</u>	SIGNATURE: <u>[Signature]</u>



P.O. Box 4442  
Houston, Texas 77210

# ORIGINAL CEMENTING LOG

STAGE NO.

Date 1/13/91 District MEN. 6006 Ticket No. 62645H  
 Company ADAMATION OIL Rig 4-30#2  
 Lease GRAVES "B" Well No. 1  
 County BARBER State KANSAS  
 Location 13-34-13W Field HEZNA  
UNCLARIFIED, N. TO D.E., 4.2 S, 3/4 SE

CASING DATA PTA  Squeeze   
 Surface  Intermediate  Production  Liner   
 Size 3 7/8" Type K-55 Weight 24# Collar STC

CRUST - 2850#  
COLLAPSE - 1370#  
 Casing Depths: Top 48 Bottom 331'

Drill Pipe: Size 4 1/2" Weight 16.6# Collars KH  
 Open Hole: Size 7 7/8" T.D. 1103 ft. P.B. to \_\_\_\_\_ ft

CAPACITY FACTORS  
 Casing: Bbls/Lin ft. .0637 Lin ft./Bbl 15.7  
 Open Holes 1 1/4" Bbls/Lin ft. .1453 Lin ft./Bbl 6.85  
 Drill Pipe: Bbls/Lin ft. \_\_\_\_\_ Lin ft./Bbl \_\_\_\_\_  
 Annulus: Bbls/Lin ft. .0735 Lin ft./Bbl 13.6  
 Bbls/Lin ft. \_\_\_\_\_ Lin ft./Bbl \_\_\_\_\_  
 Perforations: From \_\_\_\_\_ ft. to \_\_\_\_\_ ft. Amt. \_\_\_\_\_

CEMENT DATA  
 Spacer Type: 5 P.Bls. FRESH H<sub>2</sub>O  
 Amt. \_\_\_\_\_ Sks Yield \_\_\_\_\_ ft<sup>3</sup>/sk Density \_\_\_\_\_ PPG

LEAD: Pump Time \_\_\_\_\_ hrs. Type 35:05:6  
+ 3 3/4 A-7P Excess \_\_\_\_\_  
 Amt. 175 Sks Yield 1.58 ft<sup>3</sup>/sk Density 13.3 PPG

TAIL: Pump Time \_\_\_\_\_ hrs. Type CLASS. H  
+ 3 3/4 A-7P, 2 1/2 BCL Excess \_\_\_\_\_  
 Amt. 75 Sks Yield 1.34 ft<sup>3</sup>/sk Density 13.2 PPG  
 WATER: Lead 7.3 gals/sk Tail 6.5 gals/sk Total 14 Bbls

Pump Trucks Used 2902-6431 MAY BALL  
 Bulk Equip 2923-6493 JUDITH HART

Floater Equip Manufacturer BAKER - WEAVERFORD  
 Shoe Type \_\_\_\_\_ Depth 331  
 Floater Type BAFFLE PLATE Depth 339  
 Centralizers Quantity 1 Plugs Top BLDEN Bin \_\_\_\_\_  
 Stage Collars \_\_\_\_\_  
 Special Equip 2 BASKETS (30' + 340')  
 Disp. Fluid Type FRESH H<sub>2</sub>O Amt. \_\_\_\_\_ Bbls. Weight 3.51 PPG  
 Mud Type NATIVE Weight \_\_\_\_\_ PPG

COMPANY REPRESENTATIVE GUNNELL WATCH

CEMENTER KEVIN BRUNDALOT

TIME	PRESSURES PSI		FLUID PUMPED DATA			REMARKS
	DRILL PIPE CASING	ANNULUS	TOTAL FLUID	Pumped Per Time Period	RATE Bbls Min	
10:00						ON LOCATION, WAZZ ON DORER REG UP - JOB + SAFETY MEET RUN 2 7/8" CASING + BREAK GUARDIAN REG UP TO CEMENT PUMP
2:55	200				6	START FRESH H <sub>2</sub> O
	150		5	5	6	FRESH H <sub>2</sub> O IN - START LEAD
	200		54 1/4	49 1/4	6 1/2	LEAD IN - START TAIL
	0		72	17 3/4	0 1/2	TAIL IN - STOP PUMPS
						CHANGE VALVES - RELEASE PLUG
3:15	50				4	START DISPLACEMENT
	100		91	19	4	CEMENTATE CEMENT
	400		93 3/4	2 3/4	4	BUMP PLUG

STATEMENT  
 APR 24 1991

FINAL DISP PRESS 100 PSI BUMP PLUG TO 400 PSI BLEEDBACK 1/4 BBLs  
 Form No. SR 0502 (Rev. 3/90)  
 Note: Must accompany job ticket.

THANK YOU!



SERVICE OPERATIONS CONTRACT CONTINUATION

ORIGINAL

CONTRACT NO. 636454

DATE OF JOB: 01/13/91    DISTRICT: NEW LODGE    DIST. NO: 584    AUTHORIZED BY: GENEAL DEATCH  
 CUSTOMER: MARATHON OIL

PRICE BOOK 01

PRICE BOOK REF. NO.	QUANTITY	DESCRIPTION	UNIT PRICE	UM	PRICE EXTENSION
10409600	1	3 7/8" BAFFLE PLATE - W	99.25	E	99 25
10409600	1	3 7/8" CENTRALIZER - B	60.00	F	60 00
		BOOK PRICE		\$	3387 21
		LESS			508 08
		TOTAL		\$	2879 13

STATE OF MISSOURI  
FEB 24 1991

*Geneal Deatch*

SERVICE REPRESENTATIVE: *K. BRUNOLOT*    THE ABOVE MATERIAL AND SERVICE ORDERED BY CUSTOMER AND RECEIVED BY: *Geneal Deatch*  
 (WELL OWNER, OPERATOR, CONTRACTOR OR AGENT)

CHECK IF CONTINUATION IS USED    CUSTOMER: This is not an invoice - This Service Operations Contract is subject to review and correction by our Accounting Department.