

STATE OF KANSAS
STATE CORPORATION COMMISSION
CONSERVATION DIVISION
P. O. BOX 17027
WICHITA, KANSAS 67217

FORM CP-4

WELL PLUGGING RECORD

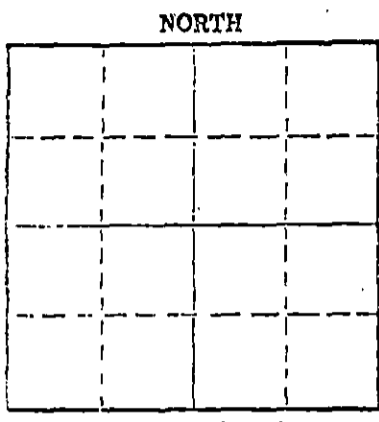

Pratt County, Sec 16 Twp. 28S Rge. (E) 13W (W)
Location as "NE/CNW/SE/SW" or footage from lines SW NE NW
Lease Owner Petrie Exploration Company
Lease Name Farmer Well No. 1
Office Address Route 1, Pratt, Kansas 67124
Character of Well (completed as Oil, Gas or Dry Hole) Dry Hole
Date well completed May 7, 19 77
Application for plugging filed May 6, 19 77
Application for plugging approved May 6, 19 77
Plugging commenced May 7, 19 77
Plugging completed May 7, 19 77
Reason for abandonment of well or producing formation Dry Hole

If a producing well is abandoned, date of last production 19
Was permission obtained from the Conservation Division or its agents before plugging was commenced? Yes

Name of Conservation Agent who supervised plugging of this well Metz
Producing formation Depth to top Bottom Total Depth of Well 3255 Feet
Show depth and thickness of all water, oil and gas formations.

OIL, GAS OR WATER RECORDS

CASING RECORD

FORMATION	CONTENT	FROM	TO	SIZE	PUT IN	PULLED OUT
		0	247	8 5/8	247	None

Describe in detail the manner in which the well was plugged, indicating where the mud fluid was placed and the method or methods used in introducing it into the hole. If cement or other plugs were used, state the character of same and depth placed, from feet to feet for each plug set.

Plugged: 35 sacks @ 240,
Mud up to 40, 1/2 sack hulls,
Plug 12 sacks to base of cellar
5 sacks in rathole; 2 sacks in mousehole,
Completed @ 8:00 PM 5-7-77
By: Halliburton

RECEIVED
Conservation Division
MAY 23 1977
WICHITA, KANSAS

(If additional description is necessary, use BACK of this sheet)

Name of Plugging Contractor DaMac Drilling Inc.
Address Box 1164, Great Bend, Kansas 67530

STATE OF Kansas COUNTY OF Barton ss.
Martha J. McKown (employee of owner) or (owner or operator) of the above-described

well, being first duly sworn on oath, says: That I have knowledge of the facts, statements, and matters herein contained and the log of the above-described well as filed and that the same are true and correct. So help me God.

(Signature) Martha J. McKown
Box 1164, Great Bend, Kansas 67530
(Address)

DONALD SLOUP
STATE NOTARY PUBLIC
My Commission Expires
November 11, 1978

12th day of May, 19 77
11-11-78
Notary Public.

KANSAS DRILLERS LOG

S. 16 T. 28S R. 13W E
W

API No. 15 _____
County _____ Number _____

Loc. SW NE NW

County Pratt

Operator
Petrie Exploration Company

Address
Route 1, Pratt, Kansas 67124

Well No. 1 Lease Name Farmer

Footage Location
feet from (N) (S) line _____ feet from (E) (W) line _____

Principal Contractor DaMac Drilling Inc. Geologist Fred Lillibridge

Spud Date 4-30-77 Total Depth 3255 P.B.T.D. _____

Date Completed 5-7-77 Oil Purchaser _____

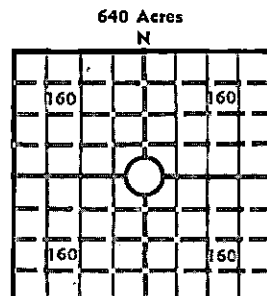

Elev.: Gr. _____

DF _____ KB _____

CASING RECORD

Report of all strings set — surface, intermediate, production, etc.

Purpose of string	Size hole drilled	Size casing set (in O.D.)	Weight lbs/ft.	Setting depth	Type cement	Sacks	Type and percent additives
Surface	12 1/4	8 5/8	24	247	Reg	250	2%Ge1 & 3%CC

LINER RECORD

PERFORATION RECORD

Top, ft.	Bottom, ft.	Sacks cement	Shots per ft.	Size & type	Depth interval

Size	Setting depth	Packer set at

ACID, FRACTURE, SHOT, CEMENT SQUEEZE RECORD

Amount and kind of material used	Depth interval treated

INITIAL PRODUCTION

Date of first production _____	Producing method (flowing, pumping, gas lift, etc.) _____
RATE OF PRODUCTION PER 24 HOURS	Oil _____ Gas _____ Water _____ Gas-oil ratio _____
Disposition of gas (vented, used on lease or sold) _____	Producing interval (s) _____

INSTRUCTIONS: As provided in KCC Rule 82-2-125, within 90 days after completion of a well, one completed copy of this Drillers Log shall be transmitted to the State Geological Survey of Kansas, 4150 Monroe Street, Wichita, Kansas 67209. Copies of this form are available from the Conservation Division, State Corporation Commission, 3830 So. Meridian (P.O. Box 17027), Wichita, Kansas 66217. Phone AC 316-522-2206. If confidential custody is desired, please note Rule 82-2-125. Drillers Logs will be on open file in the Oil and Gas Division, State Geological Survey of Kansas, Lawrence, Kansas 66044.

Operator **Petrie Exploration Company** DESIGNATE TYPE OF COMP.: OIL, GAS, DRY HOLE, SWDW, ETC.:

Well No. **1** Lease Name **Farmer** Dry Hole

S 16 T 28S R 13W ^E/_W

WELL LOG

Show all important zones of porosity and contents thereof; cored intervals, and all drill-stem tests, including depth interval tested, cushion used, time tool open, flowing and shut-in pressures, and recoveries.

SHOW GEOLOGICAL MARKERS, LOGS RUN, OR OTHER DESCRIPTIVE INFORMATION.

FORMATION DESCRIPTION, CONTENTS, ETC.	TOP	BOTTOM	NAME	DEPTH
Sand	0	150		
RedBed	150	985		
Shale	985	1850		
Shale & Lime	1850	3255RTD		

RECEIVED
STATE CORPORATION COMMISSION
MAY 23 1977
CONSERVATION DIVISION
Wichita, Kansas

USE ADDITIONAL SHEETS, IF NECESSARY, TO COMPLETE WELL RECORD.

Date Received	<u>Martha J. McKown</u> Signature
	<u>Vice President</u> Title
	<u>May 10, 1977</u> Date