

STATE CORPORATION COMMISSION OF KANSAS
OIL & GAS CONSERVATION DIVISION

WELL COMPLETION OR RECOMPLETION FORM
ACO-1 WELL HISTORY

DESCRIPTION OF WELL AND LEASE

Operator: license # 5144
name MULL DRILLING COMPANY, INC.
address P.O. Box 2758
Wichita
City/State/Zip Kansas 67201

Operator Contact Person Patricia Ungleich
Phone 316 264-6366

Contractor: license # 5427
name D.R. Lauck Oil Company
Wichita, KS

Wellsite Geologist Steve Miller
Phone 264-7433

PURCHASER Oil/Koch Oil Co. Gas/Cities Service

Designate Type of Completion

New Well Re-Entry Workover

Oil SWD Temp Abd
 Gas Inj Delayed Comp.
 Dry Other (Core, Water Supply etc.)

If OWWO: old well info as follows:

Operator
Well Name
Comp. Date Old Total Depth

WELL HISTORY

Drilling Method: Mud Rotary Air Rotary Cable

1/18/85 1/28/85 Drlg 1/28/85
Spud Date Date Reached TD On pump 3/14/85
Completion Date

4530 NA
Total Depth PBDT

Amount of Surface Pipe Set and Cemented at 260' feet

Multiple Stage Cementing Collar Used? Yes No

If Yes, Show Depth Set feet

If alternate 2 completion, cement circulated
from feet depth to w/ SX cmt

API NO. 15-017-21,065-0500

County Harper

100' West of
NE SE NE Sec 27 Twp 31S Rge 9W West

3630 Ft North from Southeast Corner of Section
430 Ft West from Southeast Corner of Section
(Note: locate well in section plat below)

Lease Name ROBINSON Well# #4

Field Name Spivey-Grabs Pool

Producing Formation Mississippian

Elevation: Ground 1632 KB 1639

Section Plat

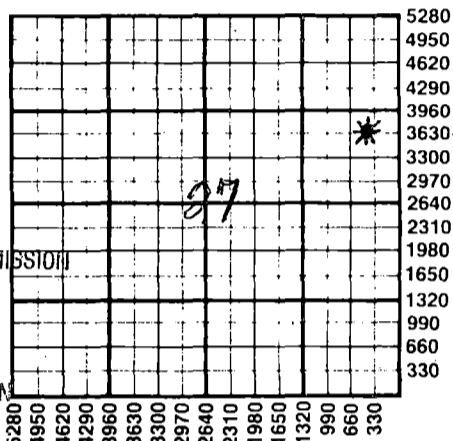

RECEIVED
STATE CORPORATION COMMISSION
MAY 06 1985
CONSERVATION DIVISION
Wichita, Kansas

WATER SUPPLY INFORMATION

Source of Water:

Division of Water Resources Permit #

Groundwater Ft North From Southeast Corner of (Well) Ft. West From Southeast Corner of
Sec Twp Rge East West

Surface Water Ft North From Southeast Corner and (Stream, Pond etc.) Ft West From Southeast Corner
Sec Twp Rge East West

Other (explain) (purchased from city, R.W.D.#)

Disposition of Produced Water: Disposal Repressuring

Docket #

INSTRUCTIONS: This form shall be completed in duplicate and filed with the Kansas Corporation Commission, 200 Colorado Derby Building, Wichita, Kansas 67202, within 90 days after completion or recompletion of any well. Rules 82-3-130 and 82-3-107 apply.

Information on side two of this form will be held confidential for a period of 12 months if requested in writing and submitted with the form. See rule 82-3-107 for confidentiality in excess of 12 months.

One copy of all wireline logs and drillers time log shall be attached with this form. Submit CP-4 form with all plugged wells. Submit CP-111 form with all temporarily abandoned wells.

All requirements of the statutes, rules, and regulations promulgated to regulate the oil and gas industry have been fully complied with and the statements herein are complete and correct to the best of my knowledge.

Signature Michael R. Kidwell
Title President Date May 2, 1985

Subscribed and sworn to before me this 2nd day of May 1985

Notary Public Patricia L. Ungleich
Date Commission Expires 3/27/87

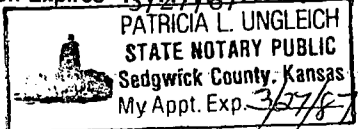

K.C.C. OFFICE USE ONLY
F Letter of Confidentiality Attached
C Wireline Log Received
C Drillers Timelog Received
Distribution
 KCC SWD/Rep NGPA
 KGS Plug Other (Specify)

Sec. 27 Twp. 31S Rge. 9W

SIDE TWO

Operator Name MULL DRILLING COMPANY Lease Name ROBINSON Well# 4 SEC 27 TWP. 31S RGE. 9W ~~West~~

WELL LOG

INSTRUCTIONS: Show important tops and base of formations penetrated. Detail all cores. Report all drill stem tests giving interval tested, time tool open and closed, flowing and shut-in pressures, whether shut-in pressure reached static level, hydrostatic pressures, bottom hole temperature, fluid recovery, and flow rates if gas to surface during test. Attach extra sheet if more space is needed. Attach copy of log.

Drill Stem Tests Taken Yes No
 Samples Sent to Geological Survey Yes No
 Cores Taken Yes No

Formation Description
 Log Sample

Name	Top	Bottom
Heebner	3487	-1848
Lansing	3653	-2014
Stark	4117	-2478
BKc	4215	-2576
Miss	4407	-2768
LTD	4530	-2891
RTD	4530	

DST #1 4412-4426/30-45-60-60
 Strong blow off bttm bucket 1"
 Strong blow throughout both flow pressures
 Rec: 1344' GIP
 110' very slightly oil & gas cut mud
 40' mud cut water
 ISIP 529 IFP 42-52 FFP 52-63 FSIP 635 BHT 115°

DST #2 4414-4441/30-45-60-60
 Strong blow throughout both openings
 GTS in 50 min.- FFP Gauge 6270 CFGPD
 Rec: 240' O&GCM
 120' Slightly oil cut water
 ISIP 625 IFP 74-95 FFP 105-137 FSIP 635 BHT 117°

DST #3 4442-4461/30-45-Lost pkr seat when tool opened for FFP - MISRUN

DST #4 4439-4468(Straddle)/30-45-60-60
 Strong blow throughout both openings
 Rec: 240' GCM
 340' G&MCW (SSO) Chl 35,000 ppm
 IFP & ISIP invalid - lost some mud when tool opened
 FFP 296-381 FSIP 836 BHT 121°

CASING RECORD <input type="checkbox"/> new <input type="checkbox"/> used							
Report all strings set - conductor, surface, intermediate, production, etc.							
Purpose of string	size hole drilled	size casing set (in O.D.)	weight lbs/ft.	setting depth	type of cement	# sacks used	type and percent additives
Surface	12 1/4"	8-5/8"	24#	260'	175 sx C1 'A'	2% gel	1.3% cc
Production	7-7/8"	4-1/2"	10 1/2#	4529'	125 sx 50-50 poz,	10% salt,	3/4% CFR2
					20 bbls salt flush,		
					25 sx scavenger cement		
PERFORATION RECORD				Acid, Fracture, Shot, Cement Squeeze Record			
shots per foot	specify footage of each interval perforated			(amount and kind of material used)			Depth
4408-4416 (4SRF)				Frac 5000# 20-40 sand	2/19		
				Ac w/500 gal 15% MA	2/18 & 2/27		
				Frac 5000# 20-40 sand	2/28/85		
TUBING RECORD				Liner Run <input type="checkbox"/> Yes <input type="checkbox"/> No			
size	set at	packer at					
Date of First Production	Producing method <input type="checkbox"/> flowing <input checked="" type="checkbox"/> pumping <input type="checkbox"/> gas lift <input type="checkbox"/> Other (explain)						
3/14/85							
Estimated Production Per 24 Hours	Oil	Gas	Water	Gas-Oil Ratio		Gravity	
	3 BOPD Bbls	30,000 CFGPD XXXX	20 BWPB Bbls	CFPB			

Disposition of gas: vented sold used on lease

METHOD OF COMPLETION open hole perforation other (specify) _____

PRODUCTION INTERVAL 4408-4416

Dually Completed.
 Commingled

Mull Drilling Company, Inc.
P.O. Box 2758
Wichita, Kansas 67201

Robinson #4
NE SE NE Sec. 27-31S-9W
Harper County, Kansas

Contractor: D. R. Lauck Oil Company, Inc.
221 S. Broadway, Suite 400
Wichita, Kansas 67202

Commenced: January 18, 1985
Completed: January 28, 1985

Drillers Log

Sand, Clay, Red Bed	263
Red Bed	1025
Shale & Shells	1640
Shale	3215
Shale & Lime	3880
Lime & Shale	4035
Lime	4530 RTD

Casing: 260' 8-5/8" cemented with 175 sacks Class A Cement,
2% Gel, 3% Calcium Chloride.
4-1/2" cemented with 25 sacks Class A Light HOWCO Cement,
125 sacks Class A 50-50 Pozmix Cement, 10% Salt,
3/4 of 1% CFR-2.

RECEIVED
STATE CORPORATION COMMISSION

MAY 06 1985

CONSERVATION DIVISION
Wichita, Kansas

PLAT AND CERTIFICATION OF ACREAGE ATTRIBUTABLE TO AN OIL WELL

State Corporation Commission, Conservation Division
200 Colorado Derby Bldg. Wichita, Kansas 67202

OPERATOR Mull Drilling Company, Inc.

LOCATION OF WELL:

LEASE Robinson

1650 feet from the North line

430 feet from the East line

WELL NUMBER 4

Of the NE/4 of Sec 27 T.31S R. 9W

FIELD Spivey-Grabs

COUNTY Harper County, Kansas

*NUMBER OF ACRES
ATTRIBUTABLE TO WELL 160

DESCRIPTION OF ACREAGE:

PLAT

(Show location of Well and outline attributable acreage)
(Show footage to nearest lease or unit boundary line)

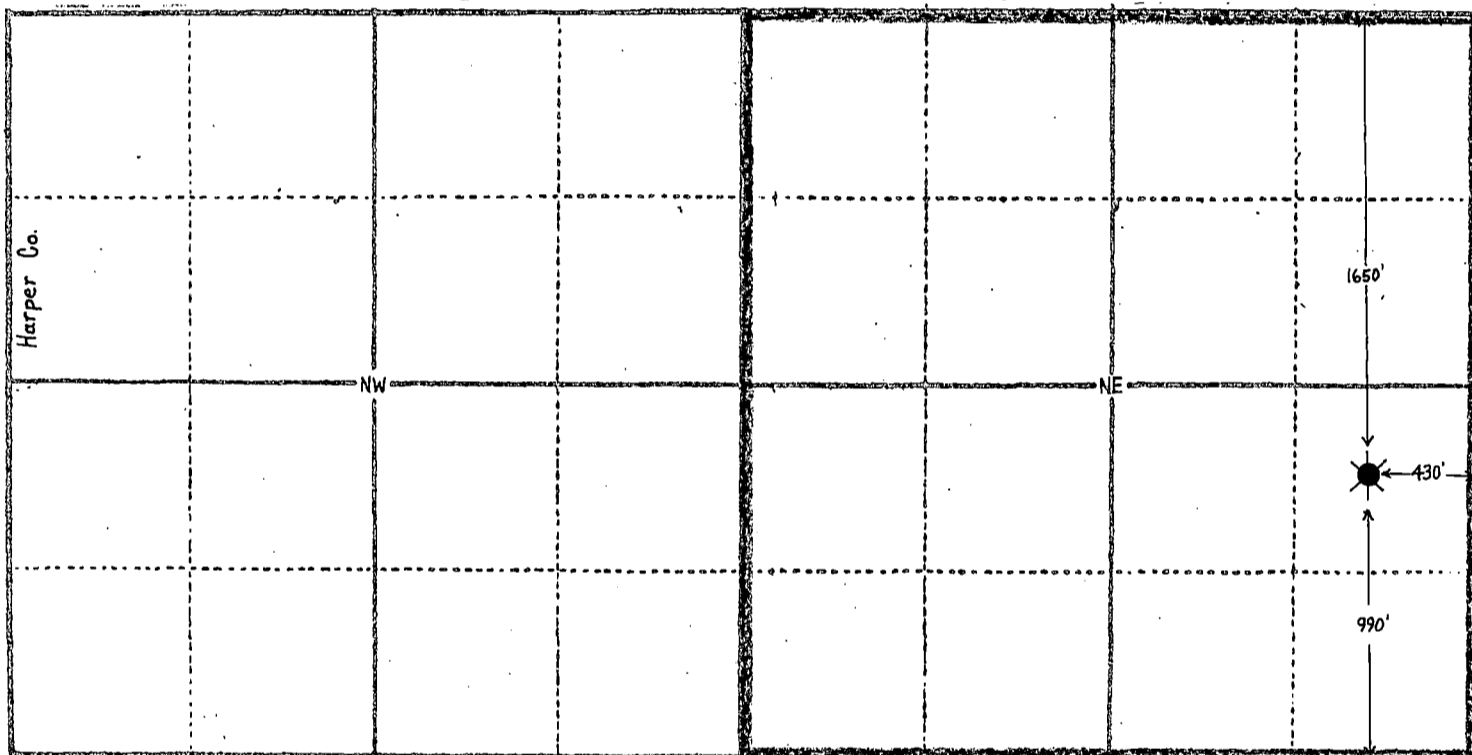

RECEIVED
STATE CORPORATION COMMISSION
CONS. DIV. WICHITA, KS

OCT 20 1986

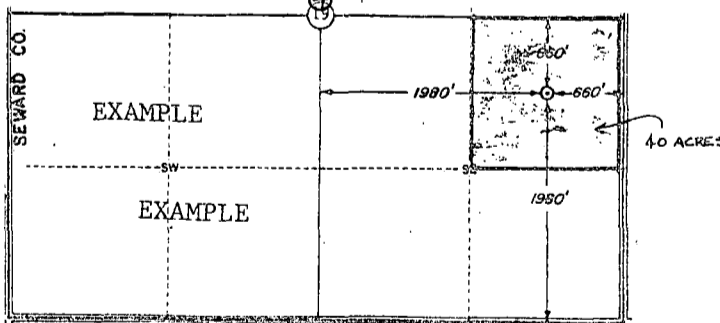

The undersigned hereby certifies that he is Land/Contract Manager
for Mull Drilling Company, Inc. a duly authorized agent, that all information
shown hereon is true and correct to the best of his knowledge and belief, and that
all acreage claimed as attributable to the well named herein is held by production
from that well.

Robert D. Swann
Robert D. Swann

Suscribed and sworn to before me on this 16th day of October, 19 86.

PATRICIA L. UNGLEICH
STATE NOTARY PUBLIC
Sedgwick County, Kansas
My Appt. Exp. _____

Patricia L. Ungleich
Patricia L. Ungleich
Notary Public

My Commission expires March 27, 1987

PLAT AND CERTIFICATION OF ACREAGE ATTRIBUTABLE TO AN OIL WELL

State Corporation Commission, Conservation Division
200 Colorado Derby Bldg. Wichita, Kansas 67202

OPERATOR Mull Drilling Company, Inc.

LOCATION OF WELL:

LEASE Robinson

1650 feet from the North line

430 feet from the East line

WELL NUMBER 4

Of the NE/4 of Sec 27 T.31S R. 9W

FIELD Spivey-Grabs

COUNTY Harper County, Kansas

*NUMBER OF ACRES
ATTRIBUTABLE TO WELL 160

DESCRIPTION OF ACREAGE:

P L A T

(Show location of Well and outline attributable acreage)
(Show footage to nearest lease or unit boundry line)

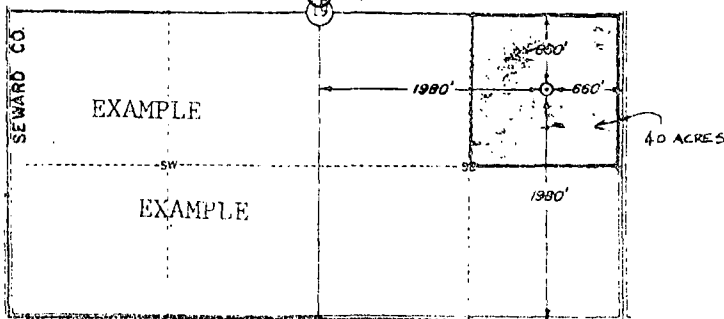
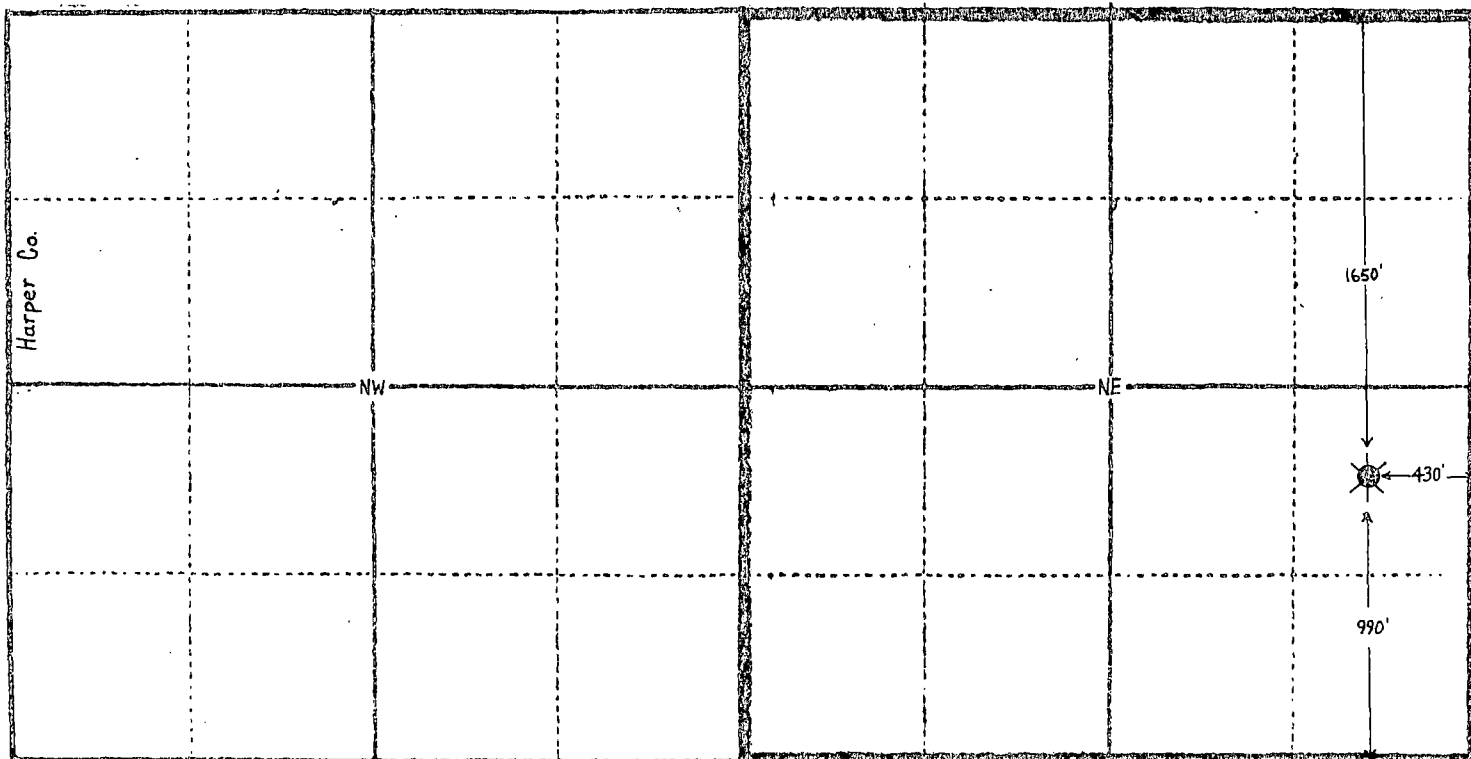

The undersigned hereby certifies that he is Land/Contract Manager
for Mull Drilling Company, Inc. a duly authorized agent, that all information
shown hereon is true and correct to the best of his knowledge and belief, and that
all acreage claimed as attributable to the well named herein is held by production
from that well.

RECEIVED
STATE CORPORATION COMMISSION
CONS. DIV. WICHITA, KS

Robert D. Swann
Robert D. Swann

Suscribed and sworn to before me on this 16th day of October, 19 86.

PATRICIA L. UNGLEICH
STATE NOTARY PUBLIC
Sedgwick County, Kansas
My Appt. Exp. _____

Patricia L. Ungleich
Patricia L. Ungleich
Notary Public

My Commission expires March 27, 1987