

15-025-20397-00-00

STATE OF KANSAS
STATE CORPORATION COMMISSION

WELL PLUGGING RECORD

Give All Information Completely
Make Required Affidavit
Mail or Deliver Report to
Conservation Division
State Corporation Comm.
245 North Water
Wichita, KS 67202

Clark County. Sec. 20 Twp. 34S Rge. 21 E/W
Location as "NE/CNW 1/4 SW 1/4" or footage from lines

C SW NE
Lease Owner Rine Drilling Company
Lease Name Shupe Well No. 1-20
Office Address Suite 600, 300 W. Douglas, Wichita, KS 67202
Character of Well (Completed as Oil, Gas or Dry Hole)

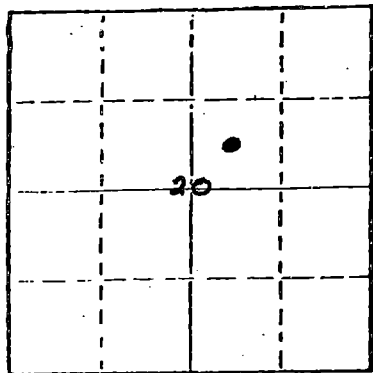

Locate well correctly on above
Section Plat

Plugged and Abandoned
Date Well completed June 21 1981
Application for plugging filed June 21 1981
Application for plugging approved June 21 1981
Plugging commenced June 21 1981
Plugging completed June 21 (3:15 p.m.) 1981
Reason for abandonment of well or producing formation
Could'nt get back in hole, bottom two joints of surface csg. of
If a producing well is abandoned, date of last production
N/A 19

Was permission obtained from the Conservation Division or
its agents before plugging was commenced? yes

Name of Conservation Agent who supervised plugging of this well Clarence Thomas, Jr.
Producing formation Depth to top Bottom Total Depth of Well
Show depth and thickness of all water, oil and gas formations. RTD 3855'

OIL, GAS OR WATER RECORDS

CASING RECORD

FORMATION	CONTENT	FROM	TO	SIZE	PUT IN	PULLED OUT
	Surface	0	700'	8 - 5/8"	yes	no

Describe in detail the manner in which the well was plugged, indicating where the mud fluid
was placed and the method or methods used in introducing it into the hold. If cement or other
plugs were used, state the character of same and depth placed, from feet to
feet for each plug set.

1st Plug @ 700' with 60 sacks
2nd Plug @ 40' - 0 with 10 sacks
10 sacks in rathole
5 sacks in mousehole / 5 sacks in water well
Job completed @ 3:15 p.m. 6/21/81

RECEIVED
STATE CORPORATION COMMISSION

(If additional description is necessary, use BACK of this sheet)

Name of Plugging Contractor DaMac Drilling, Inc.

7-1981
CONSERVATION DIVISION
Wichita, Kansas

STATE OF KANSAS COUNTY OF SEDGWICK
E. J. Rine (employee of owner) or (owner or operator)

of the above-described well, being first duly sworn on oath, says: That I have knowledge of
the facts, statements, and matters herein contained and the log of the above-described well
as filed and that the same are true and correct. So help me God.

(Signature) E. J. Rine
E. J. Rine, President
Suite 600, 300 W. Douglas, Wichita, KS 67202
(Address)

SUBSCRIBED AND SWORN TO before me this 22nd day of June, 1981.

Donna K. McKee
Notary Public.

My commission expires January 21, 1985.

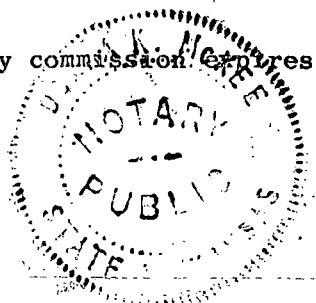

KANSAS

WELL COMPLETION REPORT AND
DRILLER'S LOG

S. 20 T. 34S R. 21 W ^{EX}

API No. 15 — 025 — 20,397 — 00-00
County Number

Loc. C SW NW

Operator

Rine Drilling Company

County Clark

Address

Suite 600, 300 W. Douglas, Wichita, KS 67202

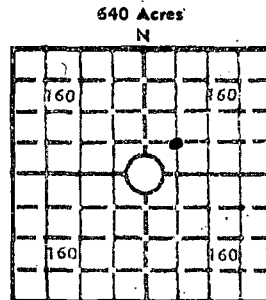

Well No.

1-20

Lease Name

Shupe

Footage Location

1980' FNL

feet from (N) line

1980' FEL

feet from (E) line

Principal Contractor

DaMac

Geologist

Bill Sladek

Spud Date

6-15-81

Date Completed

6-21-81

Total Depth

722'

P.B.T.D.

N/A

Directional Deviation

N/A

Oil and/or Gas Purchaser

P & A (SKID RIG)

Elev.: Gr. 1775'

DF 1786' KB 1788'

CASING RECORD

Report of all strings set — surface, intermediate, production, etc.

Purpose of string	Size hole drilled	Size casing set (in O.D.)	Weight lbs/ft.	Setting depth	Type cement	Sacks	Type and percent additives
Conductor		20"	24#	82'	Common	300 sx	
Surface	12 1/4"	8 5/8"	23#	811'	Lite Cement	600 sx	HLC - 3% cc.; 2% 1/2# Flo-cele CH
Intermediate	17 1/4"	13 3/8"	48#	322'	Common	800 sx	3% cc; 2% gel.

LINER RECORD

PERFORATION RECORD

Top, ft.	Bottom, ft.	Sacks cement	Shots per ft.	Size & type	Depth interval
N/A			N/A		

Size	Setting depth	Packer set at
N/A		

ACID, FRACTURE, SHOT, CEMENT SQUEEZE RECORD

Amount and kind of material used	Depth interval treated
N/A	N/A

INITIAL PRODUCTION

Date of first production		Producing method (flowing, pumping, gas lift, etc.)			
N/A		N/A			
RATE OF PRODUCTION PER 24 HOURS	Oil	Gas	Water	Gas-oil ratio	
	N/A	N/A	N/A	N/A	
	bbfs.	MCF	bbfs.	CFPB	
Disposition of gas (vented, used on lease or sold)			Producing interval(s)		
N/A			N/A		

INSTRUCTIONS: As provided in KCC Rule 82-2-125, within 90 days after completion of a well, one completed copy of this Drillers Log shall be transmitted to the State Geological Survey of Kansas, 4150 Monroe Street, Wichita, Kansas 67209. Copies of this form are available from the Conservation Division, State Corporation Commission, 245 No. Water, Wichita, Kansas 67202. Phone AC 316-522-2206. If confidential custody is desired, please note Rule 82-2-125. Drillers Logs will be on open file in the Oil and Gas Division, State Geological Survey of Kansas, Lawrence, Kansas 66044.

Operator Rine Drilling Company		DESIGNATE TYPE OF COMP.: OIL, GAS, DRY HOLE, SWDW, ETC.: P & A
Well No. 1-20	Lease Name Shupe	
S 20 T 34S R 21 EX W		

WELL LOG

Show all important zones of porosity and contents thereof; cored intervals, and all drill-stem tests, including depth interval tested, cushion used, time tool open, flowing and shut-in pressures, and recoveries.

SHOW GEOLOGICAL MARKERS, LOGS RUN, OR OTHER DESCRIPTIVE INFORMATION.

FORMATION DESCRIPTION, CONTENTS, ETC.	TOP	BOTTOM	NAME	DEPTH
<p>N/A</p> <p>Plugged & Abandoned 1st plug @ 950' with 35 sacks 2nd plug @ 800' with 35 sacks Bridge @ 40' with 10 sacks 5 sacks in Rathole</p> <p>Plugging information previously submitted.</p>				

USE ADDITIONAL SHEETS, IF NECESSARY, TO COMPLETE WELL RECORD.

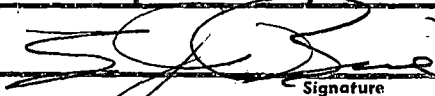
Date Received	 Signature
	E. J. Rine, President
	Title
	August 18, 1981
	Date

15-025-20397-00-00

Shupe 1-20

C SW NE
Sec. 20-34S-21W
Clark County, Kansas

Started: June 4, 1981

Completed: June 21, 1981

Surface 0 - 722'

20" Conductor set @ 82' by Haliburton with 300 sacks. Ran 13 3/8" csg., set @ 322' w/ 800 sx, 1" 100 sx.; 8 5/8" 23# @ 811' w/500 sx HLU - 3% cc. 1/4# FC - 100 sx CH-2%. 8 5/8" csg. could'nt get back in hole, bottom two joints of surface csg. off. 722' bit stopped. plugged hole.

STATE OF KANSAS)
) ss:
SEDGWICK COUNTY)

I, E. J. Rine, do hereby certify that the above is a true and accurate log of the Shupe #1-20, located C SW NE, Sec. 20-34S-21W, Clark County, Kansas.

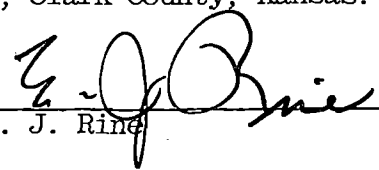
E. J. Rine

Subscribed and sworn to before me this 3rd day of July, 1981.

My commission expires: January 21, 1985

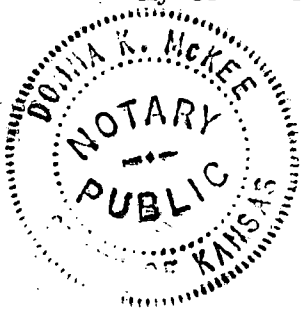

RECEIVED 
Donna K. McKee, Notary Public
STATE CORPORATION COMMISSION

JUL - 7 1981

CONSERVATION DIVISION
Wichita, Kansas