

2/4/85

STATE CORPORATION COMMISSION OF KANSAS
OIL & GAS CONSERVATION DIVISION

WELL COMPLETION OR RECOMPLETION FORM
ACO-1 WELL HISTORY

DESCRIPTION OF WELL AND LEASE

Operator: License # 8758
Name Raw Energy Corporation
Address 7200 West 13th
Suite 8
City/State/Zip Wichita, Kansas 67212

Purchaser Colony Natural Gas
P.O. Box 50550 Midland, TX

Operator Contact Person Benny Green
Phone (316)722-6382

Contractor: License # 5879
Name J. B. Bohannon Drilling, Inc.

Wellsite Geologist Mark Rogers
Phone (316)722-6382

Designate Type of Completion
 New Well Re-Entry Workover
 Oil SWD Temp Abd
 Gas Inj Delayed Comp.
 Dry Other (Core, Water Supply etc.)

If OWWO: old well info as follows:
Operator
Well Name
Comp. Date Old Total Depth

WELL HISTORY

Drilling Method:
 Mud Rotary Air Rotary Cable
1/17/85 1/29/85 2/4/85
Spud Date Date Reached TD Completion Date
5904 5849
Total Depth PBT

Amount of Surface Pipe Set and Cemented at 1446 feet
Multiple Stage Cementing Collar Used? Yes No
If yes, show depth set feet
If alternate 2 completion, cement circulated from feet depth to w/SX cmt

API NO. 15-119-20694-00-00
County Meade
SE NW Sec. 21 Twp. 33 Rge. 28 East West

3150 Ft North from Southeast Corner of Section
3150 Ft West from Southeast Corner of Section
(Note: Locate well in section plat below)

Lease Name Heinson Well # 1-21

Field Name Wildcat

Producing Formation Morrow

Elevation: Ground 2514 KB 2526

Section Plat

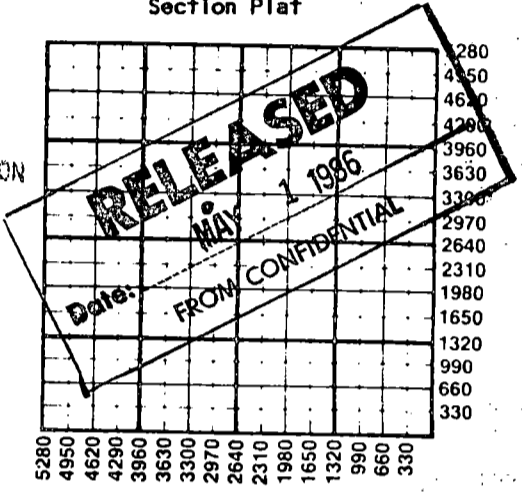

WATER SUPPLY INFORMATION

Disposition of Produced Water: Disposal Repressuring
Docket #

Questions on this portion of the ACO-1 call:
Water Resources Board (913) 296-3717

Source of Water:
Division of Water Resources Permit #
 Groundwater Ft North from Southeast Corner (Well) Ft West from Southeast Corner of Sec 21 Twp 33 Rge 28 East West
 Surface Water Ft North from Southeast Corner (Stream, pond etc) Ft West from Southeast Corner Sec Twp Rge East West
 Other (explain) (purchased from city, R.W.D. #)

INSTRUCTIONS: This form shall be completed in duplicate and filed with the Kansas Corporation Commission, 200 Colorado Derby Building, Wichita, Kansas 67202, within 90 days after completion or recompletion of any well. Rule 82-3-130 and 82-3-107 apply. Information on side two of this form will be held confidential for a period of 12 months if requested in writing and submitted with the form. See rule 82-3-107 for confidentiality in excess of 12 months. One copy of all wireline logs and drillers time log shall be attached with this form. Submit CP-4 form with all plugged wells. Submit CP-111 form with all temporarily abandoned wells.

All requirements of the statutes, rules and regulations promulgated to regulate the oil and gas industry have been fully complied with and the statements herein are complete and correct to the best of my knowledge.

Signature Benny Green

Title District Manager Date 2/14/85

Subscribed and sworn to before me this 14th day of February 1985
Notary Public Carla M. Parker

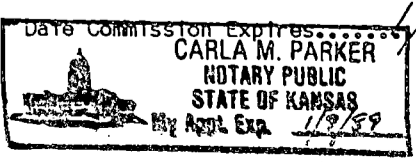

K.C.C. OFFICE USE ONLY
 Letter of Confidentiality Attached
 Wireline Log Received
 Drillers Timelog Received
Distribution
 KCC SWD/Rep NGPA
 KGS Plug Other
FEB 15 1985 (Specify)

State Geological Survey
WICHITA BRANCH

Sec. 21 Twp. 33 Rge. 28 W

SIDE TWO

Operator Name Raw Energy Corporation of Ks. Lease Name Heinson Well # 1-21

Sec. 21 Twp. 33 Rge. 28 East West County Meade

WELL LOG

INSTRUCTIONS: Show important tops and base of formations penetrated. Detail all cores. Report all drill stem tests giving interval tested, time tool open and closed, flowing and shut-in pressures, whether shut-in pressure reached static level, hydrostatic pressures, bottom hole temperature, fluid recovery, and flow rates if gas to surface during test. Attach extra sheet if more space is needed. Attach copy of log.

Drill Stem Tests Taken Yes No
 Samples Sent to Geological Survey Yes No
 Cores Taken Yes No

Formation Description
 Log Sample

DST #1
 5710' - 80'
 30" 30" 45" 45"

IHP 2687#
 IFP 863#-944#
 ISIP 1372#
 FFP 960 - 954
 FSIP 1336
 FHP 2576

GTS in 2 minutes, gauged at 4,468 mmcfd.

100' watery condensate.

Name	Top Log Tops	Bottom Sample Tops
Heebner	4454	4450
Lansing		
Kansas City	4631	4627
Marmanton	5251	5248
Cherokee	5419	5417
Morrow Shale	5725	5723
Morrow Sand	5729	5732
Chester	5784	5779

RECEIVED
 STATE CORPORATION COMMISSION

FEB 15 1985

RELEASED

CONSERVATION DIVISION
 Wichita, Kansas

JUN 05 1986

CASING RECORD <input checked="" type="checkbox"/> New <input type="checkbox"/> Used				FROM CONFIDENTIAL			
Report all strings set-conductor, surface, intermediate, production, etc.							
Purpose of String	Size Hole Drilled	Size Casing Set (in O.D.)	Weight Lbs/Ft.	Setting Depth	Type of Cement	#Sacks Used	Type and Percent Additives
Surface	12 1/4"	8 5/8"	24#	1456'	HAL LIGHT CLASS H	575	2% CC
Production	7 7/8"	4 1/2"	10.5#	5890'	CLASS H	150	3% CC
						100	5% KCL 5% HAL 322
PERFORATION RECORD				Acid, Fracture, Shot, Cement Squeeze Record			
Shots Per Foot	Specify Footage of Each Interval Perforated			(Amount and Kind of Material Used)			Depth
4	5729-33			NONE			
4	5752-62			NONE			
TUBING RECORD				Liner Run <input type="checkbox"/> Yes <input checked="" type="checkbox"/> No			
Size	Set At	Packer at					
2 3/8"	5724	N/A					
Date of First Production	Producing Method <input checked="" type="checkbox"/> Flowing <input type="checkbox"/> Pumping <input type="checkbox"/> Gas Lift <input type="checkbox"/> Other (explain).....						
Estimated Production Per 24 Hours	Oil	Gas	Water	Gas-Oil Ratio	Gravity		
	Bbls	1,500 MCF	Bbls	CFPB			

METHOD OF COMPLETION

Production Interval

Disposition of gas: Vented Open Hole Perforation
 Sold Other (Specify)
 Used on Lease Dually Completed Commingled

5729-33' 5752-62'