

STATE OF KANSAS
STATE CORPORATION COMMISSION

WELL PLUGGING RECORD/Revises Report of May 11, 1978

Give All Information Completely
Make Required Affidavit
Mail or Deliver Report to
Conservation Division
State Corporation Comm.
245 North Water
Wichita, KS 67202

Stevens County, Sec. 35 Twp. 33S Rge. 39 ~~X~~/W
Location as "NE/CNW $\frac{1}{4}$ SW $\frac{1}{4}$ " or footage from lines
1250' FEL & 2570' FSL

Lease Owner Anadarko Production Company
Lease Name SLEASE "A" Well No. 1
Office Address P. O. Box 351 Liberal, Kansas 67901
Character of Well (Completed as Oil, Gas or Dry Hole)
Dry Hole

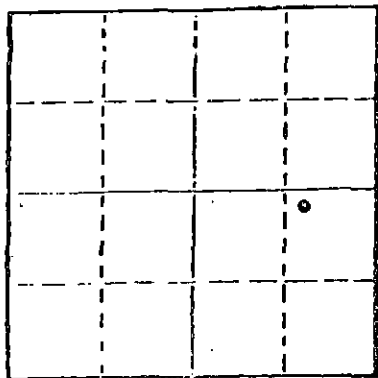

Locate well correctly on above
Section Plat

Date Well completed 1-9 1978
Application for plugging filed verbally 1-9 ** 1978
Application for plugging approved 1-9 1978
Plugging commenced 1-9 1978
Plugging completed 1-9 1978
Reason for abandonment of well or producing formation
mechanical problems

If a producing well is abandoned, date of last production
19

Was permission obtained from the Conservation Division or
its agents before plugging was commenced? yes-verbally

Name of Conservation Agent who supervised plugging of this well Clarence Thomas, Jr.
Producing formation _____ Depth to top _____ Bottom _____ Total Depth of Well 1396'
Show depth and thickness of all water, oil and gas formations.

OIL, GAS OR WATER RECORDS

CASING RECORD

FORMATION	CONTENT	FROM	TO	SIZE	PUT IN	PULLED OUT
				NONE		

Describe in detail the manner in which the well was plugged, indicating where the mud fluid
was placed and the method or methods used in introducing it into the hold. If cement or other
plugs were used, state the character of same and depth placed, from _____ feet to
_____ feet for each plug set.

Filled 600 sxs common cmt from 1100' to 3'.

RECEIVED
STATE CORPORATION COMMISSION

DEC 19 1978

CONSERVATION DIVISION
Wichita, Kansas

(If additional description is necessary, use BACK of this sheet)

Name of Plugging Contractor Rotary-Rains & Williamson Oil Co., Inc.

STATE OF KANSAS COUNTY OF SEWARD, ss.
Paul Campbell (employee of owner) or ~~xxxxxx~~

of the above-described well, being first duly sworn on oath, says: That I have knowledge of
the facts, statements, and matters herein contained and the log of the above-described well
as filed and that the same are true and correct. So help me God.

(Signature) *Paul Campbell*

(Address) _____
Beverly J. Williams
Notary Public.

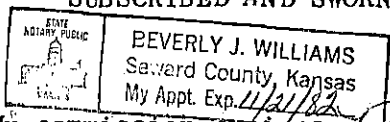
SUBSCRIBED AND SWORN TO before me this 18th day of December, 1978

My commission expires December 21, 1982

**Revised application filed 12-15-78.

KANSAS DRILLERS LOG Revises Report of May 11, 1978

S. 35 T. 33S R. 39 ^W
 Loc. 2570' FSL & 1250' FEL
 County Stevens

API No. 15 — 189 — 20,375
 County Number

Operator
Anadarko Production Company
 Address
P. O. Box 351 Liberal, Kansas 67901

Well No. 1 Lease Name SLEASE "A"

Footage Location
2570 feet from (N) (S) line 1250 feet from (E) (W) line

Principal Contractor Rains & Williamson Oil Co., Inc. Geologist

Spud Date 12-29-77 Total Depth 1396' P.B.T.D.

Date Completed 1-9-78 Oil Purchaser

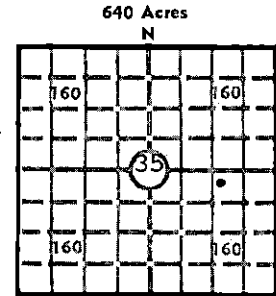

Locate well correctly
3238'
 Elev.: Gr. _____
 DF _____ KB _____

CASING RECORD

Report of all strings set— surface, intermediate, production, etc.

Purpose of string	Size hole drilled	Size casing set (in O.D.)	Weight lbs/ft.	Setting depth	Type cement	Sacks	Type and percent additives

LINER RECORD

PERFORATION RECORD

Top, ft.	Bottom, ft.	Sacks cement	Shots per ft.	Size & type	Depth interval

Size	Setting depth	Packer set at

ACID, FRACTURE, SHOT, CEMENT SQUEEZE RECORD

Amount and kind of material used	Depth interval treated

STATE RECEIVED
 CORPORATION COMMISSION
 DEC 19 1978
 CONSERVATION DIVISION
 Wichita, Kansas

INITIAL PRODUCTION

Date of first production <u>Dry Hole</u>	Producing method (flowing, pumping, gas lift, etc.)				
RATE OF PRODUCTION PER 24 HOURS	Oil	Gas	Water	Gas-oil ratio	
	bbbs.	MCF	bbbs.	CFPB	
Disposition of gas (vented, used on lease or sold)			Producing interval (s)		

INSTRUCTIONS: As provided in KCC Rule 82-2-125, within 90 days after completion of a well, one completed copy of this Drillers Log shall be transmitted to the State Geological Survey of Kansas, 4150 Monroe Street, Wichita, Kansas 67209. Copies of this form are available from the Conservation Division, State Corporation Commission, 3830 So. Meridian (P.O. Box 17027), Wichita, Kansas 66217. Phone AC 316-522-2206. If confidential custody is desired, please note Rule 82-2-125. Drillers Logs will be on open file in the Oil and Gas Division, State Geological Survey of Kansas, Lawrence, Kansas 66044.

Operator
Anadarko Production Company

DESIGNATE TYPE OF COMP.: OIL, GAS, DRY HOLE, SWDW, ETC.:

Well No. 1 Lease Name SLEASE "A" Dry Hole

S 35 T 33S R 39 E W

WELL LOG

Show all important zones of porosity and contents thereof; cored intervals, and all drill-stem tests, including depth interval tested, cushion used, time tool open, flowing and shut-in pressures, and recoveries.

SHOW GEOLOGICAL MARKERS, LOGS RUN, OR OTHER DESCRIPTIVE INFORMATION.

FORMATION DESCRIPTION, CONTENTS, ETC.	TOP	BOTTOM	NAME	DEPTH
Sand, Clay & Redbed	0	679		
Redbed & Sand	679	1396		
TD	1396			
PLUGGED & SKIDDED RIG 150' NORTH				

USE ADDITIONAL SHEETS, IF NECESSARY, TO COMPLETE WELL RECORD.

Date Received

Paul Campbell
Paul Campbell Signature
Division Production Manager Title
December 15, 1978 Date