

STATE OF KANSAS
STATE CORPORATION COMMISSION

WELL PLUGGING RECORD

Give All Information Completely
Make Required Affidavit
Mail or Deliver Report to
Conservation Division
State Corporation Comm.
245 North Water
Wichita, KS 67202

Stevens County, Sec. 23 Twp. 33S Rge. 38 E/W
Location as "NE/CNW 1/4 SW 1/4" or footage from lines
1250' FNL & 1400' FEL

Lease Owner Anadarko Production Company
Lease Name DUNNE-HOFFMAN "C" Well No. 2
Office Address P. O. Box 351, Liberal, Kansas 67901
Character of Well (Completed as Oil, Gas or Dry Hole)

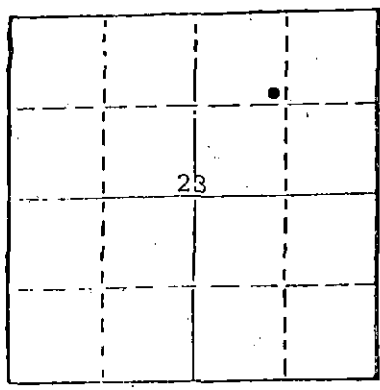

Locate well correctly on above
Section Plot

Dry Hole
Date Well completed 11/26 1979
Application for plugging filed 10/24 1979
Application for plugging approved 10/25 1979
Plugging commenced 11/26 1979
Plugging completed 11/26 1979

Reason for abandonment of well or producing formation
Dry Hole
If a producing well is abandoned, date of last production 19

Was permission obtained from the Conservation Division or
its agents before plugging was commenced? Yes

Name of Conservation Agent who supervised plugging of this well Clarence Thomas
Producing formation Morrow Depth to top 6088' Bottom 6100' Total Depth of Well 6200'
Show depth and thickness of all water, oil and gas formations.

OIL, GAS OR WATER RECORDS

CASING RECORD

FORMATION	CONTENT	FROM	TO	SIZE	PUT IN	PULLED OUT
Morrow	water	6088'	6100'	8-5/8"	1707'	0
				4-1/2"	6198'	0

Describe in detail the manner in which the well was plugged, indicating where the mud fluid
was placed and the method or methods used in introducing it into the hold. If cement or other
plugs were used, state the character of same and depth placed, from feet to
feet for each plug set.

Mixed 20 sxs cmt, pmp plug to 5850, 35 sxs cmt 1809-1609, 5 sxs 40-0 w/hvy mud between
all plugs.

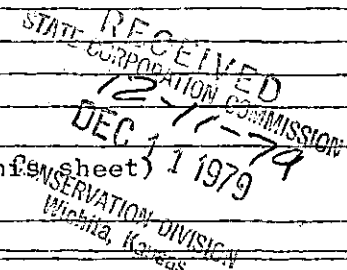

(If additional description is necessary, use BACK of this sheet)

Name of Plugging Contractor Sargents Casing Pullers Service

STATE OF KANSAS COUNTY OF SEWARD, ss.
Paul Campbell (employee of owner) or ~~XXXXXXXXXXXXXXXXXXXX~~

of the above-described well, being first duly sworn on oath, says: That I have knowledge of
the facts, statements, and matters herein contained and the log of the above-described well
as filed and that the same are true and correct. So help me God.

(Signature) Paul Campbell
P. O. Box 351, Liberal, Kansas 67901
(Address)

SUBSCRIBED AND SWORN TO before me this 10th day of December, 1979

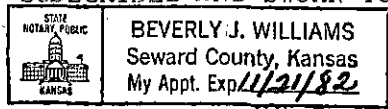

Beverly J. Williams
Notary Public.

My commission expires November 21, 1982

15-189-20441-0000

KANSAS

WELL COMPLETION REPORT AND DRILLER'S LOG

S. 23 T. 33S R. 38 W
 Loc. 1250' FNL & 1400' FEL
 County Stevens

API No. 15 — 189 — 20,441
 County Number

Operator
 Anadarko Production Company

Address
 P. O. Box 351, Liberal, Kansas 67901

Well No. 2 Lease Name DUNNE-HOFFMAN "C"

Footage Location
 1250 feet from (N) line 1400 feet from (E) line

Principal Contractor Lohmann-Johnson Drlg Co. Geologist Joe Blair

Spud Date 3/5/79 Date Completed 11/26/79 Total Depth 6200' P.B.T.D. 6126'

Directional Deviation 3/4 deg @ 6200' Oil and/or Gas Purchaser None

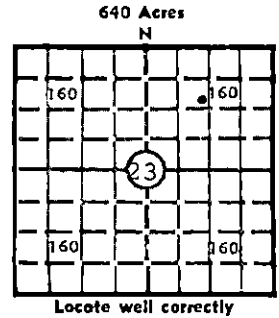

Locate well correctly
 Elev.: Gr. 3148'
 DF 3157' KB 3158'

CASING RECORD

Report of all strings set — surface, intermediate, production, etc.

Purpose of string	Size hole drilled	Size casing set (in O.D.)	Weight lbs/ft.	Setting depth	Type cement	Sacks	Type and percent additives
Surface	12-1/4"	8-5/8"	24#	1707	Pozmix Common	600 200	4% gel 2% CaCl 3% CaCl
Production	7-7/8"	4-1/2"	10.5#	6198	Pozmix First Stage	160	SS .05% CFR-2
DV Tool				3135	2nd Lite-wate stage Pozmix	500 150	4% gel SS .05% CFR-2

LINER RECORD

PERFORATION RECORD

Top, ft.	Bottom, ft.	Sacks cement	Shots per ft.	Size & type	Depth interval
			2	3-1/8" csg gun	6088-6100'

TUBING RECORD

Size	Setting depth	Packer set at

ACID, FRACTURE, SHOT, CEMENT SQUEEZE RECORD

Amount and kind of material used	Depth interval treated
A/1200 gal 7.5% HCS	6088-6100'

INITIAL PRODUCTION

Date of first production Dry Hole Producing method (flowing, pumping, gas lift, etc.) Swabbing

RATE OF PRODUCTION PER 24 HOURS	Oil	Gas	Water	Gas-oil ratio
	---	---	27	---

Disposition of gas (vented, used on lease or sold) Dry Hole Producing interval (s) 6088-6100'

STATE RECEIVED
 CORPORATION COMMISSION
 DEC 11 1979
 CONSERVATION DIVISION
 Wichita, Kan.

INSTRUCTIONS: As provided in KCC Rule 82-2-125, within 90 days after completion of a well, one completed copy of this Drillers Log shall be transmitted to the State Geological Survey of Kansas, 4150 Monroe Street, Wichita, Kansas 67209. Copies of this form are available from the Conservation Division, State Corporation Commission, 245 No. Water, Wichita, Kansas 67202. Phone AC 316-522-2206. If confidential custody is desired, please note Rule 82-2-125. Drillers Logs will be on open file in the Oil and Gas Division, State Geological Survey of Kansas, Lawrence, Kansas 66044.

Operator Anadarko Production Company		DESIGNATE TYPE OF COMP.: OIL, GAS, DRY HOLE, SWDW, ETC.:
Well No. 2	Lease Name DUNNE-HOFFMAN "C"	DRY HOLE
S 23 T 33S R 38 ^{Ex} _W		

WELL LOG

Show all important zones of porosity and contents thereof; cored intervals, and all drill-stem tests, including depth interval tested, cushion used, time tool open, flowing and shut-in pressures, and recoveries.

SHOW GEOLOGICAL MARKERS, LOGS RUN, OR OTHER DESCRIPTIVE INFORMATION.

FORMATION DESCRIPTION, CONTENTS, ETC.	TOP	BOTTOM	NAME	DEPTH
Sand	0'	540'	LOGS: Schlumberger Dual Induction-SFL Compensated Neutron- Formation Density	
Redbed	540'	825'		
Sand, Redbed	825'	1180'		
Sand, Shale	1180'	1707'		
Shale	1707'	2270'		
Lime, Shale	2270'	2545'		
Shale	2545'	2780'		
Lime, Shale	2780'	6170'		
Lime	6170'	6205'		

USE ADDITIONAL SHEETS, IF NECESSARY, TO COMPLETE WELL RECORD.

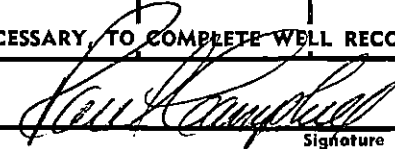
Date Received	 Signature
	Paul Campbell, Division Production Manager Title
	December 5, 1979 Date

LOHMANN - JOHNSON

Drilling Company, Inc.



OFFICES IN
EVANSVILLE, INDIANA
OKLAHOMA CITY, OKLAHOMA

1108 Old National Bank Bldg.
Evansville, Indiana 47708

April 3, 1979

ANADARKO PRODUCTION COMPANY
Box 351
Liberal, Kansas 67901
Attn: Paul Gatlin

Drillers Log for: Dunne-Hoffman C #2

- 0' - 540' Sand
- 540' - 825' Redbed
- 825' - 1180' Sand, Redbed
- 1180' - 1707' Sand, Shale
- 1707' - 2270' Shale
- 2270' - 2545' Lime, Shale
- 2545' - 2780' Shale
- 2780' - 6170' Lime, Shale
- 6170' - 6205' Lime

LOHMANN-JOHNSON DRILLING COMPANY

Signed By:

Curtis A. Schieble
Curtis A. Schieble, Vice President

State of Indiana
County of Vanderburgh

Subscribed and sworn to before me this 3rd day of April, a979.

Anna Lee Kerkwood Notary Public.

My commission expires 12/19/79.

RECEIVED
OCT 25 1979
CONSERVATION DIVISION
Wichita, Kansas
WICHITA CONSERVATION COMMISSION