

STATE OF KANSAS
STATE CORPORATION COMMISSION

WELL PLUGGING RECORD

Give All Information Completely
Make Required Affidavit
Mail or Deliver Report to
Conservation Division
State Corporation Comm.
245 North Water
Wichita, KS 67202

Morton County, Sec. 7 Twp. 33S Rge. 40 E/W
Location as "NE/CNW 1/4 SW 1/4" or footage from lines
660' ESL & 1980' FWL
Lease Owner ANADARKO PRODUCTION COMPANY
Lease Name LOW "E" Well No. 6
Office Address P. O. Box 351, Liberal, Kansas 67901
Character of Well (Completed as Oil, Gas or Dry Hole)
Dry Hole
Date Well completed 3/25 1977
Application for plugging filed Verbally 3/24 1977
Application for plugging approved 3/24 1977
Plugging commenced 3/24 1977
Plugging completed 5:45 AM #/25 1977
Reason for abandonment of well or producing formation

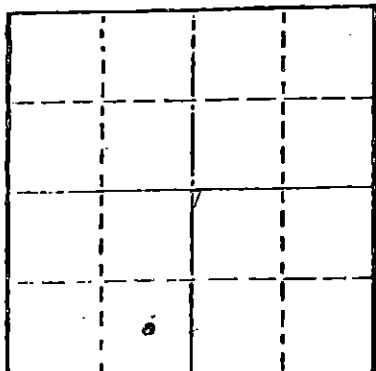

Locate well correctly on above
Section Plat

If a producing well is abandoned, date of last production 19

Was permission obtained from the Conservation Division or its agents before plugging was commenced? Yes

Name of Conservation Agent who supervised plugging of this well Clarence Thomas
Producing formation Depth to top Bottom Total Depth of Well 5400'
Show depth and thickness of all water, oil and gas formations.

OIL, GAS OR WATER RECORDS

CASING RECORD

FORMATION	CONTENT	FROM	TO	SIZE	PUT IN	PULLED OUT
				8-5/8	1572'	

Describe in detail the manner in which the well was plugged, indicating where the mud fluid was placed and the method or methods used in introducing it into the hold. If cement or other plugs were used, state the character of same and depth placed, from feet to feet for each plug set.

Spotted 35 sxs cmt. 2500', 50 sxs 1625-1525', 15 sxs 30-0', comp 5:45 AM 3/25/77

RECEIVED
STATE CORPORATION COMMISSION

MAY 11 1977

CONSERVATION DIVISION
Wichita, Kansas

(If additional description is necessary, use BACK of this sheet)

Name of Plugging Contractor Cabbert-Jones, Inc.

STATE OF KANSAS COUNTY OF SEWARD, ss.
Stanley R. Shoemaker (employee of owner) or (owner or operator)
of the above-described well, being first duly sworn on oath, says: That I have knowledge of the facts, statements, and matters herein contained and the log of the above-described well as filed and that the same are true and correct. So help me God.

(Signature) Stanley R. Shoemaker
Stanley R. Shoemaker, Division Office Manager
P. O. Box 351 (Address) Liberal, Ks. 67901

SUBSCRIBED AND SWORN TO before me this 10th day of May, 1977

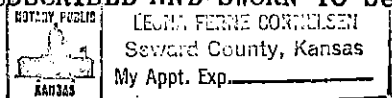

Leona Ferne Cornelsen
Notary Public.

My commission expires June 23, 1980

15-129-20300-0000

KANSAS DRILLERS LOG

S. 7 T. 33S R. 40 ^W
 Loc. 660' FSL & 1980' FWL
 County MORTON

API No. 15 — 129 County — 20,300 Number

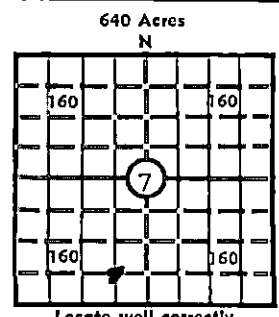

Elev.: Gr. 3345'
 DF _____ KB _____

Operator
ANADARKO PRODUCTION COMPANY

Address
P. O. BOX 351, LIBERAL, KANSAS 67901

Well No. 6 Lease Name LOW "E"

Footage Location
660 feet from (N) (S) line 1980 feet from (E) (W) line

Principal Contractor GABBERT-JONES, INC. Geologist (Contract Consultant) BOB POSEY

Spud Date 1 PM 3/8/77 Total Depth 5400' P.B.T.D. _____

Date Completed 3/25/77 Oil Purchaser _____

CASING RECORD

Report of all strings set — surface, intermediate, production, etc.

Purpose of string	Size hole drilled	Size casing set (in O.D.)	Weight lbs/ft.	Setting depth	Type cement	Sacks	Type and percent additives
Surface	12-1/4"	8-5/8"	24#	1572'	Poz Common	550 200	4% gel 2% cc

LINER RECORD

PERFORATION RECORD

Top, ft.	Bottom, ft.	Sacks cement	Shots per ft.	Size & type	Depth interval

TUBING RECORD

Size	Setting depth	Packer set at

ACID, FRACTURE, SHOT, CEMENT SQUEEZE RECORD

Amount and kind of material used	Depth interval treated

RECEIVED
 STATE CORPORATION COMMISSION

MAY 11 1977

CONSERVATION DIVISION
 Wichita, Kansas INITIAL PRODUCTION

Date of first production _____ Producing method (flowing, pumping, gas lift, etc.) _____

RATE OF PRODUCTION PER 24 HOURS
 Oil _____ bbls. Gas _____ MCF Water _____ Gas-oil ratio _____ CFPB

Disposition of gas (vented, used on lease or sold) _____ Producing interval (s) _____

INSTRUCTIONS: As provided in KCC Rule 82-2-125, within 90 days after completion of a well, one completed copy of this Drillers Log shall be transmitted to the State Geological Survey of Kansas, 4150 Monroe Street, Wichita, Kansas 67209. Copies of this form are available from the Conservation Division, State Corporation Commission, 3830 So. Meridian (P.O. Box 17027), Wichita, Kansas 66217. Phone AC 316-522-2206. If confidential custody is desired, please note Rule 82-2-125. Drillers Logs will be on an open file in the Oil and Gas Division, State Geological Survey of Kansas, Lawrence, Kansas 66044.

Operator ANADARKO PRODUCTION COMPANY DESIGNATE TYPE OF COMP.: OIL, GAS, DRY HOLE, SWDW, ETC.: DRY HOLE

Well No. 6 Lease Name LOW "E"

\$7 T33S R 40 ^{EX} W

WELL LOG
 Show all important zones of porosity and contents thereof; cored intervals, and all drill-stem tests, including depth interval tested, cushion used, time tool open, flowing and shut-in pressures, and recoveries.
 SHOW GEOLOGICAL MARKERS, LOGS RUN, OR OTHER DESCRIPTIVE INFORMATION.

FORMATION DESCRIPTION, CONTENTS, ETC.	TOP	BOTTOM	NAME	DEPTH
Surface Clay-Sand-Redbed	0'	530'		
Sand-Redbed-Shale	530'	642'		
Redbed-Shale	642'	1420'		
Redbed-Anhy-Sand	1420'	1575'		
Redbed-Anhy	1575'	1856'		
Anhy-Shale	1856'	2090'		
Shale-Shale w/lime	2090'	2130'		
Shale-Lime	2130'	5400'		
Lime-Shale	5400'	TD		
TOTAL DEPTH		5400'		
DST #1 5332-38 (Morrow) 10-20-40-60, wk blow & died 1 min, bypass tool w/no blow rec 10' DM, ISIP 1320 (20), IFP 78-78, FP 65-65, FSIP 1347 (60), temp 126°.				
DST #2 5170-5400', pkr failure				
DST #3 5126-5400, tool plugged, TIH w/DP & cond hole after DST #3. Circ 3 hrs, st TOH to pickup test tool 6:15 AM.				
DST #4 5126-5400' (Morrow), 20-40-40-80 w/fair to good blow thruout, rec 490' DM, NS, IHP 2702, IFP 303-316, ISIP 1265 (40), FFP 348-408, FSIP 1238 (80), FHP 2676.				

USE ADDITIONAL SHEETS, IF NECESSARY, TO COMPLETE WELL RECORD.

Date Received _____

 Signature
 Stanley R. Shoemaker, Division Office Manager
 Title
 May 10, 1977
 Date