

STATE OF KANSAS  
STATE CORPORATION COMMISSION

WELL PLUGGING RECORD

Give All Information Completely  
Make Required Affidavit  
Mail or Deliver Report to  
Conservation Division  
State Corporation Comm.  
245 North Water  
Wichita, KS 67202

Morton County, Sec. 9 Twp. 33S Rge. 40 E/W  
Location as "NE/CNW 1/4 SW 1/4" or footage from lines  
49' NG S/2 SE NE 9-33-40W

Lease Owner Anadarko Production Company  
Lease Name Davison "C" Well No. #2  
Office Address Box 351, Liberal, Kansas 67901

Character of Well (Completed as Oil, Gas or Dry Hole)  
Dry Hole

Date Well completed 9-15 1978  
Application for plugging filed 10-16 1978  
Application for plugging approved Verbal 9-15 1978  
Plugging commenced 9-15 1978  
Plugging completed 9-15 1978

Reason for abandonment of well or producing formation  
Dry Hole

If a producing well is abandoned, date of last production  
19

Was permission obtained from the Conservation Division or  
its agents before plugging was commenced? Yes - Verbal

Name of Conservation Agent who supervised plugging of this well Clarence Thomas  
Producing formation none Depth to top Bottom Total Depth of Well 5900'  
Show depth and thickness of all water, oil and gas formations.

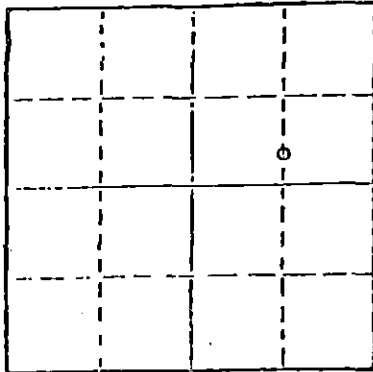

Locate well correctly on above  
Section Plat

OIL, GAS OR WATER RECORDS

CASING RECORD

| FORMATION | CONTENT | FROM | TO | SIZE   | PUT IN | PULLED OUT |
|-----------|---------|------|----|--------|--------|------------|
|           |         |      |    | 8-5/8" | 1514'  | -0-        |
|           |         |      |    |        |        |            |
|           |         |      |    |        |        |            |
|           |         |      |    |        |        |            |

Describe in detail the manner in which the well was plugged, indicating where the mud fluid was placed and the method or methods used in introducing it into the hold. If cement or other plugs were used, state the character of same and depth placed, from feet to feet for each plug set.

- 50 sacks 3150-3250'
- 35 sacks 1500'
- 10 sacks 40-0'
- 5 sacks RH

RECEIVED  
STATE CORPORATION COMMISSION  
12-12-78  
DEC 12 1978

(If additional description is necessary, use BACK of this sheet)

Name of Plugging Contractor Gabbert-Jones Drilling Company

STATE OF KANSAS COUNTY OF SEWARD, ss.  
Paul Campbell (employee of owner) or (owner or operator)

of the above-described well, being first duly sworn on oath, says: That I have knowledge of the facts, statements, and matters herein contained and the log of the above-described well as filed and that the same are true and correct. So help me God.

Paul Campbell, Div. Prod. Mgr. (Signature) *Paul Campbell*  
Box 351, Liberal, Kansas 67901 (Address)

SUBSCRIBED AND SWORN TO before me this 8<sup>th</sup> day of December, 1978

STATE NOTARY PUBLIC  
BEVERLY J. WILLIAMS  
Seward County, Kansas  
My Appt. Exp. 11/21/82

My commission expires December 21, 1982

*Beverly J. Williams*  
Notary Public.

**KANSAS DRILLERS LOG**

S. 9 T. 33S R. 40 <sup>EC</sup><sub>W</sub>

API No. 15 — 129 — 20,368 - 0000  
 County Number

Loc. S/2 SE NE

County Morton

Operator  
Anadarko Production Company

Address  
Box 351, Liberal, Kansas 67901

Well No. #2 Lease Name Davison "C"

Footage Location  
2261 feet from (N) 660' line feet from (E) (W) line

Principal Contractor Gabbert-Jones Geologist John C. Riggs

Spud Date 8-28-78 Total Depth 5900' P.B.T.D.

Date Completed 9-15-78 Oil Purchaser Dry Hole

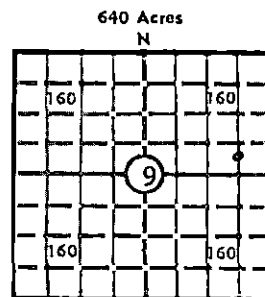

Locate well correctly  
 Elev.: Gr. 3232.7'

DF \_\_\_\_\_ KB \_\_\_\_\_

**CASING RECORD**

Report of all strings set — surface, intermediate, production, etc.

| Purpose of string | Size hole drilled | Size casing set (in O.D.) | Weight lbs/ft. | Setting depth | Type cement | Sacks      | Type and percent additives |
|-------------------|-------------------|---------------------------|----------------|---------------|-------------|------------|----------------------------|
| Surface           | 12-1/4"           | 8-5/8"                    | 24#            | 1514          | Poz Common  | 600<br>250 | 4% Gel<br>2% CC            |
|                   |                   |                           |                |               |             |            |                            |
|                   |                   |                           |                |               |             |            |                            |
|                   |                   |                           |                |               |             |            |                            |

**LINER RECORD**

**PERFORATION RECORD**

| Top, ft. | Bottom, ft. | Sacks cement | Shots per ft. | Size & type | Depth interval |
|----------|-------------|--------------|---------------|-------------|----------------|
|          |             |              |               |             |                |
|          |             |              |               |             |                |
|          |             |              |               |             |                |

**TUBING RECORD**

| Size | Setting depth | Packer set at |
|------|---------------|---------------|
|      |               |               |
|      |               |               |

**ACID, FRACTURE, SHOT, CEMENT SQUEEZE RECORD**

| Amount and kind of material used | Depth interval treated |
|----------------------------------|------------------------|
|                                  |                        |
|                                  |                        |
|                                  |                        |

RECEIVED  
 STATE CORPORATION COMMISSION  
 DEC 12 1978

**INITIAL PRODUCTION**

CONSERVATION DIVISION  
 WICHITA, KANSAS

Date of first production Dry Hole Producing method (flowing, pumping, gas lift, etc.)

RATE OF PRODUCTION PER 24 HOURS  
 Oil \_\_\_\_\_ Gas \_\_\_\_\_ Water \_\_\_\_\_ Gas-oil ratio \_\_\_\_\_  
 bbls. MCF bbls. CFPB

Disposition of gas (vented, used on lease or sold) \_\_\_\_\_ Producing Interval(s) \_\_\_\_\_

INSTRUCTIONS: As provided in KCC Rule 82-2-125, within 90 days after completion of a well, one completed copy of this Drillers Log shall be transmitted to the State Geological Survey of Kansas, 4150 Monroe Street, Wichita, Kansas 67209. Copies of this form are available from the Conservation Division, State Corporation Commission, 3830 So. Meridian (P.O. Box 17027), Wichita, Kansas 66217. Phone AC 316-522-2206. If confidential custody is desired, please note Rule 82-2-125. Drillers Logs will be on an open file in the Oil and Gas Division, State Geological Survey of Kansas, Lawrence, Kansas 66044.

Operator Anadarko Production Company DESIGNATE TYPE OF COMP.: OIL, GAS, DRY HOLE, SWDW, ETC.: Dry Hole

Well No. #2 Lease Name Davison "C"

S 9 T 33S R 40 <sup>X</sup><sub>W</sub>

**WELL LOG**

Show all important zones of porosity and contents thereof; cored intervals, and all drill-stem tests, including depth interval tested, cushion used, time tool open, flowing and shut-in pressures, and recoveries.

SHOW GEOLOGICAL MARKERS, LOGS RUN, OR OTHER DESCRIPTIVE INFORMATION.

| FORMATION DESCRIPTION, CONTENTS, ETC. | TOP  | BOTTOM | NAME | DEPTH |
|---------------------------------------|------|--------|------|-------|
| Sand-Clay                             | 0    | 316    |      |       |
| Sand-Redbed                           | 316  | 635    |      |       |
| Sand-Gravel-Anhy-Redbed               | 635  | 1090   |      |       |
| Redbed                                | 1090 | 1488   |      |       |
| Redbed-Anhy                           | 1488 | 1515   |      |       |
| Anhy-Sand-Redbed                      | 1515 | 1810   |      |       |
| Shale                                 | 1810 | 2194   |      |       |
| Shale w/Lime                          | 2194 | 2225   |      |       |
| Lime-Shale                            | 2225 | 5701   |      |       |
| Lime-Chert                            | 5701 | 5761   |      |       |
| Lime                                  | 5761 | 5796   |      |       |
| Core                                  | 5796 | 5850   |      |       |
| Lime                                  | 5850 | 5900   |      |       |
| Total Depth                           |      | 5900   |      |       |

USE ADDITIONAL SHEETS, IF NECESSARY, TO COMPLETE WELL RECORD

Date Received \_\_\_\_\_

*Paul Campbell*  
 Paul Campbell Signature  
 Division Production Manager  
Title  
*Dec 4, 1978*  
Date