

STATE OF KANSAS  
STATE CORPORATION COMMISSION  
200 Colorado Derby Bldg.  
Wichita, Kansas 67202

WELL PLUGGING RECORD

Give All Information Completely  
Make Required Affidavit

COUNTY Sumner SEC. 5 TWP. 34S RGE. 2 E/W  
Location as in quarters or footage from lines:  
C SW/4 NW/4

Lease Owner Anadarko Production Company  
Lease Name JINDRA "A" Well No. 1  
Office Address P. O. Box 351, Liberal, Kansas 67901  
Character of Well (Completed as Oil, Gas or Dry Hole): Oil  
Date Well Completed 2/6/79  
Application for plugging filed 10/23/81  
Plugging commenced 3/2/82  
Plugging completed 3/5/82  
Reason for abandonment of well or producing formation Depleted

Locate Well  
correctly on above  
Section Platt.

Was permission obtained from the Conservation Division or it's  
Agent's before plugging was commenced? yes

Name of Conservation Agent who supervised plugging of this well Tim Galliher  
Producing formation Viola Depth to top 4489' bottom 4500' T.D. 4560'  
Show depth and thickness of all water, oil and gas formations.

OIL, GAS OR WATER RECORDS Casing Record

Formation	Content	From	To	Size	Put in	Pulled Out
Viola	Oil	4489'	4500'	8-5/8"	286'	None
				4-1/2"	4559'	3610'

Describe in detail the manner in which the well was plugged, indicating where the mud  
fluid was placed and the method or methods used in introducing it into the hold. If cement  
or other plugs were used, state the character of same and depth placed, from          feet  
to          feet for each plug set. Plugged 4-1/2" casing to 4439' w/4 sxs sand and 4 sxs  
cmt, shot off 4-1/2" casing @ 3722 & 3610', plugged 8-5/8" casing from 350' to 3' w/4 sxs  
hulls, 6 sxs gel, 100 sxs cmt & capped well.

RECEIVED  
STATE CORPORATION COMMISSION

MAR 16 1982

CONSERVATION DIVISION  
Wichita, Kansas

(If additional description is necessary, use BACK of this sheet)  
Name of Plugging Contractor Kelso Casing Pulling Service

STATE OF KANSAS COUNTY OF SEWARD, ss.  
Paul Campbell (employee of owner) or ~~(owner or operator)~~ of the  
above-described well, being first duly sworn on oath, says: That I have knowledge of the  
facts, statements, and matters herein contained and the log of the above-described well as  
filed and that the same are true and correct. So help me God.

(Signature) Paul Campbell  
P. O. Box 351, Liberal, KS 67901  
(Address)

SUBSCRIBED AND SWORN TO before me this 15<sup>th</sup> day of March, 19 82

STATE NOTARY PUBLIC  
BEVERLY J. WILLIAMS  
Seward County, Kansas  
My Comm. Expires November 21, 1982

Beverly J. Williams  
Notary Public.

15-191-20845-0000

**KANSAS DRILLERS LOG**

API No. 15 — 191 — 20,845  
County Number

S. 5 T. 34S R. 2 <sup>XK</sup> W  
 Loc. 660' FWL & 1980 FNL

Operator  
 Anadarko Production Company

County Sumner

Address  
 P. O. Box 351, Liberal, Kansas 67901

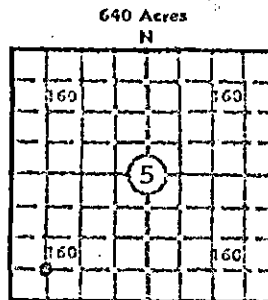

Well No. 1 Lease Name JINDRA "A"

Footage Location  
 1980 feet from (N) X23 line 660 feet from X23 (W) line

Principal Contractor Geologist  
 Gabbert-Jones, Inc. Lee H. Cornell

Spud Date Total Depth P.B.T.D.  
 12-30-78 4560 4542

Date Completed Oil Purchaser  
 2-8-79 Koch Exploration Company

Elev.: Gr. 1141

DF \_\_\_\_\_ KB \_\_\_\_\_

**CASING RECORD**

Report of all strings set — surface, intermediate, production, etc.

Purpose of string	Size hole drilled	Size casing set (in O.D.)	Weight lbs/ft.	Setting depth	Type cement	Sacks	Type and percent additives
Surface	12-1/4"	8-5/8"	20#	286	Common	275	3% CaCl
Production	7-7/8"	4-1/2"	10.5#	4559	SS Pozmix	175	.5% D-31

**LINER RECORD**

**PERFORATION RECORD**

Top, ft.	Bottom, ft.	Sacks cement	Shots per ft.	Size & type	Depth interval
			2		4489-93'
<b>TUBING RECORD</b>			2		4493-96'
Size	Setting depth	Packer set at	2		4496-4500'
2-3/8"	4511'				

**ACID, FRACTURE, SHOT, CEMENT SQUEEZE RECORD**

Amount and kind of material used	Depth interval treated
None.	

RECEIVED  
 STATE CORPORATION COMMISSION

**INITIAL PRODUCTION**

OCT 30 1981

Date of first production Producing method (flowing, pumping, gas lift, etc.)  
 3/16/79 Pumping

RATE OF PRODUCTION PER 24 HOURS Oil 15 bbls. Gas — MCF 61 bbls. Water tstm CFPB

Disposition of gas (vented, used on lease or sold) Producing interval (s)  
 None 4489-4500'

INSTRUCTIONS: As provided in KCC Rule 82-2-125, within 90 days after completion of a well, one completed copy of this Drillers Log shall be transmitted to the State Geological Survey of Kansas, 4150 Monroe Street, Wichita, Kansas 67209. Copies of this form are available from the Conservation Division, State Corporation Commission, 3830 So. Meridian (P.O. Box 17027), Wichita, Kansas 66217. Phone AC 316-522-2206. If confidential custody is desired, please note Rule 82-2-125. Drillers Logs will be on open file in the Oil and Gas Division, State Geological Survey of Kansas, Lawrence, Kansas 66044.

Operator: Anadarko Production Company DESIGNATE TYPE OF COMP.: OIL, GAS, DRY HOLE, SWOW, ETC.:

Well No. 1 Lease Name JINDRA Oil

S 5 T 34S R 2 xxx  
W

**WELL LOG**

Show all important zones of porosity and contents thereof; cored intervals, and all drill-stem tests, including depth interval tested, cushion used, time tool open, flowing and shut-in pressures, and recoveries.

SHOW GEOLOGICAL MARKERS, LOGS RUN, OR OTHER DESCRIPTIVE INFORMATION.

FORMATION DESCRIPTION, CONTENTS, ETC.	TOP	BOTTOM	NAME	DEPTH
Sand-Redrock	0'	33'	Logs: Schlumberger Dual Induction- Laterolog 4551-285'	
Shale	33'	286'		
Shale-Shells	286'	815'	Comp. Neut.-Form Density 4556-1500	
Shale-Lime	815'	1120'		
Lime-Shale	1120'	1225'		
Shale	1225'	1445'		
Shale-Lime	1445'	2505'		
Lime-Shale	2505'	3035'		
Shale-Lime	3035'	3345'		
Lime	3345'	3700'		
Lime-Shale	3700'	4285'		
Lime	4285'	4314'		
Shale	4314'	4365'		
Lime	4365'	4440'		
Shale	4440'	4510'		
Lime-Shale	4510'	4560'		
TD		4560'		

DST #1 4502-10' (Viola) 20-40-40-120, PF w/str blo, op 40m w/GTS tstm, rec 60' DCM, 2100' HGCD 500' wtr, IFP 226-667, ISIP 1586 (40), FFP 610-1025, FSIP 1594 (120), HP 2315.

USE ADDITIONAL SHEETS, IF NECESSARY, TO COMPLETE WELL RECORD.

<p>Date Received</p>	<p><i>Paul Campbell</i> Signature</p> <p>Paul Campbell, Division Production Manager Title</p> <p>March 29, 1979 Date</p>
----------------------	--