

STATE OF KANSAS
STATE CORPORATION COMMISSION

WELL PLUGGING RECORD

Give All Information Completely
Make Required Affidavit
Mail or Deliver Report to
Conservation Division
State Corporation Comm.
245 North Water
Wichita, KS 67202

Morton County, Sec. 12 Twp. 33S Rge. 41 E/W
Location as "NE/CNW $\frac{1}{4}$ SW $\frac{1}{4}$ " or footage from lines
554' FSL & 554' FEL
Lease Owner Anadarko Production Company
Lease Name CHEROKEE "B" Well No. 2
Office Address P. O. Box 351, Liberal, Kansas 67901
Character of Well (Completed as Oil, Gas or Dry Hole)
OIL

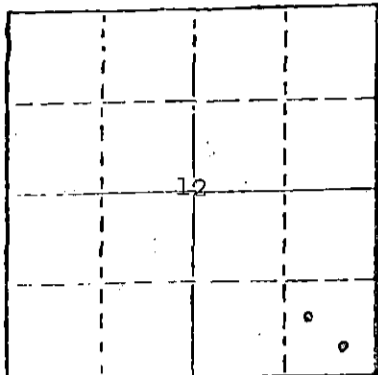

Locate well correctly on above
Section Plot

Date Well completed July 2 1977
Application for plugging filed July 13 1981
Application for plugging approved July 22 1981
Plugging commenced October 31 1981
Plugging completed November 4 1981
Reason for abandonment of well or producing formation
Depleted

If a producing well is abandoned, date of last production
June 6 1981

Was permission obtained from the Conservation Division or
its agents before plugging was commenced? yes

Name of Conservation Agent who supervised plugging of this well Clarence Thomas
Producing formation Upper Morrow Depth to top 5290 Bottom 5314 Total Depth of Well 5960
Show depth and thickness of all water, oil and gas formations.

OIL, GAS OR WATER RECORDS

CASING RECORD

FORMATION	CONTENT	FROM	TO	SIZE	PUT IN	PULLED OUT
Upper Morrow	Oil	5290	5314	8-5/8"	1585'	None
				4-1/2"	5562'	3214'

Describe in detail the manner in which the well was plugged, indicating where the mud fluid
was placed and the method or methods used in introducing it into the hold. If cement or other
plugs were used, state the character of same and depth placed, from _____ feet to
_____ feet for each plug set.

Spotted 25 sxs cement from 5000-5314'; shot 4-1/2" casing @ 3214, spotted 30 sxs cmt
2600-2500, 40 sxs cmt 1550-1450, 10 sxs cmt 40-0, cut off 8-5/8 csg & capped well.

(If additional description is necessary, use BACK of this sheet)

Name of Plugging Contractor Sargents Casing Pulling Service

STATE OF KANSAS COUNTY OF SEWARD, ss.

Paul Campbell (employee of owner) or (owner or operator)

of the above-described well, being first duly sworn on oath, says: That I have knowledge of
the facts, statements, and matters herein contained and the log of the above-described well
as filed and that the same are true and correct. So help me God.

(Signature) Paul Campbell
P. O. Box 351, Liberal, Kansas 67901
(Address)

SUBSCRIBED AND SWORN TO before me this 18th day of November, 1981

BEVERLY J. WILLIAMS
Seward County, Kansas
My Appt. Exp. _____

My commission expires November 21, 1982

Beverly J. Williams
Notary Public.

RECEIVED
STATE CORPORATION COMMISSION

NOV 20 1981

CONSERVATION DIVISION
Wichita Kansas

KANSAS DRILLERS LOG

S. 12 T. 33S R. 41 ^N/_W

API No. 15 — 129 — 20,308 - 0000
County Number

Loc. 554' FSSEL

County Morton

Operator

ANADARKO PRODUCTION COMPANY

Address

P. O. BOX 351, LIBERAL, KANSAS 67901

Well No.

Lease Name

2

Cherokee "B"

Footage Location

554

feet from (N) (S) line

554

feet from (E) (W) line

Principal Contractor

Gabbert-Jones, Inc.

Geologist

Bob Posey

Spud Date

9:15PM 5/26/77

Total Depth

5960'

P.B.T.D.

5410'

Date Completed

7/8/77

Oil Purchaser

Permian Corp.

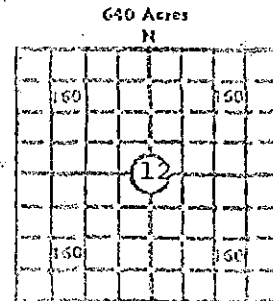

Elev. Gr. 3405.7'

DF _____ KB _____

CASING RECORD

Report of all strings set—surface, intermediate, production, etc.

Purpose of string	Size hole drilled	Size casing set (in O.D.)	Weight lbs/ft.	Setting depth	Type cement	Sacks	Type and percent additives
Surface	12-1/4"	8-5/8"	24#	1585'	50/50 Poz Common	550 200	4% gel 2% cc
Production	7-7/8"	4-1/2"	10.5#	5562'	SS Poz	190	.2% D-45, 1/4# tuff fiber/sx

LINER RECORD

PERFORATION RECORD

Top, ft.	Bottom, ft.	Sacks cement	Shots per ft.	Size & type	Depth interval
			2		5438-48'
			2		5307-14'

TUBING RECORD

ACID, FRACTURE, SHOT, CEMENT SQUEEZE RECORD

Amount and kind of material used	Depth interval treated
A/1000 gals 10% MCA + 35BS. set CIBP 5410'	5438-48'
A/750 gals 10% spearhead + 10BS	5307-14'
F/24BO 1 hr, KW/50B 2% KCL	

INITIAL PRODUCTION

RECEIVED
 STATE CORPORATION COMMISSION

Date of first production

7/2/77

Producing method (flowing, pumping, gas lift, etc.)

Pumping

RATE OF PRODUCTION PER 24 HOURS

Oil

103 bbls.

Gas

40.4 MCF

Water

no

Disposition of gas (vented, used on lease or sold)

Producing interval (s)

5307-14'

JUL 21 1981
 Gas-oil ratio

CONSERVATION DIVISION CFPB

Wichita, Kansas

INSTRUCTIONS: As provided in KCC Rule 82-2-125, within 90 days after completion of a well, one completed copy of this Drillers Log shall be transmitted to the State Geological Survey of Kansas, 4150 Monroe Street, Wichita, Kansas 67209. Copies of this form are available from the Conservation Division, State Corporation Commission, 3830 So. Meridian (P.O. Box 17027), Wichita, Kansas 66217. Phone AC 316-522-2206. If confidential custody is desired, please note Rule 82-2-125. Drillers Logs will be on open file in the Oil and Gas Division, State Geological Survey of Kansas, Lawrence, Kansas 66044.

DESIGNATE TYPE OF COMP.: OIL, GAS, DRY HOLE, SWDW, ETC.:

OIL

Operator
ANADARKO PRODUCTION COMPANY

Well No.
2

Lease Name
CHEROKEE "B"

S12 T 33S R 41 ^{EX}
W

WELL LOG

Show all important zones of porosity and contents thereof; cored intervals, and all drill-stem tests, including depth interval tested, cushion used, time tool open, flowing and shut-in pressures, and recoveries.

SHOW GEOLOGICAL MARKERS, LOGS RUN, OR OTHER DESCRIPTIVE INFORMATION.

FORMATION DESCRIPTION, CONTENTS, ETC.	TOP	BOTTOM	NAME	DEPTH
Surface Clay-Sand	0'	664'		
Redbed	664'	673'		
Redbed-Anhy-Sand	673'	1169'		
Redbed-Sand-Anhy	1169'	1478'		
Sand-Redbed-Anhy	1478'	1585'		
Anhy-Shale	1585'	2015'		
Shale-Shale w/Lime	2015'	2264'		
Lime-Shale	2264'	5824'		
Lime	5824'	5914'		
Lime-Shale	5914'	5960'		
TOTAL DEPTH		5960'		

DST #1 5300-5353 (Morr), 27MPF, GTS 22M TSTM, op 40M gas TSTM decrg, re 620' HGCO, ISIP 1685. (40), IFP 212-225, FFP 225-238, FSIP 1711 (80) HP 2552-2526, temp 140°

DST #1 sample chamber press 275, rec .014 CFG + 1100 cc oil, grav 39.5 60° - 0 wtr & 0 mud.

USE ADDITIONAL SHEETS, IF NECESSARY, TO COMPLETE WELL RECORD.

Date Received

Paul Campbell
Signature

Paul Campbell, Division Production Manager

Title

November 2, 1977

Date

UNITED STATES
DEPARTMENT OF THE INTERIOR
BUREAU OF LAND MANAGEMENT

15-129-20308-0000

FORM APPROVED
Budget Bureau No. 1004-0135
Expires: March 31, 1993

SUNDRY NOTICES AND REPORTS ON WELLS

BLM-TULSA D.O.

KS NM 77185

Do not use this form for proposals to drill or to deepen or reentry to a different reservoir. Use "APPLICATION FOR PERMIT—" for such proposals.

5. Lease Designation and Serial No.
6. If Indian, Allottee or Tribe Name

SUBMIT IN TRIPLICATE

1. Type of Well

Oil Well Gas Well Other

2. Name of Operator

Anadarko Petroleum Corporation

3. Address and Telephone No.

P. O. Box 351, Liberal, Kansas 69705-0351

4. Location of Well (Footage, Sec., T., R., M., or Survey Description)

2310' FSL & 2310' FEL Section 12-33S-41W

7. If Unit or CA, Agreement Designation

KS NM 75248

8. Well Name and No.

Cherokee "B" NO. 1

9. API Well No.

15-129-20313-0000

10. Field and Pool, or Exploratory Area

Santa Fe Trail

11. County or Parish, State

Morton, Kansas

12. CHECK APPROPRIATE BOX(S) TO INDICATE NATURE OF NOTICE, REPORT, OR OTHER DATA

TYPE OF SUBMISSION	TYPE OF ACTION
<input type="checkbox"/> Notice of Intent	<input type="checkbox"/> Abandonment
<input checked="" type="checkbox"/> Subsequent Report	<input type="checkbox"/> Recompletion
<input type="checkbox"/> Final Abandonment Notice	<input type="checkbox"/> Plugging Back
	<input type="checkbox"/> Casing Repair
	<input type="checkbox"/> Altering Casing
	<input checked="" type="checkbox"/> Other <u>Commingling</u>
	<input type="checkbox"/> Change of Plans
	<input type="checkbox"/> New Construction
	<input type="checkbox"/> Non-Routine Fracturing
	<input type="checkbox"/> Water Shut-Off
	<input type="checkbox"/> Conversion to Injection
	<input type="checkbox"/> Dispose Water

(Note: Report results of multiple completion on Well Completion or Recompletion Report and Log form.)

13. Describe Proposed or Completed Operations (Clearly state all pertinent details, and give pertinent dates, including estimated date of starting any proposed work. If well is directionally drilled, give subsurface locations and measured and true vertical depths for all markers and zones pertinent to this work.)*

TOH W/153 jts 2 1/16" tbg (short string). TOH w/158 jts 2 1/16" tbg (long string), & Model K packer. Drill permanent packer @ 5175' and push to 5352'. TIH w/sn, TA, & 163 jts 2 3/8" tbg. Set TA @ 4947', SN @ 5307'. TIH w/pump, rods. POP & turn down pipeline.

RECEIVED
KANSAS CORPORATION COMMISSION
NOV 29 1993
CONSERVATION DIVISION
Wichita, Kansas

14. I hereby certify that the foregoing is true and correct

Signed Beverly J. Williams

Title Technical Assistant

Date 11-17-93

(This space for Federal or State office use)

Approved by (ORIG. SGD.) VIRGIL L. PAULI

Title VIRGIL L. PAULI
CHIEF, BRANCH OF
FLUID OPERATIONS

Date NOV 23 1993

Conditions of approval, if any:

ACCEPTED FOR RECORD PURPOSES ONLY

Title 18 U.S.C. Section 1001, makes it a crime for any person knowingly and willfully to make to any department or agency of the United States any false, fictitious or fraudulent statements or representations as to any matter within its jurisdiction.

*See Instruction on Reverse Side

Kansas Corporation Commission

GENERAL INSTRUCTIONS

This form is designed for submitting proposals to perform certain well operations, and reports of such operations when completed, as indicated, on Federal and Indian lands pursuant to applicable Federal law and regulations, and, if approved or accepted by any State, on all lands in such State, pursuant to applicable State law and regulations. Any necessary special in-

structions concerning the use of this form and the number of copies to be submitted, particularly with regard to local area, or regional procedures and practices, either are shown below or will be issued by, or may be obtained from, the local Federal and/or State office.

SPECIFIC INSTRUCTIONS

Item 4—If there are no applicable State requirements, locations on Federal or Indian land should be described in accordance with Federal requirements. Consult local State or Federal office for specific instructions.

Item 13—Proposals to abandon a well and subsequent reports of abandonment should include such special information as is required by local Federal and/or State offices. In addition, such proposals and reports should include reasons for the abandonment; data on any former or present productive

zones, or other zones with present significant fluid contents not sealed off by cement or otherwise; depths (top and bottom) and method of placement of cement plugs; mud or other material placed below, between and above plugs; amount, size, method of parting of any casing, liner or tubing pulled and the depth to top of any left in the hole; method of closing top of well; and date well site conditioned for final inspection looking to approval of the abandonment.

NOTICE

The Privacy Act of 1974 and the regulation in 43 CFR 2.48(d) provide that you be furnished the following information in connection with information required by this application.

AUTHORITY: 30 U.S.C. 181 et. seq., 351 et. seq., 25 U.S.C. et. seq.; 43 CFR 3160.

PRINCIPAL PURPOSE — The information is to be used to evaluate, when appropriate, approve applications, and report completion of secondary well operations, on a Federal or Indian lease.

ROUTINE USES:

- (1) Evaluate the equipment and procedures used during the proposed or completed subsequent well operations.
- (2) Request and grant approval to perform those actions covered by 43 CFR 3162.3-2(2).
- (3) Analyze future applications to drill or modify operations in light of data obtained and methods used.
- (4)(5) Information from the record and/or the record will be transferred to appropriate Federal, State, local or foreign agencies, when relevant to civil, criminal or regulatory investigations or prosecutions.

EFFECT OF NOT PROVIDING INFORMATION — Filing of this notice and report and disclosure of the information is mandatory once an oil or gas well is drilled.

The Paperwork Reduction Act of 1980 (44 U.S.C. 3501, et. seq.) requires us to inform you that:

This information is being collected in order to evaluate proposed and/or completed subsequent well operations on Federal or Indian oil and gas leases.

This information will be used to report subsequent operations once work is completed and when requested, to obtain approval for subsequent operations not previously authorized.

Response to this request is mandatory for the specific types of activities specified in 43 CFR Part 3160.

BURDEN HOURS STATEMENT

Public reporting burden for this form is estimated to average 25 minutes per response, including the time for reviewing instructions, gathering and maintaining data, and completing and reviewing the form. Direct comments regarding the burden estimate or any other aspect of this form to U.S. Department of the Interior, Bureau of Land Management, (Alternate) Bureau Clearance Officer, (WO-771), 18 and C Streets, N.W., Washington, D.C. 20240, and the Office of Management and Budget, Paperwork Reduction Project (1004-0135), Washington, D.C. 20503.