

WELL PLUGGING RECORD

Give All Information Completely
Make Required Affidavit
Mail or Deliver Report to:
Conservation Division
State Corporation Commission
212 No. Market
Wichita, Kansas

Morton County, Sec. 13 Twp. 33S Rge. (X) 41 (W)

Location as "NE/CNW/SW" or footage from lines C NE NW
Lease Owner ANADARKO PRODUCTION COMPANY
Lease Name DUNKLE "B" Well No. 1
Office Address P. O. BOX 351, LIBERAL, KANSAS 67901
Character of Well (completed as Oil, Gas or Dry Hole) Dry Hole
Date well completed Nov. 27 19 77
Application for plugging filed Jan. 24 19 78
Application for plugging approved verbally Nov. 27 19 77
Plugging commenced Nov. 27 19 77
Plugging completed Nov. 27 19 77
Reason for abandonment of well or producing formation Dry Hole

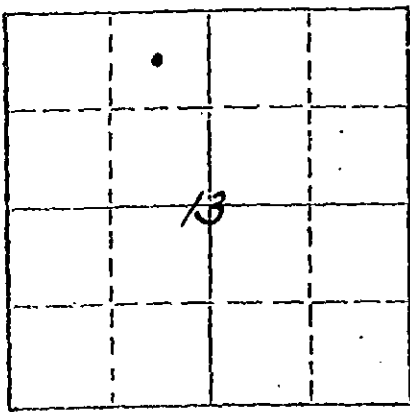

Locate well correctly on above Section Plat

If a producing well is abandoned, date of last production 19
Was permission obtained from the Conservation Division or its agents before plugging was commenced? Yes

Name of Conservation Agent who supervised plugging of this well Lee Massey
Producing formation _____ Depth to top _____ Bottom _____ Total Depth of Well 5500' Feet
Show depth and thickness of all water, oil and gas formations.

OIL, GAS OR WATER RECORDS

CASING RECORD

FORMATION	CONTENT	FROM	TO	SIZE	PUT IN	PULLED OUT
				8-5/8"	1501'	None

Describe in detail the manner in which the well was plugged, indicating where the mud fluid was placed and the method or methods used in introducing it into the hole. If cement or other plugs were used, state the character of same and depth placed, from _____ feet to _____ feet for each plug set.
Spotted 30 sxs cmt. from 5100' to 5000', 30 sxs cmt from 2600' to 2500', 50 sxs cmt from 1550' to 1450' and 10 sxs cmt from 40' to surface. Hole filled with mud.

RECEIVED
STATE CORPORATION COMMISSION

JAN 26 1978

U.S. CONSERVATION DIVISION
Wichita, Kansas

(If additional description is necessary, use BACK of this sheet)

Name of Plugging Contractor Lohmann-Johnson Drilling Company
Address 1302 Old National Bank Building, Evansville, Indiana 47708

STATE OF KANSAS COUNTY OF SEWARD, ss.

Paul Campbell (employee of owner) or (owner) of the above-described well, being first duly sworn on oath, says: That I have knowledge of the facts, statements, and matters herein contained and the log of the above-described well as filed and that the same are true and correct. So help me God.

LEONA FERNE CORNELSEN
STATE NOTARY PUBLIC
Seward County, Kansas
My Appointment Expires
June 23, 1980

(Signature) Paul Campbell
Paul Campbell, Division Production Manager
P. O. Box 351, Liberal, Kansas 67901
(Address)

Subscribed and sworn to before me this 24th day of January, 19 78

Leona Ferne Cornelsen
Notary Public

My commission expires June 23, 1980

KANSAS DRILLERS LOG

S. 13 T. 33S R. 41 $\frac{1}{2}$ W

API No. 15 — 129 — 20,342-0000
 County Number

Loc. C NE NW

County MORTON

Operator

ANADARKO PRODUCTION COMPANY

Address

P. O. BOX 351, LIBERAL, KANSAS 67901

Well No.

Lease Name

1 DUNKLE "B"

Footage Location

660 feet from (N) line 1980 feet from (E) (W) line

Principal Contractor

Geologist

Lohmann-Johnson Drllg Co

Bob Posey

Spud Date

Total Depth

P.B.T.D.

11/16/77

5500'

Date Completed

Oil Purchaser

11/27/77

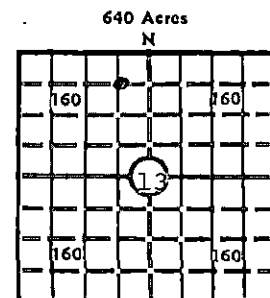

Locate well correctly
 Elev.: Gr. 3361.4'

DF _____ KB _____

CASING RECORD

Report of all strings set — surface, intermediate, production, etc.

Purpose of string	Size hole drilled	Size casing set (in O.D.)	Weight lbs/ft.	Setting depth	Type cement	Sacks	Type and percent additives
Surface	12-1/4"	8-5/8"	24#	1501'	Pozmix Common	600 200	4% gel, 2% cc 2% cc

LINER RECORD

PERFORATION RECORD

Top, ft.	Bottom, ft.	Sacks cement	Shots per ft.	Size & type	Depth interval

TUBING RECORD

Size	Setting depth	Packer set at

ACID, FRACTURE, SHOT, CEMENT SQUEEZE RECORD

Amount and kind of material used	Depth interval treated

RECEIVED
 STATE CORPORATION COMMISSION
 JAN 26 1978
 OIL SERVICE DIVISION
 WICHITA, KANSAS

INITIAL PRODUCTION

Date of first production _____ Producing method (flowing, pumping, gas lift, etc.) _____

RATE OF PRODUCTION PER 24 HOURS	Oil	Gas	Water	Gas-oil ratio
	bbis.	MCF	bbis.	CFPB

Disposition of gas (vented, used on lease or sold) _____ Producing interval (s) _____

INSTRUCTIONS: As provided in KCC Rule 82-2-125, within 90 days after completion of a well, one completed copy of this Drillers Log shall be transmitted to the State Geological Survey of Kansas, 4150 Monroe Street, Wichita, Kansas 67209. Copies of this form are available from the Conservation Division, State Corporation Commission, 3830 So. Meridian (P.O. Box 17027), Wichita, Kansas 66217. Phone AC 316-522-2206. If confidential custody is desired, please note Rule 82-2-125. Drillers Logs will be on open file in the Oil and Gas Division, State Geological Survey of Kansas, Lawrence, Kansas 66044.

Operator ANADARKO PRODUCTION COMPANY DESIGNATE TYPE OF COMP.: OIL, GAS, DRY HOLE, SWDW, ETC.: DRY HOLE

Well No. 1 Lease Name DUNKLE "B"

S 13 T 33S R 41 W

WELL LOG

Show all important zones of porosity and contents thereof; cored intervals, and all drill-stem tests, including depth interval tested, cushion used, time tool open, flowing and shut-in pressures, and recoveries.

SHOW GEOLOGICAL MARKERS, LOGS RUN, OR OTHER DESCRIPTIVE INFORMATION.

FORMATION DESCRIPTION, CONTENTS, ETC.	TOP	BOTTOM	NAME	DEPTH
SAND	0'	401'		
REDBED	401'	1060'		
SAND	1060'	1213'		
REDBED & SHALE	1213'	1498'		
ANDY	1498'	1505'		
REDBED & SHALE	1505'	2631'		
LIME & SHALE	2631'	3624'		
LIME, SHALE & CHALK	3624'	4197'		
LIME & SHALE	4197'	5500'		
TOTAL DEPTH		5500'		
DST #1 4906-5120 (Morrow) 20-40-40-80 w/fair to good blow, rec 93' DM, ISIP 102 (40), IFP 102-102, FFP 102-102, FSIP 188 (80).				
DST #2 5230-5342 (Morrow) 10-20-40-80 w/fair to good blow thruout, rec 270' GCM + 450' SW, IHP 2524, IFP 105-223, ISIP 1151 (20), FFP 288-393, FSIP 288-393, FSIP 1178 (80), FHP 2497.				

USE ADDITIONAL SHEETS, IF NECESSARY, TO COMPLETE WELL RECORD.

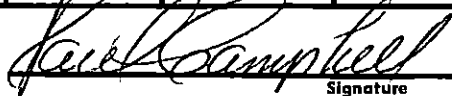
Date Received	 Signature
	Paul Campbell, Division Production Manager
	Title
	January 24, 1978
	Date