

WELL PLUGGING RECORD

Give All Information Completely
Make Required Affidavit
Mail or Deliver Report to:
Conservation Division
State Corporation Commission
212 No. Market
Wichita, Kansas

NORTH

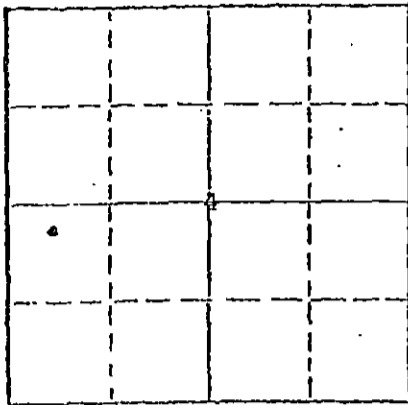

Locate well correctly on above
Section Plot

Seward

County, Sec. 4

Twp. 33S

Rge. X 34

(E)

(W)

Location as "NE/CNWESW" or footage from lines 1980' FSL & 660' FWL

Lease Owner ANADARKO PRODUCTION COMPANY

Lease Name HITCH "F"

Well No. 1

Office Address P. O. Box 351, Liberal, Kansas 67901

Character of Well (completed as Oil, Gas or Dry Hole) Dry Hole

Date well completed 5/16 19 78

Application for plugging filed verbally 5/15 19 78

Application for plugging approved verbally 5/15; written 5/18 19 78

Plugging commenced 5/16 19 78

Plugging completed 5/16 19 78

Reason for abandonment of well or producing formation DRY

If a producing well is abandoned, date of last production 19

Was permission obtained from the Conservation Division or its agents before plugging was commenced? Yes

Name of Conservation Agent who supervised plugging of this well Clarence Thomas

Producing formation Depth to top Bottom Total Depth of Well 6386 feet

Show depth and thickness of all water, oil and gas formations.

OIL, GAS OR WATER RECORDS

CASING RECORD

FORMATION	CONTENT	FROM	TO	SIZE	PUT IN	PULLED OUT
				8-5/8"	1670'	None
				4-1/2"	3208'	None

Describe in detail the manner in which the well was plugged, indicating where the mud fluid was placed and the method or methods used in introducing it into the hole. If cement or other plugs were used, state the character of same and depth placed, from feet to feet for each plug set.

Mixed 200 sxs Common, cmtd csg from 2983' to surface

RECEIVED
STATE CORPORATION COMMISSION

JUL 18 1978

7-18-78

CONSERVATION DIVISION
Wichita, Kansas

(If additional description is necessary, use BACK of this sheet)

Name of Plugging Contractor Halliburton Cementing, Hwy 54 West, Liberal, Kansas 67901

Address

STATE OF KANSAS COUNTY OF SEWARD, ss.

Paul Campbell (employee of owner) or (owner) of the above-described well, being first duly sworn on oath, says: That I have knowledge of the facts, statements, and matters herein contained and the log of the above-described well as filed and that the same are true and correct. So help me God.

LEONA FERNE CORNELSEN
STATE NOTARY PUBLIC
Seward County, Kansas
My Appointment Expires 17th day of July 19 78

(Signature)

Paul Campbell

Paul Campbell, Division Production Manager

(Address)

My commission expires June 23, 1980

Notary Public

15-175-20349-0000

KANSAS DRILLERS LOG

S. 4 T. 33S R. 34 ^{NE}_W
 Loc. 1980' FS & 660' FWL
 County Seward

API No. 15 — 175 — 20,349
 County Number

Operator
 ANADARKO PRODUCTION COMPANY

Address
 P. O. BOX 351, LIBERAL, KANSAS 67901

Well No. 1 Lease Name HITCH "F"

Footage Location
1980 feet from (N) (S) line 660 feet from (E) (W) line

Principal Contractor Lohmann-Johnson Geologist John C. Riggs

Spud Date 2/27/78 Total Depth 6381' P.B.T.D. 3155'

Date Completed 5/16/78 Oil Purchaser

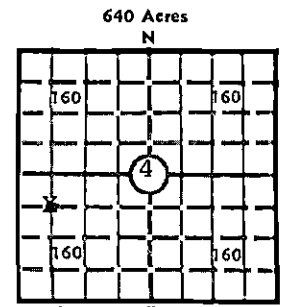

Elev.: Gr. 2892'
 DF _____ KB _____

CASING RECORD

Report of all strings set — surface, intermediate, production, etc.

Purpose of string	Size hole drilled	Size casing set (in O.D.)	Weight lbs/ft.	Setting depth	Type cement	Sacks	Type and percent additives
Surface	12-1/4"	8-5/8"	24#	1670'	POZ Common	600 200	4% gel 2% cc
Production	7-7/8"	4-1/2"	10.5#	3208'	Lite Wate SS Poz	500 150	12-1/2# Gilsonite .5% CFR-2 1/4# Tuff Fiber

LINER RECORD

PERFORATION RECORD

Top, ft.	Bottom, ft.	Sacks cement	Shots per ft.	Size & type	Depth interval
			2		2934-2983

TUBING RECORD

Size	Setting depth	Packer set at

ACID, FRACTURE, SHOT, CEMENT SQUEEZE RECORD

Amount and kind of material used	Depth interval treated
A/4500 gals 15% HCL + 100 BS; F/90,000 gals wtr + 125,000# riversand	2934-2983'

RECEIVED
 STATE CORPORATION COMMISSION

JUL 18 1978

INITIAL PRODUCTION

Date of first production _____ Producing method (flowing, pumping, gas lift, etc.) _____

CONSERVATION DIVISION
 Wichita, Kansas

RATE OF PRODUCTION PER 24 HOURS	Oil	Gas	Water	Gas-oil ratio
	bbfs.	MCF	bbfs.	CFPB

Disposition of gas (vented, used on lease or sold) _____ Producing interval(s) _____

INSTRUCTIONS: As provided in KCC Rule 82-2-125, within 90 days after completion of a well, one completed copy of this Drillers Log shall be transmitted to the State Geological Survey of Kansas, 4150 Monroe Street, Wichita, Kansas 67209. Copies of this form are available from the Conservation Division, State Corporation Commission, 3830 So. Meridian (P.O. Box 17027), Wichita, Kansas 66217. Phone AC 316-522-2206. If confidential custody is desired, please note Rule 82-2-125. Drillers Logs will be on open file in the Oil and Gas Division, State Geological Survey of Kansas, Lawrence, Kansas 66044.

Operator ANADARKO PRODUCTION COMPANY DESIGNATE TYPE OF COMP.: OIL, GAS, DRY HOLE, SWDW, ETC.: DRY HOLE

Well No. 1 Lease Name HITCH "F"

S 4 T 33S R 34 W

WELL LOG

Show all important zones of porosity and contents thereof; cored intervals, and all drill-stem tests, including depth interval tested, cushion used, time tool open, flowing and shut-in pressures, and recoveries.

SHOW GEOLOGICAL MARKERS, LOGS RUN, OR OTHER DESCRIPTIVE INFORMATION.

FORMATION DESCRIPTION, CONTENTS, ETC.	TOP	BOTTOM	NAME	DEPTH
Redbed & Sand	0'	1673'		
Redbed	1673'	2700'		
Shale	2700'	3170'		
Shale & Lime	3170'	6381'		
TOTAL DEPTH		6381'		
PBTD		3155'		
<p>DST #1 6148-6208 (Chester) 20-40-30-80, op w/few bubbles & died, rec 15' DM, ISIP 59-59, ISIP 207 (40), FFP 59-59, FSIP 207 (80), HP 2981-2981, sampler rec 2240 cc mud.</p>				

USE ADDITIONAL SHEETS, IF NECESSARY, TO COMPLETE WELL RECORD.

Date Received

Paul Campbell
Signature
Paul Campbell, Division Production Manager
Title
July 17, 1978
Date