

15-175-20237-0000

STATE OF KANSAS
STATE CORPORATION COMMISSION

Form CP-4

Give All Information Completely
Make Required Affidavit
Mail or Deliver Report to:
Conservation Division
State Corporation Commission

WELL PLUGGING RECORD

P. O. Box 17027
Wichita, Kansas 67217
NORTH

Seward County, Sec. 10 Twp. 34S Rge. 32 (W)

Location as "NE/CNWSW" or footage from lines 330' FNL & 330' FWL
Lease Owner CIG Exploration, Inc.
Lease Name Reimer Well No. 1
Office Address 415 W. 8th St.-Suite 330, Amarillo, Texas 79101
Character of Well (completed as Oil, Gas or Dry Hole) Dry Hole
Date well completed 11/4 19 74
Application for plugging filed 11/14 19 74
Application for plugging approved 11/20 19 74
Plugging commenced 11/21 19 74
Plugging completed 11/23 19 74
Reason for abandonment of well or producing formation Dry Hole

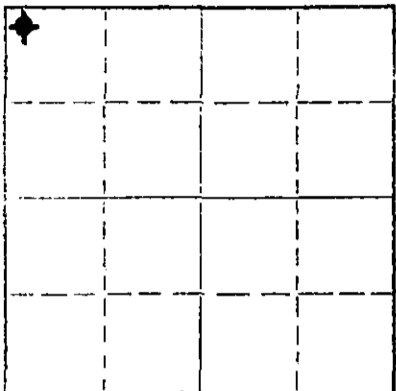

Locate well correctly on above
Section Plat

If a producing well is abandoned, date of last production 19
Was permission obtained from the Conservation Division or its agents before plugging was commenced? Yes

Name of Conservation Agent who supervised plugging of this well Mr. Clarence F. Thomas
Producing formation _____ Depth to top _____ Bottom _____ Total Depth of Well 6030 Feet
Show depth and thickness of all water, oil and gas formations.

OIL, GAS OR WATER RECORDS

CASING RECORD

FORMATION	CONTENT	FROM	TO	SIZE	PUT IN	PULLED OUT
Krider	SW	2633	2681	8-5/8"	1494'	0
Lansing	SW	4530	5207	4-1/2"	5976'	3005'
Morrow	SW	5747	5971			
Mississippian	SW	5971	6030			

Describe in detail the manner in which the well was plugged, indicating where the mud fluid was placed and the method or methods used in introducing it into the hole. If cement or other plugs were used, state the character of same and depth placed, from _____ feet to _____ feet for each plug set.

Spotted 20 sxs cement from 5550' to 5292'

Filled casing w/9.2 #/gal mud

Spotted 35 sxs cement from 1000' to 900'

Spotted 10 sxs cement from 40' to 0'

RECEIVED
STATE CORPORATION COMMISSION
DEC 23 1974
15-23-74
CONSERVATION DIVISION
Wichita, Kansas

(If additional description is necessary, use BACK of this sheet)

Name of Plugging Contractor Bob Sargent
Address Liberal, Kansas

STATE OF TEXAS COUNTY OF POTTER ss.

Jim R. Pendergrass (employee of owner) of the above-described well, being first duly sworn on oath, says: That I have knowledge of the facts, statements, and matters herein contained and the log of the above-described well as filed and that the same are true and correct. So help me God.

(Signature) Jim R. Pendergrass
415 W. 8th St.-Suite 300, Amarillo, Texas 79101
(Address)

Subscribed and Sworn to before me this 20th day of December, 1974

Patricia Mary
Notary Public.

My commission expires June 1, 1975

KANSAS DRILLERS LOG

S. 10 T. 34 R. 32 ^W

API No. 15 — 175 — 20,237
County Number

Loc. 330 FNL 330 FWL

County Seward

Operator
CIG Exploration, Inc.

Address
 415 West 8th Street, Suite 300, Amarillo, Texas

Well No. #1 Lease Name Reimer

Footage Location
330 feet from (N) line 330 feet from (S) (W) line

Principal Contractor Service Drilling Company Geologist Ben Gray

Spud Date 10/2/74 Total Depth 6030' P.B.T.D. 5966'

Date Completed 11/4/74 Oil Purchaser -

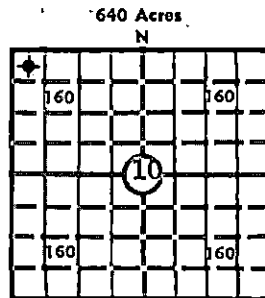

Elev.: Gr. 2646

DF _____ KB _____

CASING RECORD

Report of all strings set — surface, intermediate, production, etc.

Purpose of string	Size hole drilled	Size casing set (in O.D.)	Weight lbs/ft.	Setting depth	Type cement	Sacks	Type and percent additives
Surface	12-1/4	8-5/8	24	1494	Howco Lite Class H	600 200	2% CaCl ₂ 3% CaCl ₂
Production	7-7/8	4-1/2	10.79 &10.5	5976	50-50 poz	110	18% salt

LINER RECORD

Top, ft.	Bottom, ft.	Sacks cement	Shots per ft.	Size & type	Depth interval
				.39" Welex DP	5892-5907

TUBING RECORD

Size	Setting depth	Packer set at

ACID, FRACTURE, SHOT, CEMENT SQUEEZE RECORD

Amount and kind of material used	Depth interval treated
1,500 gal 15% HCl	5892-5907
20,000 gal gelled 3% HCl w/20,000# 10-20 sd.	5892-5907

INITIAL PRODUCTION

Date of first production None Producing method (flowing, pumping, gas lift, etc.) Dry Hole Will P & A

RATE OF PRODUCTION PER 24 HOURS
 Oil _____ Gas _____ Water _____ Gas-oil ratio _____
bbls. MCF bbls. CFPB

Disposition of gas (vented, used on lease or sold) _____ Producing interval (s) _____

INSTRUCTIONS: As provided in KCC Rule 82-2-125, within 90 days after completion of a well, one completed copy of this Drillers Log shall be transmitted to the State Geological Survey of Kansas, 4150 Monroe Street, Wichita, Kansas 67209. Copies of this form are available from the Conservation Division, State Corporation Commission, 3830 So. Meridian (P.O. Box 17027), Wichita, Kansas 66217. Phone AC 316-522-2206. If confidential custody is desired, please note Rule 82-2-125. Drillers Logs will be on open file in the Oil and Gas Division, State Geological Survey of Kansas, Lawrence, Kansas 66044.

Operator _____ DESIGNATE TYPE OF COMP.: OIL, GAS, DRY HOLE, SWDW, ETC.:

Well No. #1 Lease Name Reimer Dry Hole

S 10 T 34 R 32 W

WELL LOG

Show all important zones of porosity and contents thereof; cored intervals, and all drill-stem tests, including depth interval tested, cushion used, time tool open, flowing and shut-in pressures, and recoveries.

SHOW GEOLOGICAL MARKERS, LOGS RUN, OR OTHER DESCRIPTIVE INFORMATION.

FORMATION DESCRIPTION, CONTENTS, ETC.	TOP	BOTTOM	NAME	DEPTH
Perforated, acidized & fraced Morrow sand gas production not commerical, (18 mcf/d @ 0 psi). Will P & A.	5892	5907	Base/of	
			Stowe Corral	1608
			Krider	2681
			Council Grove	3024
			Base of Heebner	4375
			Lansing	4530
			Marmaton	5207
			Cherokee	5526
			Morrow	5747
			Morrow sand	5897
Chester	5933			
TD	6030			

USE ADDITIONAL SHEETS, IF NECESSARY, TO COMPLETE WELL RECORD.

Date Received _____

 Signature W. E. Rawlings
 Sr. Engineer
 Title
 11/18/74
 Date