

STATE OF KANSAS
STATE CORPORATION COMMISSION

WELL PLUGGING RECORD

Give All Information Completely
Make Required Affidavit
Mail or Deliver Report to
Conservation Division
State Corporation Comm.
245 North Water
Wichita, KS 67202

Seward County. Sec. 20 Twp. 34S Rge. 32W E/W
Location as "NE/CNW $\frac{1}{4}$ SW $\frac{1}{4}$ " or footage from lines

C SW NE
Lease Owner Kansas Energies
Lease Name Redford B Well No. 1
Office Address Box 1578 Liberal, Kansas 67901
Character of Well (Completed as Oil, Gas or Dry Hole)
Dry Hole

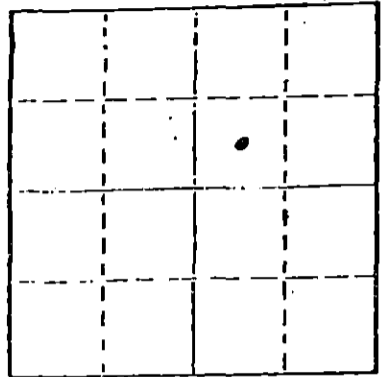

Locate well correctly on above
Section Plat

Date Well completed 19
Application for plugging filed 11-16 1979
Application for plugging approved 11-17 1979
Plugging commenced 11-17 1979
Plugging completed 11-20 1979
Reason for abandonment of well or producing formation

dry hole
If a producing well is abandoned, date of last production 19

Was permission obtained from the Conservation Division or its agents before plugging was commenced? Yes

Name of Conservation Agent who supervised plugging of this well Clarence Thomas
Producing formation _____ Depth to top _____ Bottom _____ Total Depth of Well 6294
Show depth and thickness of all water, oil and gas formations.

OIL, GAS OR WATER RECORDS

CASING RECORD

FORMATION	CONTENT	FROM	TO	SIZE	PUT IN	PULLED OUT
				8 5/8	1574	none
				4 1/2	6292	3519

Describe in detail the manner in which the well was plugged, indicating where the mud fluid was placed and the method or methods used in introducing it into the hold. If cement or other plugs were used, state the character of same and depth placed, from _____ feet to _____ feet for each plug set.

Pump 20 sks. of cement @ 5700
Pump 40 sks. of cement @ 1550 to 1450
Put 10 sks. of cement @ 40 to 0

(If additional description is necessary, use BACK of this sheet)

Name of Plugging Contractor Sargents Casing Pulling Ser. Box 506 Liberal, Kansas No. 511

RECEIVED
NOV 29 1979
STATE CORPORATION COMMISSION

STATE OF Kansas COUNTY OF Seward
Ned E. Lowry (employee of owner) or (owner or operator)

of the above-described well, being first duly sworn on oath, says: That I have knowledge of the facts, statements, and matters herein contained and the log of the above-described well as filed and that the same are true and correct. So help me God.

(Signature) Ned E. Lowry, Agent
P. O. Box 1578, Liberal, Kansas 67901
(Address)

SUBSCRIBED AND SWORN TO before me this 27th day of November, 1979

BETTIE HUTCHINSON
Seward County, Ks.
My Appt. Exp. 4/2/81

Bettie Hutchinson
Notary Public.

My commission expires

15-175-10153-0001

KANSAS DRILLERS LOG

S. 20 T.34S R.32W E

API No. 15 — OWWO —
County Number

Loc. C SW NE

County Seward

640 Acres
N

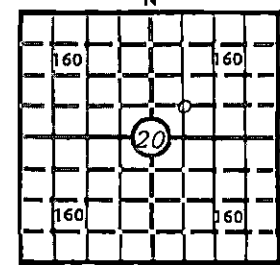

Elev.: Gr. _____

DF _____ KB _____

Operator
Kansas Energy Investment, Inc.

Address
PO Box 1578, Liberal, Kansas 67901

Well No. B#1 Lease Name Redford

Footage Location
1980 feet from (N) (X) line 1980 feet from (E) XX line

Principal Contractor DaMac Drilling Company Geologist _____

Spud Date 7-28-79 Total Depth 6400' P.B.T.D. 6092'

Date Completed 10-2-79 Oil Purchaser _____

CASING RECORD

Report of all strings set — surface, intermediate, production, etc.

Purpose of string	Size hole drilled	Size casing set (in O.D.)	Weight lbs/ft.	Setting depth	Type cement	Sacks	Type and percent additives
surface	12 1/4"	8 5/8"		1574'			
production	7 7/8"	4 1/2"	10.5#	6292'	class H	50	8% gel, 10% salt, 12 1/2# Kolite
					50/50 pozmix	200	18% salt, 12 1/2# Kolite, .75% TIC

LINER RECORD

PERFORATION RECORD

Top, ft.	Bottom, ft.	Sacks cement	Shots per ft.	Size & type	Depth interval
			1 spf	3 1/8" gun, DP	6152-58; 6124-28; 6132-34; 6100-16; 6060-66; 6070-74

Size	Setting depth	Packer set at

ACID, FRACTURE, SHOT, CEMENT SQUEEZE RECORD

Amount and kind of material used	Depth interval treated
500 gal 28% HCS acid; 3200 scf CO ₂ /bbl; 2500 gal 28% HRTA-1 acid; 3200 scf CO ₂ /bbl	6060-6158
2000 gal 28% HCS acid; 2000 scf CO ₂ /bbl	6060-66; 6070-74
300 gal 28% HCS acid; 3200 scf CO ₂ /bbl - 1000 gal 28% HRTA-1 acid; 3200 SCF CO ₂ /bbl - 15,000 gal Cross-link gelled 2% KCL water + 21,500# 20/40 sand + 7500 gal CO ₂ INITIAL PRODUCTION	5982-6006

RECEIVED
STATE CORPORATION COMMISSION

NOV 2 1979

Date of first production _____ Producing method (flowing, pumping, gas lift, etc.) _____

RATE OF PRODUCTION PER 24 HOURS	Oil _____ bbls.	Gas _____ MCF	Water _____ bbls.	Gas-oil ratio _____	CFPB
---------------------------------	-----------------	---------------	-------------------	---------------------	------

Disposition of gas (vented, used on lease or sold) _____ Producing interval(s) _____

INSTRUCTIONS: As provided in KCC Rule 82-2-125, within 90 days after completion of a well, one completed copy of this Drillers Log shall be transmitted to the State Geological Survey of Kansas, 4150 Monroe Street, Wichita, Kansas 67209. Copies of this form are available from the Conservation Division, State Corporation Commission, 3830 So. Meridian (P.O. Box 17027), Wichita, Kansas 66217. Phone AC 316-522-2206. If confidential custody is desired, please note Rule 82-2-125. Drillers Logs will be on open file in the Oil and Gas Division, State Geological Survey of Kansas, Lawrence, Kansas 66044.

Operator
Kansas Energy Investment, Inc.

DESIGNATE TYPE OF COMP.: OIL, GAS,
DRY HOLE, SWDW, ETC.:
Dry Hole

Well No. B#1 Lease Name Redford

S 20 T 34S R 32W^E_W

WELL LOG

Show all important zones of porosity and contents thereof; cored intervals, and all drill-stem tests, including depth interval tested, cushion used, time tool open, flowing and shut-in pressures, and recoveries.

SHOW GEOLOGICAL MARKERS, LOGS RUN,
OR OTHER DESCRIPTIVE INFORMATION.

FORMATION DESCRIPTION, CONTENTS, ETC.	TOP	BOTTOM	NAME	DEPTH
information unavailable				

USE ADDITIONAL SHEETS, IF NECESSARY, TO COMPLETE WELL RECORD.

Date Received

Neil E. Perry

 Signature

Agent for Kansas Energy Investment

 Title

27 November, 1979

 Date

15-175-10153-0001

KANSAS DRILLERS LOG

S. 20 T. 34S R. 32W ^E _W

API No. 15 — OWWO —
County Number

Loc. C SW NE

County Seward

Operator
Kansas Energy Investment, Inc.

Address
PO Box 1578, Liberal, Kansas 67901

Well No. B#1 Lease Name Redford

Footage Location
1980 feet from (N) (X) line 1980 feet from (E) XW line

Principal Contractor DaMac Drilling Company Geologist

Spud Date 7-28-79 Total Depth 6400' P.B.T.D. 6092'

Date Completed 10-2-79 Oil Purchaser

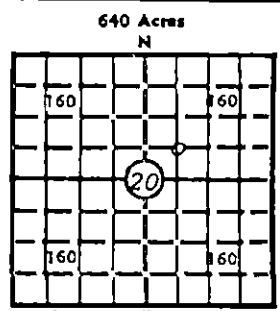

Elev.: Gr. _____

DF _____ KB _____

CASING RECORD

Report of all strings set — surface, intermediate, production, etc.

Purpose of string	Size hole drilled	Size casing set (in O.D.)	Weight lbs/ft.	Setting depth	Type cement	Sacks	Type and percent additives
surface	12 1/2"	8 5/8"		1574'			
production	7 7/8"	4 1/2"	10.5#	6292'	class H	50	8% gel, 10% salt, 12 1/2# Kolite
					50/50 pozmix	200	18% salt, 12 1/2# Kolite, .75% TIC

LINER RECORD

PERFORATION RECORD

Top, ft.	Bottom, ft.	Sacks cement	Shots per ft.	Size & type	Depth interval
			1 spf	3 1/8" gun, DP	6152-58; 6124-28;

TUBING RECORD

Size	Setting depth	Packer set at	Depth interval
			6132-34; 6100-16; 6060-66; 6070-74 5982-94; 5998-600

ACID, FRACTURE, SHOT, CEMENT SQUEEZE RECORD

Amount and kind of material used	Depth interval treated
500 gal 28% HCS acid; 3200 scf CO ₂ /bbl; 2500 gal 28% HRTA-1 acid; 3200 scf CO ₂ /bbl	6060-6158
2000 gal 28% HCS acid; 2000 scf CO ₂ /bbl	6060-66; 6070-74
300 gal 28% HCS acid; 3200 scf CO ₂ /bbl - 1000 gal 28% HRTA-1 acid; 3200 scf CO ₂ /bbl - 15,000 gal Cross-link gelled 2% KCL water + 21,500# 20/40 sand + 7500 gal CO ₂ INITIAL PRODUCTION	5982-6006

Date of first production _____ Producing method (flowing, pumping, gas lift, etc.) _____

RATE OF PRODUCTION PER 24 HOURS	Oil	Gas	Water	Gas-oil ratio
	bbls.	MCF	REC bbls.	CFPB

Disposition of gas (vented, used on lease or sold) _____ Producing interval(s) _____

INSTRUCTIONS: As provided in KCC Rule 82-2-125, within 90 days after completion of a well, one completed copy of this Drillers Log shall be transmitted to the State Geological Survey of Kansas, 4150 Monroe Street, Wichita, Kansas 67209. Copies of this form are available from the Conservation Division, State Corporation Commission, 3830 So. Meridian (P.O. Box 17027), Wichita, Kansas 66217. Phone AC 316-522-2206. If confidential custody is desired, please note Rule 82-2-125. Drillers Logs will be on open file in the Oil and Gas Division, State Geological Survey of Kansas, Lawrence, Kansas 66044.

RECORDED
STATE CORPORATION COMMISSION
NOV 2 1979
OIL AND GAS DIVISION
WICHITA, KANSAS

Operator
Kansas Energy Investment, Inc.

DESIGNATE TYPE OF COMP.: OIL, GAS,
DRY HOLE, SWDW, ETC.:
Dry Hole

Well No.
B#1

Lease Name
Redford

S 20 T 34S R 32W^E_W

WELL LOG

Show all important zones of porosity and contents thereof; cored intervals, and all drill-stem tests, including depth interval tested, cushion used, time tool open, flowing and shut-in pressures, and recoveries.

SHOW GEOLOGICAL MARKERS, LOGS RUN,
OR OTHER DESCRIPTIVE INFORMATION.

FORMATION DESCRIPTION, CONTENTS, ETC.	TOP	BOTTOM	NAME	DEPTH
<i>information unavailable</i>				

USE ADDITIONAL SHEETS, IF NECESSARY, TO COMPLETE WELL RECORD.

Date Received

Neil E. Perry
Signature
Agent for Kansas Energy Investment
Title
27 November, 1979
Date

15-175-10153-0001

KANSAS DRILLERS LOG

S. 20 T.34S R.32W E W

API No. 15 — OWWO —
County Number

Loc. C SW NE

County Seward

Operator
Kansas Energy Investment, Inc.

Address
PO Box 1578, Liberal, Kansas 67901

Well No. B#1 Lessee Name Redford

Footage Location
1980 feet from (N) (S) line 1980 feet from (E) (W) line

Principal Contractor DaMac Drilling Company Geologist

Spud Date 7-28-79 Total Depth 6400' P.B.T.D. 6092'

Date Completed 10-2-79 Oil Purchaser

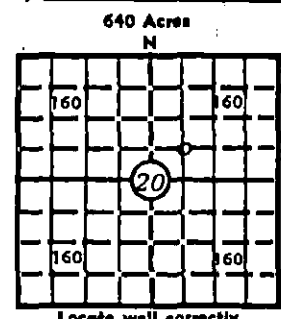

Elev.: Gr. _____

DP _____ KB _____

CASING RECORD

Report of all strings set — surface, intermediate, production, etc.

Purpose of string	Size hole drilled	Size casing set (in O.D.)	Weight lbs/ft.	Setting depth	Type cement	Socks	Type and percent additives
surface	12 1/2"	8 5/8"		1574'			
production	7 7/8"	4 1/2"	10.5#	6292'	class H	50	8% gel, 10% salt, 12# Kolite
					50/50 pozmix	200	18% salt, 12# Kolite, .75% TIC

LINER RECORD

PERFORATION RECORD

Top, ft.	Bottom, ft.	Socks cement	Shots per ft.	Size & type	Depth interval
			1 spf	3 1/8" gun, DP	6152-58; 6124-28; 6132-34; 6100-16; 6060-66; 6070-74

Size	Setting depth	Packer set at	Depth interval
			5982-94; 5998-6006

ACID, FRACTURE, SHOT, CEMENT SQUEEZE RECORD

Amount and kind of material used	Depth interval treated
500 gal 28% HCS acid; 3200 scf CO ₂ /bbl; 2500 gal 28% HRTA-1 acid; 3200 scf CO ₂ /bbl	6060-6158
2000 gal 28% HCS acid; 2000 scf CO ₂ /bbl	6060-66; 6070-74
300 gal 28% HCS acid; 3200 scf CO ₂ /bbl - 1000 gal 28% HRTA-1 acid; 3200 SCF CO ₂ /bbl - 15,000 gal Cross-link gelled 2% KCL water + 21,500# 20/40 sand + 7500 gal CO ₂ INITIAL PRODUCTION	5982-6006

Date of first production _____ Producing method (flowing, pumping, gas lift, etc.) _____

RATE OF PRODUCTION PER 24 HOURS
Oil _____ Gas _____ Water _____ Gas-oil ratio _____
bbbl. MCF

Disposition of gas (vented, used on lease or sold) _____ Producing interval (s) _____

RECEIVED
STATE CORPORATION COMMISSION

NOV 25 1979

CONSERVATION DIVISION
Wichita, Kansas

INSTRUCTIONS: As provided in KCC Rule 82-2-125, within 90 days after completion of a well, one completed copy of this Drillers Log shall be transmitted to the State Geological Survey of Kansas, 4150 Monroe Street, Wichita, Kansas 67209. Copies of this form are available from the Conservation Division, State Corporation Commission, 3830 So. Meridian (P.O. Box 17027), Wichita, Kansas 66217. Phone AC 316-522-2206. If confidential custody is desired, please note Rule 82-2-125. Drillers Logs will be on open file in the Oil and Gas Division, State Geological Survey of Kansas, Lawrence, Kansas 66044.

Operator
Kansas Energy Investment, Inc.

DESIGNATE TYPE OF COMP.: OIL, GAS,
DRY HOLE, SWDW, ETC.:
Dry Hole

Well No. B#1

Lease Name Redford

S 20 T 34S R 32W E W

WELL LOG

Show all important zones of porosity and contents thereof; corod intervals, and all drill-stem tests, including depth interval tested, cushion used, time tool open, flowing and shut-in pressures, and recoveries.

SHOW GEOLOGICAL MARKERS, LOGS RUN,
OR OTHER DESCRIPTIVE INFORMATION.

FORMATION DESCRIPTION, CONTENTS, ETC.	TOP	BOTTOM	NAME	DEPTH
information unavailable				

USE ADDITIONAL SHEETS, IF NECESSARY, TO COMPLETE WELL RECORD.

Date Received

Signature
Title
Date