

UNITED STATES DEPARTMENT OF THE INTERIOR BUREAU OF LAND MANAGEMENT

SUBMIT IN DUPLICATE

(See other instructions on reverse side)

FOR APPROVED OMB NO. 1004-0137 Expires: December 31, 1991

CORR

WELL COMPLETION OR RECOMPLETION REPORT AND LOG

1. TYPE OF WELL: OIL WELL [X] GAS WELL [ ] DRY [ ] Other [ ]
2. NAME OF OPERATOR: Anadarko Petroleum Corporation

3. ADDRESS AND TELEPHONE NO.: P. O. Box 351, Liberal, Kansas 67905-0351 (316) 624-6253
4. LOCATION OF WELL: At surface 660' FNL & 1830' FWL

5. LEASE DESIGNATION AND SERIAL NO.: KS NM 84091
6. IF INDIAN, ALLOTTEE OR TRIBE NAME
7. UNIT AGREEMENT NAME
8. FARM OR LEASE NAME, WELL NO.: USA "AC" No. 1

14. PERMIT NO.: 15-129-21,148 DATE ISSUED: 11-13-92

15. DATE SPUDDED: 11-18-92 16. DATE T.D. REACHED: 12-1-92 17. DATE COMPL.: 12-22-92
19. ELEVATIONS: 3285.7 GR

10. FIELD AND POOL OR WILDCAT: Sitrup
11. SEC., T., R., M., OR BLOCK AND SURVEY OR AREA: Sec. 11-33S-40W
12. COUNTY OR RANGE: Morton
13. STATE: Kansas

20. TOTAL DEPTH, MD & TVD: 5600 21. PLUG BACK T.D., MD & TVD: 5543
22. IF MULTIPLE COMPL. HOW MANY?: NA
23. INTERVALS DRILLED BY: ROTARY TOOLS [X] CABLE TOOLS [ ]

24. PRODUCING INTERVAL(S): 5357-5400 O.A. U. Morrow "D"
25. WAS DIRECTIONAL SURVEY MADE: Yes
26. TYPE ELECTRIC AND OTHER LOGS RUN: DIL/SFL/GR; CNL/LDT/GR; Microlog; Dipmeter
27. WAS WELL CORED: No

Table with 6 columns: CASING SIZE/GRADE, WEIGHT, LB./FT., DEPTH SET (MD), HOLE SIZE, TOP OF CEMENT, CEMENTING RECORD, AMOUNT PULLED

Table with 8 columns: SIZE, TOP (MD), BOTTOM (MD), SACKS CEMENT, SCREEN (MD), SIZE, DEPTH SET (MD), PACKER SET (MD)

31. PREPARATION RECORD: 5376-5400, 5357-70 - 4 SPF = 148 Total Shots
32. ACID SHOT, FRACTURE, CEMENT SQUEEZE, ETC.: 5376-5400, 5357-70 A/in 2' intervals, 50 gal/ft w/1850 gals 7 1/2% fe acid. A/3700 7 1/2% fe acid.

33. PRODUCTION: DATE FIRST PRODUCTION: 12-18-92 PRODUCTION METHOD: Flowing WELL STATUS: Producing
DATE OF TEST: 12-22-92 HOURS TESTED: 24 CHOKER SIZE: 46/64 PROD'N. FOR TEST PERIOD: 300 GAS-MCF: 91 WATER-BBL: - GAS-OIL RATIO: 303

34. DISPOSITION OF GAS: Sold TEST WITNESSED BY: CORPORATION COMMISSION

35. LIST OF ATTACHMENTS: KCC ACO-1, Drillers Log, Electric Logs, Cement Tickets

36. I hereby certify that the foregoing and attached information is complete and correct as determined from all available records. SIGNED: Beverly A. Williams TITLE: Engineering Technician DATE: 1-12-93

40. RECEIVED STATE CORPORATION COMMISSION FEB 12 1993

CONSERVATION DIVISION Wichita, Kansas

(See Instructions and Spaces for Additional Data on Reverse Side)

Title 18 U.S.C. Section 1001, makes it a crime for any person knowingly and willfully to make to any department or agency of the United States any false, fictitious or fraudulent statements or representations as to any matter within its jurisdiction.

Kansas Corporation Commission

37. SUMMARY OF POROUS ZONES: (Show all important zones of porosity and contents thereof; cored intervals; and all drill-stem tests, including depth interval tested, cushion used, time tool open, flowing and shut-in pressures, and recoveries):

38. GEOLOGIC MARKERS

FORMATION	TOP	BOTTOM	DESCRIPTION, CONTENTS, ETC.	NAME	TOP	
					MEAS. DEPTH	TRUE VERT. DEPTH
SEE ATTACHMENT				Sand & Redbed Glorietta Sand Redbed Lime-Shale	0 1158 1331 2401	

UNITED STATES  
DEPARTMENT OF THE INTERIOR  
BUREAU OF LAND MANAGEMENT

APPLICATION FOR PERMIT TO DRILL, DEEPEN, OR PLUG BACK

1a. TYPE OF WORK  
 DRILL  DEEPEN  PLUG BACK

b. TYPE OF WELL  
 OIL WELL  GAS WELL  OTHER   
 SINGLE ZONE  MULTIPLE ZONE

2. NAME OF OPERATOR  
 Anadarko Petroleum Corporation

3. ADDRESS OF OPERATOR  
 P. O. Box 351, Liberal, KS 67905-0351

4. LOCATION OF WELL (Report location clearly and in accordance with any State requirements.)\*  
 At surface  
 660' FNL & 1830' FWL, Section 11-33S-40W  
 At proposed prod. zone  
 Same

14. DISTANCE IN MILES AND DIRECTION FROM NEAREST TOWN OR POST OFFICE\*  
 6.5 miles N NW from Rolla, Kansas

10. DISTANCE FROM PROPOSED\* LOCATION TO NEAREST PROPERTY OR LEASE LINE, FT. (Also to nearest drig. unit line, if any): 660'

16. NO. OF ACRES IN LEASE: 80

17. NO. OF ACRES ASSIGNED TO THIS WELL: 80

18. DISTANCE FROM PROPOSED LOCATION\* TO NEAREST WELL, DRILLING, COMPLETED, OR APPLIED FOR, ON THIS LEASE, FT. See Exhibit C-2 6000'

19. PROPOSED DEPTH: 6000'

20. ROTARY OR CABLE TOOLS: Rotary

21. ELEVATIONS (Show whether DF, RT, GR, etc.)  
 GR 3285.7

22. APPROX. DATE WORK WILL START\*

5. LEASE DESIGNATION AND SERIAL NO.  
 KS NM 84091

6. IF INDIAN, ALLOTTEE OR TRIBE NAME

7. UNIT AGREEMENT NAME  
 #15-129-21148

8. FARM OR LEASE NAME  
 U.S.A. "AC"

9. WELL NO.  
 1

10. FIELD AND POOL, OR WILDCAT  
 Stirrup

11. SEC., T., R., M., OR BLK. AND SURVEY OR AREA  
 11-33S-40W

12. COUNTY OR PARISH  
 Morton

13. STATE  
 Kansas

23. PROPOSED CASING AND CEMENTING PROGRAM

SIZE OF HOLE	SIZE OF CASING	WEIGHT PER FOOT	SETTING DEPTH	QUANTITY OF CEMENT
12 1/4"	8 5/8"	24	1575'	See #1
7 7/8"	5 1/2"	15.5	6000'	See #2

- Drill 12 1/4" Hole to - 1575' set 8 5/8" 24# K-55 ST&C csg and cement with 550 sxs poz W/4% gel CaCl 2 + 200 sxs Com W/2% CaCl 2 with good returns to surface.
- Drill 7 7/8" hole to 6000', set 5 1/2" 15.5# K-55 ST&C csg. If production is indicated then cement with 50 sxs lightweight (65/35 pozmix W/6% gel) 1/2#/sx cellophane flakes and 165 sxs Thixset W/5% KCL, 1/4#/sx cellophane flakes, and 5#/sx gilsonite. Expected fillup is 4500' from surface.

EXHIBITS ATTACHED

- |                                 |                                 |
|---------------------------------|---------------------------------|
| A. Location and Elevation       | C-2. Location of Existing Wells |
| B. Drilling Plan                | C-3. Site Facility Diagram      |
| B-1. Pressure Control Equipment | C-4. Drillsite Layout           |
| C. Surface Use Plan             | C-5. Pipeline Layout            |
| C-1. Access Road                | D. Culture Resource Survey      |

RECEIVED  
 STATE CORPORATION COMMISSION  
 NOV 12 1992  
 WICHITA, KANSAS

IN ABOVE SPACE DESCRIBE PROPOSED PROGRAM: If proposal is to deepen or plug back, give data on present productive zone and proposed new productive zone. If proposal is to drill or deepen directionally, give pertinent data on subsurface locations and measured and true vertical depths. Give blowout preventer program, if any.

24. SIGNED L. Ashton TITLE Division Production Manager DATE 10/12/92  
 (This space for Federal or State office use)

PERMIT NO. \_\_\_\_\_ APPROVAL DATE \_\_\_\_\_  
 (ORIG. SGD.) VIRGIL L. PAULI CHIEF, BRANCH OF FLUID OPERATIONS  
 APPROVED BY \_\_\_\_\_ TITLE \_\_\_\_\_ DATE NOV 09 1992  
 (CONDITIONS OF APPROVAL, IF ANY: \_\_\_\_\_)

Kansas Corporation Commission

\*See Instructions On Reverse Side

**WELL LOCATION SURVEY**

PROPERTY OWNER Anadarko Petroleum Corporation SURVEY OF WELL USA AC#1 (Restake)  
 LOCATED 660 feet from the North line and 1830 feet from the West line of  
 SECTION 11, T33S-R40W COUNTY OF Morton STATE OF Kansas  
 SURVEYED September 25, 1992 PLATTED September 30, 1992  
 ELEVATION OF WELL LOCATION IS 3285.7 feet

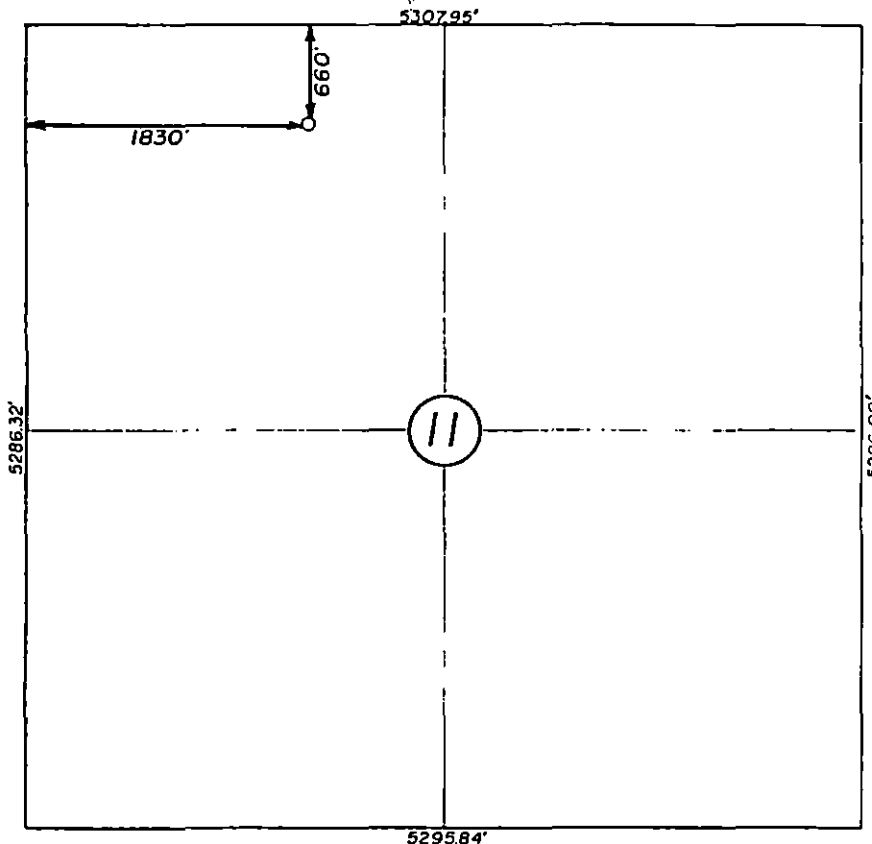

**Exhibit A  
Location and Elevation**

**U.S.A. AC-1  
660' FNL & 1830' FWL  
Section 11-33S-40W  
Morton County, Kansas  
Lease No. KS NM 84091**

RECEIVED  
STATE CORPORATION COMMISSION

NOV 12 1992

I, Donald D. DeSpain, being a Registered Land Surveyor

in the State of Kansas Seal No 707 do hereby certify that the above plat represents an accurate survey made under my supervision and that all measurements, bearings and monuments are correctly shown and indicated on the above plat as found or staked in the field as so dated above.

Signed: Donald D. DeSpain

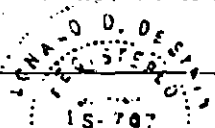

**Surveying - Engineering - Drafting  
Company**  
 Guymon, Oklahoma 73342  
 Box 1214 Phone: Day 338-6904 or 338-2144  
 338-7781 and 338-2656

EFFECTIVE DATE

11-18-92 STIRRUP

NOTICE OF INTENTION TO DRILL

FORM MUST BE SIGNED

DISTRICT#

Must be approved by the K.C.C. five (5) days prior to commencing well

ALL BLANKS MUST BE FILLED

SGA? Yes/No

EXPECTED SPUD DATE: 11 18 92

spot A E2 W#2 NE NW Sec 11 Twp 33 S, Rg 40 EAST WW WEST

Operator: License# 04549 ANADARKO PETROLEUM CORP. Address: P.O. BOX 351 LIBERAL, KS. 67901 Contact Person: JIM BARLOW Phone: 316-624-6253

660 N feet from (North) Line of Section 1930 W feet from (West) Line of Section IS SECTION XX REGULAR IRREGULAR?

NOTE: Locate well on the Section Plat on Reverse Side)

COUNTY: MORTON LEASE NAME: USA WELL#: AC-1

Field Name: STIRRUP

Is this a Prorated/Spaced Field? XX yes no

Target Formation(s): MORROW MmW

Nearest lease or unit boundary: 510

Ground Surface Elevation: 3296 feet MSL

Water well within one-quarter mile: XX yes no

Public water supply well within one mile: XX yes no

Depth to bottom of fresh water: 235 300

Depth to bottom of usable water: 550 390

Surface Pipe by Alternate: XX 1 2

Length of Surface Pipe Planned to be set: 6575

Length of Conductor Pipe required: NONE

Projected Total Depth: 6000 (MmW)

Formation at Total Depth: ST LOUIS

Water Source for Drilling Operations: XX well farm pond other

DWR Permit#

Will Cores Be Taken? yes XX no

If yes, proposed zone:

Well Drilled For: Well Class: Type Equipment:

XX Oil Enh Rec Infield XX Mud Rotary Gas Storage XX Pool Ext. Air Rotary OWO Disposal Wildcat Cable Seismic # of Holes Other

If OWO: old well information as follows:

Operator: Well Name: Comp. Date: Old Total Depth

Directional, Deviated or Horizontal wellbore? yes XX no

If yes, true vertical depth:

Bottom Hole Location:

AFFIDAVIT

The undersigned hereby affirms that the drilling, completion and eventual plugging of this well will comply with K.S.A. 55-101 et. seq.

It is agreed that the following minimum requirements will be met:

- 1. Notify the appropriate district office prior to spudding of well. 2. A copy of the approved notice of intent to drill shall be posted on each drilling rig. 3. The minimum amount of surface pipe as specified below shall be set by circulating cement to the top; in all cases surface pipe shall be set through all unconsolidated materials plus a minimum of 20 feet into the underlying formation. 4. If the well is dry hole, an agreement between the operator and district office on plug length and placement is necessary prior to plugging. 5. The appropriate district office will be notified before well is either plugged or production casing is cemented in. 6. IF AN ALTERNATE II COMPLETION, PRODUCTION PIPE SHALL BE CEMENTED FROM BELOW ANY USABLE WATER TO SURFACE WITHIN (120) DAYS OF SPUD DATE. IN ALL CASES, NOTIFY DISTRICT OFFICE PRIOR TO ANY CEMENTING.

I hereby certify that the statements made herein are true and to the best of my knowledge and belief.

Date: 11/12/92 Signature of Operator or Agent: [Signature] Title: AGENT

600

SEARCH INC., 316-265-5415

FOR KCC USE: API # 15- 129-21,148 Conductor Pipe required None feet Minimum surface pipe required 600 feet per alt. OK Approved by: CB 11-13-92 This Authorization expires: 4-13-93 (This authorization void if drilling not started within 6 months of effective date.) Spud date: Agent:

REMEMBER TO:

- File Drill Pit Application (form CDP-1) with intent to Drill; File Completion Form ACO-1 within 120 days of spud date; File acreage attribution plat according to field proration orders; Notify appropriate district office 48 hour prior to workover or re-entry; Submit plugging report (CP-4) after plugging is completed; Obtain written approval before disposing or injecting salt water.

Mail to: Conservation Division, 200 Colorado Derby Building, 202 W. First St., Wichita, Kansas 67202-1286.

NOV 12 1992 RECEIVED KANSAS CORPORATION COMMISSIONER

IN ALL CASES PLOT THE INTENDED WELL ON THE PLAT BELOW

PLAT OF ACREAGE ATTRIBUTABLE TO A WELL IN A PRORATED OR SPACED FIELD

If the intended well is in a prorated or spaced field, please fully complete this side of the form. If the intended well is in a prorated or spaced field complete the plat below showing that the well will be properly located in relationship to other wells producing from the common source of supply. Please show all the wells within 1 mile of the boundaries of the proposed acreage attribution unit for gas wells and within 1/2 mile of the boundaries of the proposed acreage attribution unit for oil wells.

API NO. 15  
OPERATOR ANADARKO PETROLEUM CORP.  
LEASE USA  
WELL NUMBER AC-1  
FIELD STIRRUP

LOCATION OF WELL: COUNTY MORTON  
660 feet from South / (North) line of section  
1830 feet from East / (West) line of section  
SECTION 11 TWP 33 RG 40

# ACRES ATTRIBUTABLE TO WELL 0  
QTR/QTR/QTR OF ACREAGE W/2 - NE - NW

IS SECTION XX REGULAR or \_\_\_\_\_ IRREGULAR  
IF SECTION IS IRREGULAR, LOCATE WELL FROM  
NEAREST CORNER BOUNDARY

Section corner used: \_\_\_\_\_ NE \_\_\_\_\_ NW \_\_\_\_\_ SE \_\_\_\_\_ SW

PLAT

(Show location of the well and shade attributable acreage for prorated or spaced wells.)  
(Show footage to the nearest lease or unit boundary line.)

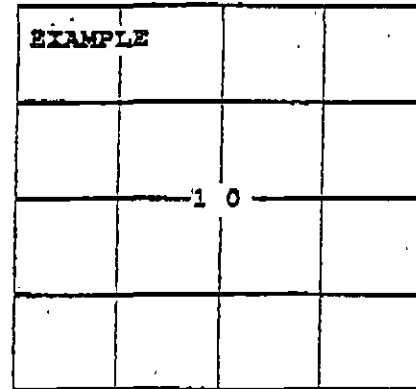
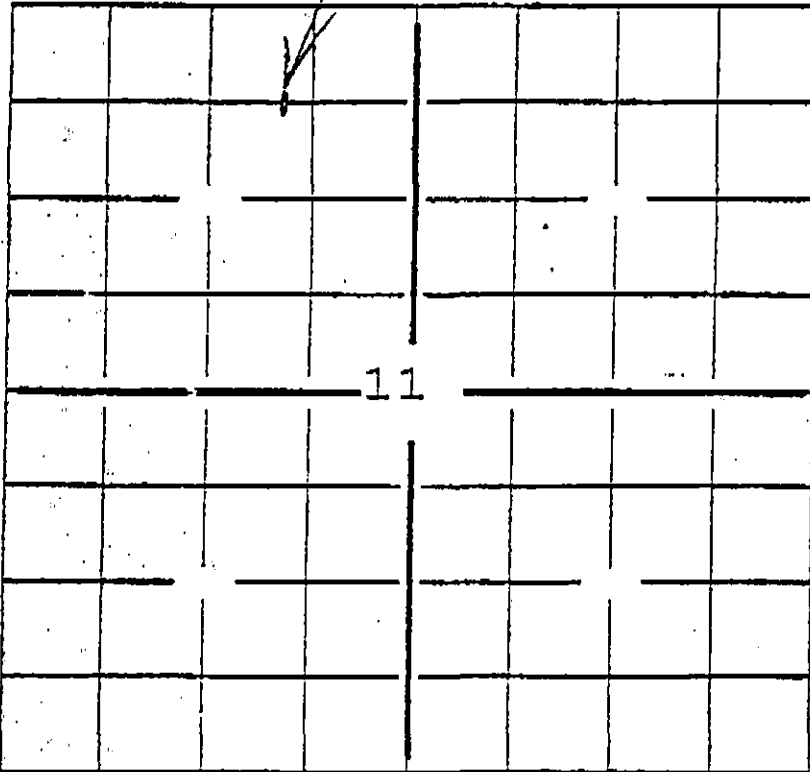

40  
ACRES

SEWARD CO.

In plotting the proposed location of the well, you must show:

- 1) The manner in which you are using the depicted plat by identifying section lines, i.e. 1 section, 1 section with 8 surrounding sections, 4 sections, etc.;
- 2) the distance of the proposed drilling location from the section's south/north and east/west lines; and
- 3) the distance to the nearest lease or unit boundary line.