

STATE OF KANSAS
STATE CORPORATION COMMISSION

WELL PLUGGING RECORD

Give All Information Completely
Make Required Affidavit
Mail or Deliver Report to
Conservation Division
State Corporation Comm.
245 North Water
Wichita, KS 67202

Seward County, Sec. 32 Twp. 33S Rge. 34 E/W
Location as "NE/CNW $\frac{1}{4}$ SW $\frac{1}{4}$ " or footage from lines
C W/2 NE SW

Lease Owner Anadarko Production Company
Lease Name REEVER "A" Well No. 1

Office Address P. O. Box 351, Liberal, Kansas
Character of Well (Completed as Oil, Gas or Dry Hole)

DRY HOLE

Date Well completed September 13 19 80
Application for plugging filed October 21 19 80
Application for plugging approved verbal September 13 19 80
Plugging commenced September 13 19 80
Plugging completed September 13 19 80
Reason for abandonment of well or producing formation
DRY HOLE

If a producing well is abandoned, date of last production 19

Was permission obtained from the Conservation Division or its agents before plugging was commenced? yes

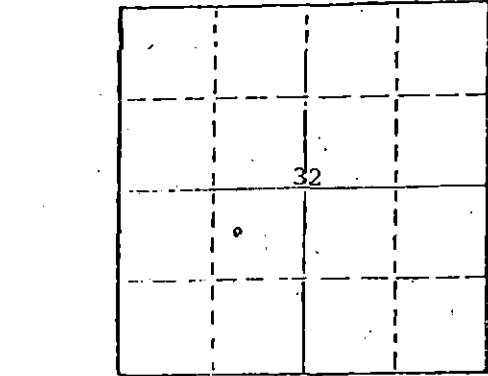

Locate well correctly on above Section Plat

Name of Conservation Agent who supervised plugging of this well Clarence Thomas
Producing formation _____ Depth to top _____ Bottom _____ Total Depth of Well 6565'
Show depth and thickness of all water, oil and gas formations.

OIL, GAS OR WATER RECORDS

CASING RECORD

FORMATION	CONTENT	FROM	TO	SIZE	PUT IN	PULLED OUT
				8-5/8"	1714'	-0-

Describe in detail the manner in which the well was plugged, indicating where the mud fluid was placed and the method or methods used in introducing it into the hold. If cement or other plugs were used, state the character of same and depth placed, from _____ feet to _____ feet for each plug set.

Spotted 60 sxs cmt 1725-1675', filled hole w/heavy drilling mud, spotted 25 sxs cmt 750-725', 10 sxs cmt 40-0', 5 sxs cmt rathole and mousehole.

RECEIVED
STATE CORPORATION COMMISSION
OCT 28 1980
CONSERVATION DIVISION
Wichita, Kansas

(If additional description is necessary, use BACK of this form)
Name of Plugging Contractor Lohmann-Johnson Drilling Company, Inc.

STATE OF KANSAS COUNTY OF SEWARD, ss.

Paul Campbell (employee of owner) on

of the above-described well, being first duly sworn on oath, says: That I have knowledge of the facts, statements, and matters herein contained and the log of the above-described well as filed and that the same are true and correct. So help me God.

(Signature) Paul Campbell
P. O. Box 351, Liberal, Kansas 67901

(Address)

SUBSCRIBED AND SWORN TO before me this 22nd day of October, 19 80

STATE NOTARY PUBLIC
BEVERLY J. WILLIAMS
Seward County, Kansas
My Appt. Exp. November 21, 1982

Beverly J. Williams
Notary Public.

My commission expires November 21, 1982

15-175-20482-0000

KANSAS

WELL COMPLETION REPORT AND DRILLER'S LOG

S. 32 T. 33S R. 34 E W

Loc. C W/2 NE SW

County Seward

API No. 15 — 175 — 20,482
County Number

Operator
Anadarko Production Company

Address
P. O. Box 351, Liberal, Kansas 67901

Well No. 1 Lease Name REEVER "A"

Footage Location
1980 feet from ~~XX~~ (S) line 1650 feet from ~~XX~~ (W) line

Principal Contractor Lohmann-Johnson Drlg. Co. Geologist Mr. Joe Blair

Spud Date 8/30/80 Date Completed 9/13/80 Total Depth 6565' P.B.T.D. NA

Directional Deviation not applicable Oil and/or Gas Purchaser DRY HOLE

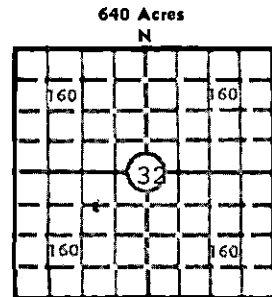

Elev.: Gr. 2950'

DF 2961' KB 2962'

CASING RECORD

Report of all strings set — surface, intermediate, production, etc.

Purpose of string	Size hole drilled	Size casing set (in O.D.)	Weight lbs/ft.	Setting depth	Type cement	Sacks	Type and percent additives
Surface	12-1/4"	8-5/8"	24#	1714'	Pozmix Common	600 200	4% gel, 2% CaCl 3% CaCl

LINER RECORD

PERFORATION RECORD

Top, ft.	Bottom, ft.	Sacks cement	Shots per ft.	Size & type	Depth interval

TUBING RECORD

Size	Setting depth	Packer set at

ACID, FRACTURE, SHOT, CEMENT SQUEEZE RECORD

Amount and kind of material used	Depth interval treated

INITIAL PRODUCTION

Date of first production DRY HOLE	Producing method (flowing, pumping, gas lift, etc.)
RATE OF PRODUCTION PER 24 HOURS	Producing interval (s)
Oil bbls.	Gas MCF
Water bbls.	Gas/GWP ratio
Disposition of gas (vented, used on lease or sold)	CFPB

RECEIVED
STATE CORPORATION COMMISSION
OCT 28 1980
CONSERVATION DIVISION
Wichita, Kansas

INSTRUCTIONS: As provided in KCC Rule 82-2-125, within 90 days after completion of a well, one completed copy of this Drillers Log shall be transmitted to the State Geological Survey of Kansas, 4150 Monroe Street, Wichita, Kansas 67209. Copies of this form are available from the Conservation Division, State Corporation Commission, 245 No. Water, Wichita, Kansas 67202. Phone AC 316-522-2206. If confidential custody is desired, please note Rule 82-2-125. Drillers Logs will be on open file in the Oil and Gas Division, State Geological Survey of Kansas, Lawrence, Kansas 66044.

Operator Anadarko Production Company		DESIGNATE TYPE OF COMP.: OIL, GAS, DRY HOLE, SWDW, ETC.:
Well No. 1	Lease Name REEVER "A"	DRY HOLE
S 32 T 33R 34 Ex W		

WELL LOG

Show all important zones of porosity and contents thereof; cored intervals, and all drill-stem tests, including depth interval tested, cushion used, time tool open, flowing and shut-in pressures, and recoveries.

SHOW GEOLOGICAL MARKERS, LOGS RUN, OR OTHER DESCRIPTIVE INFORMATION.

FORMATION DESCRIPTION, CONTENTS, ETC.	TOP	BOTTOM	NAME	DEPTH
Surface, Clay and Sand	0'	451'	LOGS: Schlumberger Dual Induction-SFL Compensated Neutron- Formation Density	
Redbed Sand and Shale	451'	1705'		
Anhydrite	1705'	1715'		
Shale	1715'	2488'		
Lime and Shale	2488'	6565'		
Core #1 6359-79, full recovery.				
Core #2 6379-6423, rec 32'.				

USE ADDITIONAL SHEETS, IF NECESSARY, TO COMPLETE WELL RECORD.

Date Received	 Signature
	Paul Campbell, Division Production Manager Title
	October 21, 1980 Date